

**Hydraulic Machine w/
Submersible Pump &
Motor
(HydroFit MR, 100-Gal.)**

**Spare Parts Leaflet
06-AAA20390AA
May 8, 2013 / Page 1 of 11**

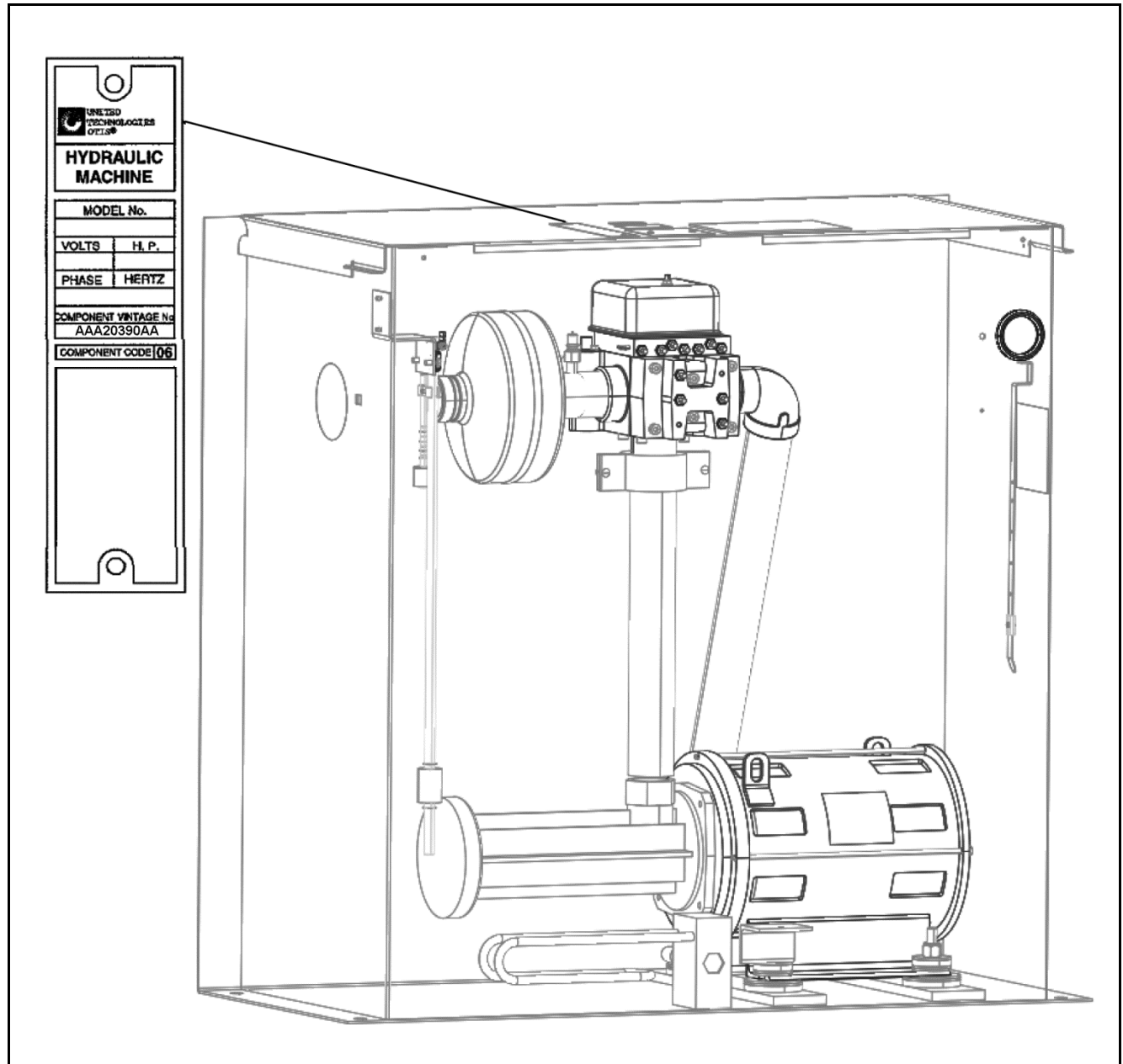

Unpublished Work—© Otis Elevator Co.; 2013

OTIS

Safety First!

**SERVICE ENGINEERING
Otis Elevator Company
Bloomfield, Connecticut USA**

Leaflet Description

This leaflet provides information for replacement parts for the Otis HydroFit™ machine room submersible pump and motor hydraulic machines for service duty applications.

Leaflet Revisions

Date Revised	Subject Matter Expert	Reason for Revision
July 15, 2005	Troy Chiccoine	Pointer to 06-AAA20390E
May 8, 2013	Art McClement	Created new SPL for this identity, for HydroFit™

Related Drawings

Drawing No.	Title	Drawing No.	Title
AAA20390AA	Hydraulic Machine Assembly and Arrangement	---	---
---	---	---	---

Related Documents

Document ID	Title
OMM 6.3-A	<i>Hydraulic Elevator Maintenance</i>
SWP 17.0.1-A	<i>Safety Tests</i>
TIP 6.3.2-4	<i>Submersible Thermal Contact</i>

Subject Matter Expert

Name	Department
Troy Chiccoine	OSC Service Engineering

About Spare Parts Leaflets...

This document lists the lowest replaceable units (LRUs) for the standard version of the product. The LRUs are chosen by a team of Otis associates representing engineering and manufacturing.

While goal of this document is to make parts identification as easy as possible, the document cannot be all-inclusive. Elevator and escalator contracts classified as “special” or “custom” are not addressed here. For such contracts, please refer to specified information, the contract folder, TIPs, Field Education Articles, Construction Letters, etc. for further information.



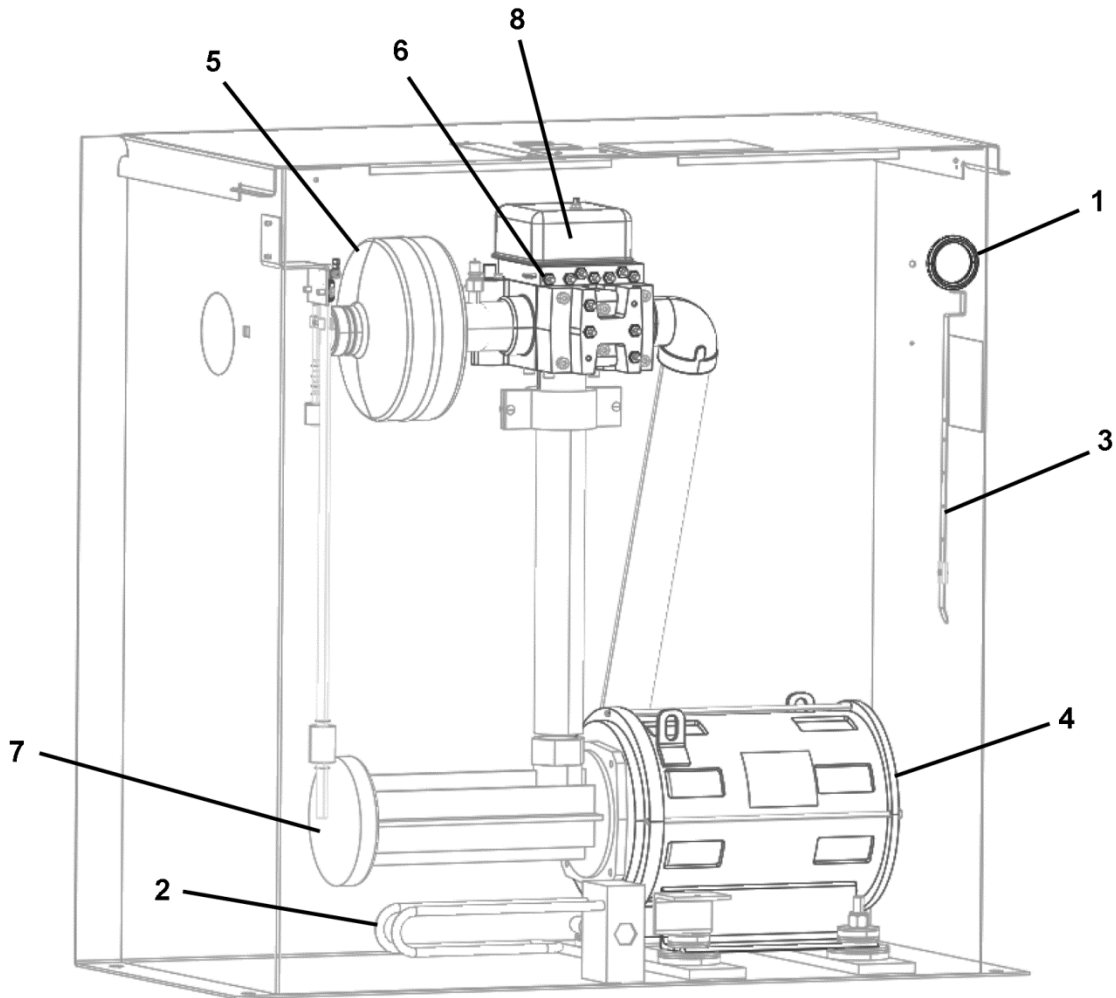

If you have any suggestions about this document, please contact the subject matter expert listed on this page.

Hydraulic Machine

06-AAA20390AA



AAA20390AA

REF. No.	PART No.	DESCRIPTION
*	AAA739H1	Contact, Thermal, Submersible,  TIP 6.3.2-4
1	334H27	Bushing, Insulating
2	615C3	Heater
3	AAA269BE4	Indicator, Dipstick
*	MT-123003	Magnet, Horseshoe Power (used with submersible thermal contact)
4	---	Motor Type 6333DD,  p. 6
5	AAA726D1	Muffler, Male 2 in NPT One End, 2 in. Victaulic Groove One End
6	377DR2	Plug, Two-Way Shut-Off, 0.25 in., Hansen #2-K16
7	---	Pump, Type 6962Y,  p. 5
8	---	Valve,  pp. 7-8

* Part not shown.

Motor Isolation Mounting

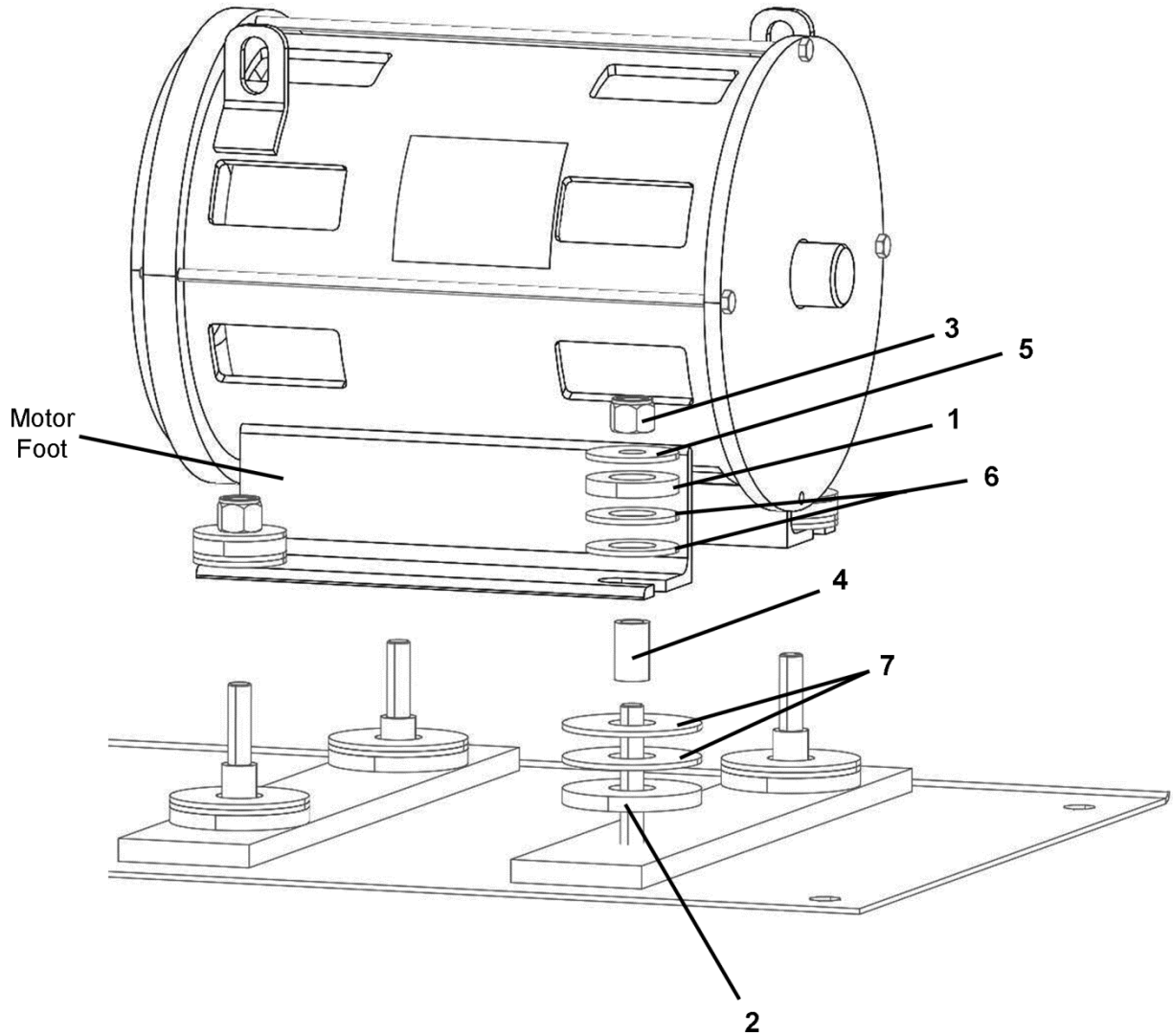

AAA20390AA		
REF. No.	PART No.	DESCRIPTION
1	310BE10	Block, Sound Insulation, 2 in. OD
2	310BE7	Block, Sound Insulation, 3 in. OD
3	67G9	Nut, Lock Elastic
4	137AL13	Tube, Non-Metallic
5	131DH1	Washer, 2 in. OD 0.56 in. ID
6	131DH2	Washer, 2 in. OD 1.0 in. ID
7	131DH3	Washer, 3 in. OD 1.0 in. ID

Submersible Pumps

06-AAA20390AA

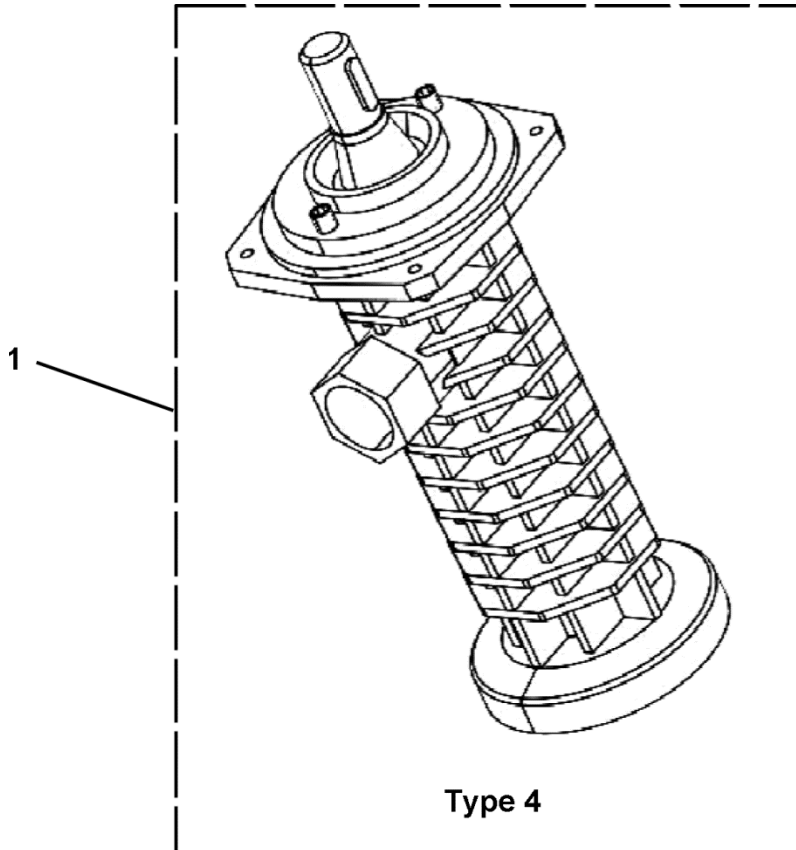

REF. No.	PART No.	MACHINE SIZE	PUMP GPM
1	6962Y26	5615S-5625S	56
	6962Y28	6525S	65
	6962Y27	7515S-7530S	75
	6962Y21	9420S-9430S	94
	6962Y22	12020S-12040S	120
	6962Y23	14020S-14040S	140
*	AAA27076AX20	Screen, Inlet	

*Part not shown.

Submersible Motor

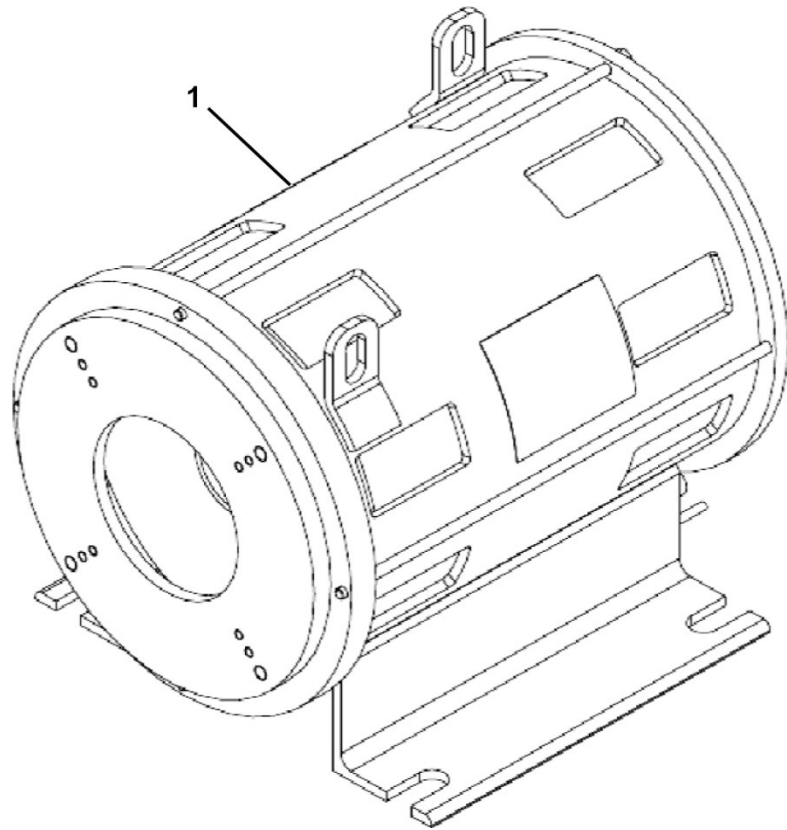

Type 6333DD

REF NO.	MACHINE SIZE	MOTOR VOLTAGE			MOTOR HP
		200 V	230/460 V	575 V	
1	5615S	6333DD1	6333DD21	6333DD4	15
	5620S-17020S	6333DD5	6333DD22	6333DD8	20
	5625S-17025S	6333DD9	6333DD23	6333DD12	25
	7530S-17030S	6333DD13	6333DD24	6333DD16	30
	7540S-17040S	6333DD17	6333DD25	6333DD20	40

Hydraulic Control Valve

06-AAA20390AA

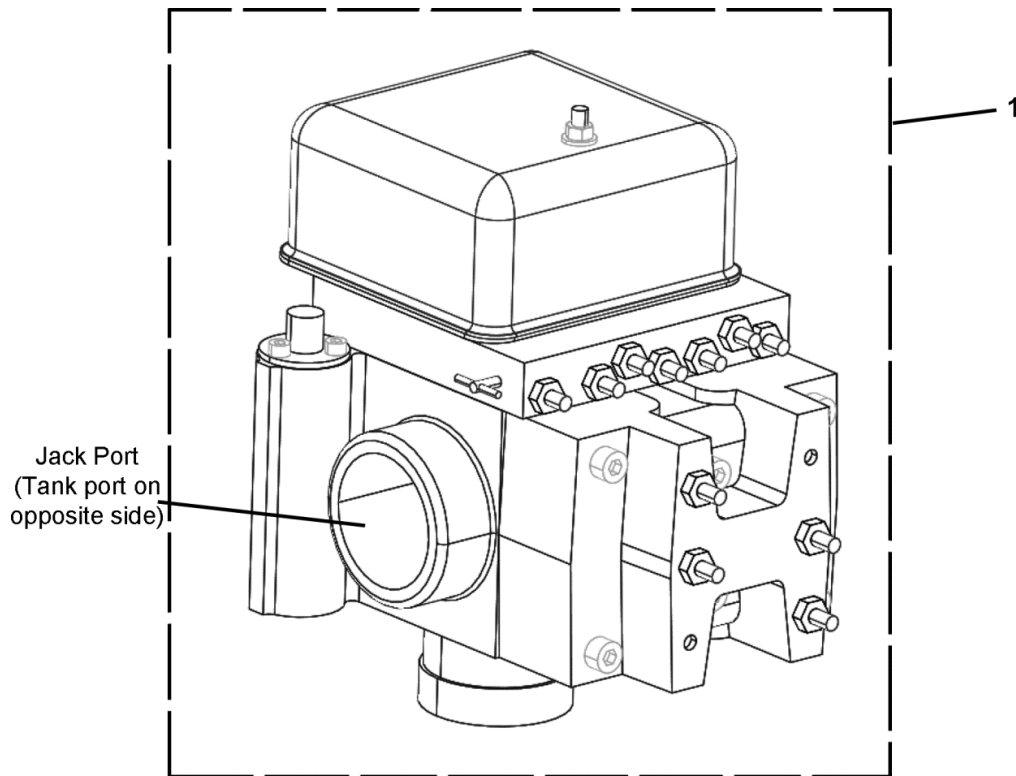

UC-4M Shown
(Tank and Jack Outlets
Opposite for UC-4)

REF. No.	PART No.	DESCRIPTION	MACHINE SIZE
1	271AP11	Maxton, UC-4M (E1) Pump Port, 2 in. Groove, Others 2 in. NPT, 115 VAC	5615S-5625S
	271AP14	Maxton, UC-4M (E1) Pump Port, 2 in. Groove, Others 2 in. NPT, 115 VDC	
	271AP17	Maxton, UC-4M (E1) Pump Port, 2 in. Groove, Others 2 in. NPT, 230 VAC	
	AAA271DL13	Maxton, UC-4 (E1) Pump Port, 2 in. Groove, Others 2 in. NPT, 115 VAC	
	AAA271DL10	Maxton, UC-4 (E1) Pump Port, 2 in. Groove, Others 2 in. NPT, 115 VDC	
	AAA271DL16	Maxton, UC-4 (E1) Pump Port, 2 in. Groove, Others 2 in. NPT, 230 VAC	
	271AP12	Maxton, UC-4M (E2) Pump Port, 2 in. Groove, Others 2 in. NPT, 115 VAC	7515S-9440S
	271AP15	Maxton, UC-4M (E2) Pump Port, 2 in. Groove, Others 2 in. NPT, 115 VDC	
	271AP18	Maxton, UC-4M (E2) Pump Port, 2 in. Groove, Others 2 in. NPT, 230 VAC	
	AAA271DL14	Maxton, UC-4 (E2) Pump Port, 2 in. Groove, Others 2 in. NPT, 115 VAC	
	AAA271DL11	Maxton, UC-4 (E2) Pump Port, 2 in. Groove, Others 2 in. NPT, 115 VDC	12020S-12040S
	AAA271DL17	Maxton, UC-4 (E2) Pump Port, 2 in. Groove, Others 2 in. NPT, 230 VAC	
	271AP13	Maxton, UC-4M (STD) Pump Port, 2 in. Groove, Others 2 in. NPT, 115 VAC	
	271AP16	Maxton, UC-4M (STD) Pump Port, 2 in. Groove, Others 2 in. NPT, 115 VDC	
	271AP19	Maxton, UC-4M (STD) Pump Port, 2 in. Groove, Others 2 in. NPT, 230 VAC	
	AAA271DL15	Maxton, UC-4 (STD) Pump Port, 2 in. Groove, Others 2 in. NPT, 115 VAC	
	AAA271DL12	Maxton, UC-4 (STD) Pump Port, 2 in. Groove, Others 2 in. NPT, 115 VDC	
	AAA271DL18	Maxton, UC-4 (STD) Pump Port, 2 in. Groove, Others 2 in. NPT, 230 VDC	

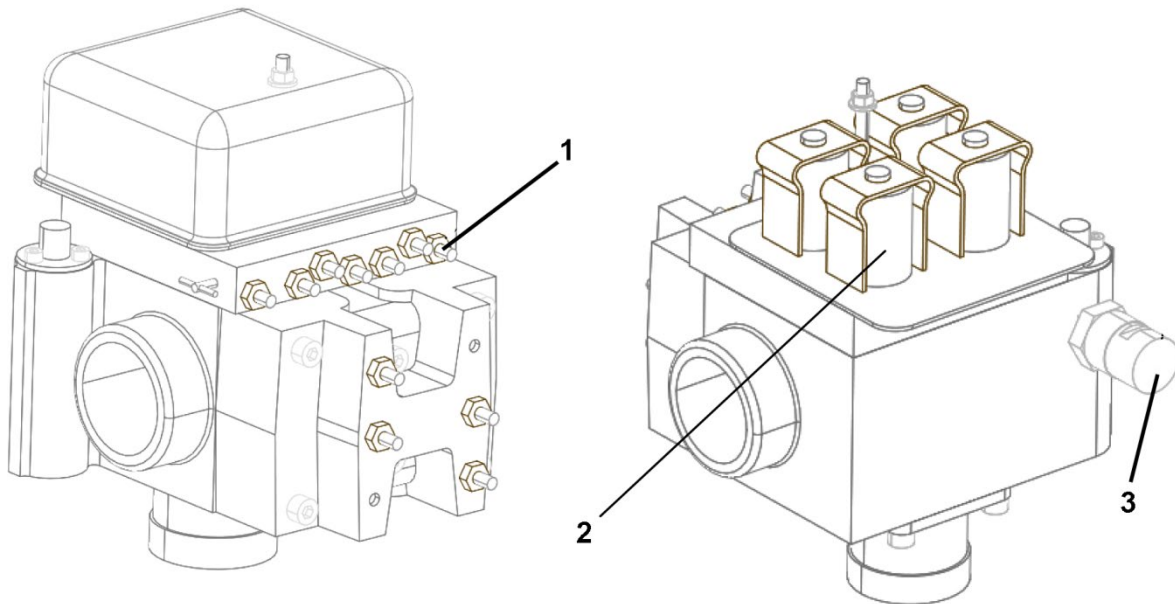

Shown w/o cover
for clarity

REF. No.	PART No.	DESCRIPTION
1	MAXT280070	Assembly, Adjuster Screw
2	MAXT208100	Coil, Individual, 115 VDC, Black
	MAXT208200	Coil, Individual, 115 VAC / 24 VDC, Red
*	AAA20302A2	Kit, Seal
*	AAA20302A5	Kit, Solenoid
3	AAA20300L2	Valve, Mounted Low Pressure Switch

* Part not shown.

Sensor Tree

06-AAA20390AA

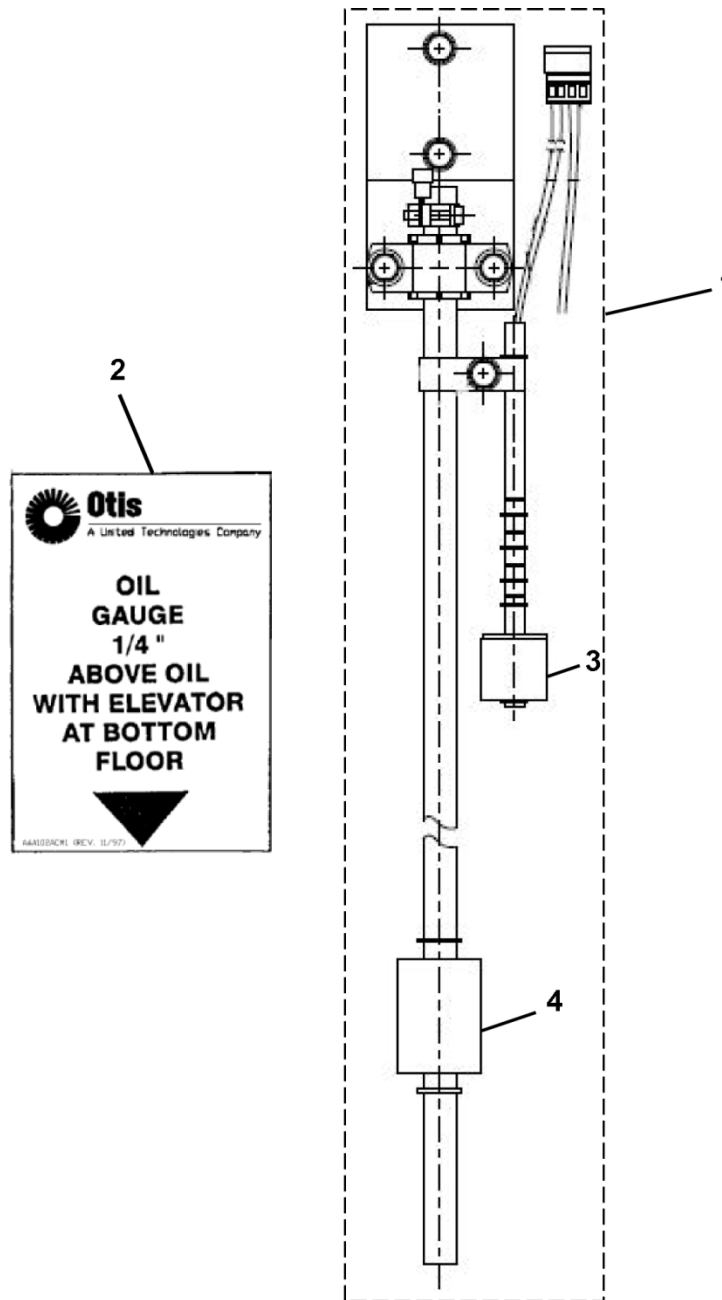

REF. No.	PART No.	DESCRIPTION
1	AAA20390Z3	Assembly, Hydraulic Sensor Tree
2	AAA102ACM1	Magnet, Oil Level Label,  TIP 12.2-3
3	AAA20390X1	Switch, Oil Level
4	AAA20390W3	Switch, Temperature

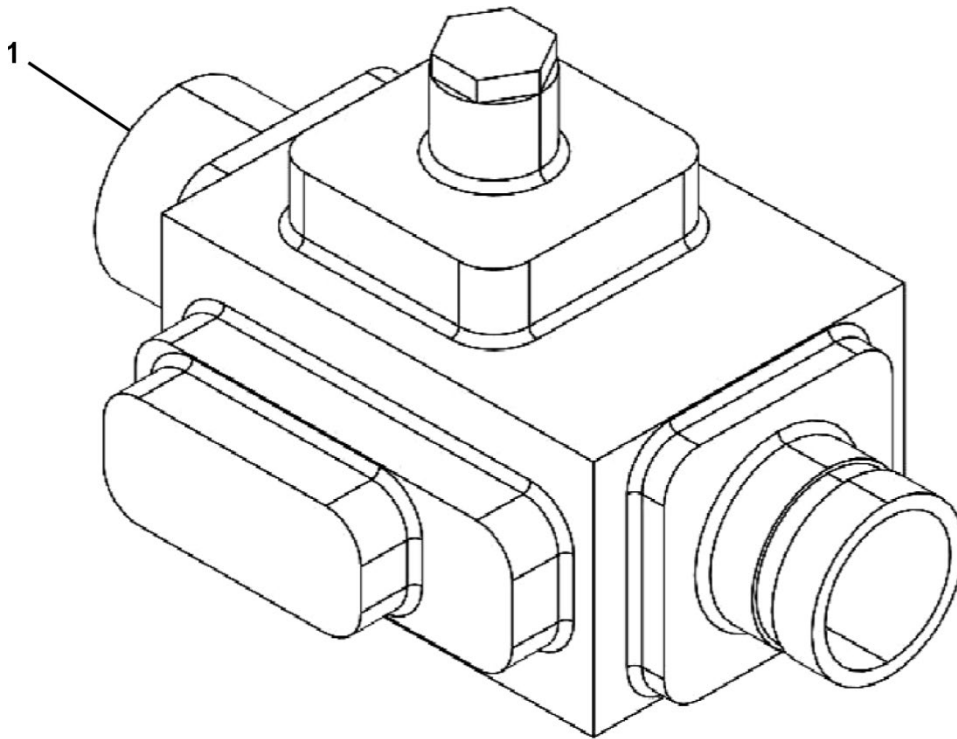

REF. No.	PART No.	DESCRIPTION
*	AAA20302A3	Seal Kit, Pipe Rupture Valve
1	AAA271DH3	Valve, Pipe Rupture, 2 in. Victaulic Ends, Less than 100 GPM
	AAA271DH1	Valve, Pipe Rupture, 2 in. Victaulic Ends, More than 100 GPM
	AAA271DH7	Valve, Pipe Rupture, 2 in. NPT One End, 2 in. Victaulic Other End, Less than 100 GPM (for Massachusetts)

* Part not shown

Hydraulic Piping Sundries

06-AAA20390AA

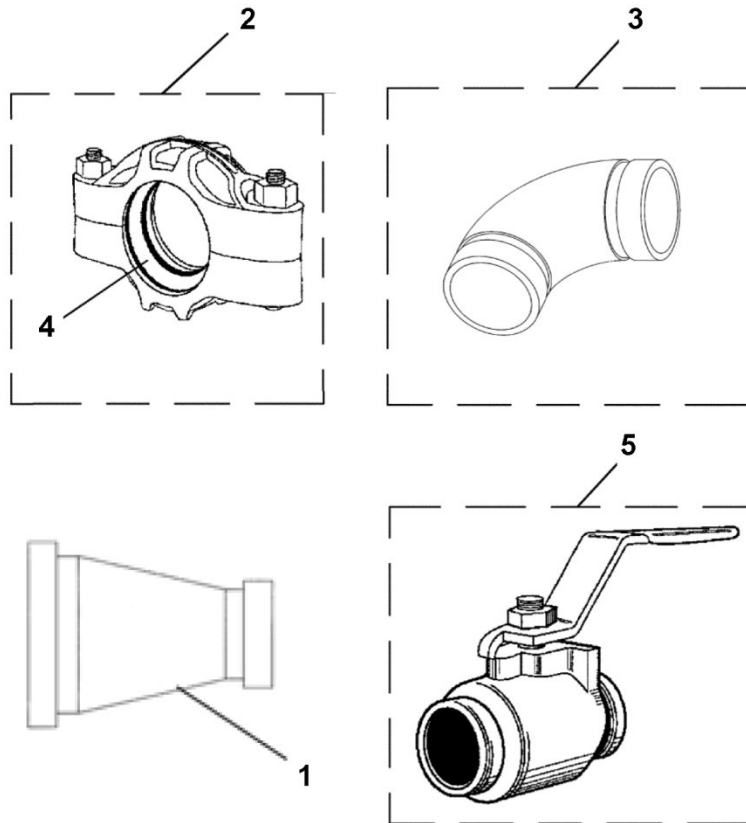

REF. No.	PART No.	DESCRIPTION
1	AAA00441AAB001	Coupling, Reducing, 2.5 in., 2 in., Victaulic Ends
2	441AS3	Coupling, Victaulic Style 77 STD, Size 2 in. (flexible)
	441AS4	Coupling, Victaulic Style 77 STD, Size 2.5 in. (flexible)
	441AS16	Coupling, Victaulic Style HP-07, Size 2 in. (rigid coupling)
3	441BC1	Elbow, 90°, 2 in. Pipe, Victaulic Grooved Ends
	441BC4	Elbow, 90°, 2.5 in. Pipe, Victaulic Grooved Ends
	377DJ9	Elbow, 90°, 2 in. Pipe, Street
4	AAA376GK3	Gasket, Victaulic, Size 2 in.
	AAA376GK4	Gasket, Victaulic, Size 2.5 in.
5	271AS6	Valve, Ball, Size 2 in., Victaulic Ends (working pressure < 1000 PSI)
	271AS7	Valve, Ball, Size 2-1/2 in., Victaulic Ends (working pressure < 1000 PSI)
*	VP-740650	Viclube, Gasket Lubricant, 4.5 oz. Tube

* Part not shown.