

NEXTSTEP™ Escalator Machine

Spare Parts Leaflet

06-GBA20401K

February 19, 2013 / Page 1 of 10

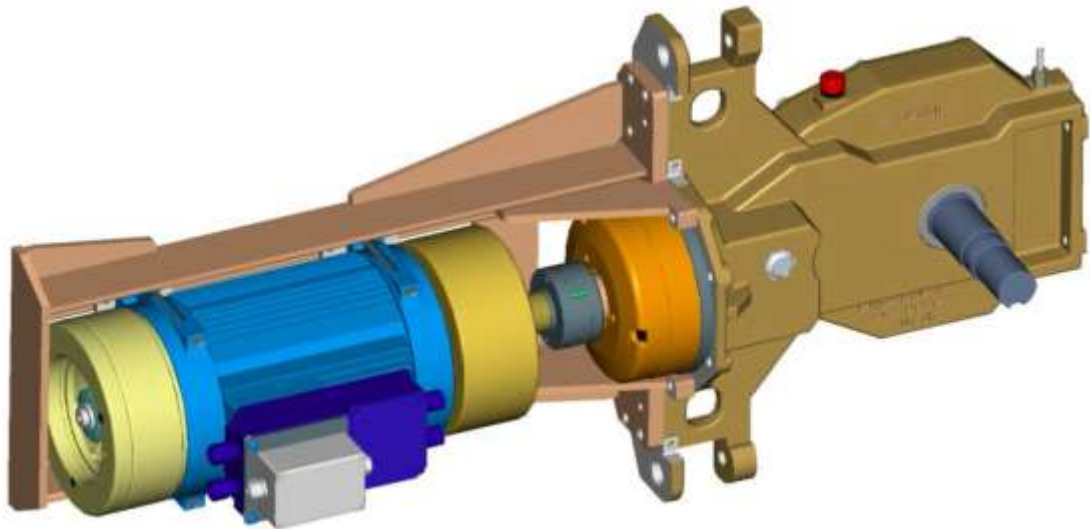

OTIS

SERVICE ENGINEERING
Otis Elevator Company
SIT GUANGZHOU

Unpublished Work—© Otis Elevator Co.; 2013

Leaflet Description

NEXTSTEP™ Machine

Leaflet Revisions

Date Revised	Subject Matter Expert	Reason for Revision
April 07, 2004	Chen, Zheng	Release
June 30, 2004	Chen, Zheng	Revised
Jan. 10, 2006	Chen, Zheng	LRUs of drive unit are separated; Gear Oil is added
Feb. 28, 2006	Chen, Zheng	OMS parts are renumbered by basic number + OMS number; Star coupling is added
April 03, 2007	Chen, Zheng	Changed '4C' to '6C' (REF. No. 21 – 32) on page 4, and revised part (Ref. No. 66) on page 6.
May 23, 2007	Chen, Zheng	Ref. No. 46 & 50 added on page 5; Claw flange & connecting shaft of star coupling deleted on page 6.
Nov. 14, 2007	Chen, Zheng	Parts (never delivered) deleted; Parts (Ref. No. 31 & 34 -51) added.
July 22, 2008	Chen, Zheng	Illustration of gear box 1.5 added on page 4; Repair tool DAA374CC1 added on page 6.
Feb 19, 2013	Liang, Jian	Page 10: add tooling GAA27HJ1 and its illustration.

Related Drawings

Drawing No.	Title	Drawing No.	Title
GBA20401K	Machine		

Related Documents

Document ID	Title
BOM GBA20401K	Machine

Subject Matter Expert

Name	Department
Chen, Zheng	SIT-GUANGZHOU

About Spare Parts Leaflets...

This document lists the lowest replaceable units (LRUs) for the standard version of the product. The LRUs are chosen by a team of Otis associates representing engineering and manufacturing.

While goal of this document is to make parts identification as easy as possible, the document cannot be all-inclusive. Elevator and escalator contracts classified as "special" or "custom" are not addressed here. For such contracts, please refer to specified information, the contract folder, TIPs, Field Education Articles, Construction Letters, etc. for further information.

If you have any suggestions about this document, please contact the subject matter expert listed on this page.

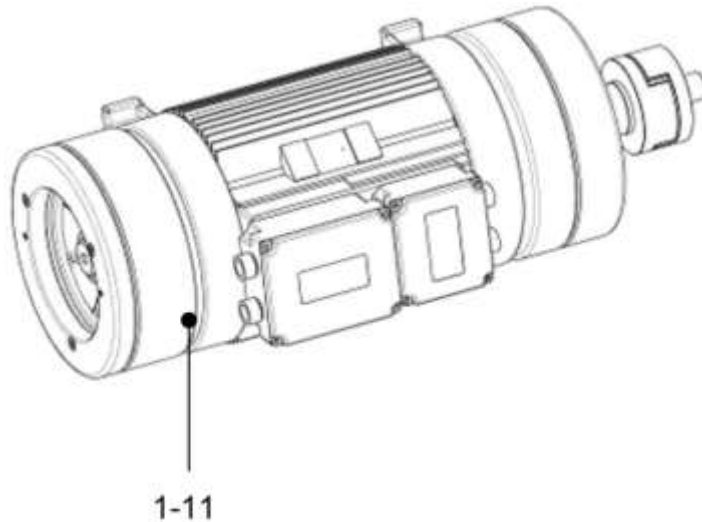

GBA20401K		
REF. No.	PART No.	DESCRIPTION
1	GBA20401K-30411066	Motor Type: AF 132M/4P-21H (5.5kW, 50Hz, 200-208V, upper)
2	GBA20401K-30410903	Motor Type: AF 132M/4P-21H (5.5kW, 50Hz, 380-415V, upper)
3	GBA20401K-30411075	Motor Type: AF 132M/4D-21H (8.0kW, 50Hz, 200-208V, upper)
4	GBA20401K-30410902	Motor type: AF 132M/4D-21H (8.0kW, 50Hz, 380-415V, upper)
5	GBA20401K-30410988	Motor Type: AF 132M/6C-21H (5.5kW, 60Hz, 200-208V, upper)
6	GBA20401K-30410926	Motor Type: AF 132M/6C-21H (5.5kW, 60Hz, 460-480V, upper)
7	GBA20401K-30411056	Motor Type: AF 132M/6C-21H (5.5kW, 60Hz, 575-600V, upper)
8	GBA20401K-30410925	Motor Type: AF 132M/6D-21H (7.6kW, 60Hz, 200-208V, upper)
9	GBA20401K-30410921	Motor Type: AF 132M/6D-21H (7.6kW, 60Hz, 460-480V, upper)
10	GBA20401K-30411064	Motor Type: AF 132M/6D-21H (7.6kW, 60Hz, 575-600V, upper)
11	GBA20401K-30410906	Motor Type: AF, 8 KW, 50Hz, 380-415

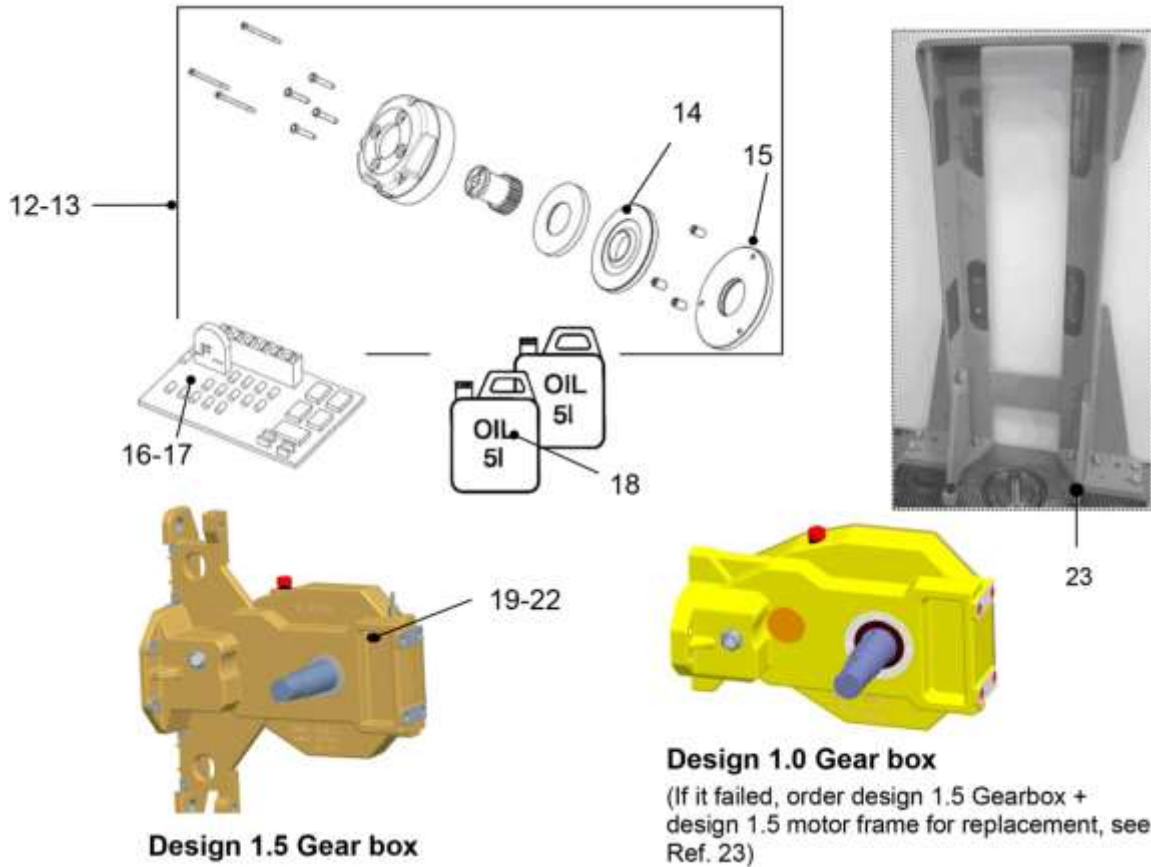

GBA20401K		
REF. No.	PART No.	DESCRIPTION
12	GBA20401K-30140014	Brake System 1-Circuit M150 (Mayr)
13	GBA20401K-30140019	Brake System Double Circuit M110 (Mayr)
14	GBA20401K-30140023	Rotor for Brake M150 (Mayr)
15	GBA20401K-30140022	Flange Plate for Brake M150 (Mayr)
16	GBA20401K-30350013	Board with over Excitation (single)
17	GBA20401K-30350014	Board with over Excitation (double)
18	GBA20401K-60200015	Gear Oil, Klüber Syntheso D220 EP, 5 L Container
19	GBA20401K-80010041	Gear Box, 50Hz, Upper
20	GBA20401K-80010042	Gear Box, 50Hz, Lower
21	GBA20401K-80010043	Gear Box, 60Hz, Upper
22	GBA20401K-80010044	Gear Box, 60Hz, Lower
23	GBA20401K-13140022	Motor Frame, Design 1.5 (if gearbox design 1.0 failed, this frame required)

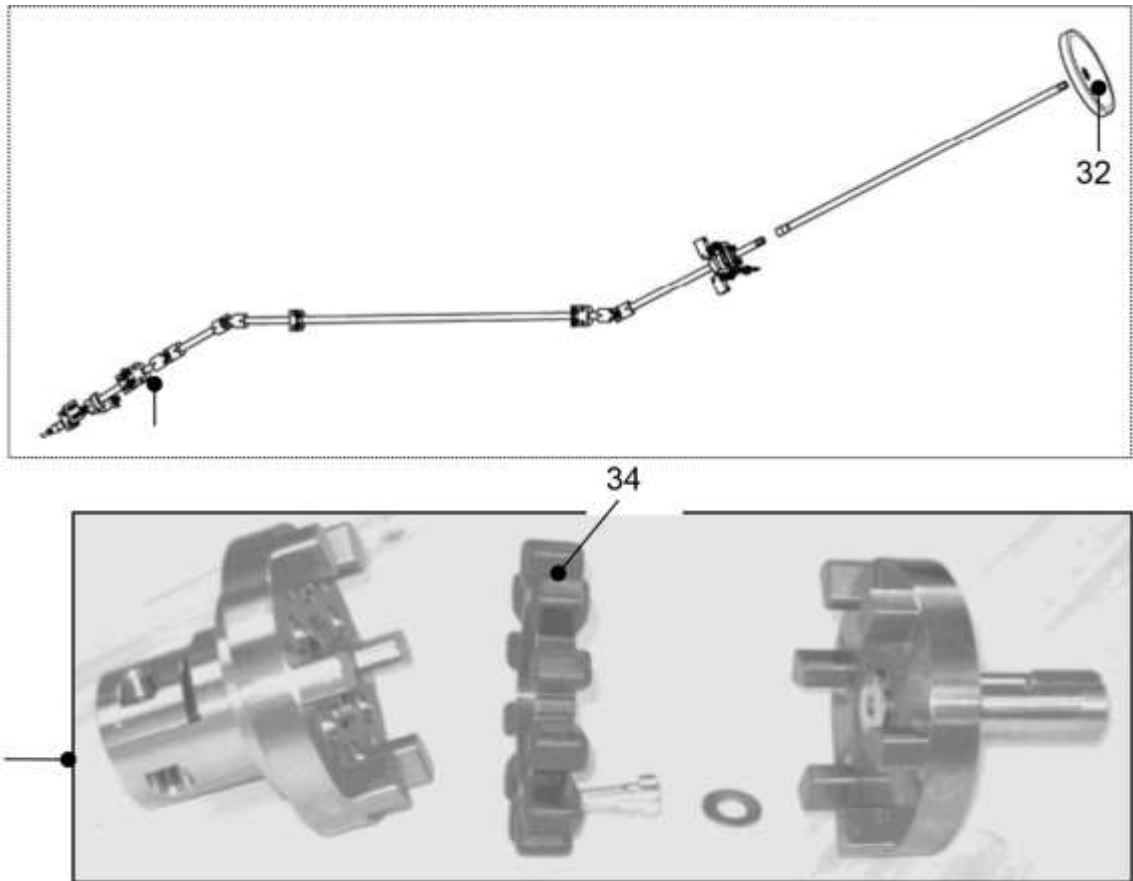

GBA20401K		
REF. No.	PART No.	DESCRIPTION
24	GAA26220BY1	Hand Winding Device, 2 Flat Steps, One Machine, 30° inclination
25	GAA26220BY2	Hand Winding Device, 2 Flat Steps, Two Machine, 30° inclination
26	GAA26220BY3	Hand Winding Device, 3 Flat Steps, One Machine, 30° inclination
27	GAA26220BY4	Hand Winding Device, 3 Flat Steps, Two Machine, 30° inclination
28	GAA26220BY5	Hand Winding Device, 2 Flat Steps, One Machine, 35° inclination
29	GAA26220BY6	Hand Winding Device, 2 Flat Steps, Two Machine, 35° inclination
30	GAA26220BY7	Hand Winding Device, 3 Flat Steps, One Machine, 35° inclination
31	GAA26220BY8	Hand Winding Device, 3 Flat Steps, Two Machine, 35° inclination
32	GAA290DK1	Hand Wheel
33	GBA20401K-13020032	Star Coupling (with claw flanges)
34	GBA20401K-30110002	Coupling Buffer Ring

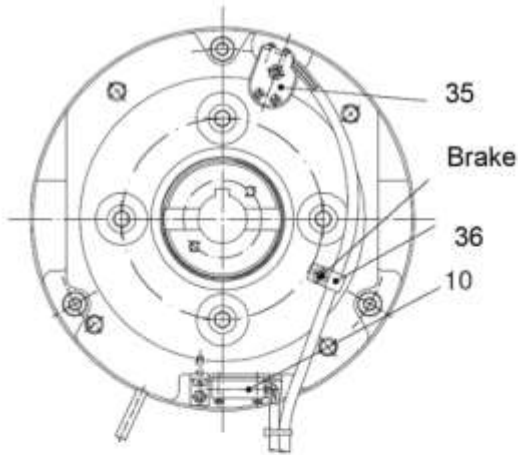

Consist of
 4x cylinder head screws M4x10
 4x cable clip 5mm
 4x cylinder head screws M4x6

37

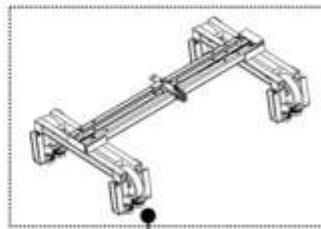
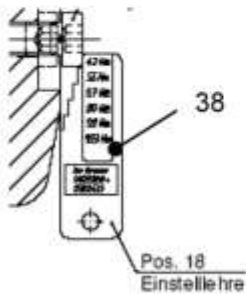

39

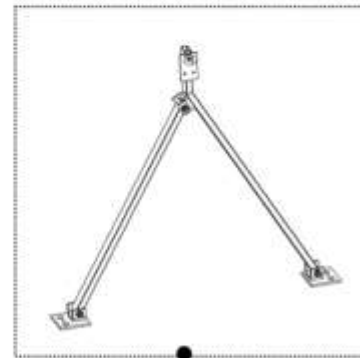

40

GBA20401K		
REF. No.	PART No.	DESCRIPTION
35	GBA20401K-30310080	Brake Function Switch (for M150)
36	GBA20401K-30310081	Brake Wear Switch (for M150)
37	GBA20401K-31360050	Mounting Set Magnetic Encoder
38	GBA20401K-0013155	Gauge for Adjustment of the Brake
39	DAA26220M01	Trolley, Repair Tool
40	DAA374CC1	Frame, Repair Tool

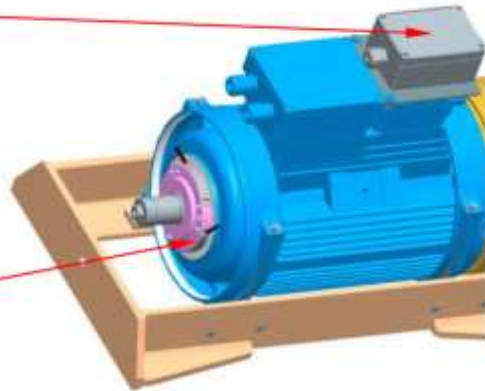
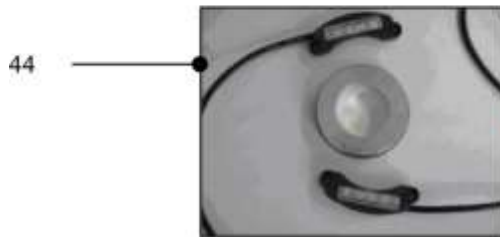
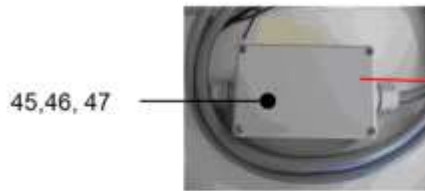
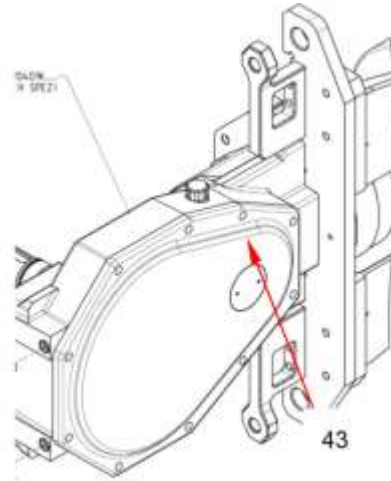
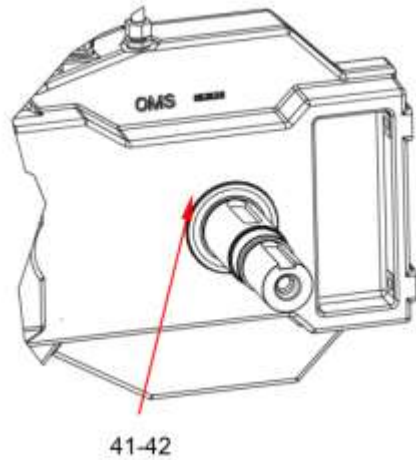

GBA20401K		
REF. No.	PART No.	DESCRIPTION
41	GBA20401K-00530001	Shaft Sealing Ring DIN3760 AS 65X90X10, Design 1.0
42	GBA20401K-00530059	Shaft Sealing Ring DIN 3760 AS 65X100X12, Design 1.5
43	GBA20401K-00550006	Screw Cap Diameter 45x7, Design 1.0
44	GBA20401K-30310070	Magnetic Encoder Type ITD67A4Y12 (1 set)
45	GBA20401K-30310074	Speed Interface Box (Include PCB for SIB)
46	GBA20401K-30350012	PCB for SIB
47	GBA20401K-13160049	Mounting Set SIB



48



49



50

GBA20401K		
REF. No.	PART No.	DESCRIPTION
48	GBA20401K-12020049	Replacement Set Hypoidpot
49	GBA20401K-29900097	Mounting Tool Disassemble Hypoidpot
50	GBA20401K-29900574	Mounting Tool Reassemble Hypoidpot

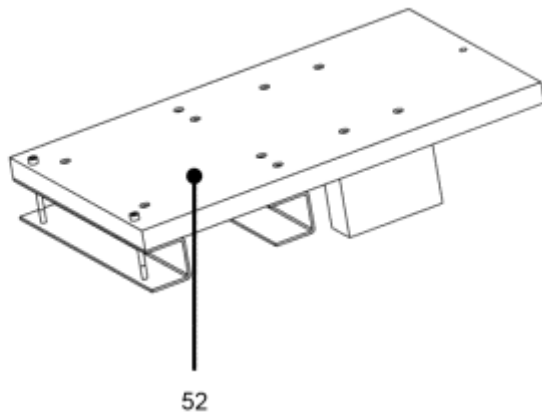
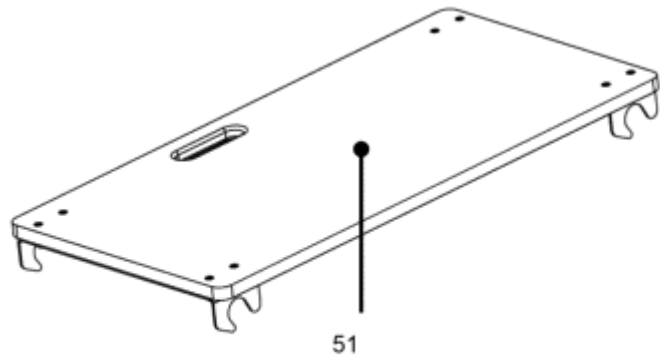

GBA20401K		
REF. No.	PART No.	DESCRIPTION
51	GAA27HK1	Walk Board
52	GAA105XQ1	Walk Board

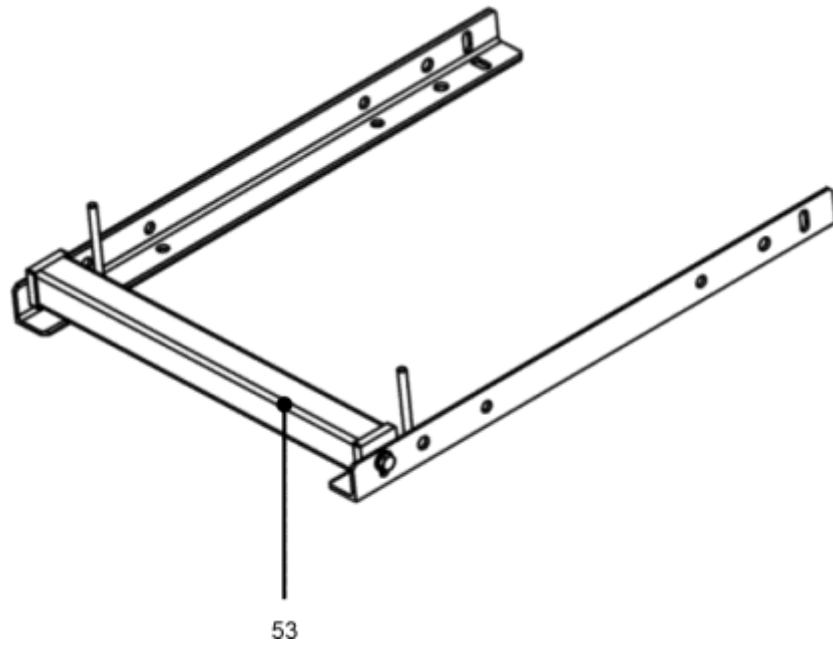

REF. No.	PART No.	DESCRIPTION
53	GAA27HJ1	Tooling: Motor Frame