

# Part Leaflet

MACHINE ESCAL/TOL  
CHAIN DRIVE

-----  
16 VEC

\* 06 GO 9514A-AH

June 1981

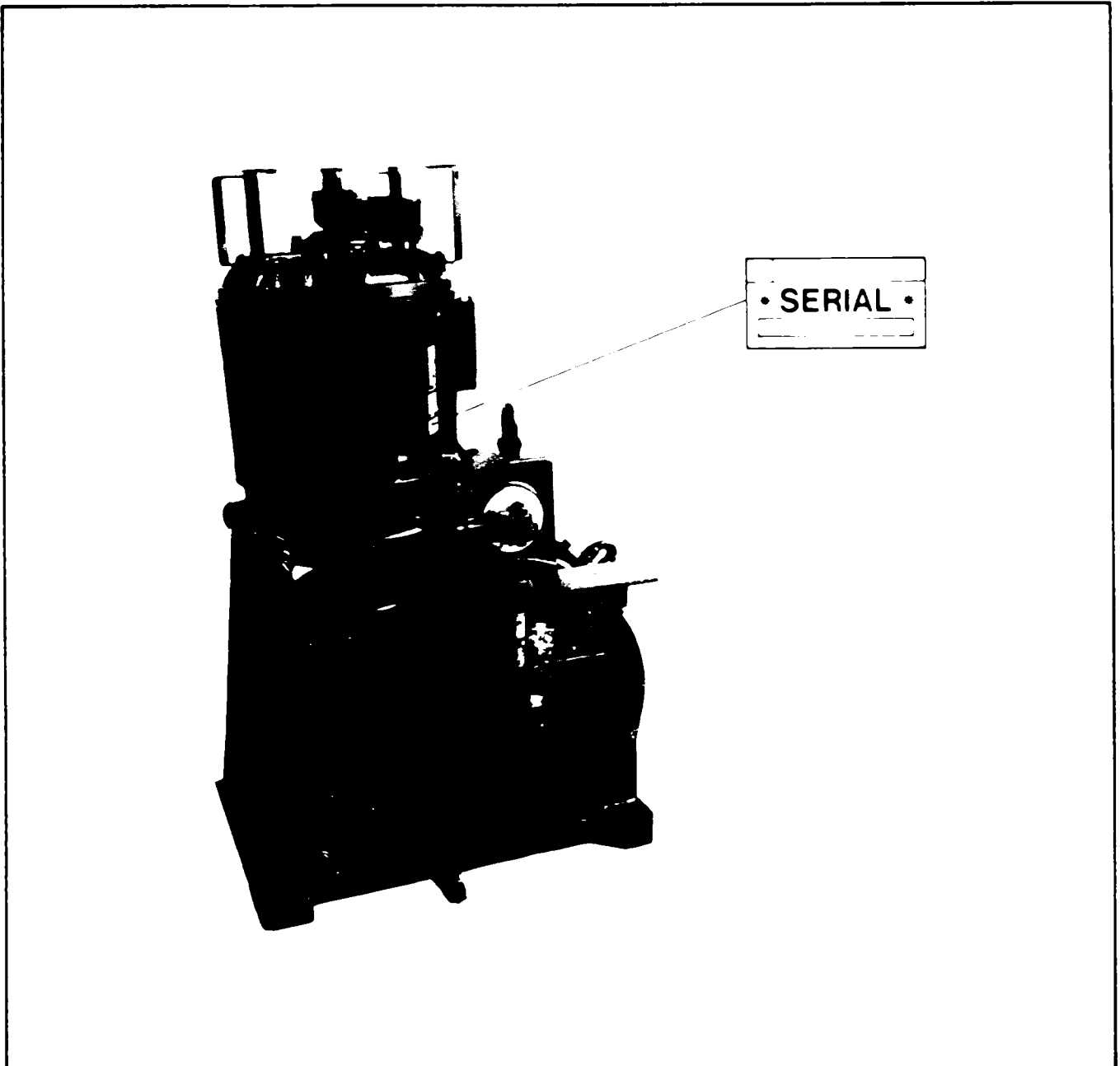

# OTIS

## 16 VEC Machine

To order a machine provide the following information  
 Renseignements à fournir pour commander une machine  
 Für die Bestellung einer Maschine werden folgende Angaben benötigt  
 Per ordinare una macchina fornire le seguenti informazioni  
 El pedido de un tractor debe incluir la siguiente información

Type of machine  
 Type de machine  
 Maschinen-Typ  
 Tipo di macchina  
 Tipo de tractor

Serial number  
 Numéro de série  
 Baunummer  
 Numero di serie  
 Numero de série

Contract number  
 Nombre de commande  
 Auftrags-Nummer  
 Numero di contratto  
 Numero de contrato

Type of motor  
 Type de moteur  
 Motor Typ  
 Tipo del motore  
 Tipo de motor

HP }  
 CV } or kW  
 PS }  
 HP }  
 CV }

Phases  
 Phases  
 Phasen  
 Fasi  
 Fases

Frequency  
 Frequence  
 Frequenz  
 Frequenza  
 Frecuencia

Volts  
 Volts  
 Volt  
 Volt  
 Volt

R. P. M.  
 Tours/min.  
 U/min.  
 Giri al minuto primo  
 R. P. M.

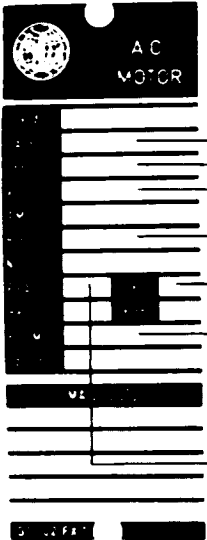
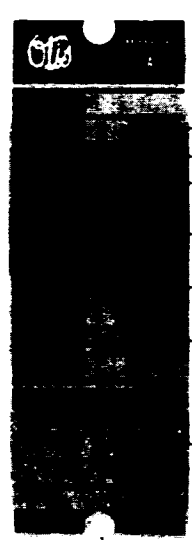
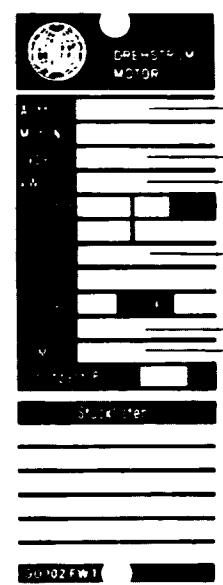
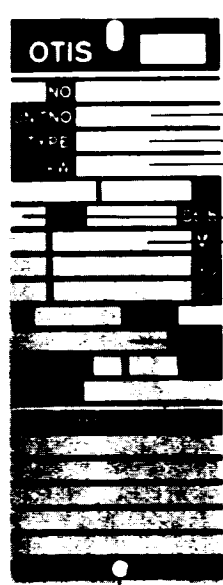
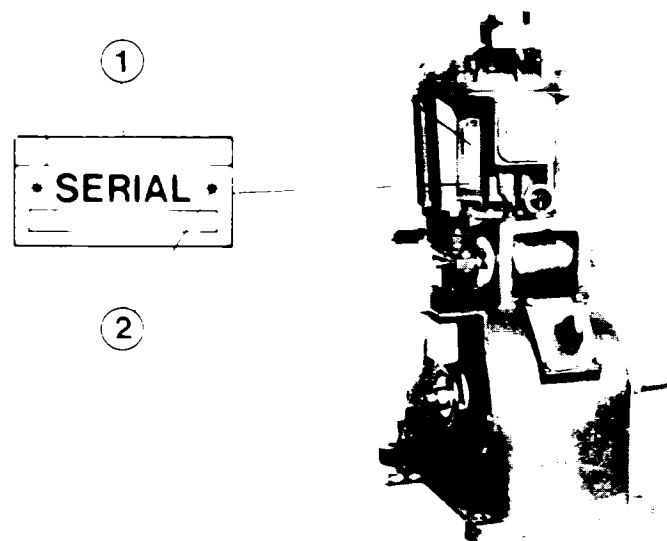
w/o Serial / Serial G. 01 & G. 02			Serial G. 03
Export Exportation Export Exportacion Exportazione	France France Frankreich Francia Francia	Germany Allemagne Deutschland Alemania Germania	
			
			

16 VEC Machine Brake

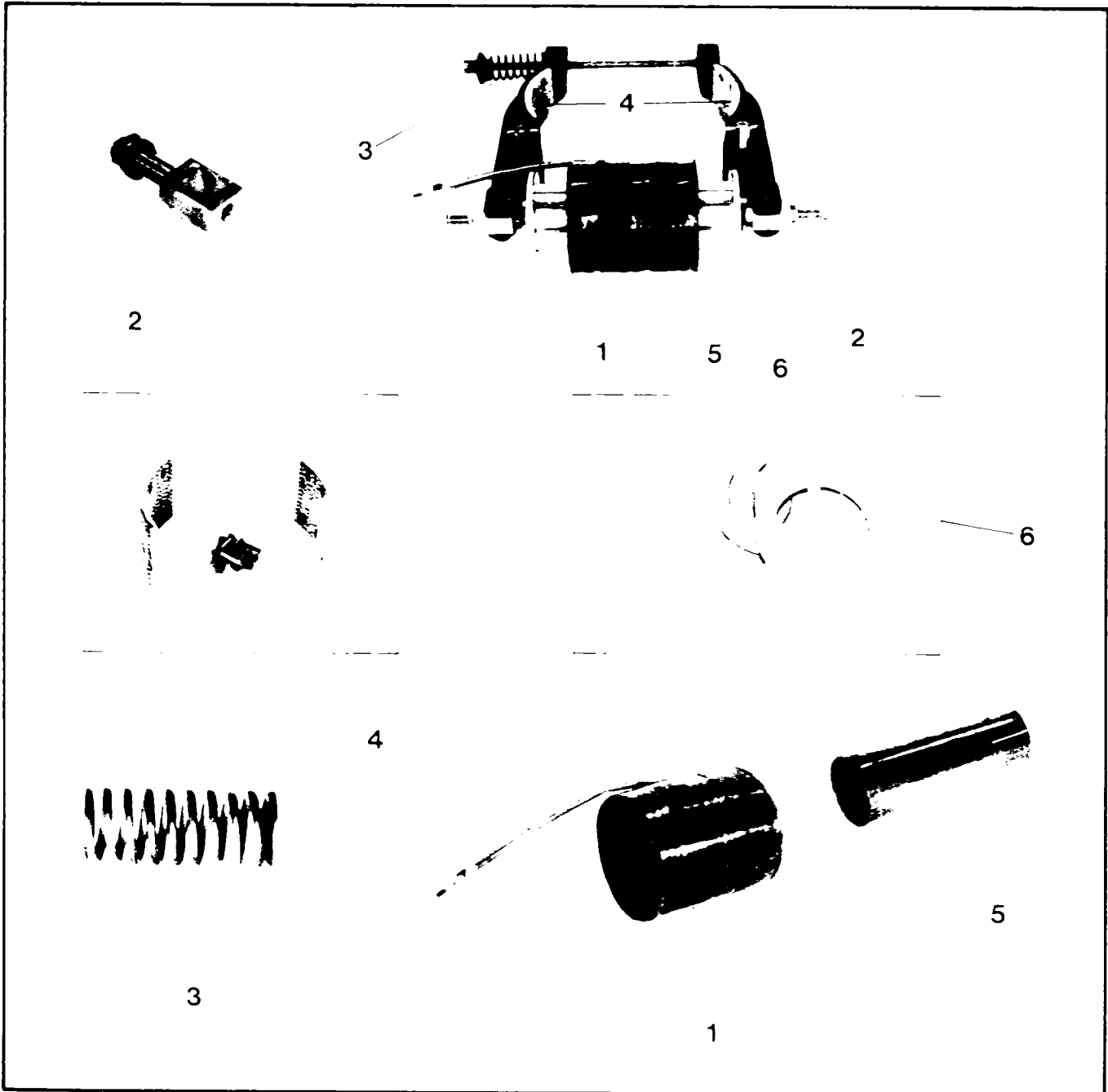

w/o Serial & Serial G.01 , G.02 & G.03

Ref. No.	Description	Type of Machine GO 9514... or 9514...	Part No.
1	Magnet coil	A, F, T, Y, AD, AF W, AA, AB, AE, AG, AH	GX 222 KA 505 ✱ SK-111-650 A.3 ✱
2	Flat bolt & spacer	A, F, T, W, Y, AA, AB, AD, AE, AF, AG, AH	GO 2500 BG 2
3	Spring	A, F	90 KC 4
4	Brake lining compl.	T, W, Y, AA, AB, AD, AE, AF, AG, AH	90 AE 1
5	Tube magnet core	A, F, T, W, Y, AA, AB, AD, AE, AF, AG, AH	GO 2002 J 1 136 R 12
6	Spacer set		GO 2215 AD 4

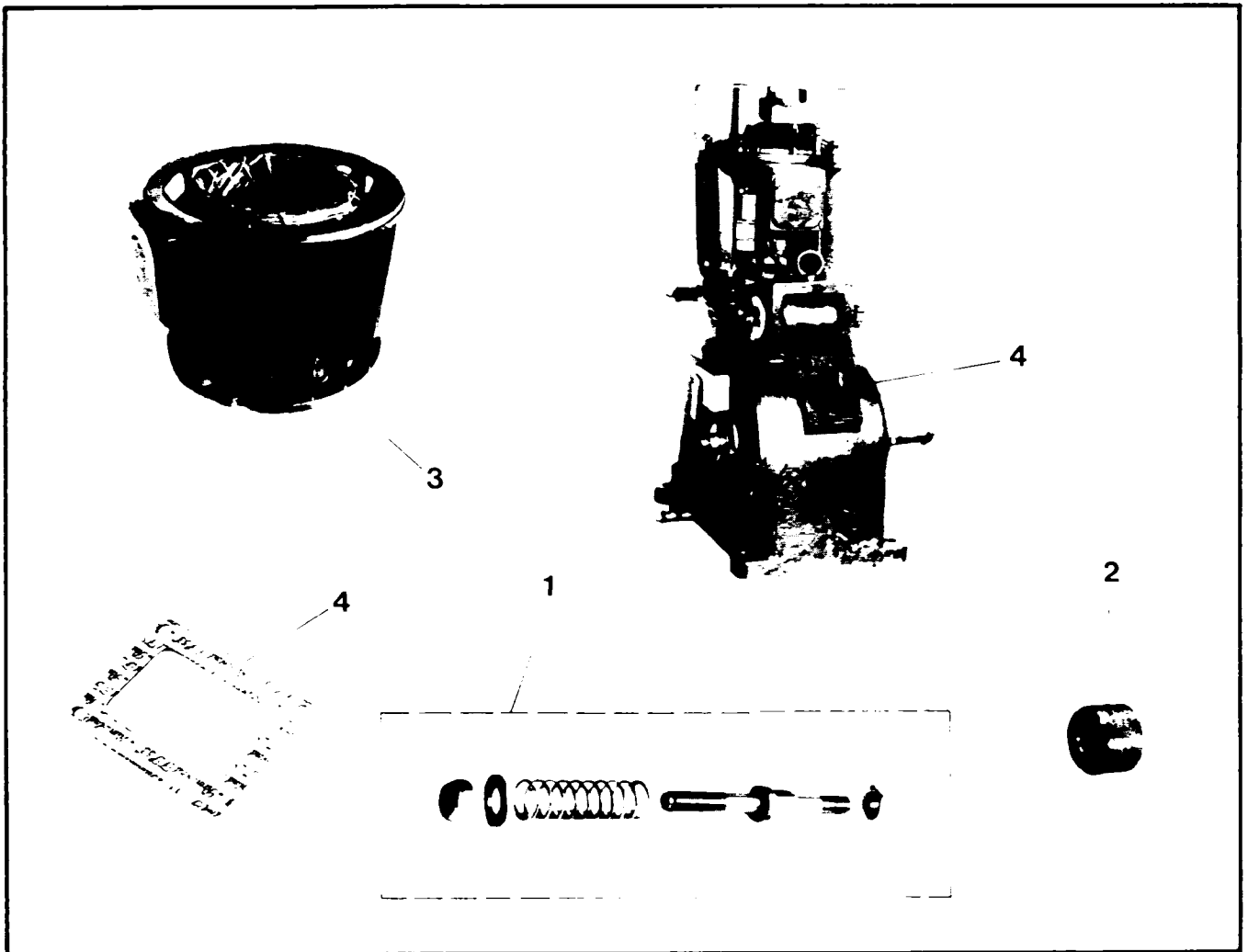

w/o Serial G.01, G.02, G.03		
Ref. No.	Description	Part or M.L.
1	Spring & ⌀ 1200 RPM	GO 2215 AD 37
	Spring & ⌀ 1500 RPM	GO 2215 AD 38
2	Test weight	GO 344 AP 1
3	Stator compl.	⊗ *
4	Gasket	376 BK 1

- Give information ③ on page 2, when ordering a stator.
- Pour commander un stator, donner l'information ③ de la page 2.
- \* < Wenn ein Stator bestellt wird, ist die Angabe ③ auf Seite 2 erforderlich.
- Al pedir un estator, dar información ③ de la página 2.
- Dare informazione ③ sulla pagina 2, quando si ordina uno statore.

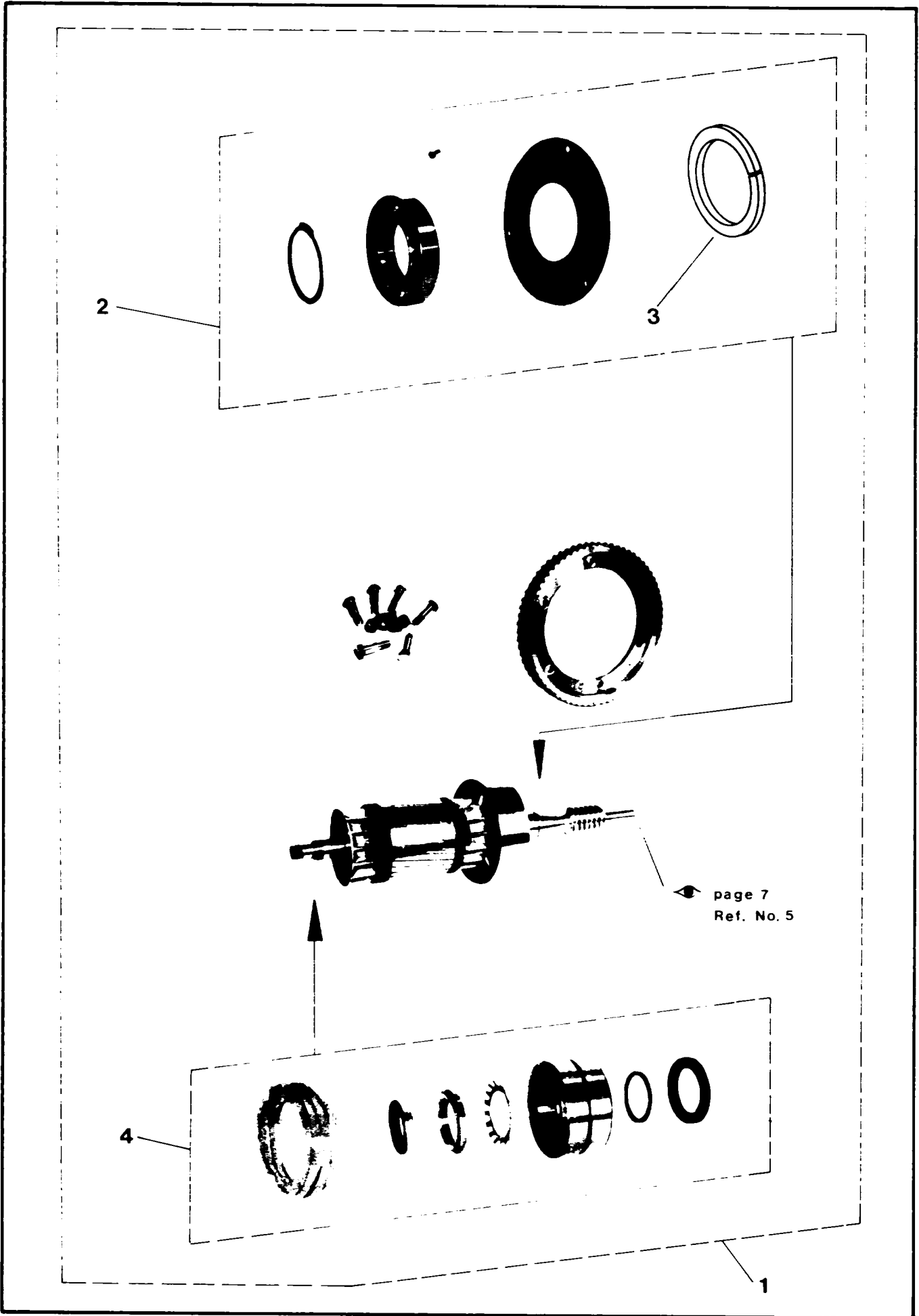

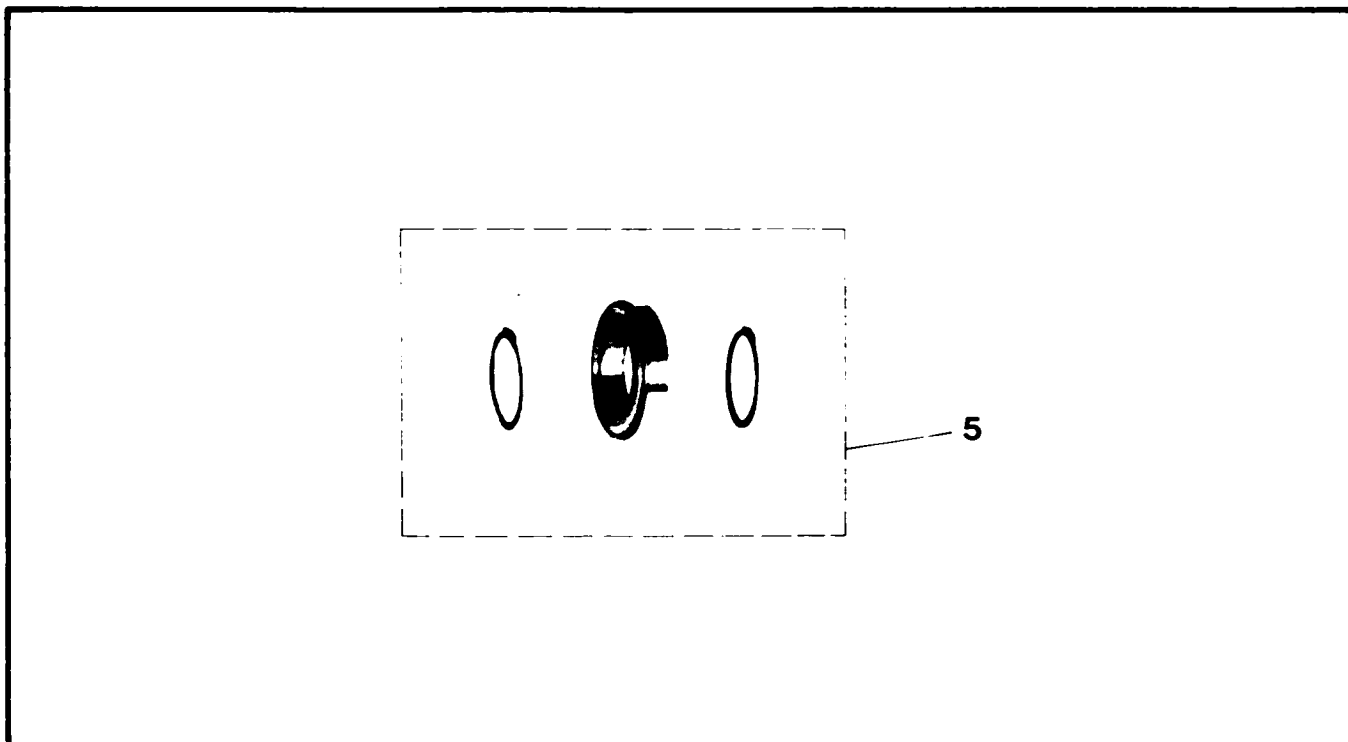

Ref. No.	Description	Serial		
		w/o	G.01	G.02
		Part or M.L.	Part or M.L.	Part or M.L.
1	Rotor compl. & worm gear	*	*	*
2	Bearing compl.	—	GO 2215 AD 5	GO 2215 AD 5
4	Bearing with shims		GO 2215 AD 7	

Serial G.03			
Ref. No.	Description	Type of Machine 9514...	Part or M.L.
1 & 5	Rotor compl. & worm gear	T, W, Y, AA, AB, AD, AE, AF, AG, AH	*
2	Bearing compl.	T, W, Y, AA, AB, AD, AE, AF, AG, AH	GO 2215 AD 5
3	Ring	AB, AH	GO 172 GS 1
4	Bearing with shims	T, W, AD, AE	GO 2215 AD 7
		Y, AA, AB, AF, AG, AH	GO 2500 BG 3
5	Bearing compl.	T, W, Y, AA, AB, AD, AE, AF, AG, AH	GO 2500 BG 4

Give information ③ on page 2 when ordering a rotor and a worm gear.  
 Pour commander un rotor et une vis sans fin, donner l'information ③ de la page 2.  
 \* < Wenn Rotor und Schneckenrad bestellt werden, ist die Angabe ③ auf Seite 2 erforderlich.  
 Al pedir un rotor con sinfin, dar información ③ de la página 2.  
 Dare informazione ③ a pagina 2, quando si ordina un rotore ed una vite senza fine.

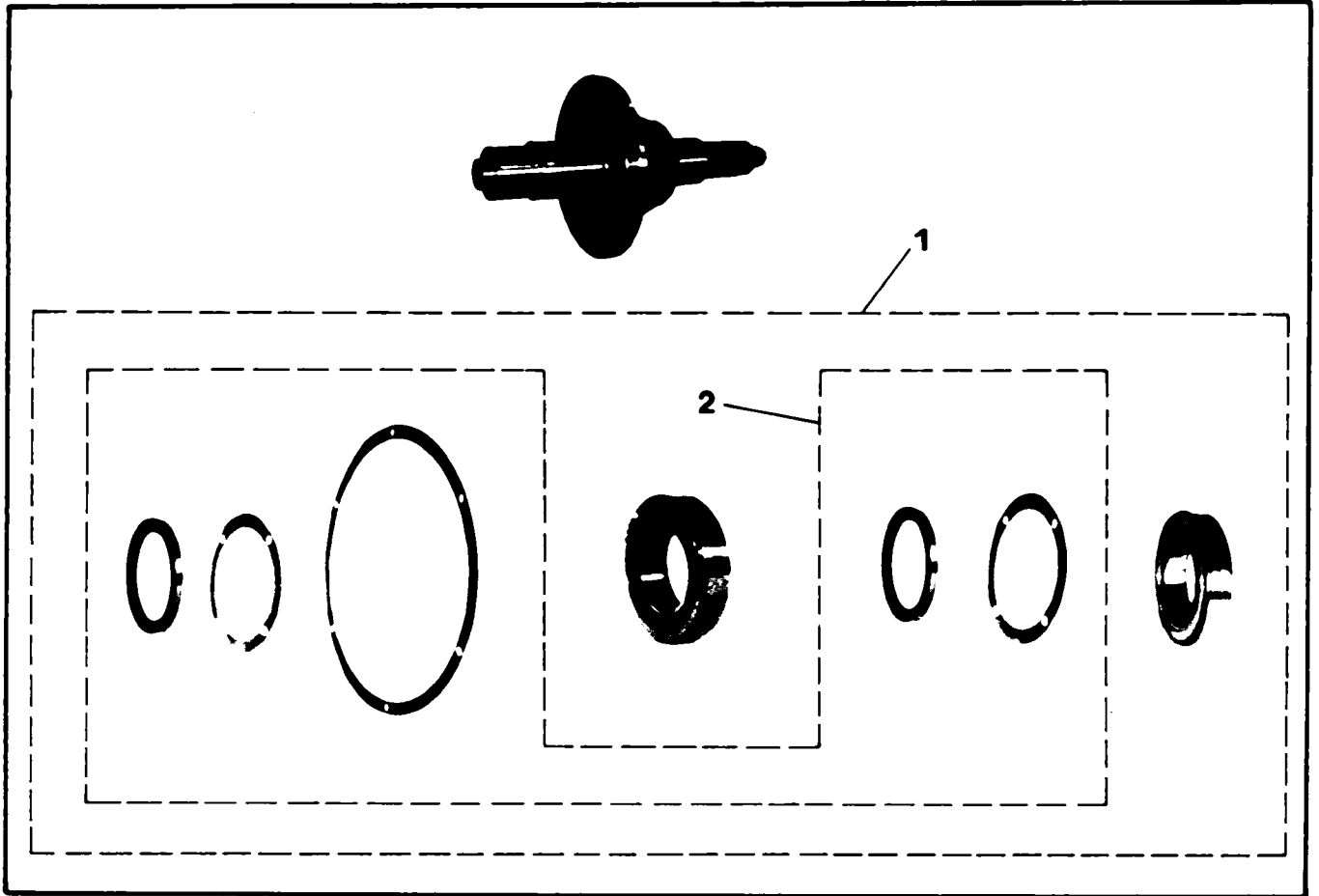

Ref. No.	Description	Serial			
		w/o, G.01, G.02	G.03		
			with Motor 2744	with Motor 3124	Dual Drive
Part or M. L.					
1	Bearings & shims & gaskets	GO 2215 AD 12	GO 2215 AD 12	GO 2500 BG 5	GO 2500 BG 7
2	Shims & gasket set	GO 2215 AD 14	GO 2215 AD 14	GO 2500 BG 10	GO 2500 BG 6
3	Coupling	-	-	-	GO 2500 BG 8

DUAL DRIVE

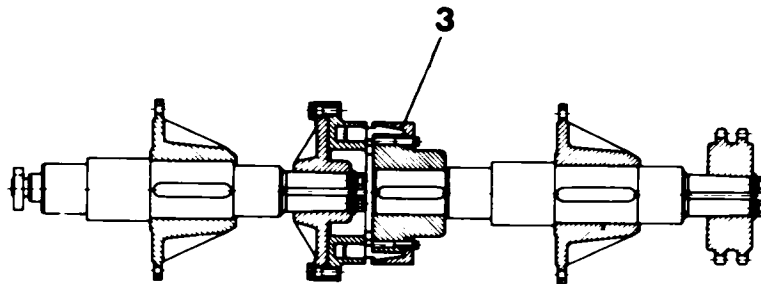



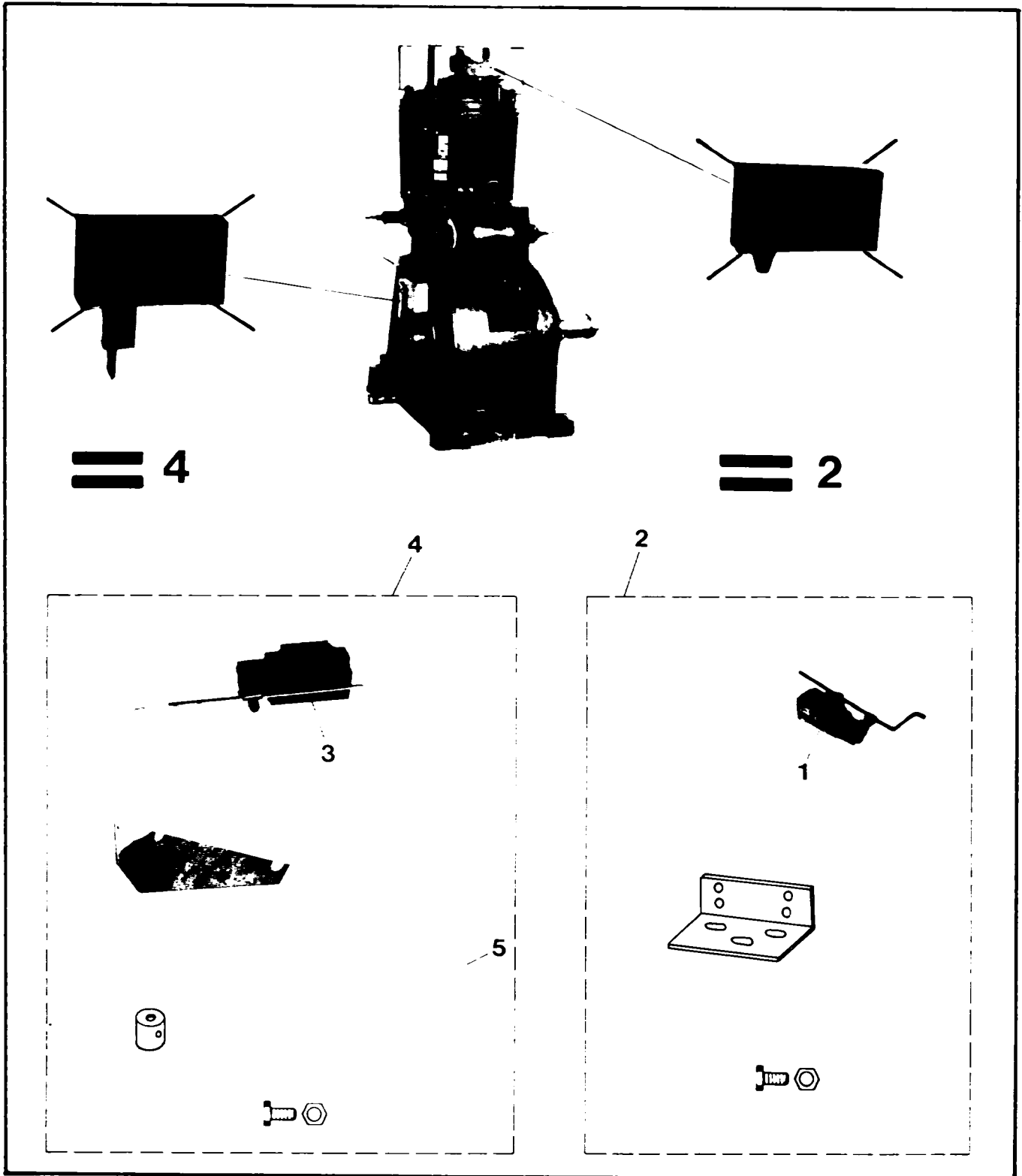

Serial w/o, G.01, G.02, G.03

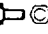
Ref. No.	Description	Type of Machine 9514 ...	Part or M.L.
1	Switch	A, F, T, W, Y, AA, AD, AE, AF, AG AB, AH	GO 177 AM 5 GO 177 AM 4
2	Switch & Angle & 	A, F, T, W, Y, AA, AD, AE, AF, AG AB, AH	GO 2022 R 1 * GO 2022 R 2 *
3	Switch		GO 177 BM 1
4	Switch & Dog & Fastening Parts		GO 2500 BG 11 *
5	Dog		GO 2500 AX 8

# 16 VEC Machine Drive Sprockets

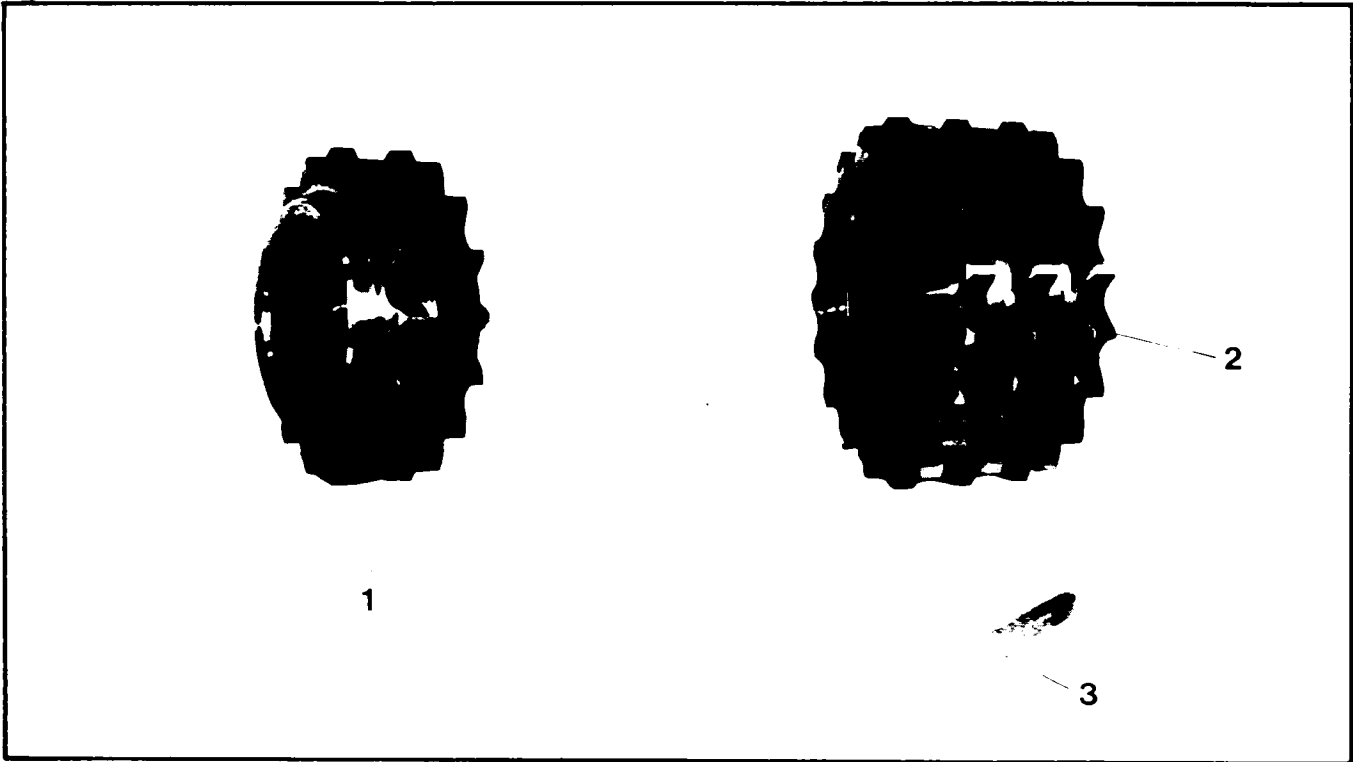

w/o Serial G.01, G.02, G.03		
Ref. No.	Description	Part or M.L.
1	Sprocket , 17 teeth	GO 195 HS 1
	Sprocket , 18 teeth	GO 195 HS 2
	Sprocket , 19 teeth	GO 195 HS 3
	Sprocket , 20 teeth	GO 195 HS 4
	Sprocket , 21 teeth	GO 195 HS 5
	Sprocket , 22 teeth	GO 195 HS 6
	Sprocket , 23 teeth	GO 195 HS 7
	Sprocket , 24 teeth	GO 195 HS 8
	Sprocket , 25 teeth	GO 195 HS 9
	Sprocket , 26 teeth	GO 195 HS 10
	Sprocket , 27 teeth	GO 195 HS 11
2	Sprocket , 17 teeth	GO 195 HR 1
	Sprocket , 18 teeth	GO 195 HR 2
	Sprocket , 19 teeth	GO 195 HR 3
	Sprocket , 20 teeth	GO 195 HR 4
	Sprocket , 21 teeth	GO 195 HR 5
	Sprocket , 22 teeth	GO 195 HR 6
	Sprocket , 23 teeth	GO 195 HR 7
	Sprocket , 24 teeth	GO 195 HR 8
	Sprocket , 25 teeth	GO 195 HR 9
	Sprocket , 26 teeth	GO 195 HR 10
	Sprocket , 27 teeth	GO 195 HR 11
3	Key	192 D 24