

# SPL 06-MC09710A - 15ATL Machine

Unpublished Work - © Otis Elevator Company. Any unauthorized reproduction, disclosure, or distribution of copies or content by any person of any portion of this work may be a violation of Copyright Law of the United States of America. All rights reserved.

April 1984

Page 1

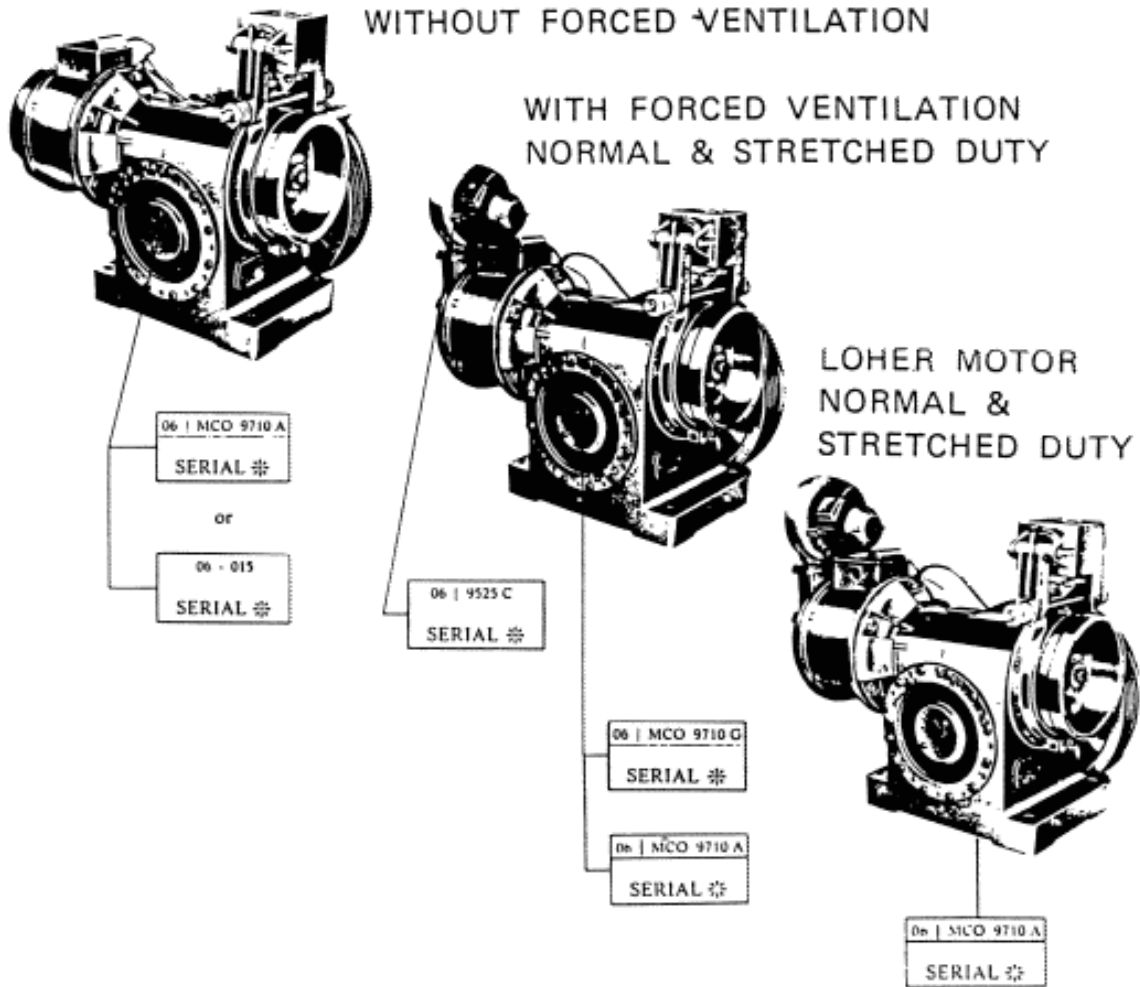

**SPL 06-MC09710A - 15ATL Machine**

**Page 2 - TYPE MC09710A 15ATL MACHINE**

CAUTION

THE COPPER ROTOR FOR 3146 MOTOR-4/16 POLES, IS NO MORE MANUFACTURED, IN CASE OF SUBSTITUTION OF THIS ROTOR, ORDER DIE-CAST ROTOR COMPLETE OF STATOR.

# SPL 06-MC09710A - 15ATL Machine

## Page 3

To order a machine provide the following information (without driving sheave)

Type of machine Type de machine Typ der Maschine Tipo della macchina Tipo de maquina	<b>15 ATL</b> ①	Flywheel Volant Schwungrad Volano Volante	⑩
Serial number Numéro de série Baunummer Numero di serie Número de série	②	Material lists Liste matériels Stücklisten Liste materiali Listas de materiales	⑪
Type of motor Type de moteur Motor Typ Tipo del motore Tipo de motor	③		
Machine ratio Reduclón machine Übersetzung Rapporto Reduccion	④		
HP CV PS HP CV	⑤		
Phases Phases Phasen Fasi Fases	⑥		
Frequency Frequence Frequenz Frequenza Frecuencia	⑦		
Volts Volts Volt Volt Volt	⑧		
R.P.M. Tours/min. U/min. Giri al minuto primo R.P.M.	⑨		

# SPL 06-MC09710A - 15ATL Machine

Page 4

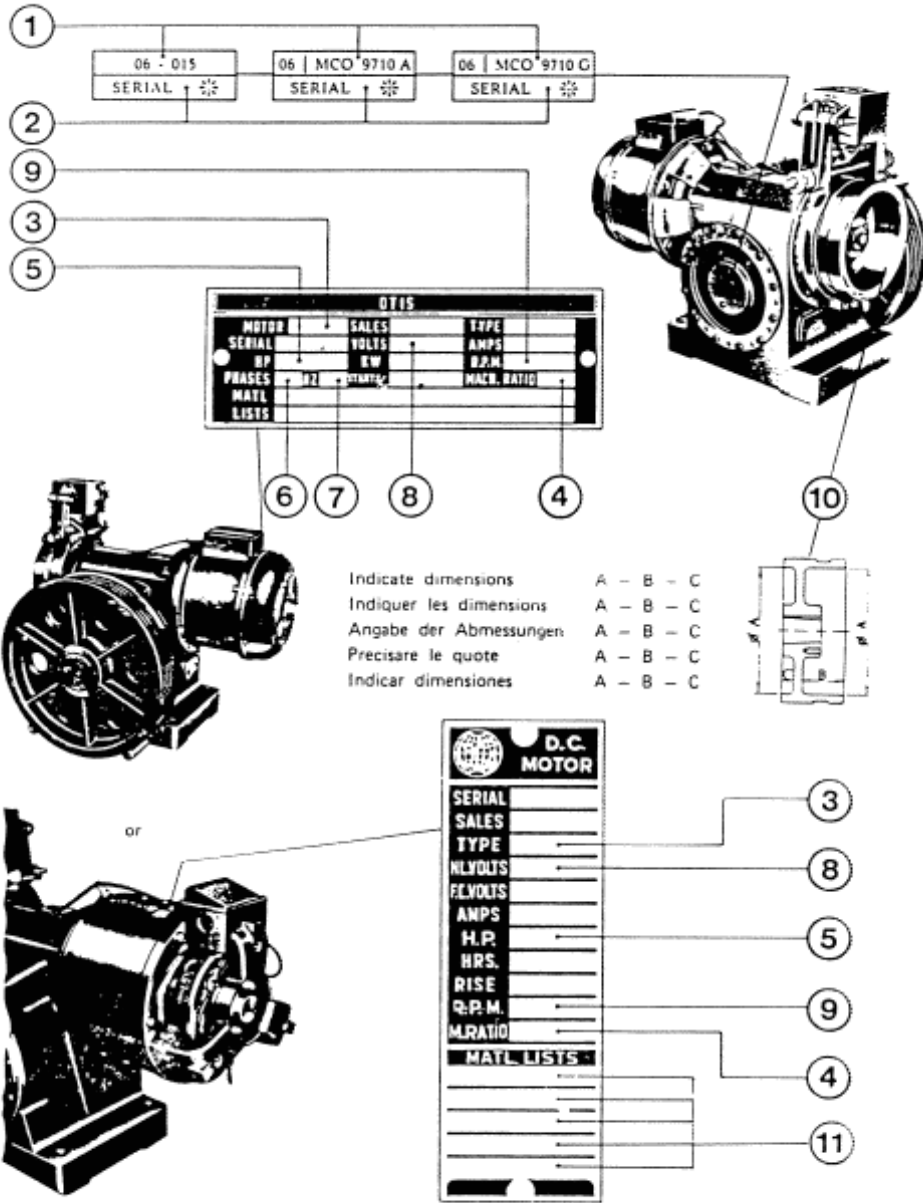

SERIAL M.01 - M.02 - M.03 - M.04

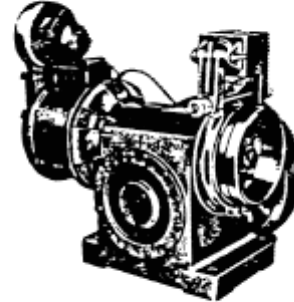
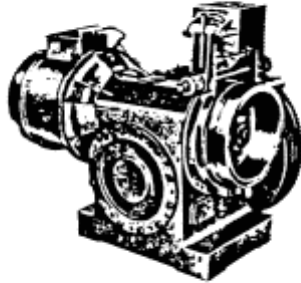

GEAR REDUCTION UNIT

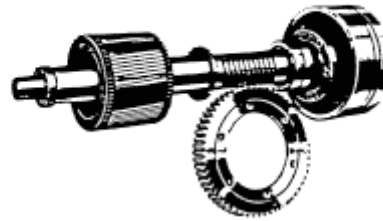
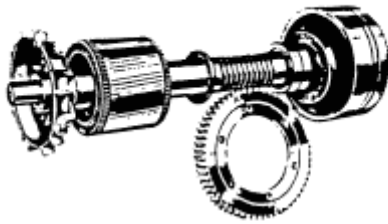

ALTERNATING CURRENT

To order a "gear reduction unit" the information of ① to ⑪ on page 3 is required.  
Pour commander un "couple" les informations ① à ⑪ de la page 3 sont nécessaires.  
Für die Bestellung eines "Getriebes" werden die Angaben ① - ⑪ auf Seite 3 benötigt.  
Per ordinare un "gruppo riduttore" sono necessarie le informazioni da ① a ⑪ alla pagina 3.  
Para pedir un "reductor" se necesita la informacion de ① a ⑪ en la pagina 3.

DIRECT CURRENT

To order a "gear reduction unit" <img alt="arrow" data-bbox="408 681 425 691"/> Part Leaflet 08 MC09710D - 66G MOTOR  
Pour commander un "couple" <img alt="arrow" data-bbox="391 693 408 703"/> Part Leaflet 08 MC09710D - 66G MOTOR  
Für die Bestellung eines Getriebes <img alt="arrow" data-bbox="414 705 431 715"/> Part Leaflet 08 MC09610D - 66G MOTOR  
Per ordinare un "gruppo riduttore" <img alt="arrow" data-bbox="414 717 431 727"/> Part Leaflet 08 MC09710D - MOTORE 66G  
Para pedir un reductor <img alt="arrow" data-bbox="348 729 365 739"/> Part Leaflet 08 MC09710D del MOTOR 66G

SPL 06-MC09710A - 15ATL Machine

Page 6 - TYPE MC09710A - 15ATL MACHINE - SPARE PARTS

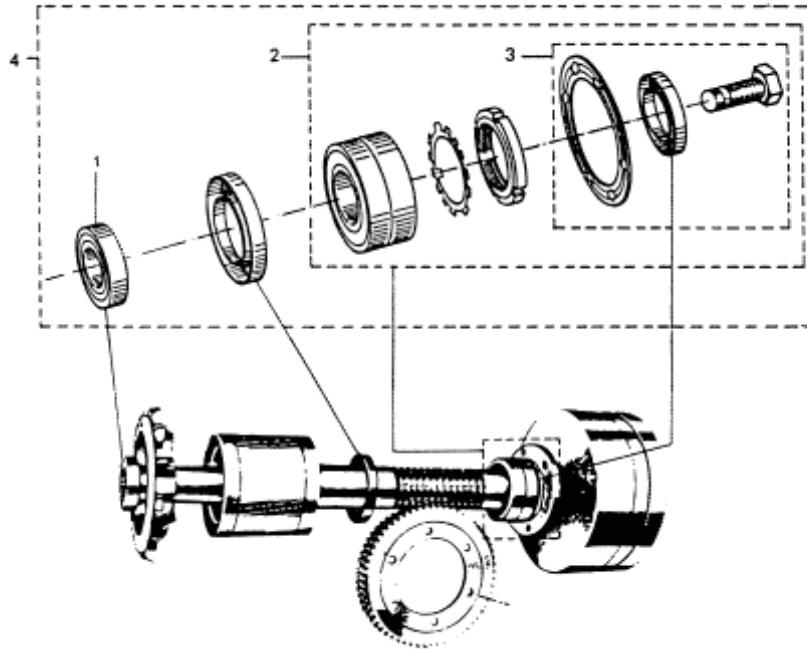

SERIAL M.01 - M.02 - M.03 - M.04		
Ref. N.	PART or ML	DESCRIPTION
1	MCO207A3	Ball bearing, motor end
2	MCO2000F1	Double thrust bearing + Gasket + Washer + Hardware for fastening
3	M02000F2	Gasket + Hardware for fastening
4	M02000F3	Bearing and gaskets

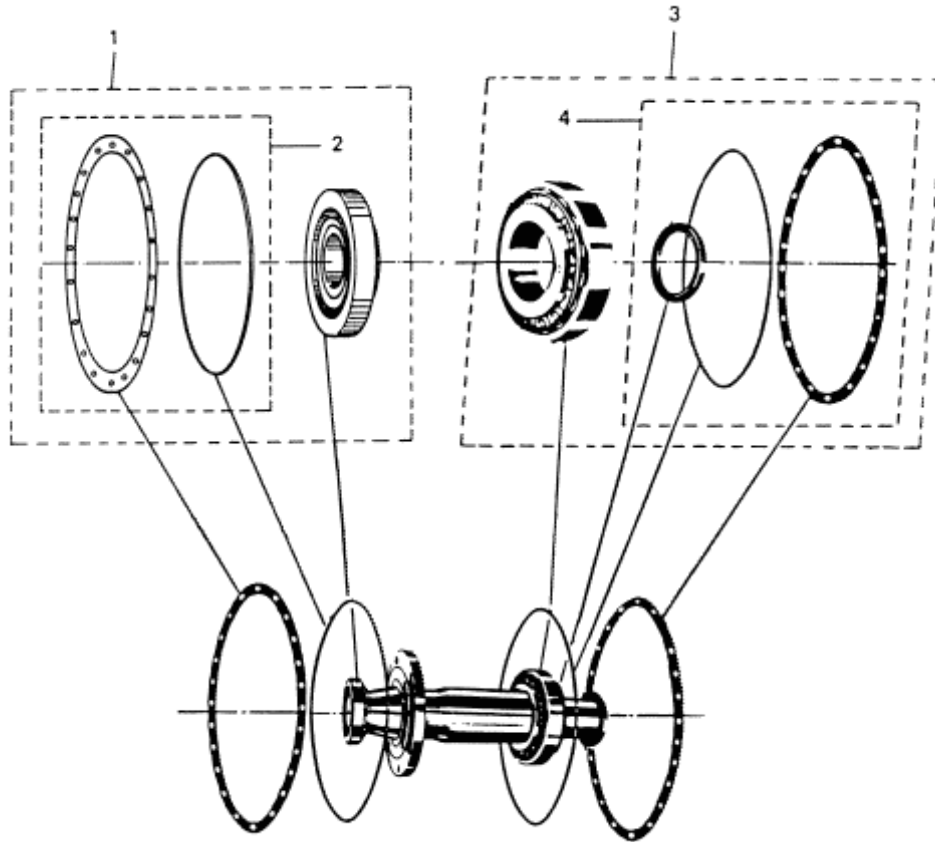

SERIAL M.01 - M.02 - M.03 - M.04		
Ref. N.	PART or ML	DESCRIPTION
1	M02000F4	Gaskets + O - Ring + Bearing
2	M02000F5	Gaskets + O - Ring
3	M02000F6	Gaskets + O - Ring + Oil seal + Bearing
4	M02000F7	Gaskets + O - Ring + Oil seal

# SPL 06-MC09710A - 15ATL Machine

## Page 8 - TYPE MC09710A 15ATL MACHINE WITHOUT FORCED VENTILATION

### SERIAL M.01

Serial M.01 differs from serial M.02 for the following parts  
Les pieces serial M.01 differentes des pieces serial M.02 sont les suivantes  
Serie M.01 unterscheidet sich von Serie M.02 durch folgende Teile  
Serie M.01 differisce dalla serie M.02 per i seguenti pezzi  
Serial M.01 se diferencia del serial M.02 en las siguientes partes

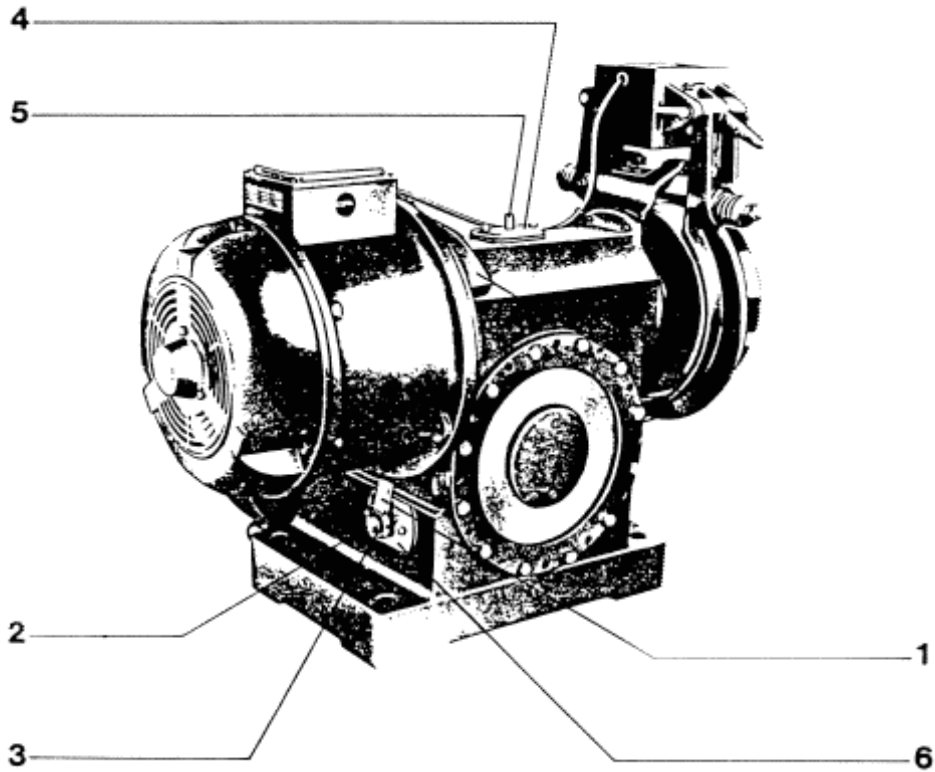

SERIAL M.01		
Ref. N.	PART or ML	DESCRIPTION
1+2+3+6	M02000F9	Oil level indicator complete
4+5	M02000F8	Cover complete with air valve



SPL 06-MC09710A - 15ATL Machine

Page 9 - TYPE MC09710A 15ATL MACHINE -- SPARE PARTS

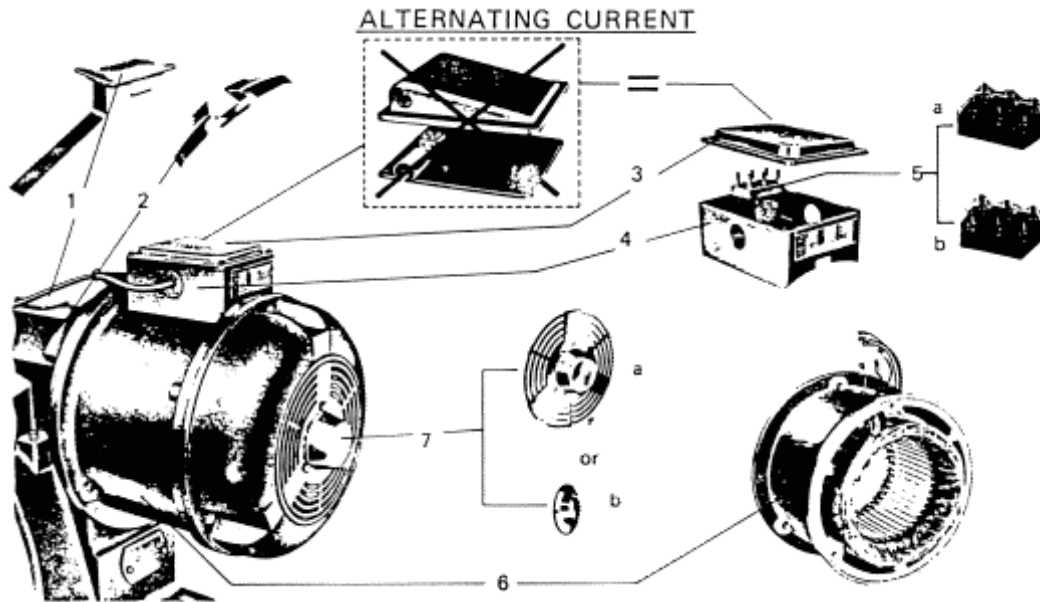

SERIAL M.02 - M.03 - M.04			
Ref. N.	PART or ML		DESCRIPTION
1	MCO346BT3		Cover
2	MO384EB1	WITH	Protection, guard (SERIAL M.03 - M.04 ONLY)
3	MCO346BN5	AND	Cover
4	MO309AE1	WITHOUT	Terminal block case
5	GO190B3	FORCED	Motor terminal base (with 6 terminals)
a			
b	MCO190C2	VENTILATION	Motor terminal base (with 8 terminals)
6	See Also •		Stator
7	MCO279G1	Without FORCED VENTIL.	Cover for motor bearing
a			
b	MCO346BR1	With FORCED VENTIL.	Cover for motor bearing

• To order a stator the information on page 3 is required.

DIRECT CURRENT

To order spare parts See Also Part Leaflet 08 MC09710D - 66G MOTOR

SPL 06-MC09710A - 15ATL Machine

Page 10 - TYPE MC09710A 15ATL MACHINE - BRAKE SPARE PARTS

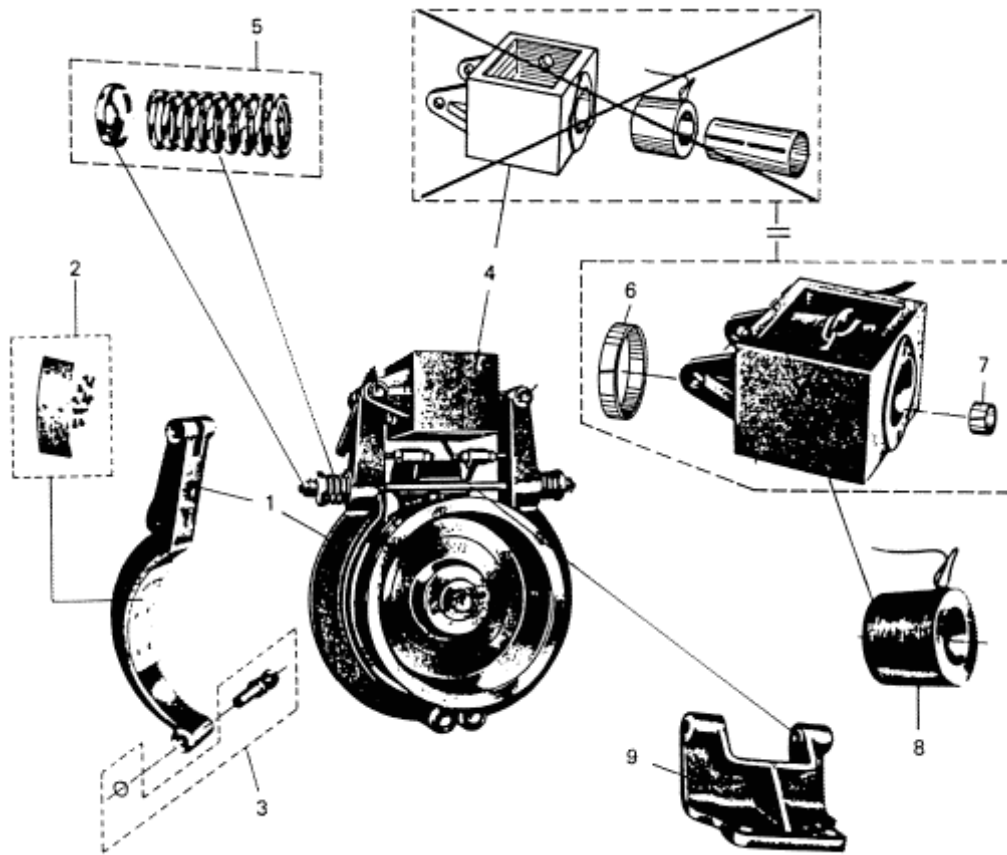

SERIAL M.01 - M.02 - M.03 - M.04		
Ref. N.	PART or ML	DESCRIPTION
1	MCO2088BL1	Brake arm + Washer
2	MCO2088AR3	Lining + Rivets
3	MCO2088AT2	Pin + Retaining ring
4	MCO2088AP2	Electromagnet complete
5	MO2000F10	Spring holder + Brake spring
6	MO298CY4	Slyd ring
7	MO298CY3	Slyd ring
8	MCOA222E1	Brake coil
9	MCOA180H1	Support for brake setting screw

SPL 06-MC09710A - 15ATL Machine

Page 11 - TYPE 9710BH - ACCORDING TO TRA200 GERMAN CODE BRAKE -SPARE PARTS

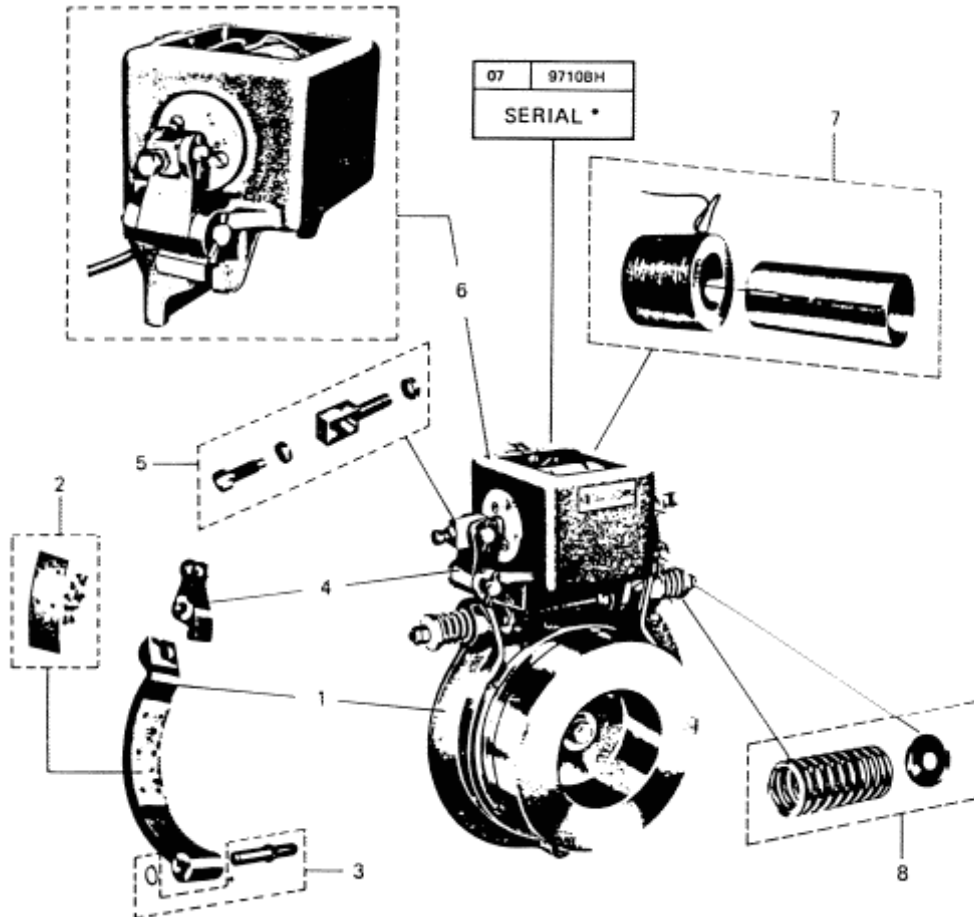

SERIAL M.01		
Ref. N.	PART or ML	DESCRIPTION
1	MCO286C2	Brake arm
	MCO286C4	Brake arm (for machine stretched duty)
2	MCO2088AR3	Lining + Rivets
3	MCO2088AT2	Pin + Retaining ring
4	MCO288AB1	Lever
5	MO2666A1	Brake setting device
6	MCO2088AH10	Electromagnet complete
7	MO2000F11	Brake coil + Brake sleeve
8	MO2000F10	Brake spring + Spring washer

# SPL 06-MC09710A - 15ATL Machine

## Page 12 - TYPE MC09710A 15ATL MACHINE - DRIVING SHEAVE

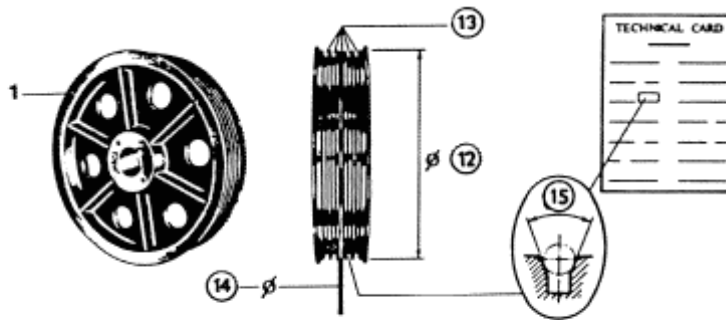

- To order a driving sheave or rope guard provide the following information.
- Renseignements à fournir pour commander une poulie de traction ou garde câble.
- Folgende Angaben werden für die Bestellung einer Treibscheibe oder eines Seilschutzes benötigt.
- Informazioni da fornire per ordinare una puleggia o guardia funi.
- Informaciones necesarias para hacer un pedido de motriz o guarda cables.

Driving sheave diameter  
Diamètre poulie de traction  
Treibsch. Durchm.  
Diametro puleggia  
Diam. motriz.

12

Ropes diameter  
Diamètre des cables  
Seilen Durchm.  
Diametro funi  
Diam. cables

14

Grooves, number  
Nombre de gorges  
Anzahl der Rillen  
N° gole  
N° de ranuras

13

Undercut grooves  
Angle des gorges  
Rillen Profil  
Profilo gole  
Tipo de ranura

15

Device for machine above  
Dispositif pour machine en haut  
Vorrichtung für Maschine oben  
Dispositivo per macchina in alto  
Dispositivo para maquina arriba

2

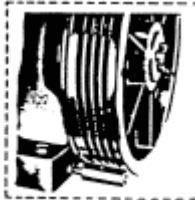

3

Device for machine below  
Dispositif pour machine en bas  
Vorrichtung für Maschine unten  
Dispositivo per macchina in basso  
Dispositivo para maquina abajo

SERIAL M.01 - M.02 - M.03 - M.04		
Ref. N.	PART or ML	DESCRIPTION
1	See Also *	Driving sheave
2 & 3	MCO465J6	Rope guards - L = 115

SPL 06-MC09710A - 15ATL Machine

Page 13 - 15ATL MACHINE - FAN FOR FORCED VENTILATION SPARE PARTS

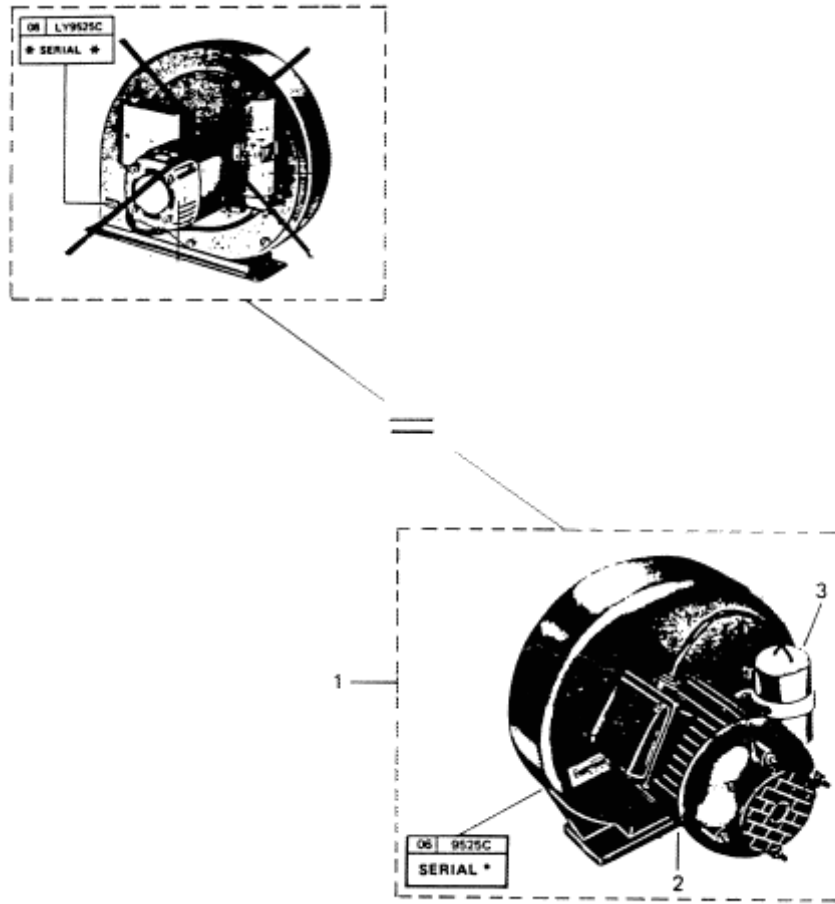

SERIAL M.01 - M.02		DESCRIPTION	
Ref. N.	PART or ML	DESCRIPTION	
1	9525C2	Fan, complete 50 / 60 Hz	
2	MO2000G1	Motor connection with star	SERIAL M.01 ONLY
	MO2000G12	Motor connection with delta	SERIAL M.02 ONLY
3	MO226G1	Capacitor	SERIAL M.01 ONLY
	MO226G2	Capacitor	SERIAL M.02 ONLY

SPL 06-MC09710A - 15ATL Machine

Page 14 - TYPE MC09710A 15ATL MACHINE STRETCHED DUTY SPARE PARTS

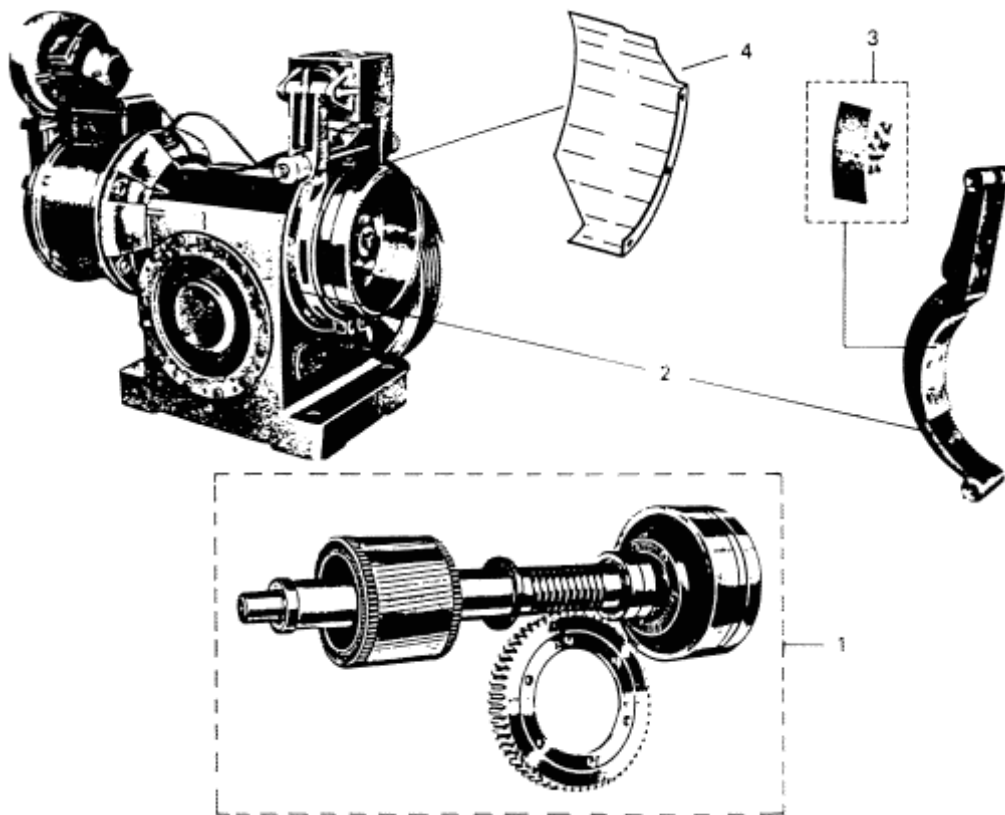

SERIAL M.04				
Ref. N.	Motor 66G	Motor 3146	WORM GEAR TEETH	DESCRIPTION
	PART or ML			
1	MO2000F12	MO2000F14	1 : 29 ½	Worm shaft + Worm gear
	--	MO2000F15	1 : 37 ½	rim +Fan + Fan hub +
	MO2000F13	MO2000F16	1 : 46	Flywheel + Bearings + Gaskets + Rotor
2	MCO286G4		Brake arm	
3	MCO2088AR3		Lining + rivets	
4	MO2000F17		Deflectors	

\* For all other spare parts See Also the preceding pages.

SPL 06-MC09710A - 15ATL Machine

Page 15 - TYPE MC09710A 15ATL MACHINE NORMAL WITH LOHER MOTOR - "GAMMA 160" - SPARE PARTS

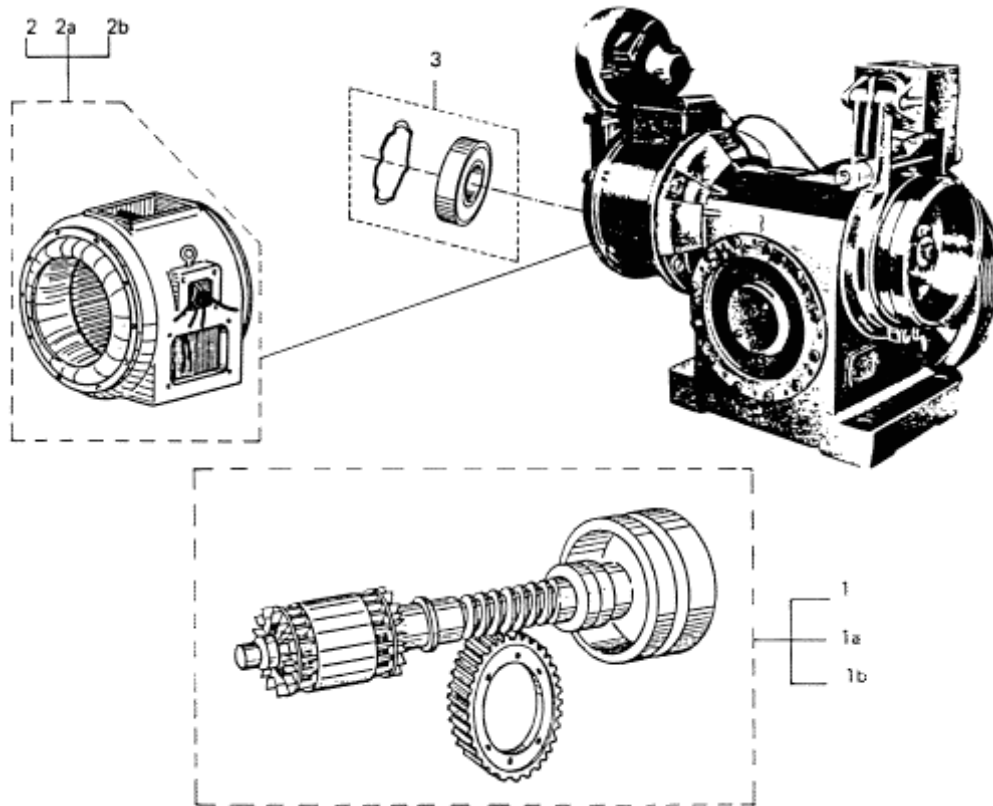

SERIAL M.04				
Ref. N.	PART or ML	WORM GEAR TEETH	Kw	DESCRIPTION
1	MO2000F18	1 : 29 ½	6,6	Shaft, worm + Worm gear rim + Rotor + + Flywheel + Bearings + Gasket
2	9716AD1	-		Stator, complete V 380
	9716AD4			V 415
1 a	MO2000F19	1 : 29 ½	11,8	Shaft, worm + Worm gear rim + Rotor + + Flywheel + Bearings + Gasket
2 a	9716AD2	-		Stator, complete V 380
	9716AD5			V 415
1 b	MO2000F20	1 : 29 ½	16	Shaft, worm + Worm gear rim + Rotor + + Flywheel + Bearings + Gasket
2 b	9716AD7	-		Stator, complete V 380
	9716AD8			V 415
3	MO2000F21	-		Ring + Bearing, ball

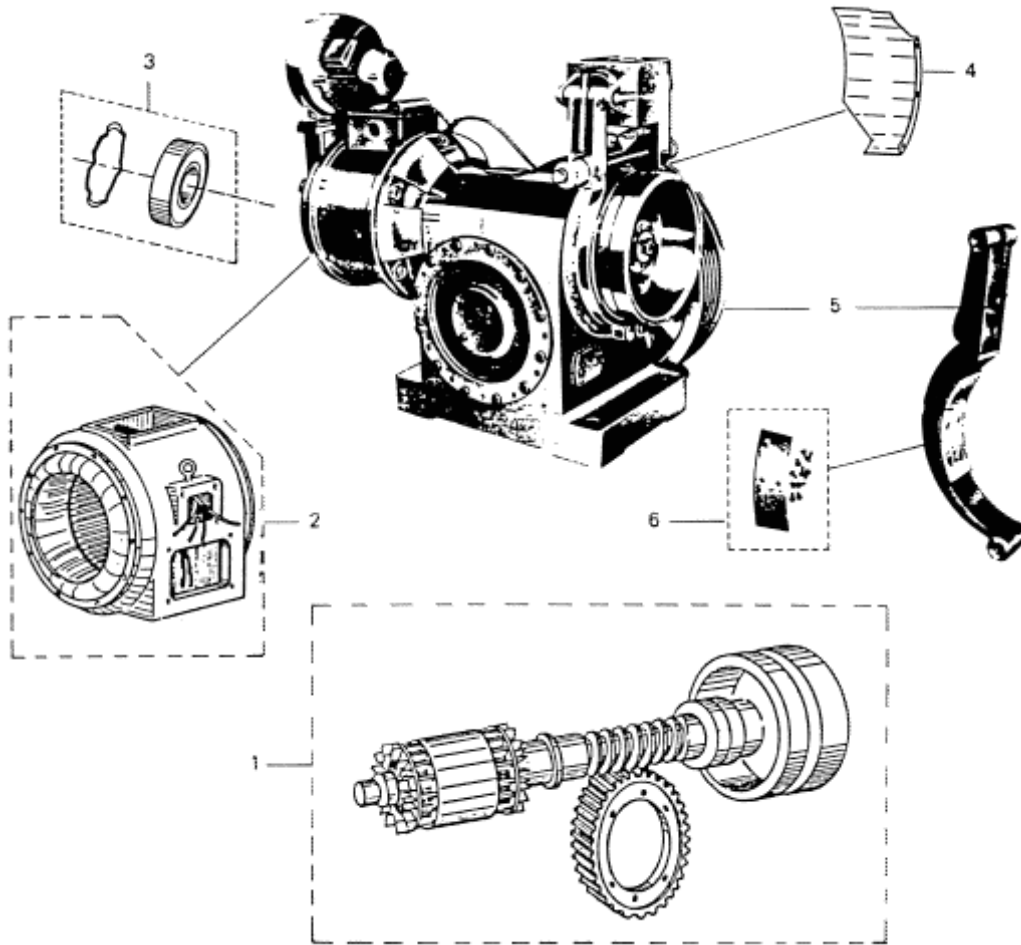

SERIAL M.04			
Ref. N.	PART or ML	WORM GEAR TEETH	DESCRIPTION
1	MO2000F22	1 : 29½	Shaft, worm + Worm gear rim + Rotor + Flyheel + + Bearings + Gasket
2	9716AD3	-	V 380 Stator, complete (Kw 19,9)
	9716AD6		V 415
3	MO2000F23		Ring + Bearing, ball
4	MO2000F17		Deflector
5	MCO286G4		Brake Lever
6	MCO2088AR3		Lining + rivets



SPL 06-MC09710A - 15ATL Machine

Page 17

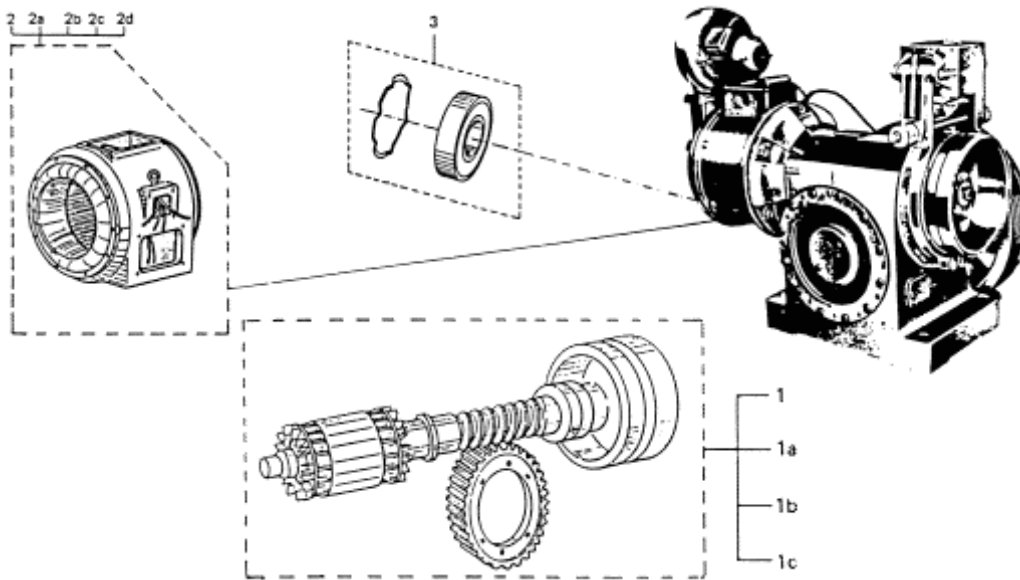

SERIAL M.04				DESCRIPTION
Ref. N.	PART or MI	WORM GEAR TEETH	Kw	
1	MO2000F24	1 : 29½	6,6	Shaft, worm + Worm gear rim + Rotor + Flywheel + Bearings + GasKets
2	9716AD9	-		Stator, complete V 380
	9716AD14			V 415
1a	MO2000F25	1 : 29½	12 - 13,5	Shaft, worm + Worm gear rim + Rotor + Flywheel + Bearings + Gaskets
2a	9716AD10	-	12	Stator, complete V 380
	9716AD15			V 415
2b	9716AD11	-	13,5	Stator, complete V 380
	9716AD16			V 415
1b	MO2000F26	1 : 29½	16	Shaft, worm + Worm gear rim + Rotor + Flywheel + Bearings+ Gaskets
2c	9716AD12	-		Stator, complete V 380
	9716AD17			V 415
1c	MO2000F27	1 : 29½	19,5	Shaft, worm + Worm gear rim + Rotor + Flywheel + Bearings + GasKets
2d	9716AD13	-		Stator, complete V 380
	9716AD18			V
3	MO2000F21	-	-	415 Ring + Bearing, ball

SPL 06-MC09710A - 15ATL Machine

Page 18

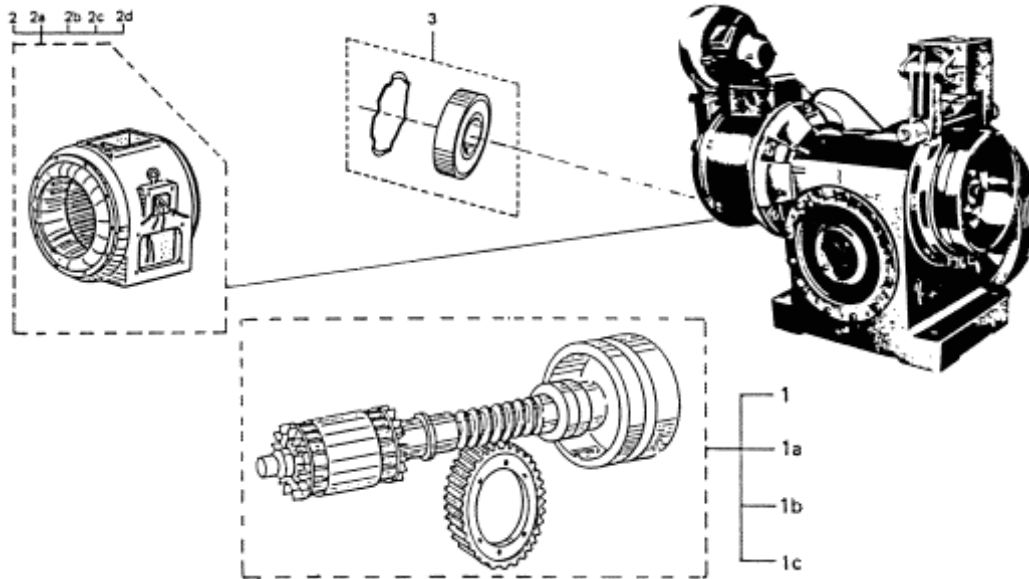

SERIAL M.04				
Ref. N.	PART or MI	WORM GEAR TEETH	Kw	DESCRIPTION
1	MO2000F24	1 : 29½	6,6	Shaft, worm + Worm gear rim + Rotor + Flywheel + Bearings + Gaskets
2	9716AD19	-		Stator, complete V 380
	9716AD24			V 415
1a	MO2000F25	1 : 29½	12 - 13,5	Shaft, worm + Worm gear rim + Rotor + Flywheel + Bearings + Gaskets
2a	9716AD20	-	12	Stator, complete V 380
	9716AD25			V 415
2b	9716AD21	-	13,5	Stator, complete V 380
	9716AD26			V 415
1b	MO2000F26	1 : 29½	16	Shaft, worm + Worm gear rim + Rotor + Flywheel + Bearings + Gaskets
2c	9716AD22	-		Stator, complete V 380
	9716AD27			V 415
1c	MO2000F27	1 : 29½	19,5	Shaft, worm + Worm gear rim + Rotor + Flywheel + Bearings + Gaskets
2d	9716AD23	-		Stator, complete V 380
	9716AD28			V 415
3	MO2000F21	-	-	Ring + Bearing, ball