

Brake, Machine
(Emergency, HILLIARD)
18ATF & 156MST

Spare Parts Leaflet

07-AAA20016C

August 24, 2011 / Page 1 of 3



07	AAA20016C
RANGE OF TOTAL SUSPENDED MASSES 3800 - 1300Kg	
RANGE OF OPERATING SPEEDS 0-4.9 m/s	

OTIS

Safety First!

SERVICE ENGINEERING
Otis Elevator Company
Bloomfield, Connecticut USA

Leaflet Description

The Hilliard emergency brake is required on the 18ATF and 156MST machines per ANSI A17.1/B44 Harmonized Code. The ANSI A17.1/B44 Harmonized Code requires protection against ascending car overspeed and unintended car motion out of the door zone with the doors open. This leaflet covers the service parts for the Hilliard emergency brake.

Leaflet Revisions

Date Revised	Subject Matter Expert	Reason for Revision
August 5, 2002	Nicholas Grant	New Leaflet
August 22, 2011	Val Sheynkman	Added NOTE on p. 3

Related Drawings

Drawing No.	Title	Drawing No.	Title
AAA20016C	Emergency Brake	---	---
AAA177EP	Switch, Toggle, Miniature	---	---

Related Documents

Document ID	Title
TIP 0.1.5-3	Emergency Evacuation of Passengers

Subject Matter Expert

Name	Department
Val Sheynkman	OSC Service Engineering

About Spare Parts Leaflets...

This document lists the lowest replaceable units (LRUs) for the standard version of the product. The LRUs are chosen by a team of Otis associates representing engineering and manufacturing.

While goal of this document is to make parts identification as easy as possible, the document cannot be all-inclusive. Elevator and escalator contracts classified as "special" or "custom" are not addressed here. For such contracts, please refer to specified information, the contract folder, TIPs, Field Education Articles, Construction Letters, etc. for further information.

If you have any suggestions about this document, please contact the subject matter expert listed on this page.

Brake Assembly

07-AAA20016C

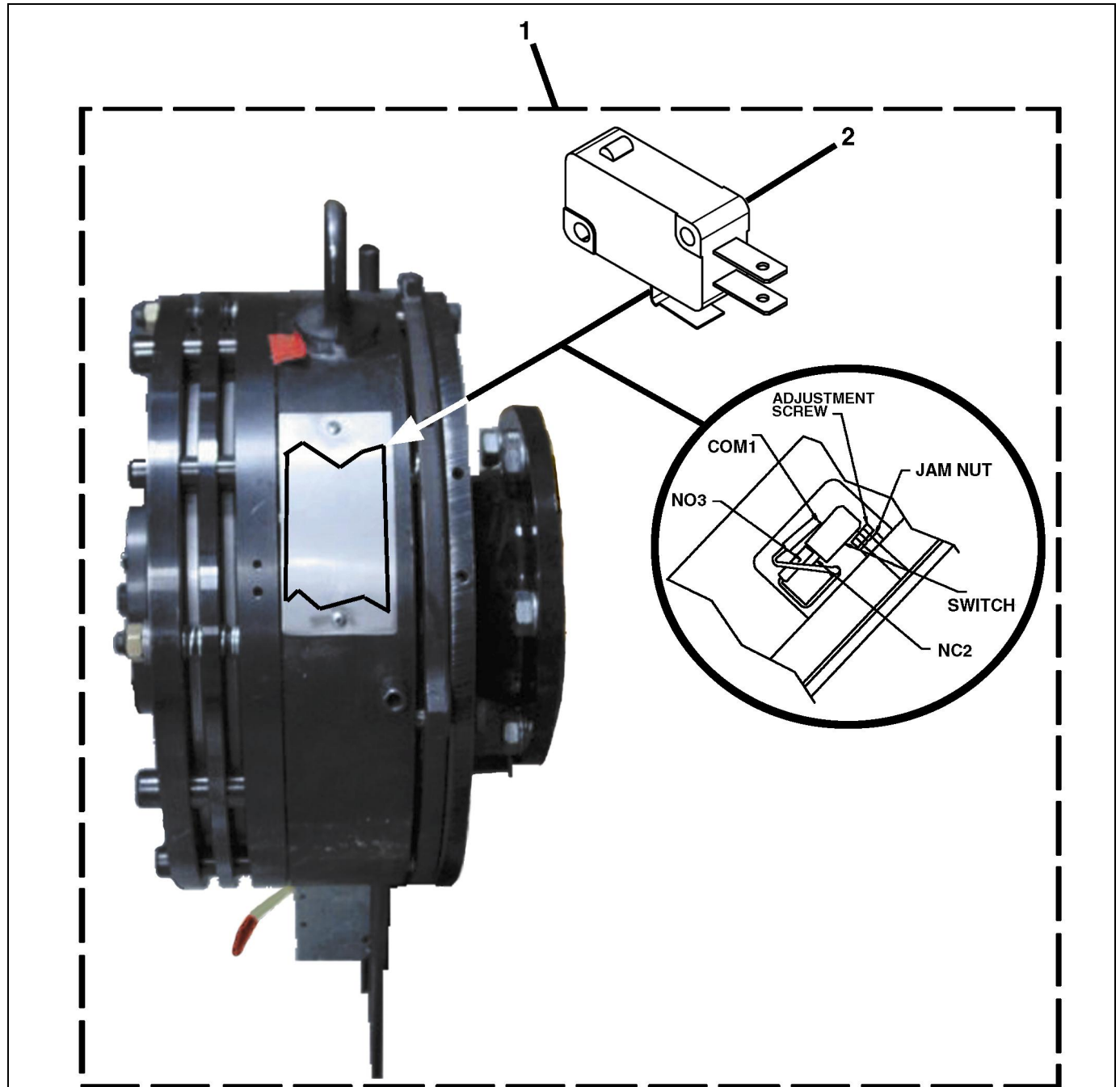

REF. No.	PART No.	DESCRIPTION
1	AAA20016C1	Assembly, Emergency Brake, Hilliard (for the 18ATF machine)
	AAA20016C2	Assembly, Emergency Brake, Hilliard (for the 156MST machine)
2	AAA177EP2	Switch

NOTE: For information regarding using and testing the Hilliard emergency brake on 18ATF and 156MST machines, see SWP N-6.0-5.