

**HydroFit® GCS
Hydraulic Controller
(HYD)**

Spare Parts Leaflet

10-AAA21242E

November 4, 2020 / Page 1 of 19

10 A - AAA21242E

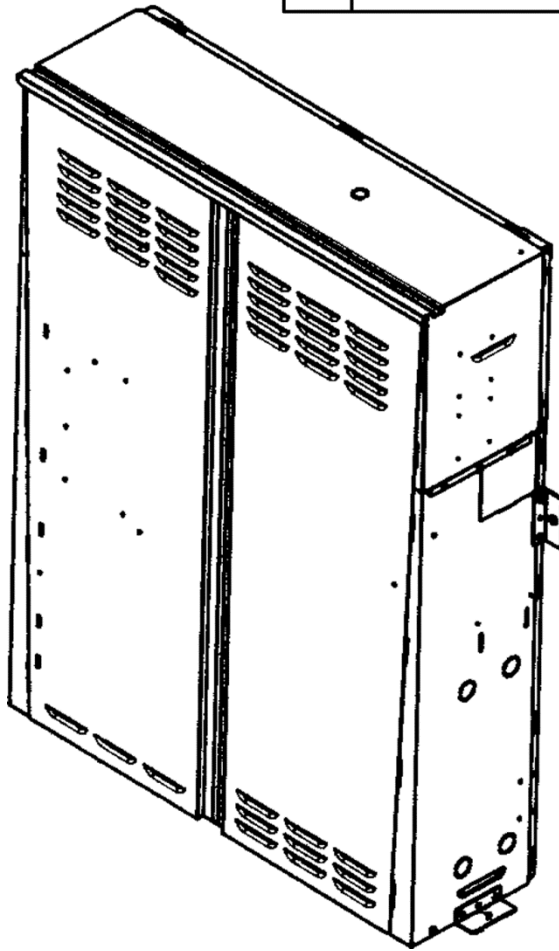

OTIS

This document does not contain any
technical data subject to EAR or ITAR

**SERVICE ENGINEERING
Otis Elevator Company
Bloomfield, Connecticut USA**

Unpublished Work—© Otis Elevator Co.; 2020

Leaflet Description

This leaflet contains all the spare parts for the HydroFit® hydraulic controller.

Leaflet Revisions

Date Revised	Subject Matter Expert	Reason for Revision
December 18, 2013	John Kleine and Bryan Leach	New SPL
October 5, 2016	Taye Gebrewold	Updated Information
December 7, 2016	Taye Gebrewold	Updated description for p/n AAA225JT35 on p. 9
November 4, 2020	Ali Bozorgzadeh	Added NOTE to p. 8

Related Drawings

Drawing No.	Title	Drawing No.	Title
AAA21242E	Assembly and Arrangement for GCS Hydraulic Controller	AAA21240AD	Control Assembly, Hydraulic Motor Soft Starter
AAA21700AV	Gateway Assembly	AAA21700AT	HydroFit® ERU Assembly
ABA21242F	HydroFit® Wiring Diagram	AAA29502L_TDS	HydroFit® Technical Data Sheet
AAA21242E_F MI	GCS Hydraulic Controller Field Micro Instruction	AAA285ZV	Passenger Duty Valve Cover Box
AAA27076FB	HydroFit® Master Wire List	AAA285ABB	Hospital Duty Valve Cover Box
AAA285ABB	MRL Hospital Duty Valve Cover	AAA285ZV	MRL Passenger Duty Valve Cover
ABA7900BH	Machine Room ERU Assembly		

Related Documents

Document ID	Title
TIP 1.1.14.0-12	<i>Hydraulic Elevator Pump Motor Solid State Controller</i>
TIP 1.1.22.1-1	<i>Updating GECEB Software with the Otis OMU</i>
SPL 10-AAA21242G	<i>Hydraulic Controller Extension Assembly</i>
SPL 10-AAA7900BH	<i>Emergency Rescue Unit (ERU)</i>

Subject Matter Expert

Name	Department
Ali Bozorgzadeh	OSC Service Engineering

About Spare Parts Leaflets...

This document lists the lowest replaceable units (LRUs) for the standard version of the product. The LRUs are chosen by a team of Otis associates representing engineering and manufacturing. While goal of this document is to make parts identification as easy as possible, the document cannot be all-inclusive. Elevator and escalator contracts classified as "special" or "custom" are not addressed here. For such contracts, please refer to specified information, the contract folder, TIPs, Field Education Articles, Construction Letters, etc. for further information.

If you have any suggestions about this document, please contact the subject matter expert listed on this page.

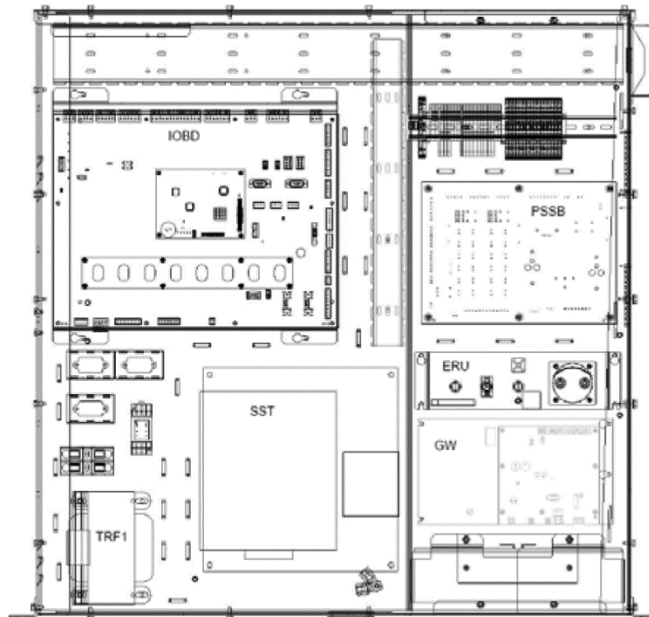

Front View—Left Hand MRL Controller
(Rights Hand MRL Controller is a Mirror Image)

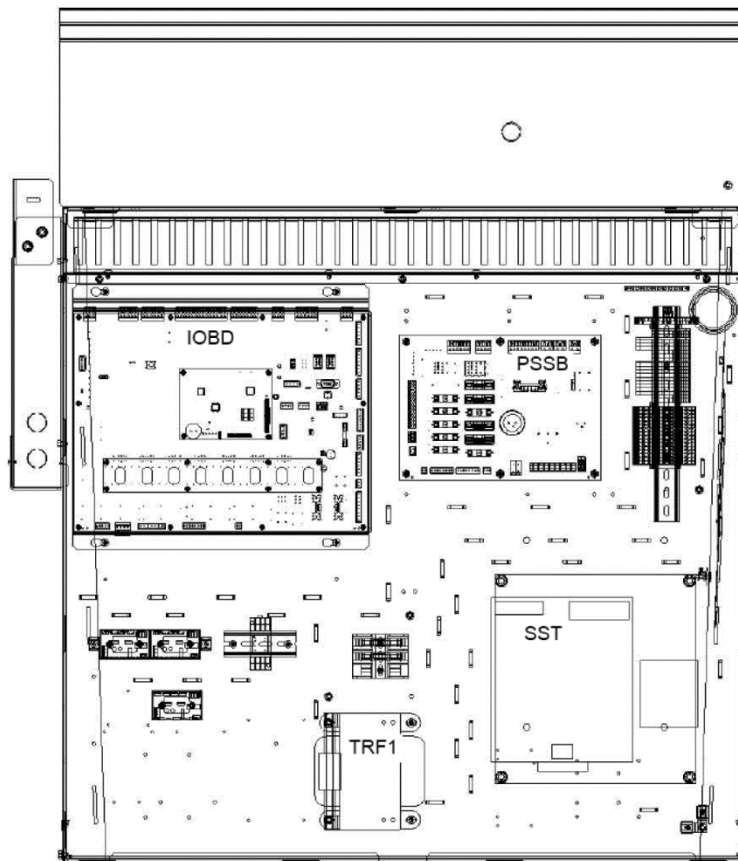

Front View—Machine Room Controller

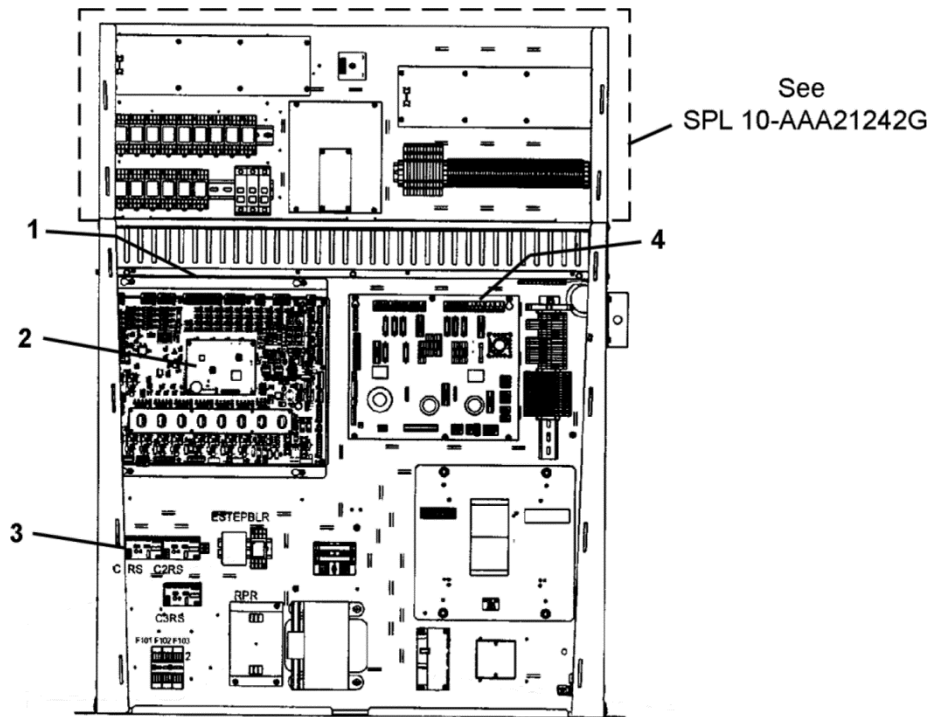

REF. No.	AAA21242E PART No.	DESCRIPTION	SYMBOL
1	ADA26800ATD1	PC Board, I/O, w/ Door Lock Bypass	IOBD (NOTE 1)
	ADA26800ATD2	PC Board, I/O, w/o Door Lock Bypass	
	AFA26800ATD1	PC Board, I/O, w/ Door Lock Bypass	
	AFA26800ATD2	PC Board, I/O, w/o Door Lock Bypass	
	AGA26800ATD1	PC Board, I/O, w/ Door Lock Bypass	
	AGA26800ATD2	PC Board, I/O, w/o Door Lock Bypass	
2	AEA26800AML13	PC Board, GECB	CPU (NOTE 2)
3	GDA25005B10	PC Board, RS-14	C1RS, C2RS, C3RS
4	ABA26800AXG1	PC Board, Power Supply, Simplex w/ AT400 Door Operator	PSSB (Obsolete)
	ABA26800AXG2	PC Board, Power Supply, Duplex w/ AT400 Door Operator	
	ABA26800AXG3	PC Board, Power Supply, Simplex w/ Glide Door Operator	
	ABA26800AXG4	PC Board, Power Supply, Duplex w/ Glide Door Operator	
	ABA26800AXG5	PC Board, Power Supply, Simplex w/ AT400 Front Only	PSSB (NEB HydroFit®)
	ABA26800AXG6	PC Board, Power Supply, Duplex w/ AT400 Front Only	
	ABA26800AXG7	PC Board, Power Supply, Simplex w/ AT400 Front & Rear	
	ABA26800AXG8	PC Board, Power Supply, Duplex w/ AT400 Front & Rear	
	ABA26800AXG9	PC Board, Power Supply, Simplex w/ Glide Front Only	
	ABA26800AXG10	PC Board, Power Supply, Duplex w/ Glide Front Only	
	ABA26800AXG11	PC Board, Power Supply, Simplex w/ Glide Front & Rear	
	ABA26800AXG12	PC Board, Power Supply, Duplex w/ Glide Front & Rear	
	ABA26800AXG15	PC Board, Power Supply, Duplex w/ Glide/Touch COP	
*	AAA616NL15	U8, 256K Bit Serial EEPROM, Blank (part not shown)	See CAUTION

(Continued on next page)

NOTE 1: When replacing AFA26800ATD board with an AGA version, see TIP 1.1.23.1-8. If upgrading from ADA26800ATD board, see TIP 1.1.23.0-1.

NOTE 2: GECB must be programmed: baseline AP231438AAB is needed for the ADA26800ATD; baseline AP131438BAA is needed for the AFA26800ATD; baseline AAA31438CAA is needed for the AGA26800ATD.

CAUTION: When swapping GECB board, remember to remove U8 (EEPROM) from the existing PCB or your E2 parameters will be lost.

10-AAA21242E

HydroFit® Hydro Controller

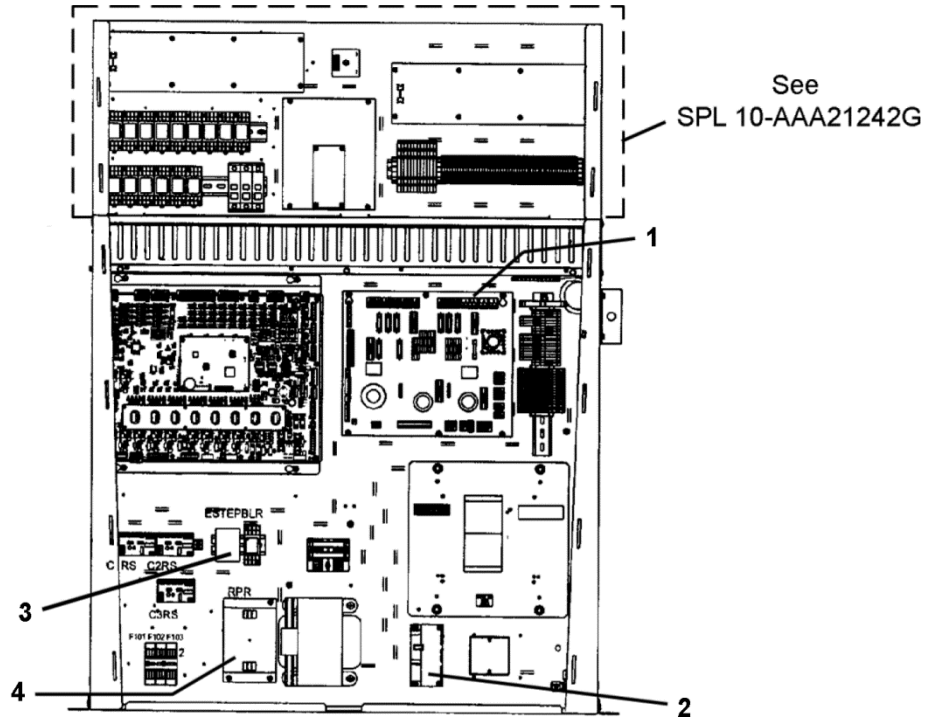

REF. No.	AAA21242E PART No.	DESCRIPTION	SYMBOL
1	ABA26800AXG13	PCB, Power Supply, For MOD w/ AT400 or i-Motion	PSSB (Mod HydroAccel®)
	ABA26800AXG14	PCB, Power Supply, For MOD w/ GAL Front & Rear	
	AAA26800AXW1	PCB, Power Supply (See NOTE)	
	AAA26800AXW2	PCB, Power Supply for DOJ & GALMODG. F19 = 2AMP	
	AAA26800AXW3	PCB, Power Supply for AT400, DOI, DOM1 & DOF. F19 = 4AMP	
	AAA26800AXW4	PCB, Power Supply for GLIDE, DOM3, DOMOVFR, DON1, DON2, DOCF & DOO. F19 = 6AMP	
2	AAA660B207	Relay, Overload, 15–30 A	OLS
	AAA660B208	Relay, Overload, 22–44 A	
	AAA660B209	Relay, Overload, 33–66 A	
	AAA660B210	Relay, Overload, 50–100 A	
	AAA660B211	Relay, Overload, 75–150 A	
3	AAA630AC1	Relay, Reverse-Phase, Site Supply = 208–240 VAC (60 Hz)	RPR
	AAA630AC2	Relay, Reverse-Phase, Site Supply = 440–480 VAC (60 Hz)	
	AAA630AC7	Relay, Reverse-Phase, Site Supply = 380 VAC (50 Hz)	
4	AAA630AC3	Relay, Reverse-Phase, Site Supply = 575–600 VAC (60 Hz)	

NOTE: When replacing AXW1 board, one of the new arrangements should be ordered depending on the door operator used, otherwise the fuse, F19 on an existing AXW1 board should be replaced in accordance with PUI-16-16-500.

Solid State Starter

10-AAA21242E

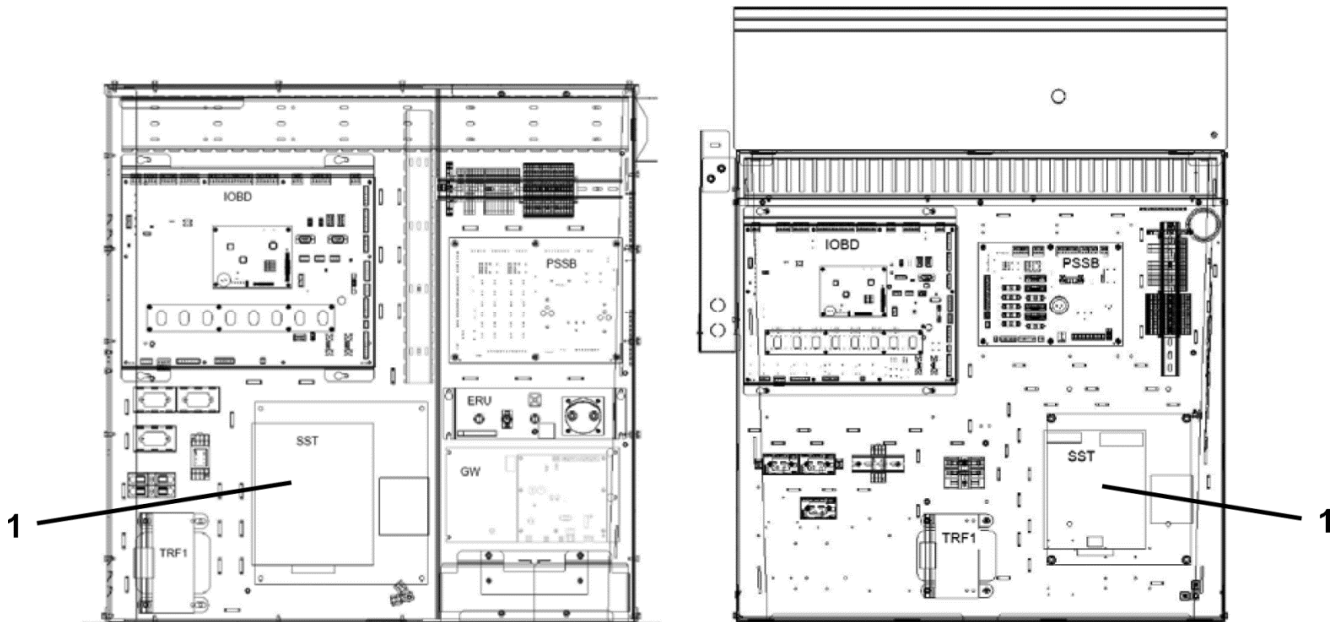

Left Hand MRL and Machine Room Controller – Solid State Starter Location
(Right Hand Controller Is a Mirror Image)

REF NO.	HP AT 200-208 V	HP AT 220-240 V	HP AT 440-480 V	HP AT 575-600 V	MAX. OPERATING CURRENT (AMPS)	OVERL OAD RANGE (AMPS)	STARTER P/N	REPLACEMENT FAULT CONTACTOR	REPLACEMENT FAULT CONTACT COVER
1	5	7.5	15	---	22	5-22	AAA21240AD5	AAA21240AD39	AAA21240AD44
	7.5	10	25	---	35	9-35			
	10	15	30	---	42	10-42			
	15	20	40	---	55	14-55			
	20	25	50	---	68	17-68			
	25	30	60	---	80	20-80	AAA21240AD7	AAA21240AD40	AAA21240AD45
	30	40	75	---	105	26-105	AAA21240AD8		
	---	---	40	50	55	14-55	AAA21240AD14		
	---	---	50	60	68	17-68	AAA21240AD15	AAA21240AD41	AAA21240AD45
	---	---	60	75	80	20-80	AAA21240AD16		

NOTE 1: Building power supply 200-240 V for use with 6- or 12-lead Wye-Delta wound motors only.

NOTE 2: Current limit % of overload current is 150-450 % (set at 230 V).

Pump Motor Contactors

10-AAA21242E

NOTE:  SPL 10-7151A, AC & DC Contactors Reversing / Y-Δ Contactors Starters, for the lower level replacement parts for the contactor assemblies listed below. Use NEMA size number to identify the contactor.

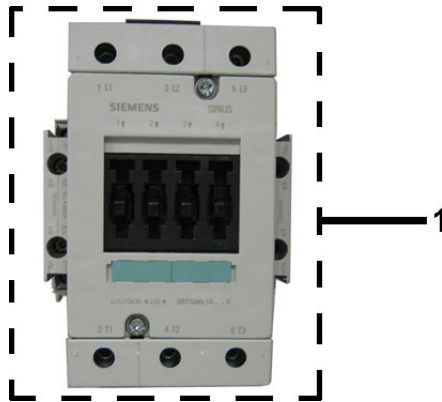

ACROSS-THE-LINE CONTACTORS (SXL)					
REF. No.	PART No.	DESCRIPTION	MOTOR HP	LINE VOLTAGE	SYMBOL
1	AAA638R7	Contactor, NEMA 2 AC	≥ 10 & ≤ 30	440–600 VAC	PM
	AAA638R107			208–240 VAC	
	AAA638A10	Contactor, NEMA 3 AC	> 30 & ≤ 50	440–600 VAC	
	AAA638A110				

10-AAA21242E

Transformer and System Fuses

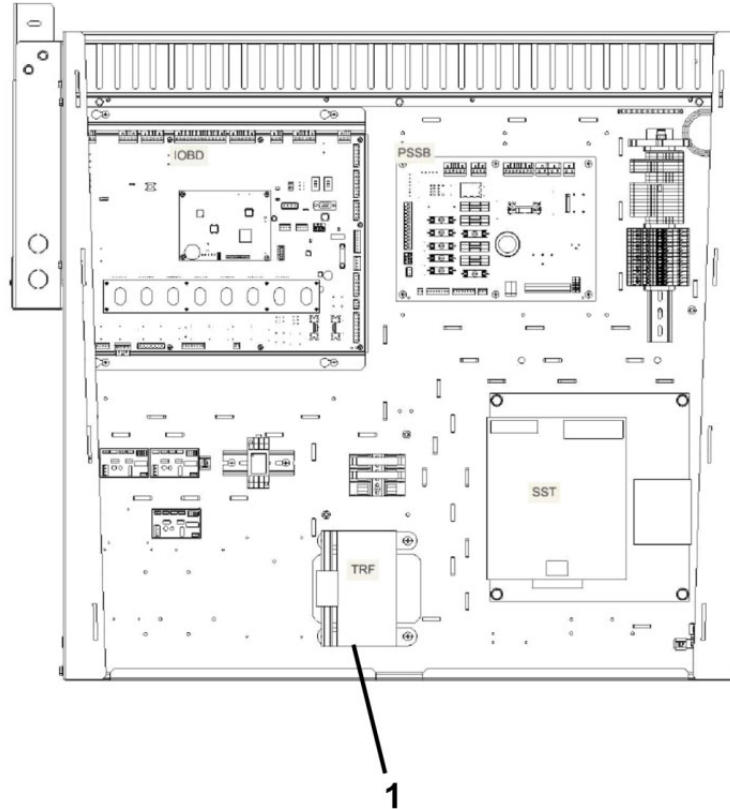

REF. No.	AAA21242E4 PART No.	OPERATOR TYPE	VOLTS	ERU	
1	AAA225JT10	AT400, i-Motion, Manual 120 DC, Manual 3 Ⓢ, F-Type, Peele Wireless, PEELE PLC, EMS PLC, Courion i-Learn	208–240	---	
	AAA225JT11		440–480		
	AAA225JT12		550–600		
	AAA225JT10	Manual 1 Ⓢ, MAC, ECI, Dover HD73, GAL MODG, Schindler QKS	208–240		without
	AAA225JT11		440–480		with (see NOTE)
	AAA225JT12		550–600		
	AAA225JT10	Glide A	208–240	---	
	AAA225JT17		440–480		
	AAA225JT18		550–600		
	AAA225JT19	GAL MOVFR	208–240		without
	AAA225JT17		440–480		
	AAA225JT18		550–600		
	AAA225JT19		550–600	with (see NOTE)	
	AAA225JT17				

NOTE: With Reynolds & Reynolds ERU.

(Continued on next page)

10-AAA21242E

Transformer and System Fuses

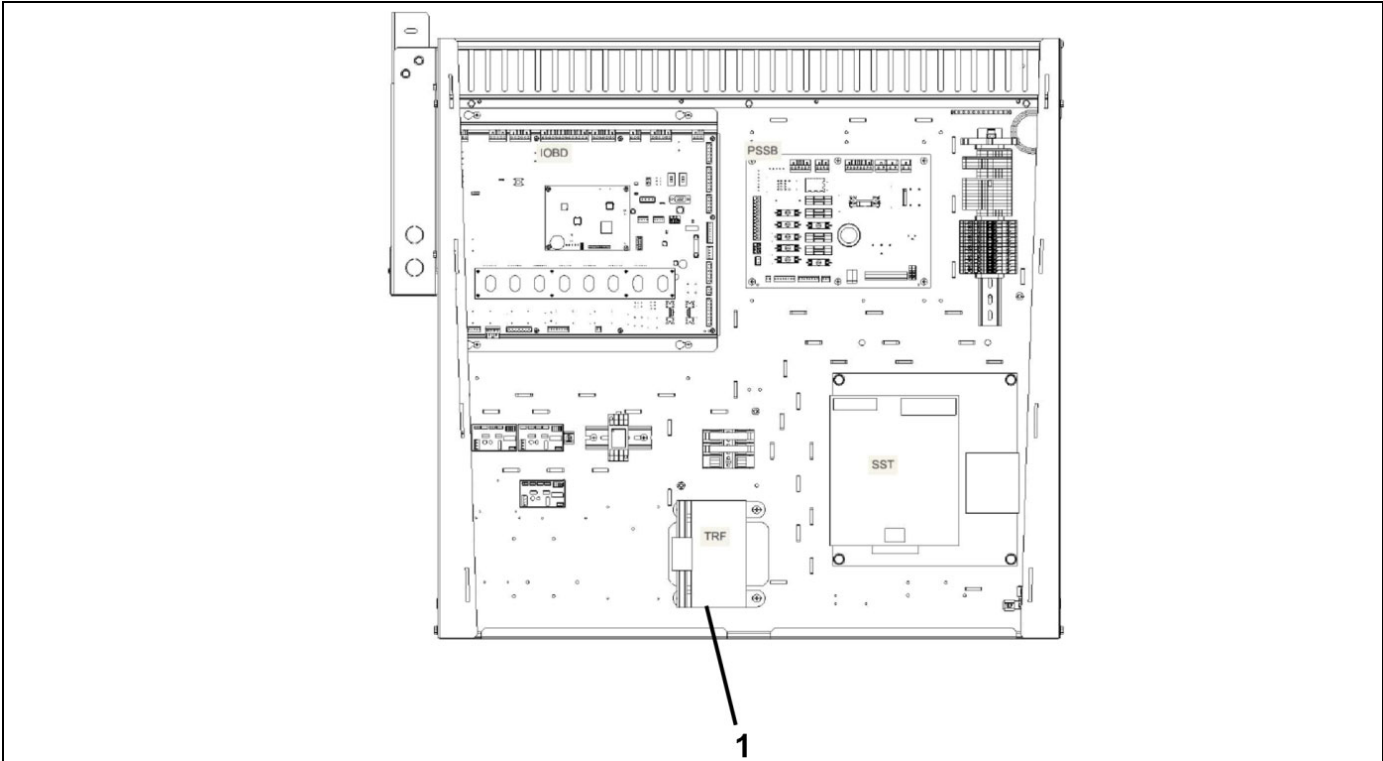

AAA21242E1
AAA21242E2
AAA21242E3

REF. No.	PART No.	DESCRIPTION	VOLTS	SYMBOL
1	AAA225JT20	Door, AT400, 526 VA, Front Door Only	208–240 VAC	TRF
	AAA225JT21		440–480 VAC	
	AAA225JT22		550–600 VAC	
	AAA225JT23	Door, AT400, 668 VA, Front and Rear Doors Only	208–240 VAC	
	AAA225JT24		440–480 VAC	
	AAA225JT25		550–600 VAC	
	AAA225JT26	Door, Glide, 474 VA, Front Door Only	208–240 VAC	
	AAA225JT27		440–480 VAC	
	AAA225JT28		550–600 VAC	
	AAA225JT29	Door, Glide, 618 VA, Front and Rear Door Only	208–240 VAC	
	AAA225JT30		440–480 VAC	
	AAA225JT31		550–600 VAC	
	AAA225JT32	Door, Glide-S or Glide-A, Front & Rear Openings w/ or w/o Touchscreen COP	208-240 VAC	
	AAA225JT33		440-480 VAC	
AAA225JT34	550-600 VAC			
	AAA21242E5 AAA21242E6 AAA21242E7 AAA21242E8 AAA21242E9 AAA21242E10			
REF. No.	PART No.	DESCRIPTION	VOLTS	SYMBOL
1	AAA225JT35	Mod—Universal Transformer	208–240 VAC 440–480 VAC	TRF

(Continued on next page)

10-AAA21242E

Transformer and System Fuses

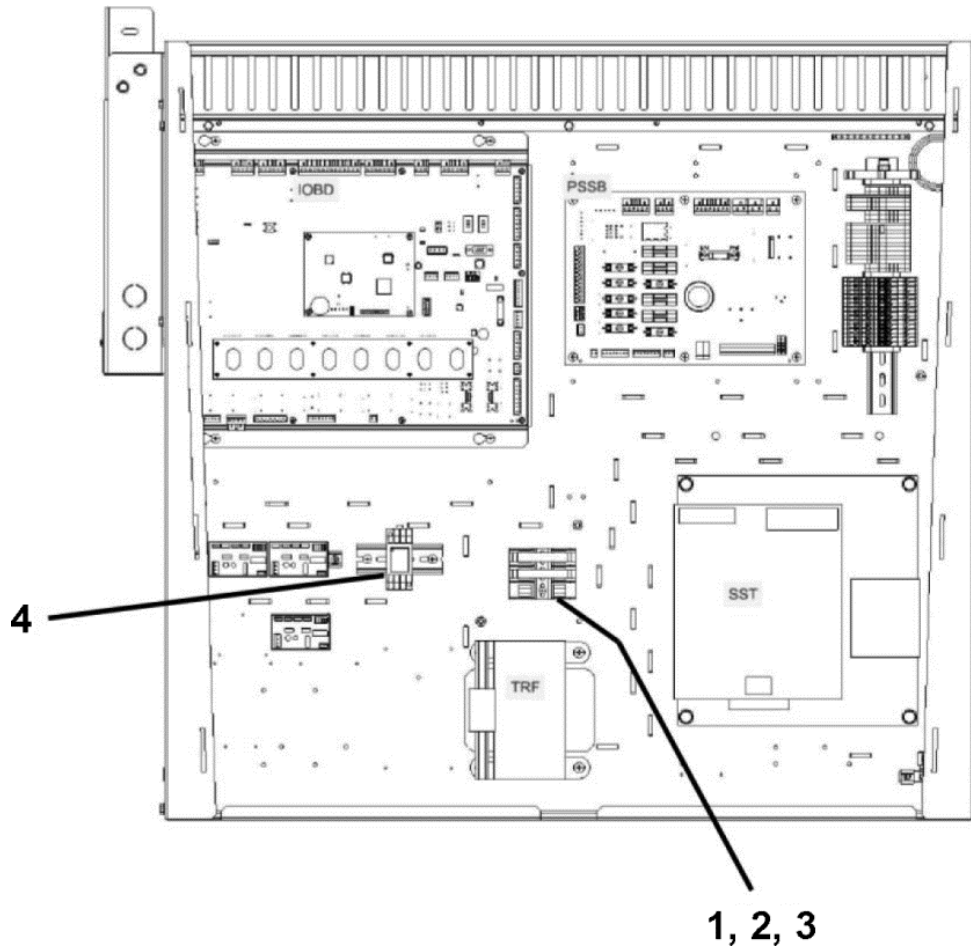

AAA21242E				
REF. No.	PART No.	OPERATOR TYPE	VOLTS	ERU
1	AAA375BK24	Fuse, Time Delay Rejection, 2.5A	440–480 VAC	---
	AAA375BK21	Fuse, Time Delay Rejection, 2.0A	550–600 VAC	
	AAA375BK32	Fuse, Time Delay Rejection, 5.6A	208 VAC	
	AAA375BK31	Fuse, Time Delay Rejection, 5A	220–240 VAC	
2	AAA180FK2	Fuse, Cover Puller	600 VAC	---
3	AAA653D1	Holder, Fuse, F1 and F2		
	AAA180FK1	Holder, Fuse F1, F2, and F3		
4	AAA613CZ26	Relay, 24V DC, 2 Form C		ESTENBLR

I/O Board

10-AAA21242E

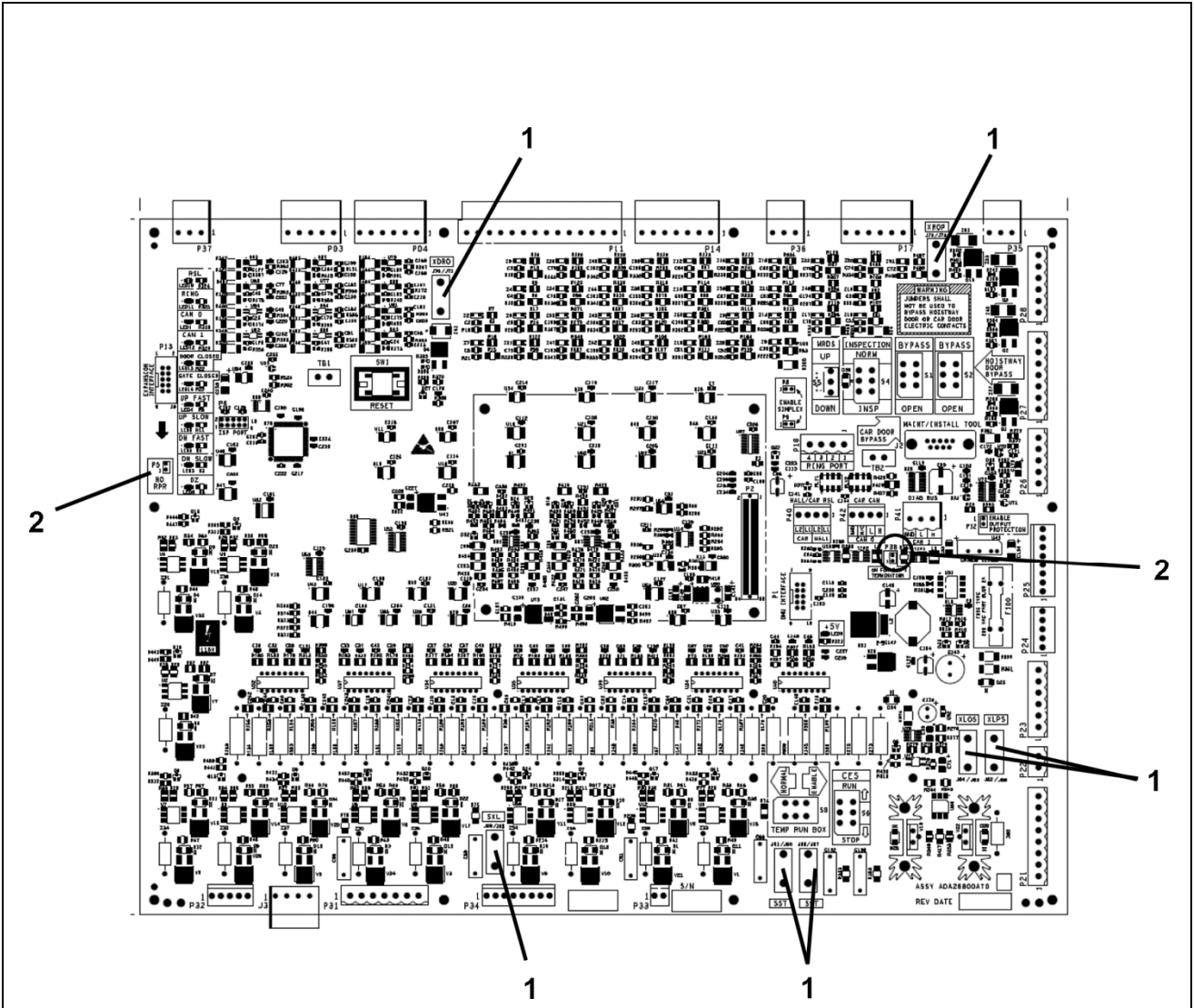

REF. No.	PART No.	DESCRIPTION
1	AAA646E4	Jumper, Red (used on IOBD and PSSB boards)
2	AAA646D1	Jumper, Small Black
*	DAA26800K1	Socket, Adapter, for OMU Programming Tool (not shown)
*	DBA26800H2	Tool, OMU Software Download, Blank (not shown)
	A_31438_A_	OMU Software, Programmed, see Note (not shown)

* Part not shown.

NOTE: Contact OSC for latest contract version.

10-AAA21242E**I/O Board Connectors**

AAA21242E		(AAA26800ATD Board)	
PART No.	SYMBOL	CONDITION	DESCRIPTION
AAA447BE155	P03	Door Link	Connectors for I/O Board (IOBD)
AAA447BE156	P04	Hall Fixtures	
AAA447BE157	P11	Position System (ADA I/O)	
AAA447BE183	P11	Position System (AFA I/O)	
AAA447BE158	P14	Inspection	
AAA447BE159	P17	Gate Switches	
AAA447BE160	P21	Tank Valves	
AAA447BE161	P22	Pump Motor	
AAA447BE175	P23	System Tank Sensors	
AAA447BE162	P26	Inspection	
AAA447BE163	P27 (two or more cars in group)	Inter-Car Connection	
AAA447BE164	P28	Smoke Sensors	
AAA447BE165	P31	Run Bug (Temp. Operation)	
AAA447BE150	P35	Safe To Open	
AAA447BE151	P36	Spare I/O	
AAA447BE166	P37	PES	
AAA447BE132	J3	REM Tank Sensors	

Power Supply Board Fuses

10-AAA21242E

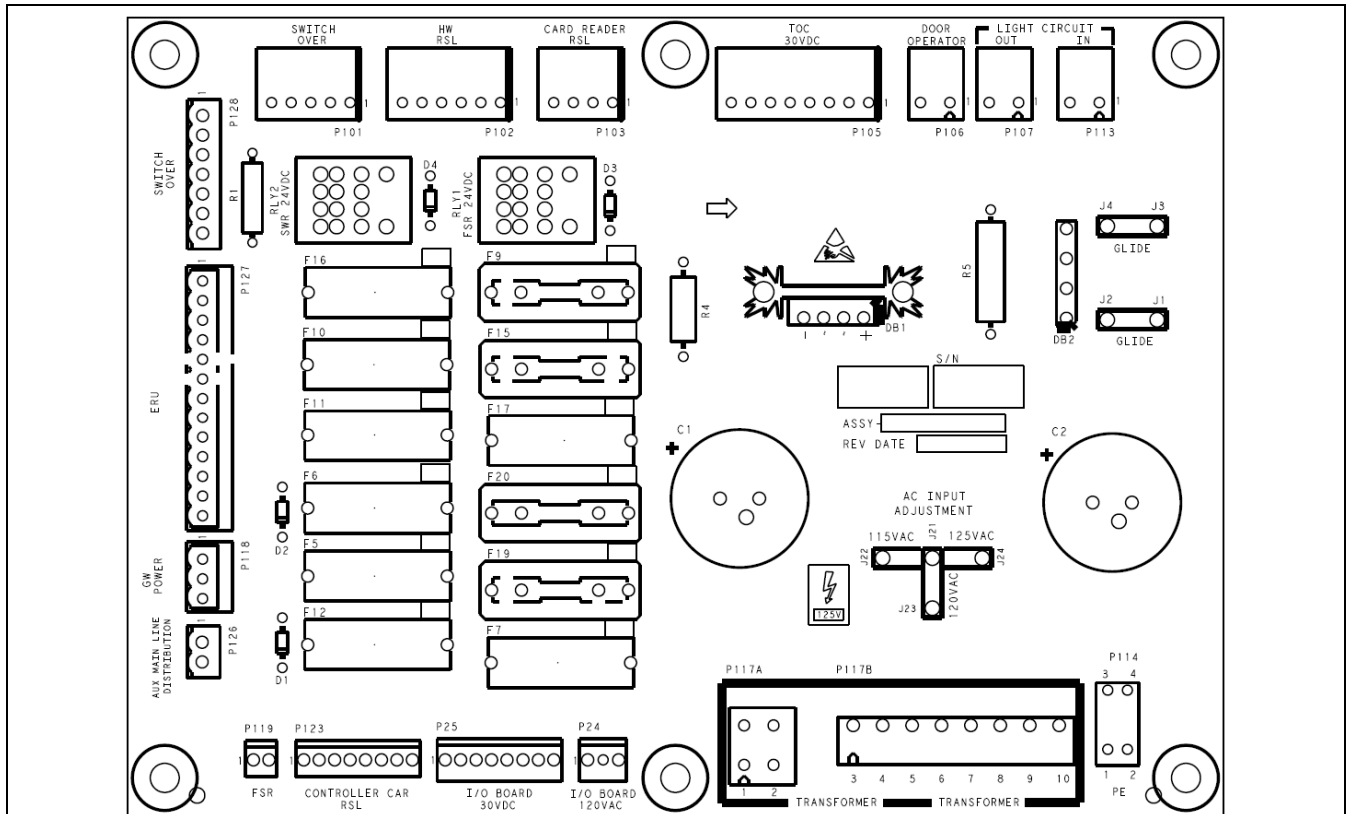

AAA21242E		(A_A26800AXG Board)			
FUSE	PART No.	FUSE TYPE	AMPS	VOLTS	CONDITIONS
F15	AAA375BT32	Fast Acting	10	250V	AXG1- AXG4 (See NOTE) AXG5 - AXG12, AXG15 AXG1- AXG4 (See NOTE) AXG5 - AXG12, AXG15 AXG1- AXG4 (See NOTE) AT400, Front Only (AXG5/6) AT400, Front and Rear (AXG7/8) Glide, Front Only (AXG9/10) Glide, Front and Rear (AXG11/12) MOD & Glide w/ Touch COP (AXG13-15)
F11	AAA375BT17		1		
F10	AAA375BT26		1.5		
F16	AAA375BT19		5		
F6	AAA375BT24		0.5		
F7	AAA375BT25		0.75		
F5	AAA375BT18		3		
F9	AAA375BT9		6		
F17	AAA375BT14	Fast Acting	15		
	AAA375BR17	Glass Body, Time Delay	7		
F20	AAA375BT28	Fast Acting	4		
	AAA375BR12	Glass Body, Time Delay	3		
F19	AAA375BT32	Fast Acting	10		
	AAA375BR11	Glass Body, Time Delay	2.5		
	AAA375BR14		4		
	AAA375BR5		0.75		
	AAA375BR7		1.25		
AAA375BR12	3				
F12	AAA375BR3		0.25		
F100	AAA375BR9		2	Located on IOBD	

NOTE: A compulsory PUI 16-16-005 dated 5/16/2016 requires this part to be changed.

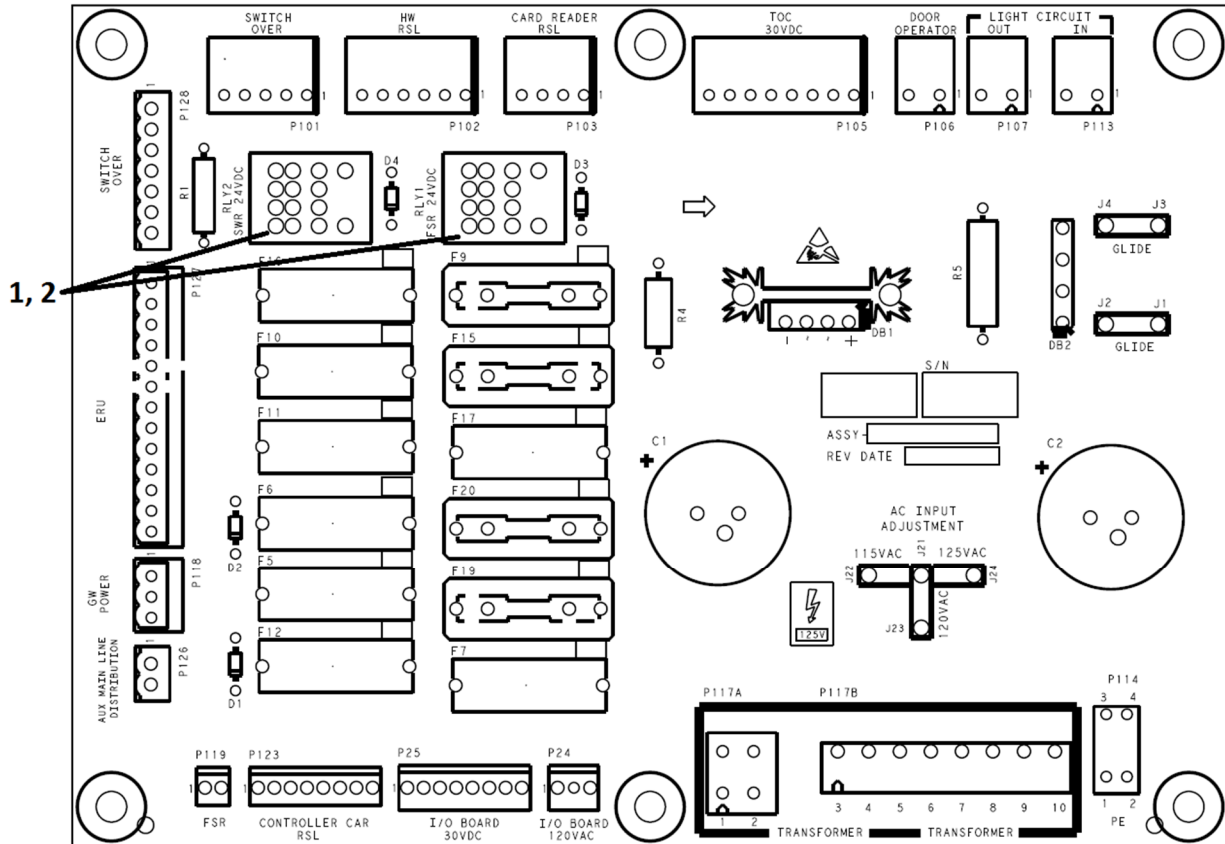

AAA21242E

(A_A26800AXG BOARD)

REF. No.	PART No.	DESCRIPTION	SYMBOL
1	AAA618AF100	Clips, Relay	FSR & SWR
2	AAA613CZ8	Relay, 24 VDC, Mounted on PSSB, Fire Service Relay and Switch-Over Relay	FSR & SWR

Power Supply Hardware: Connectors

10-AAA21242E

AAA21242E	(A_A26800AXG Board)	
PART No.	SYMBOL	OPTIONS
AAA447BE167	P101	Hall
AAA447BE168	P102	Hall/Group
AAA447BE24	P103	Card Reader
AAA447BE25	P104	Rope Governor
AAA447BE169	P105	TOC
AAA447BE170	P106	Door Operator
AAA447BE171	P107	Fan & Light
AAA447BE67	P112	24 VDC
AAA447BE172	P113	Fan and Light
AAA447BE38	P115	Tank Heater
AAA447BE37	P116	LOS, LPS Sensors
AAA447BE36	P117	Transformer
AAA447BE173	P118	REM Sensors / GWII Power
AAA447BE42	P126	Main Line Disconnect
AAA447BE40	P128	Inter-Car Connection
AAA447BE22	P130	Inter-Car Connection
AAA174YG22	P127	ERU, w/o ERU Connector

Power Supply Board Fuses

10-AAA21242E

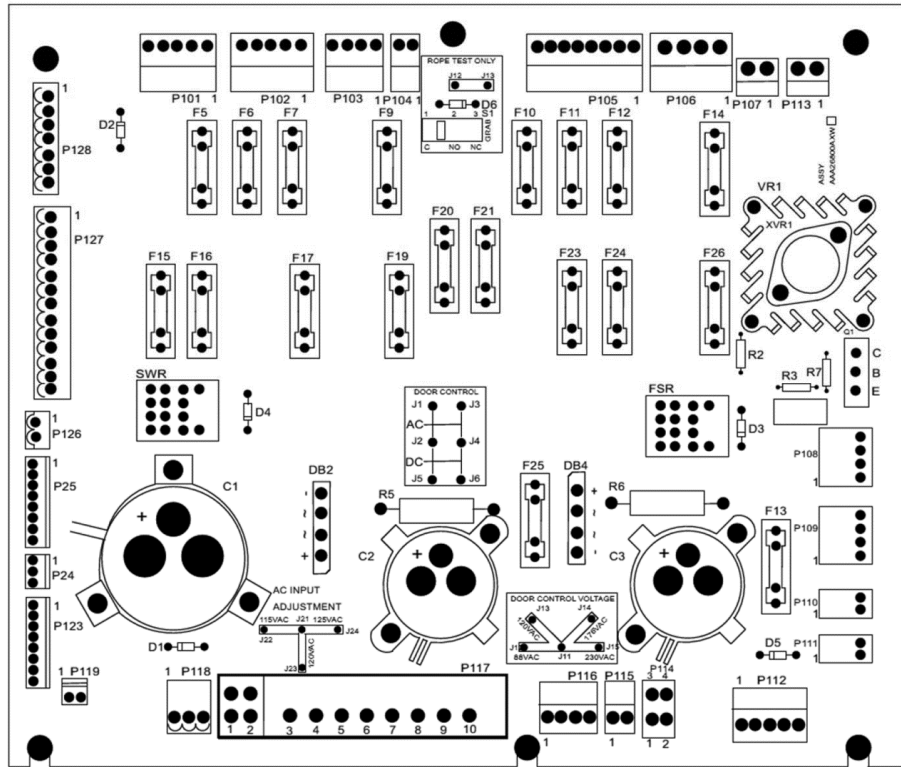

AAA21242E

(A_A26800AXW Board)

FUSE No.	PART No.	FUSE TYPE	AMPS	VOLTS	CONDITIONS
F5, F16	AAA375BT19	Glass Body Fast Acting	5A	250 V	AAA26800AXW1 (See NOTE)
F6	AAA375BT24		0.5A		
F7	AAA375BT25		0.75A		
F10	AAA375BT18		3A		
F11	AAA375BT26		1.5A		
F15	AAA375BT32		10A		
F26	AAA375BT28		4A		
F9	AAA375BT9		6A		
F13	AAA375BT6	Ceramic Body Fast Acting	3A		
F14	AAA375BT14		15A		
F19	AAA375BT32	Glass Body Fast Acting	10A		
	AAA375BT9	Ceramic Body Fast Acting	6A		
	AAA375BR14	Glass Body Time Delay	4A		
	AAA375BR9		2A		
F12	AAA375BR3	Glass Body Time Delay	0.25A		
F23	AAA375BR6		1A		
F20, F25	AAA375BR12		3A		
F21	AAA375BR11		2.5		
F24	AAA375BR4		0.5A		
F100	AAA375BR9		2A		
F17	AAA375BR20		15A	32 V	

NOTE: A compulsory PUI 16-16-005 dated 5/16/2016 requires this part to be changed.

Power Supply Hardware: Connectors

10-AAA21242E

AAA21242E	(A_A26800AXW Board)	
PART No.	SYMBOL	OPTIONS
AAA447BE167	P101	Hall
AAA447BE168	P102	Hall/Group
AAA447BE24	P103	Card Reader
AAA447BE25	P104	Rope Governor
AAA447BE169	P105	TOC
AAA447BE170	P106	Door Operator
AAA447BE171	P107	Fan and Light
AAA447AP256	P108	Extension RSL
AAA447AP256	P109	Extension Door Power
AAA447AP254	P110	120 VAC Hall Lantern
AAA447AP254	P111	120 VDC Hall Lantern
AAA447AP257	P112	30 VDC and 24 VDC
AAA447BE172	P113	Fan and Light
AAA447BE38	P115	Tank Heater
AAA447AP240	P116	Transformer 230 VAC
AAA447BE36	P117	Transformer
AAA447BE173	P118	REM Sensors / GWII Power
AAA447BE42	P126	Main Line Disconnect
AAA447BE40	P128	Inter-Car Connection
AAA447BE22	P130	Inter-Car Connection
AAA174YG22	P127	ERU, w/o ERU Connector

10-AAA21242E

Gateway Board

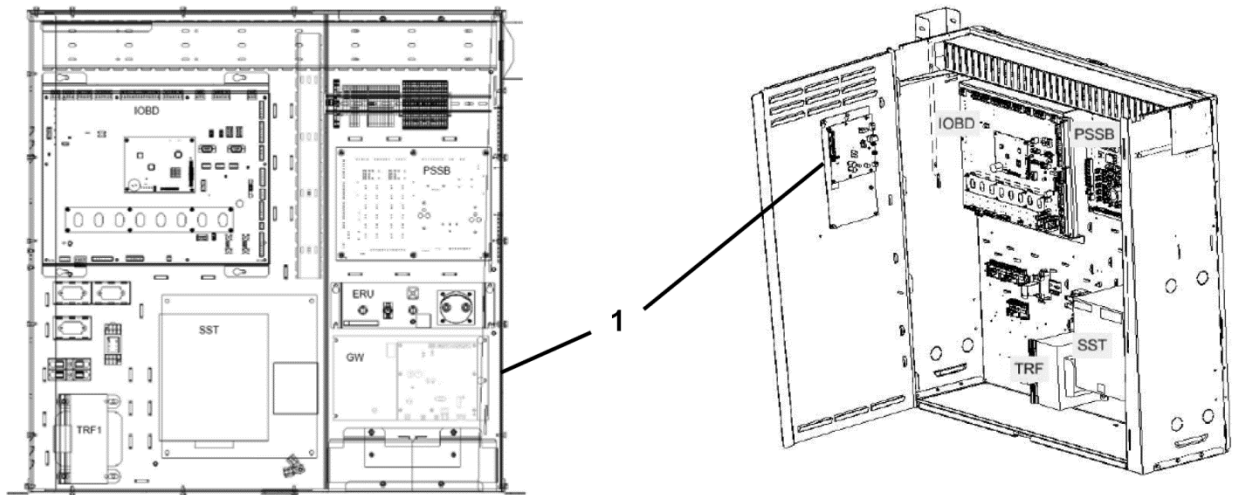

MRL Controller View

MR Controller View

AAA21242E		A_A21700AV Assembly	
REF. No.	PART No.	DESCRIPTION	SYMBOL
1	ABA26800ARC1	PC Board, Gateway	GWII

ERU Assembly

10-AAA21242E

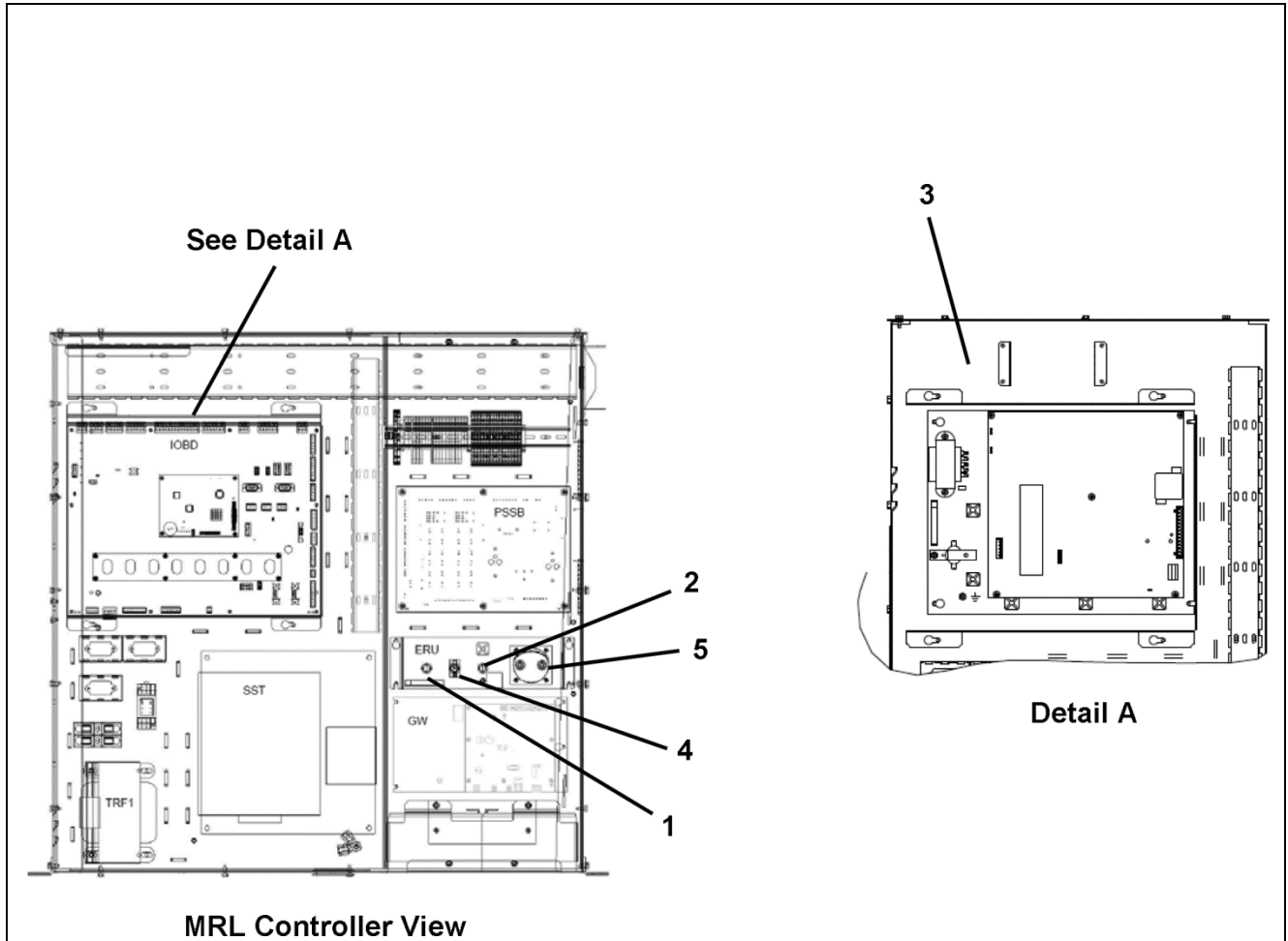

AAA21242E		(A_A21700AT ERU Assembly)	
REF. No.	PART No.	DESCRIPTION	SYMBOL
*	AAA718E15	Battery, ERU, Qty. 2	ERU (See NOTE 2)
1	AAA424Y1	LED, Amber	
2	AAA424Y3	LED, Green	
3	ADA26800RD1	PC Board, ERU (120 VDC Door Operator Power)	---
	ADA26800RD2	PC Board, ERU (220 VDC Door Operator Power)	
4	AAA177EM3	Switch	---
5	AAA659D1	Voltmeter	---

* Part not shown.

NOTE 1: For machine room ERU, see SPL 10-AAA7900BH.

NOTE 2: This assembly is the AAA21242E1 & 2 version controller only (HydroFit® MRL only).