

Compass[®] CAN to RSL
Enclosure

Spare Parts Leaflet

10-AAA25300AN

July 9, 2014 / Page 1 of 3

10 R - AAA25300AN

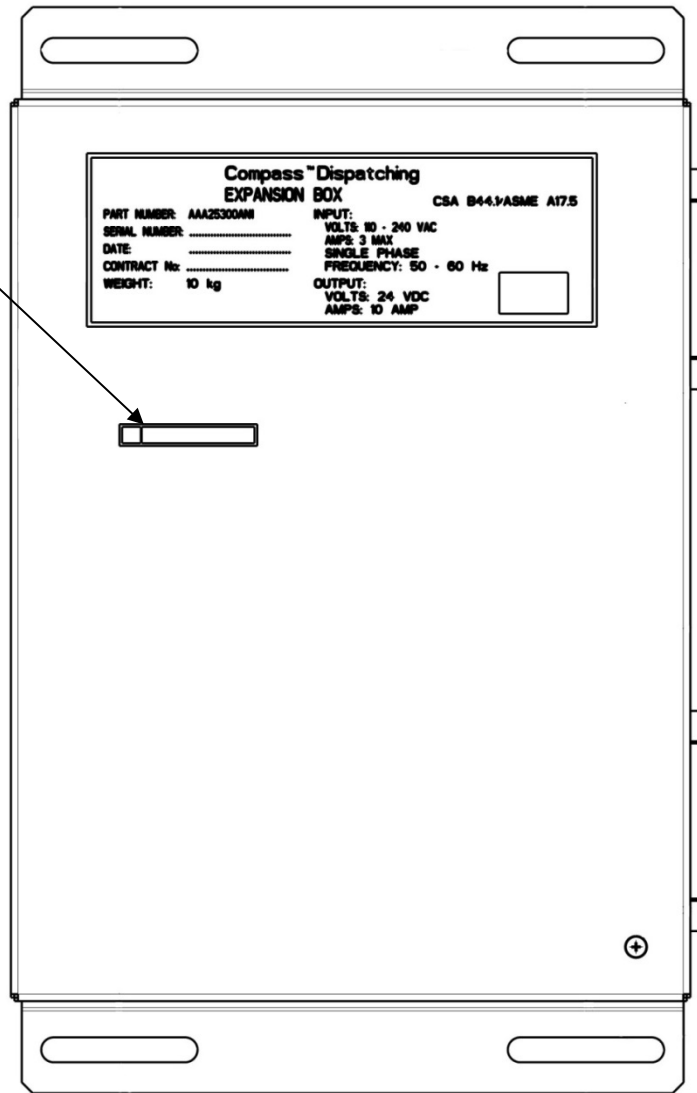

OTIS

SERVICE ENGINEERING
Otis Elevator Company
Bloomfield, Connecticut USA

Unpublished Work—© Otis Elevator Co.; 2014

Leaflet Description

This leaflet provides information for Compass CAN to RSL enclosure. Each enclosure has four RSL links and can supply a maximum 160 W (24 V @ 7 A) of power to the RSL devices.

Leaflet Revisions

Date Revised	Subject Matter Expert	Reason for Revision
July 9, 2014	Bennie Murah	New SPL

Related Drawings

Drawing No.	Title	Drawing No.	Title
AAA29000AS	System Level Compass for E401/101		
AAA21700AL	401X PCB Assembly I/O + GECEB Boards		

Related Documents

Document ID	Title

Subject Matter Expert

Name	Department
Leslie Grey	National Field Engineering, OSC

About Spare Parts Leaflets...

This document lists the lowest replaceable units (LRUs) for the standard version of the product. The LRUs are chosen by a team of Otis associates representing engineering and manufacturing.

While goal of this document is to make parts identification as easy as possible, the document cannot be all-inclusive. Elevator and escalator contracts classified as "special" or "custom" are not addressed here. For such contracts, please refer to specified information, the contract folder, TIPs, Field Education Articles, Construction Letters, etc. for further information.

If you have any suggestions about this document, please contact the subject matter expert listed on this page.

Compass CAN to RSL BOX

10-AAA25300AN

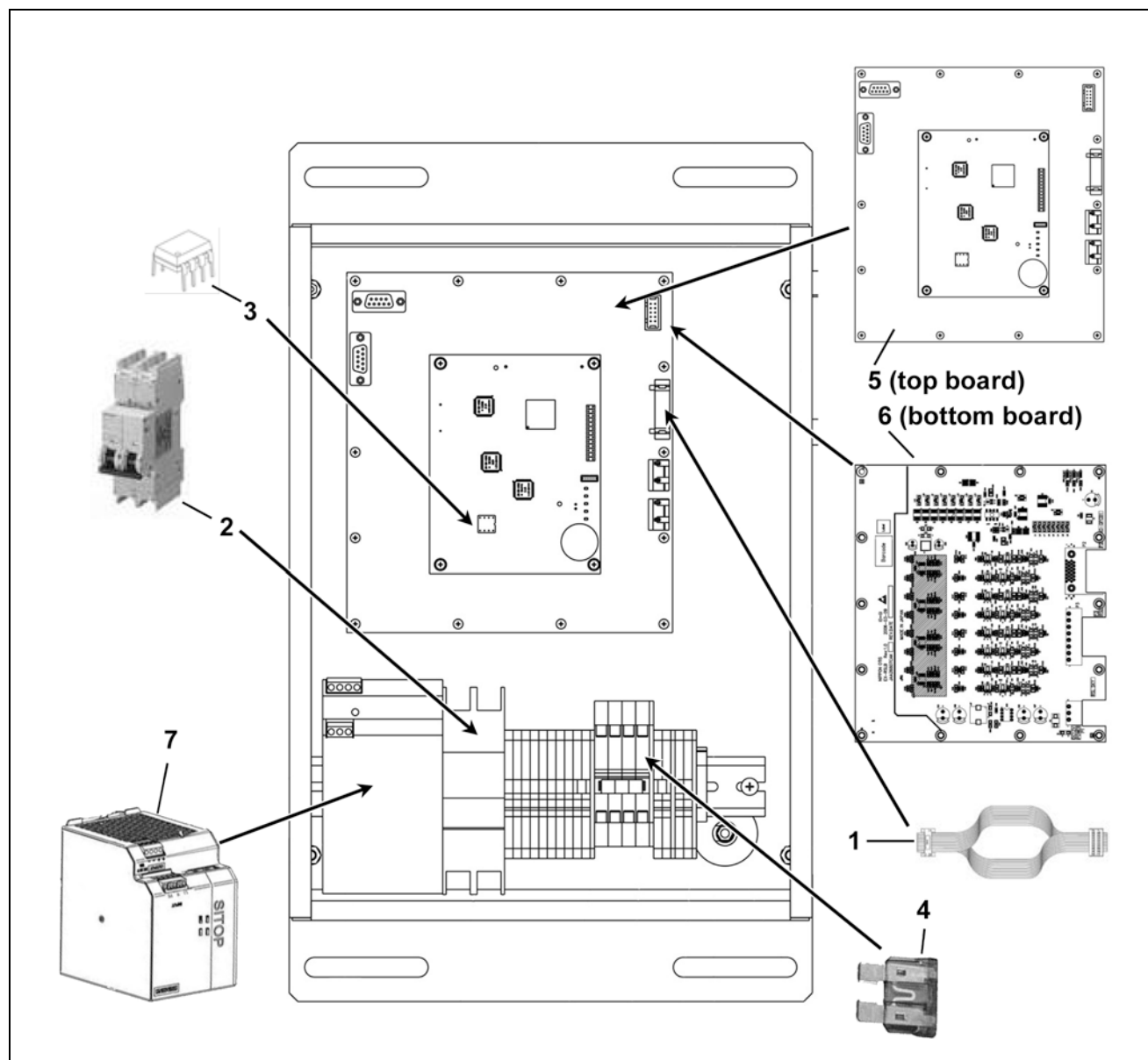

REF. No.	PART No.	DESCRIPTION
1	JAA174JJK1	Cable, GPCB to RSL PC Board
2	AAA637E43	Circuit Breaker, 3 A
3	AAA616NL31	EEPROM, 512K Bit Serial (SPI Bus)
4	AAA375C7	Fuse, 3 A, Blade Type
5	JFA26807CBN14	PC Board, GECB & I/O
6	JAA26807CAK3	PC Board, Quad RSL
7	AAA621AT14	Power Supply, 24 VDC, 10 A