

Aut-O-Safe® Return Unit

Spare Parts Leaflet

10-AAA7900BH

July 18, 2018 / Page 1 of 5

W/O VINTAGE for AAA7900BH

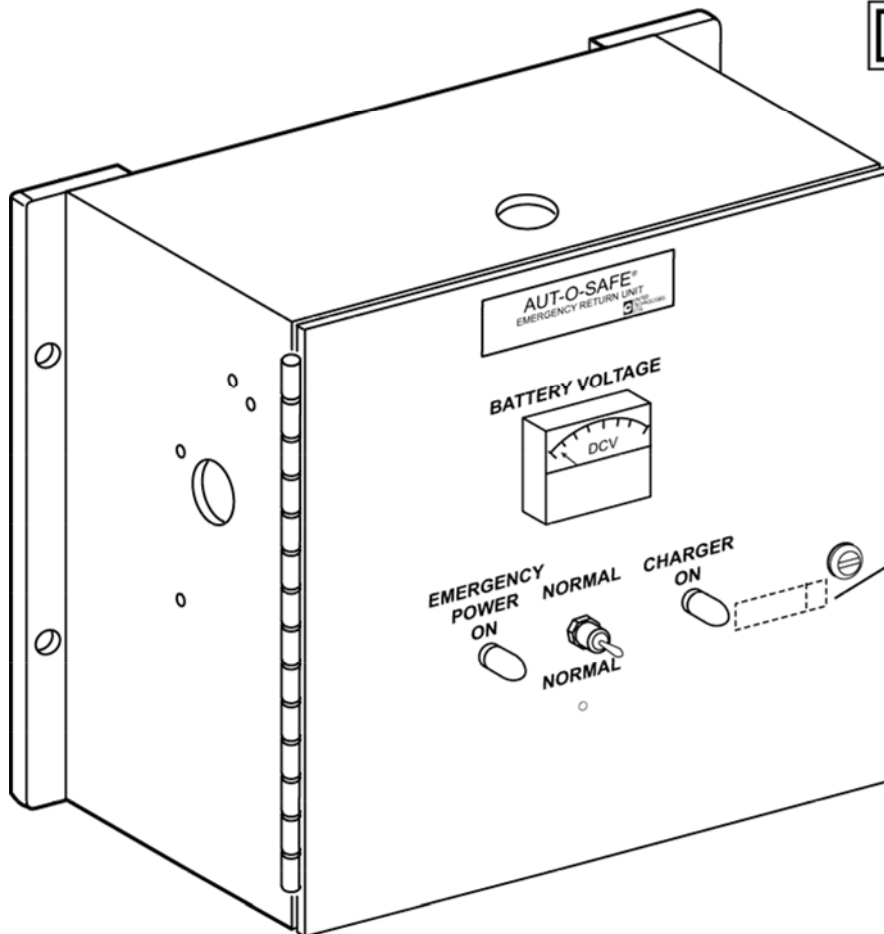

10 R-ABA7900BH

10 A-ACA7900BH

OTIS

This document does not contain any technical data subject to EAR or ITAR

SERVICE ENGINEERING
Otis Elevator Company
Bloomfield, Connecticut USA

Unpublished Work—© Otis Elevator Co.; 2018

Leaflet Description

This leaflet contains updated part numbers for the PC board element of the Otis Aut-O-Safe® product. This is an auxiliary power supply that prevents passenger entrapment due to power failure. It activates automatically when a building loses power.

The emergency return unit immediately returns the elevator to the lowest landing and opens the doors to allow passengers to exit, after which the elevator remains parked with its doors closed until normal power is restored.

Leaflet Revisions

Date Revised	Subject Matter Expert	Reason for Revision
September 1, 1997	Jeffrey S. Costley, Technical Writer	New SPL
June 1, 2000	John Doane	Update PC board part numbers.
May 1, 2008	Jeffrey Holmes	Update part numbers pp 4 and 5.
July 18, 2018	Paul Kerr	Added the ACA vintage information

Related Drawings

Drawing No.	Title	Drawing No.	Title
AAA7900BH	Assembly, Auto-Safe Return Unit	---	---
---	---	---	---

Related Documents

---	---
-----	-----

Subject Matter Expert

Name	Department
Ali Bozorgzadeh	OSC Electrical Engineering

About Spare Parts Leaflets...

This document lists the lowest replaceable units (LRUs) for the standard version of the product. The LRUs are chosen by a team of Otis associates representing engineering and manufacturing.

While goal of this document is to make parts identification as easy as possible, the document cannot be all-inclusive. Elevator and escalator contracts classified as "special" or "custom" are not addressed here. For such contracts, please refer to specified information, the contract folder, TIPS, Field Education Articles, Construction Letters, etc. for further information.

If you have any suggestions about this document, please contact the subject matter expert listed on this page.

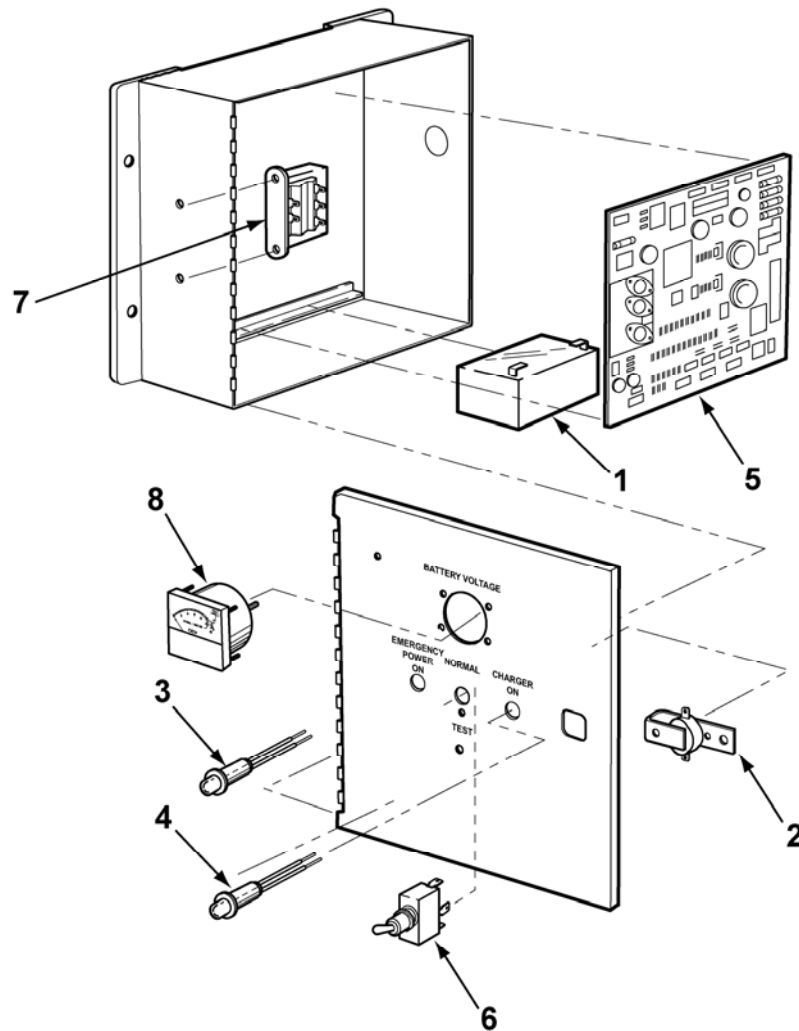

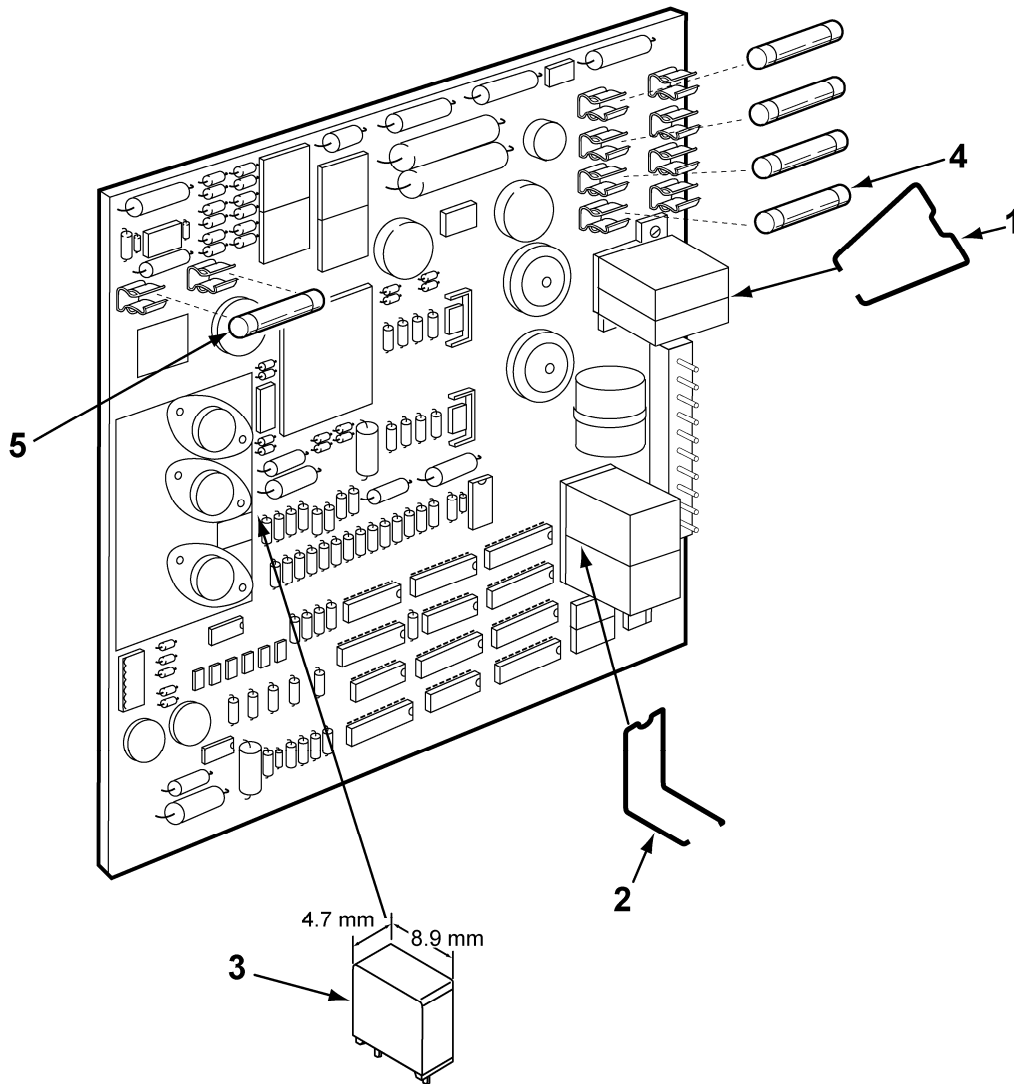

W/O VINTAGE
ABA7900BH
ACA7900BH

REF. No.	PART No.	DESCRIPTION
1	AAA718E15	Battery, 12 VDC
2	AAA731C2	Buzzer, Audible Alarm
3	AAA424Y1	Lamp, Neon, Amber
4	AAA424Y3	Lamp, Neon, Green
5	---	PC Board, Aut-O-Safe®,  p. 4
6	AAA177EM3	Switch, Toggle, Single-Pole, Double-Throw
7	AAA225GT2	Transformer, 115 VAC Primary, 48 V @ 1.2 A Secondary, 56 VA
8	AAA659D1	Voltmeter



W/O VINTAGE
ABA7900BH
ACA7900BH

REF. No.	PART No.	DESCRIPTION
1	AAA339MK3	Clip, Retaining,  CR1 Relay
2	AAA339MK2	Clip, Retaining,  CR2 Relay
3	AAA375BX4	Fuse, 0.75 A, 125 V, (F5)
4	375P26 AAA375BT26	Fuse, 1.5 A, 250 V, Type 3AG (F6)
5	AAA375CF3 AAA375BT20	Fuse, 30.0 A, 32 V, Type 3AG (F4)

Continued on next page.

Aut-O-Safe® PC Board

10-AAA7900BH

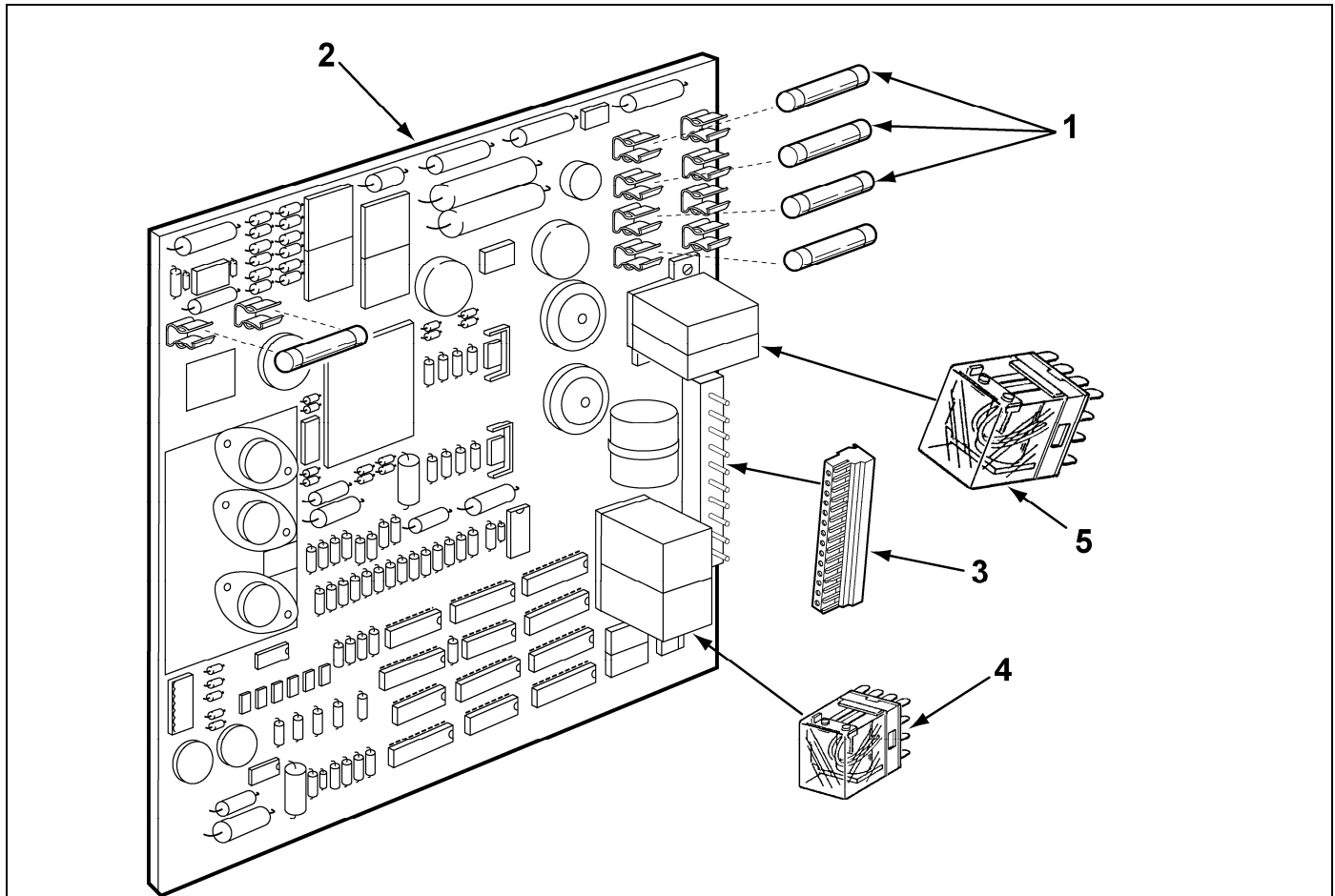

W/O VINTAGE
ABA7900BH
ACA7900BH

REF. No.	PART No.	DESCRIPTION
1	375P3 AAA375BT18	Fuse, 3.0 A, 250 V, Type 3AG (F1, F2, F3)
	375P2 AAA375BT27	Fuse, 2.0 A, 250 V, Type 3AG, (F1)  ACA26800RD2
2	ABA26800RD4 ACA26800RD4 ADA26800RD1	PC Board, Aut-O-Safe®, 110 VDC Door Power Supply
	ABA26800RD2 ACA26800RD2 ADA26800RD2	PC Board, Aut-O-Safe®, 220 VDC Door Power Supply
3	AAA447AP48 AAA447AP26 AAA447AP48	Plug, 14-Position (P1) (J1)
4	AAA613CZ17	Relay, 15 A Contacts, 12 VDC Coil, Two-Pole, Double-Throw (CR2)
5	AAA613CZ16	Relay, 15 A Contacts, 12 VDC Coil, Three-Pole, Double-Throw (CR1)