

Power Transformer  
for E411 MHS  
0-115 & 116-175 KVA

Spare Parts Leaflet

10-AAA8102J

July 17, 2013 / Page 1 of 6

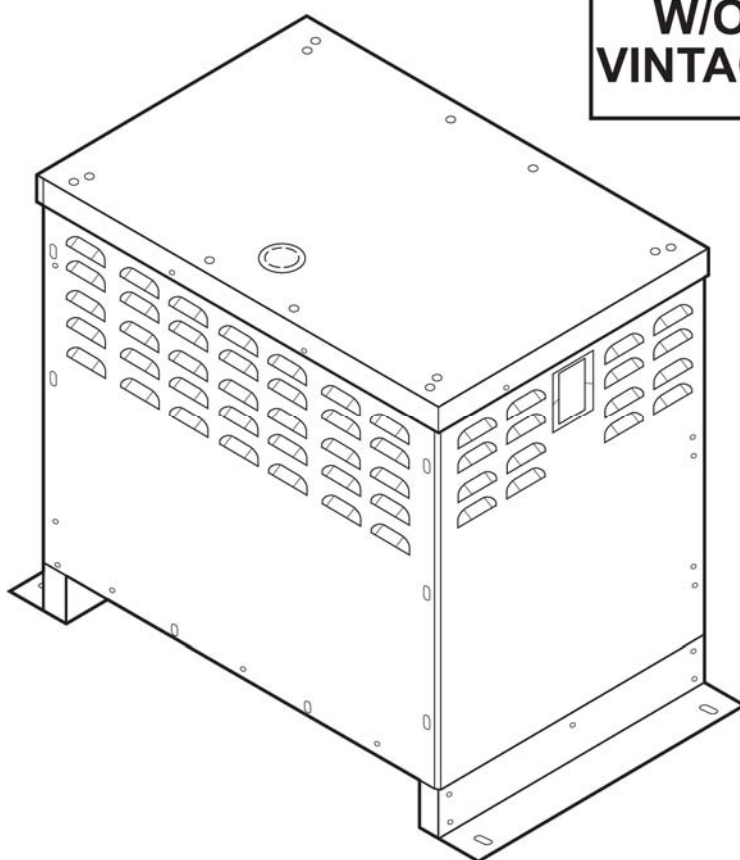

**W/O  
VINTAGE**

Unpublished Work—© Otis Elevator Co.; 2013

**OTIS**

Safety First!

SERVICE ENGINEERING  
Otis Elevator Company  
Bloomfield, Connecticut USA

## Leaflet Description

The transformer is intended for use with elevators as a drive isolation transformer providing power to a 3-phase full-wave SCR power converter. The drive isolation transformer applications include the geared No. 1, No. 2, 22CT, 29CT, 38BT, 43BT and gearless 70, 72, 74, 74D, 77A, 104HT, 131HT, 139HT, 155HT, 219HT, 269HT machines. It also has application on competitors' machines.

Requirements of fuses F101, F102, and F103. The type and rating of these fuses are defined by elevator duty. Check fuse being replaced for necessary rating.

## Leaflet Revisions

Date Revised	Subject Matter Expert	Reason for Revision
October 1, 2000	John Doane	New SPL
July 17, 2013	Ali Bozorgzadeh	Updated p/n AAA375BW58 description on p.6; brought the document into new template

## Related Drawings

Drawing No.	Title	Drawing No.	Title
AAA8102J	Power Transformer for	---	---

## Related Documents

Document ID	Title
---	---

## Subject Matter Expert

Name	Department
Ali Bozorgzadeh	OSC Service Engineering

## About Spare Parts Leaflets...

This document lists the lowest replaceable units (LRUs) for the standard version of the product. The LRUs are chosen by a team of Otis associates representing engineering and manufacturing.

While goal of this document is to make parts identification as easy as possible, the document cannot be all-inclusive. Elevator and escalator contracts classified as "special" or "custom" are not addressed here. For such contracts, please refer to specified information, the contract folder, TIPS, Field Education Articles, Construction Letters, etc. for further information.

If you have any suggestions about this document, please contact the subject matter expert listed on this page.

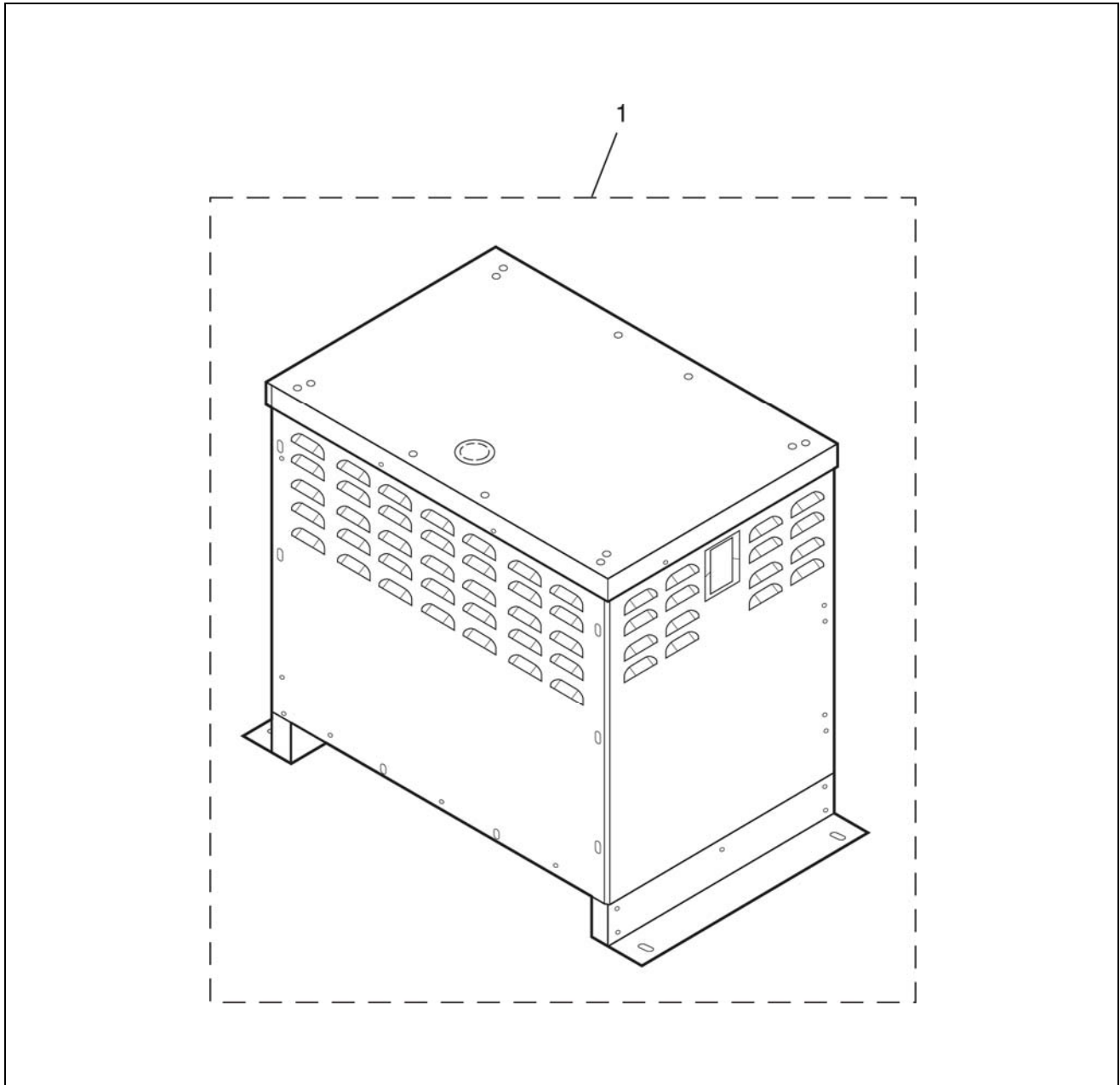

REF. No.	W/O VINTAGE PART No.	DESCRIPTION
1	---	Transformer, Power, 0-115 KVA, w/o EMI Filter
	---	Transformer, Power, 116-175 KVA, w/o EMI Filter
	---	Transformer, Power, 0-115 KVA, w/EMI Filter

**NOTE:** Transformer selection is based on individual elevator duty parameters. Ordering a replacement transformer requires that you contact your OSC customer service representative.

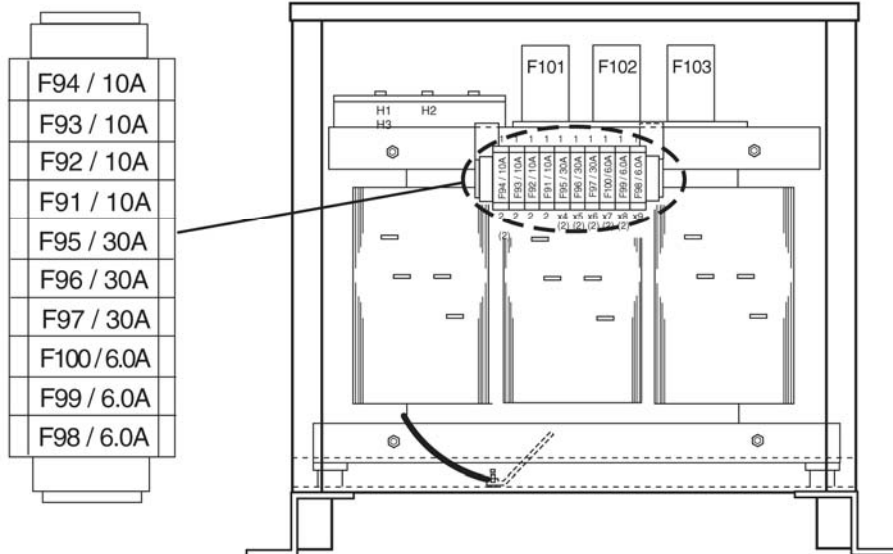
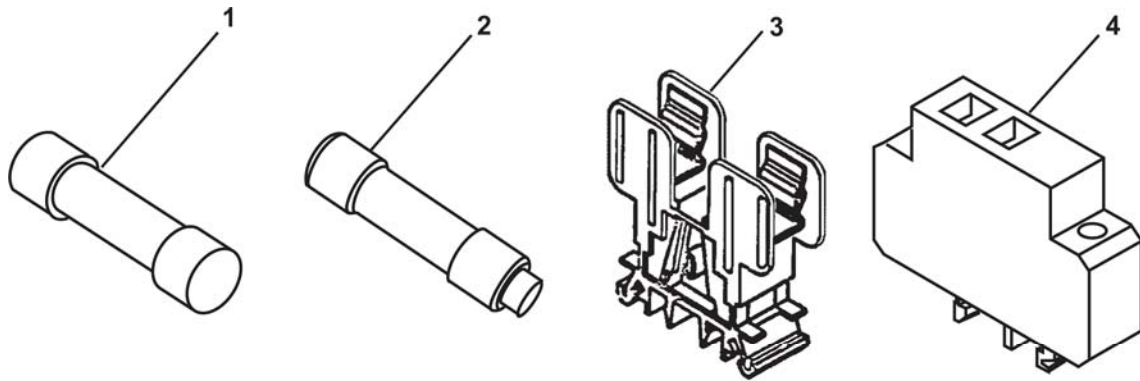

REF. No.	W/O VINTAGE PART No.	DESCRIPTION	SYMBOL
1	AAA375BV3	Fuse, Time-Delay, 10.0 A, 600 V (for controller power)	F91, F92, F93, F94
	AAA375BV1	Fuse, Time-Delay, 30.0 A, 300 V (for motor/field/brake power)	F95, F96, F97
2	AAA375BK33	Fuse, Time-Delay, 6.0 A, 600 V (for 6970 door operator power)	F98, F99, F100
3	AAA653K1	Holder, Fuse	F91–F94, F98–F100
4	AAA180DT1	Holder, Fuse	F95–F97

**NOTE:** Fuse rating of F91–F94 (amps) =  $F \cdot (0.816 \cdot I_{RUN})$  where:  $I_{RUN}$  = elevator motor DC run current provided by Otis for the application. F = temperature factor for the fuse provided by the fuse manufacturer.

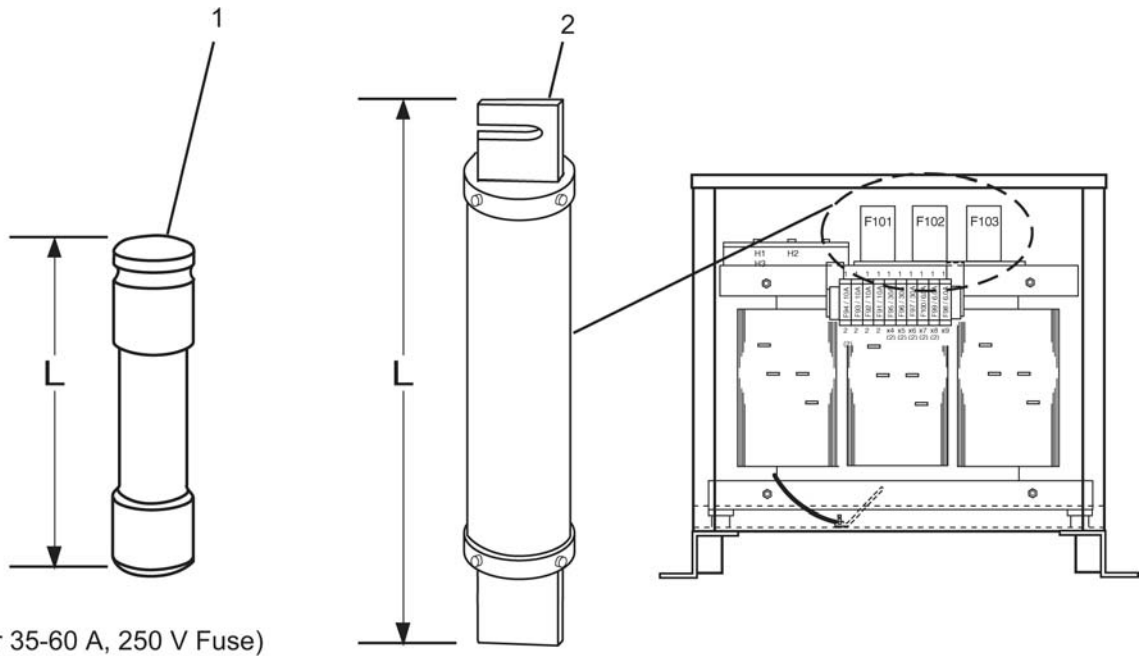

L =  
 3" (for 35-60 A, 250 V Fuse)  
 5-1/2" (for 35-60 A, 600 V Fuse)

L =  
 5-7/8" (for 70-100 A, 250 V Fuse)  
 7-1/8" (for 110-200 A, 250 V Fuse)  
 8-5/8" (for 225-400 A, 250 V Fuse)  
 10-3/8" (for 450-600 A, 250 V Fuse)  
 7-7/8" (for 70-100 A, 600 V Fuse)  
 13-3/8" (for 450-600 A, 600 V Fuse)

**Check fuse being replaced for required voltage or current rating.**

REF. No.	VINTAGE PART No.	DESCRIPTION	SYMBOL
1	AAA375BW42	Fuse, 35 A, 250 V	F101, F102, F103
	AAA375BW43	Fuse, 40 A, 250 V	
	AAA375BZ41	Fuse, 35 A, 600 V	
	AAA375BZ43	Fuse, 45 A, 600 V	
2	AAA375BW47	Fuse, 70 A, 250 V	
	AAA375BW48	Fuse, 75 A, 250 V	
	AAA375BW49	Fuse, 80 A, 250 V	
	AAA375BW50	Fuse, 90 A, 250 V	
	AAA375BW5	Fuse, 100 A, 250 V	
	AAA375BW54	Fuse, 150 A, 250 V	
	AAA375BW57	Fuse, 225 A, 250 V	

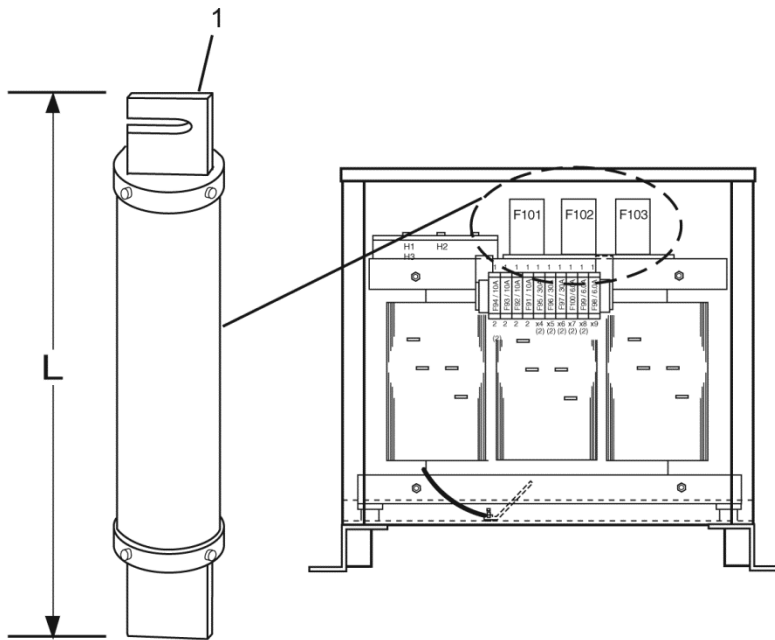

L =  
 5-7/8" (for 70-100 A, 250 V Fuse)  
 7-1/8" (for 110-200 A, 250 V Fuse)  
 8-5/8" (for 225-400 A, 250 V Fuse)  
 10-3/8" (for 450-600 A, 250 V Fuse)  
 7-7/8" (for 70-100 A, 600 V Fuse)  
 13-3/8" (for 450-600 A, 600 V Fuse)

REF. No.	VINTAGE PART No.	DESCRIPTION	SYMBOL
1	AAA375BW58	Fuse, 250 A, 600 V	F101, F102, F103
	AAA375BW59	Fuse, 300 A, 250 V	
	AAA375BW60	Fuse, 350 A, 250 V	
	AAA375BW61	Fuse, 400 A, 250 V	
	AAA375BW62	Fuse, 450 A, 250 V	
	AAA375BW63	Fuse, 500 A, 250 V	
	AAA375BW64	Fuse, 600 A, 250 V	
	AAA375BZ47	Fuse, 75 A, 600 V	
	AAA375BZ61	Fuse, 450 A, 600 V	
	AAA375BZ63	Fuse, 600 A, 600 V	
	AAA375BZ61	Fuse, 450 A, 600 V	