

ESCALATOR EMERGENCY STOP BOX

Spare Parts Leaflet

10-HE1204G

Dec 16th, 2019 / Page 1 of 8

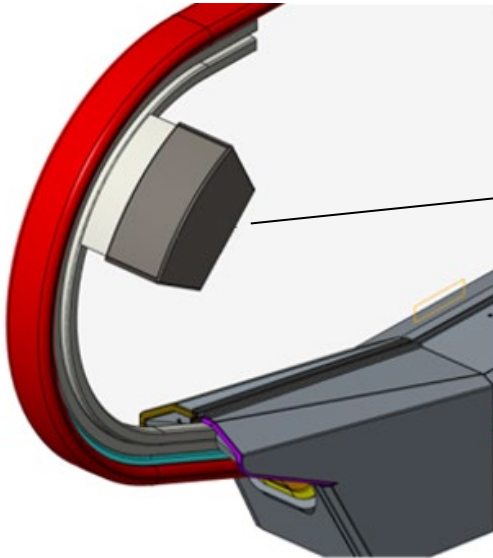

Unpublished Work—© Otis Elevator Co.

OTIS

This document does not contain
technical information subject to EAR
or ITAR

ELEVATOR ENGINEERING
Otis Elevator Company
OTIS ENGINEERING CHINA
ESCALATOR

ESCALATOR

10-HE1204G

History

Leaflet Description

EMERGENCY STOP BOX

Leaflet Revisions

Date Revised	Subject Matter Expert	Reason for Revision
Dec 16, 2019	Liu Wentong	New SPL (CN NO.: CNT2001404)
Jun 13, 2023	Li Ting	Label changed to silkscreen (CN NO.: CNT2200397)
Jan 13, 2023	Zhou Chao	Add OPA ESB box (CN NO.: CNT2300118)
Feb 8 th , 2023	Yue Peng	Add parts for ESB (CN NO.: CNT2300186)

Related Drawings

Drawing No.	Title	Drawing No.	Title
HAA26220AY	Emergency stop box		

Related Documents

Document ID	Title
HE1204G	ODS – ESB BOX FOR LINK_ANSI

Subject Matter Expert

Name	Department
Liu Wentong	SIT

About Spare Parts Leaflets...

This document lists the lowest replaceable units (LRUs) for the standard version of the product. The LRUs are chosen by a team of Otis associates representing engineering and manufacturing.

While goal of this document is to make parts identification as easy as possible, the document cannot be all-inclusive. Elevator and escalator contracts classified as “special” or “custom” are not addressed here. For such contracts, please refer to specified information, the contract folder, TIPs, Field Education Articles, Construction Letters, etc. for further information.

If you have any suggestions about this document, please contact the subject matter expert listed on this page.

ESCALATOR EMERGENCY STOP BOX

**Spare Parts Leaflet
10-HE1204G**

ESB BOX FOR UPPER LANDING, ANSI CODE, HDRLSTY<OPA



HAA26220AY5		
REF. No.	PART No.	DESCRIPTION
1	HAA308XL1	SHELL OF EMERGENCY ST
2	HAA308XL201	SHELL OF EMERGENCY ST
3	GAA346RF1	TRANSPARENT COVER OF
4	DAA177NPT1	STOP BUTTON
5	DAA177NPJ1	KEY SWITCH
6	DAA177NPS1	COVER SWITCH
7	HAA269D2	BUZZER

ESCALATOR EMERGENCY STOP BOX

Spare Parts Leaflet
10-HE1204G

ESB BOX FOR LOWER LANDING, ANSI CODE, HDRLSTY\diamondOPA



HAA26220AY6

REF. No.	PART No.	DESCRIPTION
1	HAA308XL2	SHELL OF EMERGENCY ST
2	HAA308XL201	SHELL OF EMERGENCY ST
3	GAA346RF1	TRANSPARENT COVER OF
4	DAA177NPT1	STOP BUTTON
5	DAA177NPJ1	KEY SWITCH
6	DAA177NPS1	COVER SWITCH
7	HAA269D2	BUZZER

ESCALATOR EMERGENCY STOP BOX

**Spare Parts Leaflet
10-HE1204G**

ESB BOX FOR UPPER LANDING, ANSI_NY CODE, HDRLSTY<OPA



HAA26220AY7

REF. No.	PART No.	DESCRIPTION
1	HAA308XL4	SHELL OF EMERGENCY ST
2	HAA308XL202	SHELL OF EMERGENCY ST
3	GAA346RF2	TRANSPARENT COVER OF
4	DAA177NPT1	STOP BUTTON
5	DAA177NPJ1	KEY SWITCH
6	DAA177NPS1	COVER SWITCH
7	HAA269D2	BUZZER
8	GAA346RG1	TRANSPARENT COVER OF
9	DAA635E1	START BUTTON

ESCALATOR EMERGENCY STOP BOX

Spare Parts Leaflet
10-HE1204G

ESB BOX FOR UPPER LANDING, ANSI CODE, HDRLSTY=OPA



REF. No.	PART No.	DESCRIPTION
	DAA308DQ4	
1	DAA308DP4	SHELL OF EMERGENCY ST
2	DAA177NPT1	STOP BUTTON
3	DAA177NPJ1	KEY SWITCH
4	DAA177NPS1	COVER SWITCH
5	GAA269V1	BUZZER

ESCALATOR EMERGENCY STOP BOX

**Spare Parts Leaflet
10-HE1204G**

ESB BOX FOR UPPER LANDING, ANSI_NY CODE, HDRLSTY=OPA



DAA26220CR3

REF. No.	PART No.	DESCRIPTION
1	DAA308JB3	SHELL OF EMERGENCY ST
2	DAA177NPT1	STOP BUTTON
3	DAA177NPJ1	KEY SWITCH
4	DAA177NPS1	COVER SWITCH
5	GAA269V1	BUZZER
6	DAA635E1	START BUTTON

ESCALATOR EMERGENCY STOP BOX

Spare Parts Leaflet
10-HE1204G

ESB BOX CABLE



1

HE120X			
REF. No.	PART No.	CONTROL SYSTEM	DESCRIPTION
1	HAA174BZA1	GECS FOR ANSI	S63.1 Cable FOR UPPER LANDING, ANSI CODE
	HAA174BZA2		S63 Cable FOR LOWER LANDING, ANSI CODE
	HAA174BZA3		S63.1 Cable FOR UPPER LANDING, ANSI_NY CODE
	HAA174BZA4		S63 Cable FOR LOWER LANDING, ANSI_NY CODE
	HAA174BZA5		S28 Cable FOR UPPER LANDING
	HAA174BZA6		S29 Cable FOR LOWER LANDING
	HAA174BZA7		DT Cable FOR UPPER LANDING