

OVF-409R, OVF-412R  
ReGen Drives

Spare Parts Leaflet  
10-JAA21312AAC

February 1, 2012 / Page 1 of 7

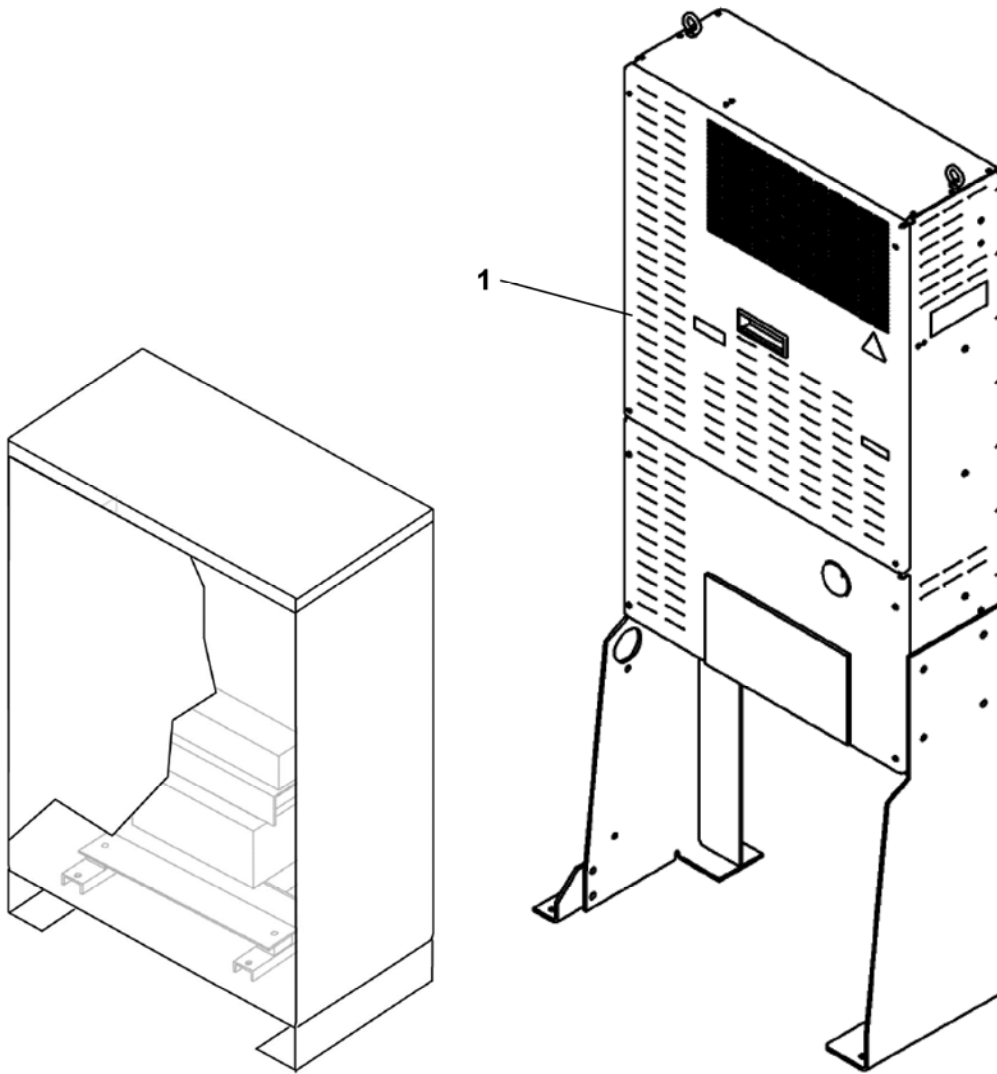

Unpublished Work—© Otis Elevator Co.; 2012

**OTIS**

Safety First!

SERVICE ENGINEERING  
Otis Elevator Company  
Bloomfield, Connecticut USA

## Leaflet Description

This leaflet lists spare parts for type JAA21312AAC (OVF-409/90AR) and JBA21312AAA (OVF-412/412AR) regenerative AC drives used as part of the Elevonic® R-Series control system.

## Leaflet Revisions

Date Revised	Subject Matter Expert	Reason for Revision
February 23, 2011	Chris Koenig	New SPL
February 1, 2012	Chris Koenig	Updated information on pp. 3 and 6

## Related Drawings

Drawing No.	Title	Drawing No.	Title
AAA21310AF	Variable Frequency Controller NSAA Elevonic® R-Series Control System	KBA21310AAC	25A Regenerative Drive Assembly: OVFR1A-402
KBA21310AAA	40A Regenerative Drive Assembly: OVF 404R	ABA21310Z	60A Regenerative Drive Assembly: OVFR1A-406
AAA21305BT	Controller Box	JAA21312AAC	90A Regenerative Drive Assembly: OVFR1A-409
AAA21305BV	Brake Box	JBA21312AAA	120A Regenerative Drive Assembly: OVFR1A-412
ADA21305BR	Transformer Box	---	---

## Related Documents

Document ID	Title
SPL 10-AAA21305BV	NSAA Global Control System Brake Module
SPL 10-AAA21305BT	Global Control System for Modernization Controller Box
SPL 10-ADA21305BR	Global Control System Transformer Box
SPL 10-AAA21799L	Transformer Cabinet
SPL 10-AAA21799M	Transformer Cabinet

## Subject Matter Expert

Name	Department
Chris Koenig	New Product Development, OSC

## About Spare Parts Leaflets...

This document lists the lowest replaceable units (LRUs) for the standard version of the product. The LRUs are chosen by a team of Otis associates representing engineering and manufacturing.

While goal of this document is to make parts identification as easy as possible, the document cannot be all-inclusive. Elevator and escalator contracts classified as "special" or "custom" are not addressed here. For such contracts, please refer to specified information, the contract folder, TIPs, Field Education Articles, Construction Letters, etc. for further information.

If you have any suggestions about this document, please contact the subject matter expert listed on this page.

OVF-409R, OVF-412R

10-JAA21312AAC

ReGen Drives

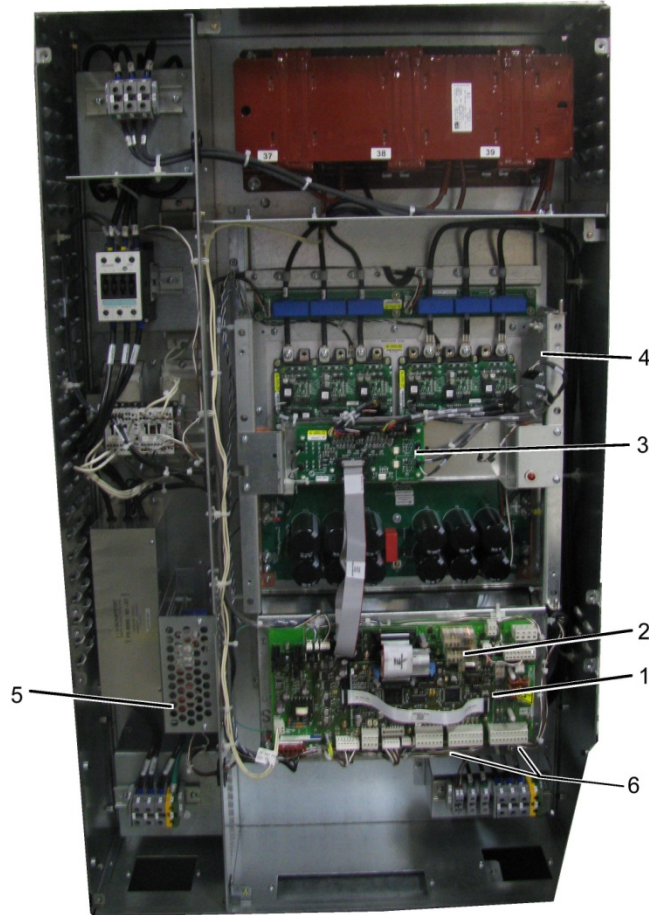

	90AR JAA21312AAC	120AR JBA21312AAA	
REF. No.	PART No.	PART No.	DESCRIPTION
1	AEA26800AKT1		Global Drive CPU Board (GDCB),  NOTE
2	ACA26800AKU2		Global Drive High Voltage Interface Board (HVIB)
3	LA46S3959-0010		IBX Interface Board (IBX)
4	LA46S3899-0010		Gate Power Supply Board (GPB)
5	KAA26800AAR1		Logic Power Supply (LPS)
6	AAA6091AJ3		Fan
---	AAA230924CAN		Software, GDCB (  TIP 1.1.22.1-1 for download instructions)

**NOTE:** Software not included on this PCB.

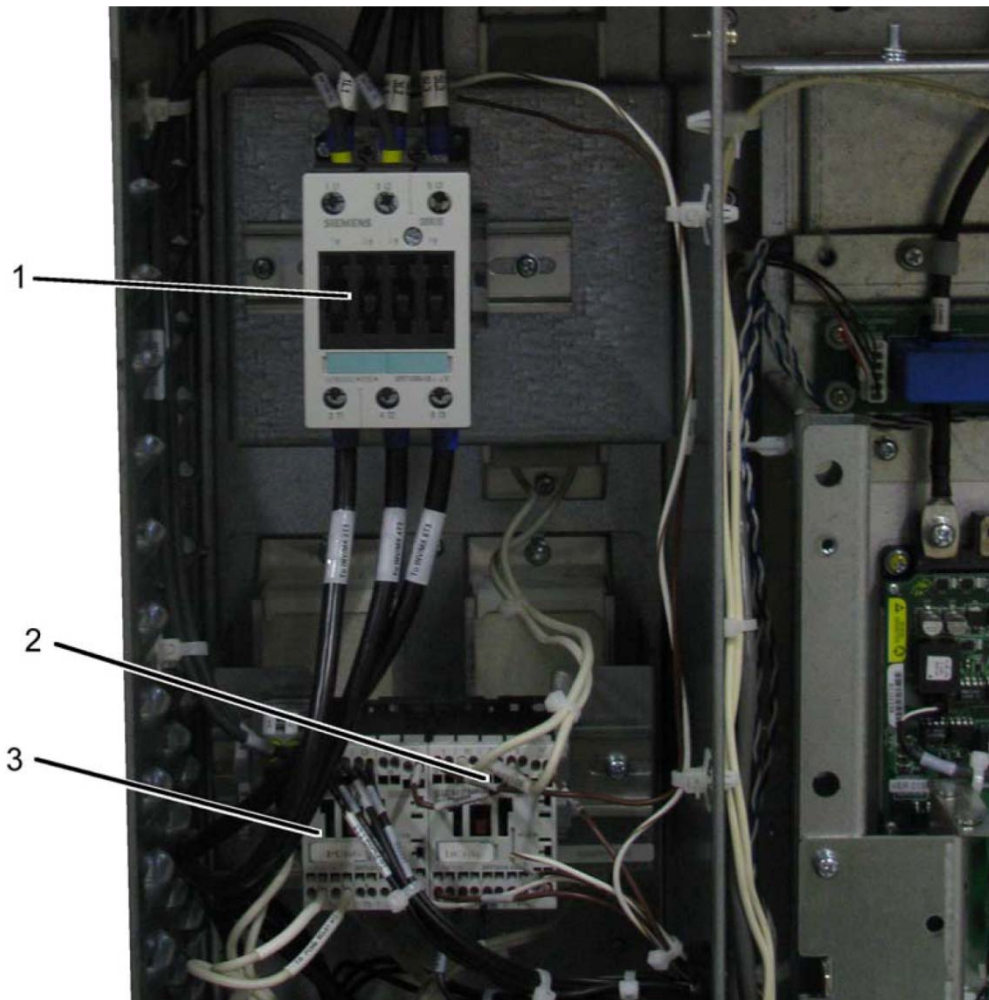

	90AR JAA21312AAC	120AR JBA21312AAA	
REF. No.	PART No.	PART No.	DESCRIPTION
1	JAA638AAB1		Inverter Control Relay Contactor (INV)
2	AAA638AM1		Bus Discharge Relay Contactor (DCHG)
3	AAA638AM3		Precharge Relay Contactor (PCHG)

OVF-409R, OVF-412R  
GDCB, HVIB Connectors

10-JAA21312AAC

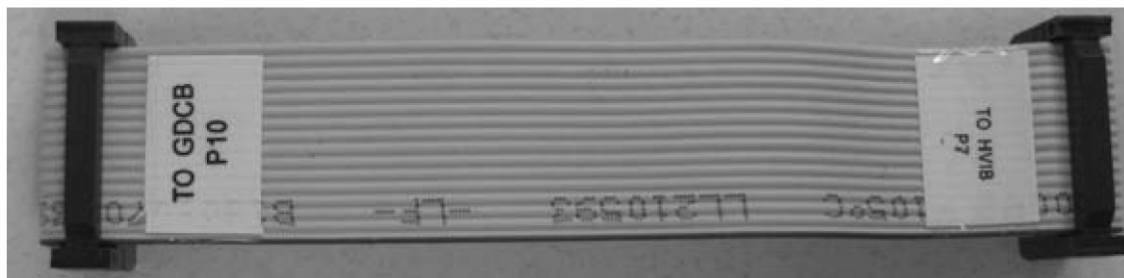
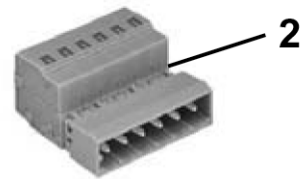
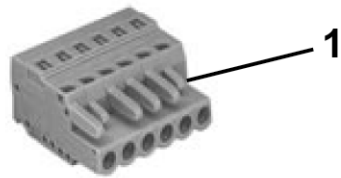

	90AR JAA21312AAC	120AR JBA21312AAA	
REF. No.	PART No.	PART No.	DESCRIPTION
1	AAA176HH66 AAA447AP21		GDCB-P5 (7-pole WAGO)
	AAA176HH75 AAA447AP23		GDCB-P6 (9-pole WAGO)
	AAA176HH65 AAA447AP18		GDCB-P8 (4-pole WAGO)
	AAA176HH70 AAA447AP24		GDCB-P11 (10-pole WAGO)
	AAA176AP66 AAA447AP16		HVIB-P100 (2-pole WAGO)
	AAA447AP7213 AAA447AP22		HVIB-P101 (8-pole WAGO)
2	AAA176HH77		HVIB-P102

10-JAA21312AAC

OVF-409R, OVF-412R  
GDCB, HVIB Ribbon Cables

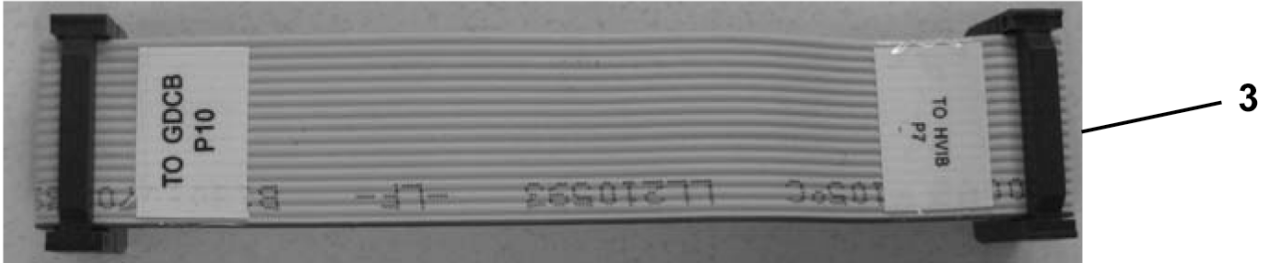

	90AR JAA21312AAC	120AR JBA21312AAA	
REF. No.	PART No.	PART No.	DESCRIPTION
3	<del>46S4031-0030</del> JAA21600AGJ26		HVIB-P5 to GDCB-P10 Ribbon Cable
	05T00933-0010 JAA21600AGJ15		HVIB-P7 to IBX-J7 Ribbon Cable
	05T00943-0010 JAA21600AGJ14		HVIB-P6 to IBX-J6 Ribbon Cable
	46S04031-0020 JAA21600AGJ25		HVIB-P10 to GDCB-P2 Ribbon Cable
	46S04031-0010 JAA21600AGJ24		HVIB-P9 to GDCB-P1 Ribbon Cable

OVF-409R, OVF-412R

10-JAA21312AAC

ReGen Drives—Contactors

REF. No.	90AR JAA21312AAC PART No.	120AR JBA21312AAA PART No.	DESCRIPTION
1	LA46S3968-0010		Current Sensor PCB
2	46S04031-0070 JAA660AAE1		Thermal Sensor—Inverter Heat Sink (HVIB-P3)
3	46S04031-0080 JAA660AAE2		Thermal Sensor—Converter Heat Sink (HVIB-P13)