

Ultra Drive 40A Drive Assembly

Spare Parts Leaflet
10-KAA21310ABL
Sep. 21, 2017 / Page 1 of 4

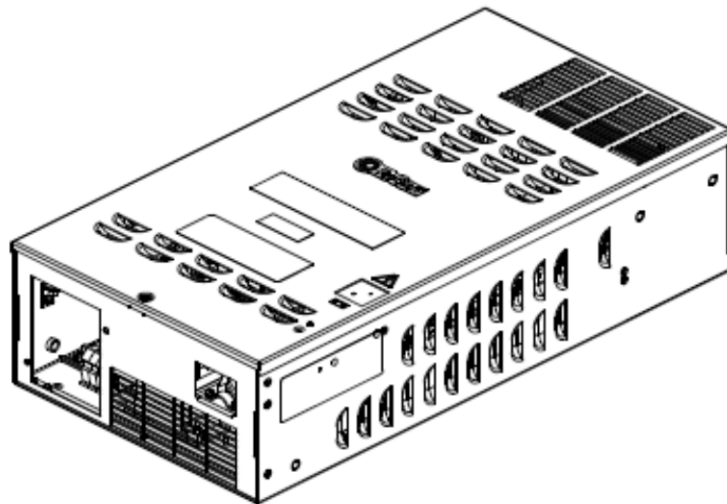

Parts	Application	Current Rating (Acc./Run)
KDA21310ABL1	CHINA/PAA, INCREMENTAL ENCODER, NOT SUPPORT OPTIMIZED ARO	40Arms/22Arms
KDA21310ABL2	CHINA/PAA, INCREMENTAL ENCODER, SUPPORT OPTIMIZED ARO	
KDA21310ABL3	CHINA/PAA, SINUSOIDAL ENCODER, NOT SUPPORT OPTIMIZED ARO	
KDA21310ABL4	CHINA/PAA, SINUSOIDAL ENCODER, SUPPORT OPTIMIZED ARO	
KDA21310ABL5	EUROPE, 110VAC SFC	
KDA21310ABL6	EUROPE, 48VDC SFC	
KDA21310ABL7	NSAA, 480 VAC INPUT	
KDA21310ABL8	NSAA, 208-240 VAC INPUT	
KDA21310ABL9	JIS	
KDA21310ABL10	CHINA/PAA, INCREMENTAL ENCODER, NOT SUPPORT OPTIMIZED ARO	
KDA21310ABL11	CHINA/PAA, SINUSOIDAL ENCODER, NOT SUPPORT OPTIMIZED ARO	

Unpublished Work—© Otis Elevator Co.; 2014



Safety First!

CEC-E Asia
Otis Elevator Company
KOREA

Leaflet Description

This leaflet provides spare part information on the KDA21310ABL Ultra Drive (UD) 40A product. There are 9 arrangements in the drive product. There are slight variations within each drive arrangement.

Leaflet Revisions

Date Revised	Subject Matter Expert	Reason for Revision
Nov, 07, 2008	SeungHyoung, Bae	New SPL
Nov. 17, 2014	SeungHyoung, Bae	Drawing is updated to KBA
Sep. 21, 2017	SeungHyoung, Bae	Drawing is updated to KDA. Contactor assembly (DAA21305CG) and fan assembly (KAA21305ACE) are added as a spare parts as SIT requested.

Related Drawings

Drawing No.	Title	Drawing No.	Title
KDA21310ABL	Ultra Drive (UD) 40A, OVFR03B-404		

Related Documents

Document ID	Title

Subject Matter Expert

Name	Department
SeungHyoung Bae / JeongKi Shin	CEC-E Asia

About Spare Parts Leaflets...

This document lists the lowest replaceable units (LRUs) for the standard version of the product. The LRUs are chosen by a team of Otis associates representing engineering and manufacturing.

While goal of this document is to make parts identification as easy as possible, the document cannot be all-inclusive. Elevator and escalator contracts classified as "special" or "custom" are not addressed here. For such contracts, please refer to specified information, the contract folder, TIPs, Field Education Articles, Construction Letters, etc. for further information. If you have any suggestions about this document, please contact the subject matter expert listed on this page.

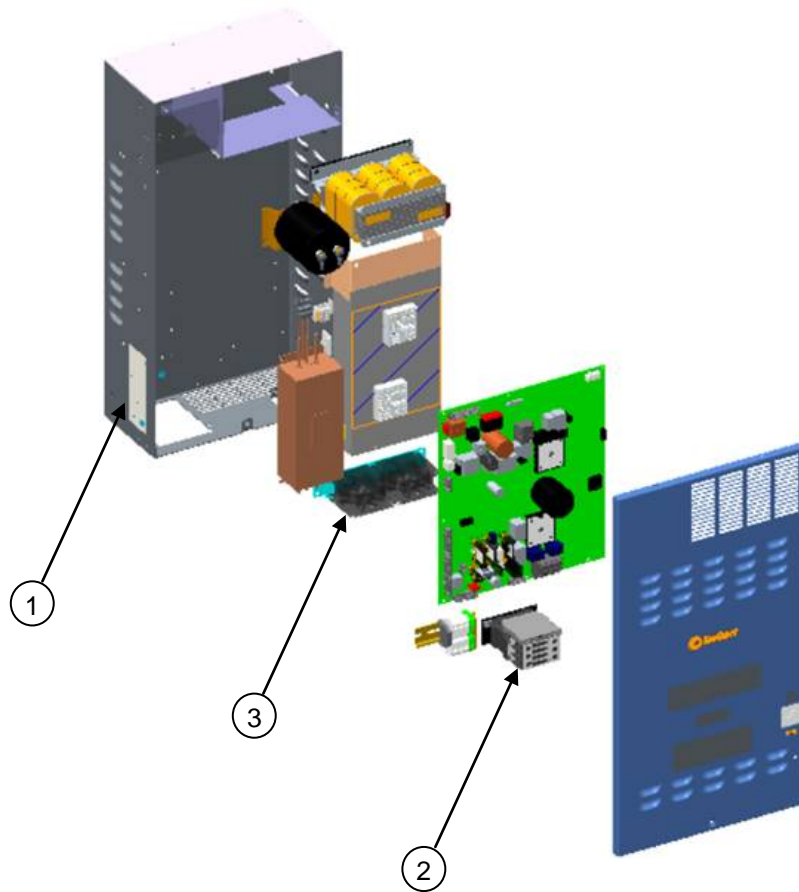

REF. No.	Part No.	DESCRIPTION
	VINTAGE	
1	KAA21310ABL1 KBA21310ABL1 KCA21310ABL1 KDA21310ABL1	CHINA/PAA, INCREMENTAL ENCODER, NOT SUPPORT OPTIMIZED ARO
	KAA21310ABL2 KBA21310ABL2 KCA21310ABL2 KDA21310ABL2	CHINA/PAA, INCREMENTAL ENCODER, SUPPORT OPTIMIZED ARO
	KAA21310ABL3 KBA21310ABL3 KCA21310ABL3 KDA21310ABL3	CHINA/PAA, SINUSOIDAL ENCODER, NOT SUPPORT OPTIMIZED ARO
	KAA21310ABL4 KBA21310ABL4 KCA21310ABL4 KDA21310ABL4	CHINA/PAA, SINUSOIDAL ENCODER, SUPPORT OPTIMIZED ARO
	KAA21310ABL5 KBA21310ABL5 KCA21310ABL5 KDA21310ABL5	EUROPE, 110VAC SFC
	KAA21310ABL6 KBA21310ABL6 KCA21310ABL6 KDA21310ABL6	EUROPE, 48VDC SFC
	KAA21310ABL7	NSAA, 480 VAC INPUT
		REGENERATIVE DRIVE PACAKGE OVFR03B-404 (Acc: 40Arms, Run:22Arms)

	KBA21310ABL7 KCA21310ABL7 KDA21310ABL7		
	KAA21310ABL8 KBA21310ABL8 KCA21310ABL8 KDA21310ABL8	NSAA, 208~240 VAC INPUT	
	KAA21310ABL9 KBA21310ABL9 KCA21310ABL9 KDA21310ABL9	JIS	
	KAA21310ABL10 KBA21310ABL10 KCA21310ABL10 KDA21310ABL10	CHINA/PAA, INCREMENTAL ENCODER, NOT SUPPORT OPTIMIZED ARO	
	KAA21310ABL11 KBA21310ABL11 KCA21310ABL11 KDA21310ABL11	CHINA/PAA, SINUSOIDAL ENCODER, NOT SUPPORT OPTIMIZED ARO	
2	KAA21305ACF1 KBA21305ACF1 DAA21305CG1	To be assembled in the K_A21310ABL1/3/5	Contactor Assembly
	KAA21305ACF2 KBA21305ACF2 DAA21305CG2	To be assembled in the K_A21310ABL2/4	
	KAA21305ACF3 KBA21305ACF3 DAA21305CG3	To be assembled in the K_A21310ABL7/8	
	KAA21305ACF3	To be assembled in the K_A21310ABL9 (Contactor Assembly is removed from this arrangement)	
	KAA21305ACF4 KBA21305ACF4 DAA21305CG4	To be assembled in the K_A21310ABL6	
	KBA21305ACF5 DAA21305CG1	To be assembled in the K_A21310ABL10/11	
3	KAA21305ACE1	Fan Assembly	