

**Wire Rope,  
Coated Steel Belts (CSB),  
and Tools**

**Spare Parts Leaflet**

**11-AAA712P/Q**

**December 14, 2022 / Page 1 of 31**

**W/O VINTAGE**

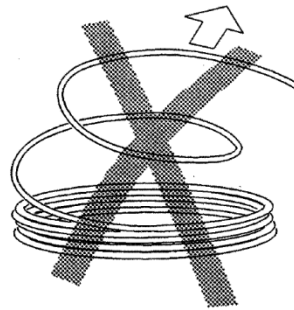
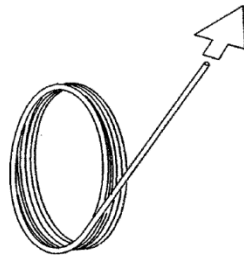
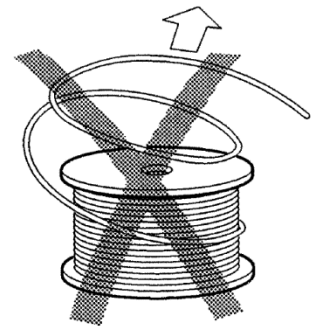
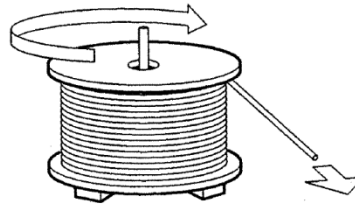
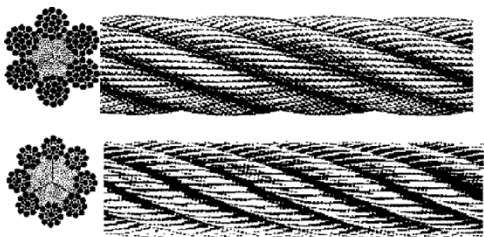

**OTIS**

This document does not contain any  
technical data subject to EAR or ITAR

**SERVICE ENGINEERING  
Otis Elevator Company  
Bloomfield, Connecticut USA**

Unpublished Work—© Otis Elevator Co.; 2022

**Leaflet Description**

This leaflet provides information to order elevator wire ropes for hoist, compensation, governor, and miscellaneous applications. Information on rope shackles, shackle sundries, and hitch springs is also included. In this revision, we added rope clips, wire rope part numbers, and rope ordering instructions.

**Leaflet Revisions**

<b>Date Revised</b>	<b>SME</b>	<b>Reason for Revision</b>
February 1998	Sean Mismas	Creation of a new parts leaflet.
December 20, 2004	Sean Mismas	Added new instruction on Order Form, page 25
March 10, 2005	Sean Mismas	Added new info on page 12; added coated steel belt for Gen2 application on page 17; updated Order Form on page 26.
April 10, 2007	Sean Mismas	Changed “m” dimension to “T” dimension in the order form
May 30, 2008	Troy Chicoine	Changed listing on page 12 that mistakenly reads “extra light strength” to the correct description of “extra high strength.”
October 23, 2008	Gary Mendrala	Substituted p/n AAA717W1 with p/n AAA717X1 and p/n AAA717R1 with p/n AAA717AD1 in ref. 1, on p. 17
March 10, 2009	Gary Mendrala	Added p/n 133AR, 133E, 227C, AAA227E, 229Y, AAA339NL, AAA2314, AAA712W58, and data plates info; updated Wire Rope Order Form
September 22, 2009	Gary Mendrala	Added new parts on pages 13–19, added compensation rope wedge shackles parts, and updated rope cutting parts.
February 17, 2010	Gary Mendrala	Added rope-related supplies on page 33; updated parts on pages 5–8, 10–11, and 24–25.
May 5, 2010	Gary Mendrala	Added thimble rod sockets and washers on pp. 24–30.
September 15, 2010	Gary Mendrala	Updated hitch spring info and added AAA717AJ2 and AAA102AW5.
March 9, 2011	Gary Mendrala	Updated spring, spring seat washer, & rope reeling parts info.
June 29, 2011	Gary Mendrala	Update pp 5, 10, 11, 14, and 18 adding information.
September 19, 2012	Gary Mendrala	Updated pp. 21, 22, 28, 29, 30, and 41 with new information
June 18, 2014	Gary Mendrala	Add CSB cutting tool & blades (MT-114419-1, -2), DAA712H1, AAA712AJ1, 2, revised order forms.
September 24, 2014	Gary Mendrala	Added p/n AAA712P131 as a replacement for VP-843650; Added AAA231U16, 68, 69.
April 22, 2015	Gary Mendrala	Add AAA712W15; Moved sockets to SPL 11-AAA6612AW
September 30, 2015	Gary Mendrala	Add AAA712W46; Correct AAA712W9 description
June 15, 2016	Juan Murillo	Updated Standard Wire Rope Order Form
August 31, 2016	Gary Mendrala	Updated the Order Forms on pp. 28-29; Added ropes p/ns AAA712W1, W19, W41, W43, W44, W53, W61, W62, and p/n AAA712AJ1
July 12, 2017	Gary Mendrala	Added AAA712W49, 51, 35, 40, 48, 50, 52 and AAA712Q46–50
July 26, 2017	Gary Mendrala	Updated Order Forms
September 13, 2017	Gary Mendrala	Added p/n AAA712W8 on p. 20
September 27, 2017	Gary Mendrala	Added p/ns AAA712AJ3 and AJ4 on p. 20
September 5, 2018	Gary Mendrala	Added 43kN FTI Belt and Tag AAA102AGW6; Added 86kN Belt and Tag
October 17, 2018	Gary Mendrala	Corrected information for p/n AAA712Q113 on p. 10
December 18, 2019	Gary Mendrala	Added p/n AAA717AJ4 on p. 21
April 8, 2020	Gary Mendrala	Added minimum breaking load in lbs. to CSB description on p. 21

*(Continued on next page)*

# History (continued)

**11-AAA712P/Q**

## Leaflet Revisions

Date Revised	SME	Reason for Revision
February 3, 2021	Gary Mendrala	Update MBL to ISO values
March 2, 2022	Gary Mendrala	Corrected typo in Order Form on p. 29
December 14, 2022	Gary Mendrala	Updated Order Forms on pp. 30–31

## Related Drawings

Drawing No.	Title	Drawing No.	Title
AAA712P	6-Strand Elevator Wire Rope	6612AN	Wedge Clamp Rope Hitches
AAA712Q	8- Strand Elevator Wire Rope	AAA6612AW	Rope Hitch Arrangement
AAA712W	Ropes	AAA717R / ...W	Coated Steel Belt
AAA717AD / ...X	Coated Steel Grooveless Belt		

## Related Documents

Document ID	Title
OMM 11.0-A	Ropes (SWP)
ORM 11.1.1-A	Re-Roping Procedures
SPL C-621A	Springs
SPL 11-AAA6612AW	Wire Rope Terminations
TIP 0.1.5-7	Top-of-Car Handrail Kit and Toe Guards
TIP 11.0-2	Rope Lubrication
TIP 11.0-3	Rope Thimble Rods
TIP 11.0-4	Wire Rope Application Policy
TIP 11.0-5	Wire Rope Stretch
TIP 11.1-10	Shackle Lacing Wear: High Rise Lang Lay Rope Applications
TIP 11.1-12	Guidelines for Troubleshooting Hoist Ropes
TIP 11.1-2	Hoist Rope Wear
TIP 11.1-8	Restraining Wedge Clamp Shackles
TIP 11.1-9	Hoist Rope Carpet Wiper Installation and Maintenance
TIP 6.0-11	Standard Sheave Guards for Non-Otis (Competitor) and Older Otis Machines
TIP 6.1.1-14	Installation Procedure for Full Cover Sheave Guard (w/ Carpet Wiper) for 130HT, 131HT, & 139HT Machines
TIP 6.1.1-15	Installation Procedure for Sheave Full Cover Guard (w/Carpet Wiper) for 70 and 72 Machines
TIP 6.1.1-16	Installation Procedure for Sheave Full Cover Guard (w/Carpet Wiper) for 74 and 77 Machines
TIP 6.1.3-3	219HT Machine Sheave Guard Installation (w/Carpet Wiper)
TIP 6.2.0-15	#1 (19BT), #2 (27BT), 17CT, 22CT Geared Machine Sheave Guard Install (w/ Carpet Wiper)
TIP 6.2.4-2	29CT Geared Machine Sheave Full Cover Guard Installation (with Carpet Wiper)

## Subject Matter Expert

Name	Department
Gary Mendrala	OSC Service Engineering

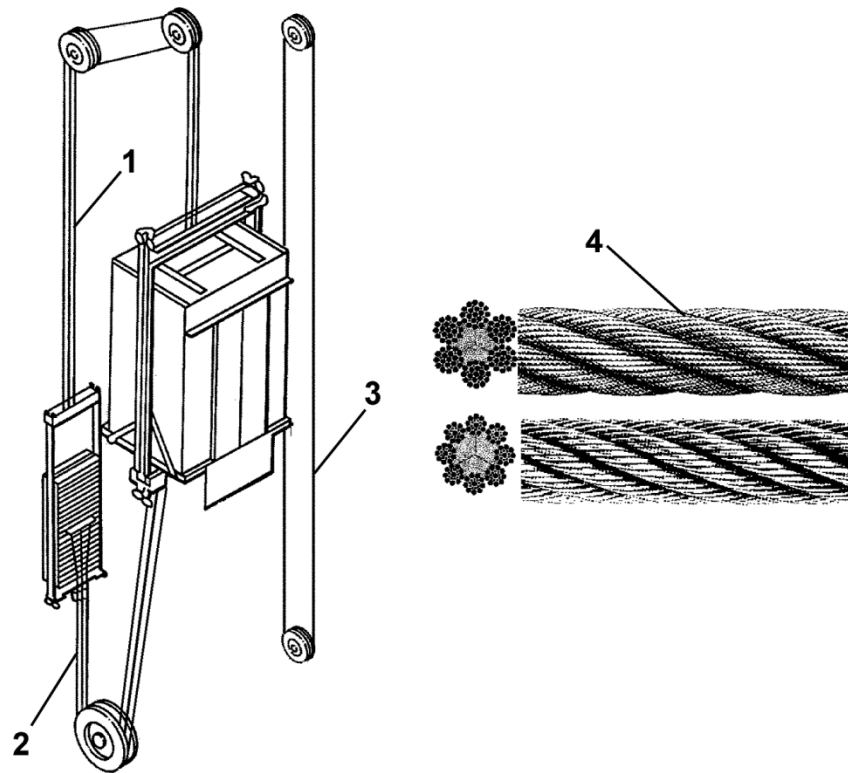

**NOTE:** If you know what type of rope to order, go directly to **Wire Rope Order Form** on pages 29 and 30. Otherwise, use the table below to locate the appropriate rope guidelines for your individual needs.

REF. No.	PAGE No.	DESCRIPTION
1	5–6	Hoist Rope, Replacement Guidelines
2	7–8	Compensation Rope, Replacement Guidelines
3	9–10	Governor Rope, Replacement Guidelines
*	11	Miscellaneous Ropes Replacement Guidelines
4	12–13	Physical Characteristics of Common Rope Constructions
*	14–21	Wire Rope Part Numbers
*	22	CSB
*	22–27	Rope Accessories and Tools
*	28	Wire Rope Order Instructions
*	29–30	Wire Rope Order Form

# Hoist Rope

## Replacement Guidelines

11-AAA712P/Q

To order hoist rope, you need to know the following seven features:

1. Hoist Rope: Traction Elevator or Drum Elevator
2. Lay: Regular or Lang
3. Construction: 6-strand, 8-strand, or 9-strand
4. Grade: Extra High Strength = EH; Traction Steel = M; Iron = L
5. Diameter
6. Number of Ropes and Rope Length
7. Machine Type, Machine Number

When you have the above information, use it to fill out the *OSC Wire Rope Order Form* at the end of this leaflet.

- **Guidelines:**

In general, you should “replace-in-kind” with the same type rope originally installed. The original rope type can usually be found on the rope data tag, car crosshead data plate, or elevator layout diagram. Otherwise, identify the six features listed above from the current ropes. Note that all hoist rope is preformed, which replaces non-preformed for hoist applications. For machines 18ATF, 156MST, PM138, and 30T, order single-tensile rope. For other machines, order dual-tensile hoist rope. For rope terminations, see SPL 11-AAA6612AW. 8 x 19, 8 x 21, and 8 x 25 strand constructions are considered equivalent and are interchangeable. The same is true for 6-strand constructions. 6- and 8-strand constructions are not interchangeable. Sheave liner applications must use Lang Lay rope.

- **Lay:**

There are two types of lay: Regular Lay or Lang Lay.

**Lang lay rope must be used with sheave liners.** (NOTE: OSC is investigating the use of regular lay rope on certain high-rise liner jobs. This requires **written approval** by Service Engineering on a case-by-case basis.)

Regular lay rope should be used on jobs **without sheave liners**, such as DWT gearless, or 90° / 105° undercut groove SWT sheaves.

- **Construction:**

The number of strands in each rope: 6-strand, 8-strand, or 9-strand.

- **Grade:**

Sometimes minimum breaking strength is given instead of grade—this will be listed on the car crosshead data plate. In this case, use the chart to select grade if rope breaking strength is known along with diameter and number of strands (construction). **NOTE:** The breaking strength is the same for both 6-strand and 8-strand traction (M) grade, but not for extra high strength (EH) grade.

**NOTE: Orders for iron (L) hoist rope should be for drum machines only and must be approved by OSC for application and safety factor.**

- **Diameter:**

Measure rope diameter if not available from records or rope data tag.

If there is any doubt about the correct rope choice, contact OSC customer service with the appropriate machine number(s). OSC can verify the correct rope via the layout and engineering data for a given job.

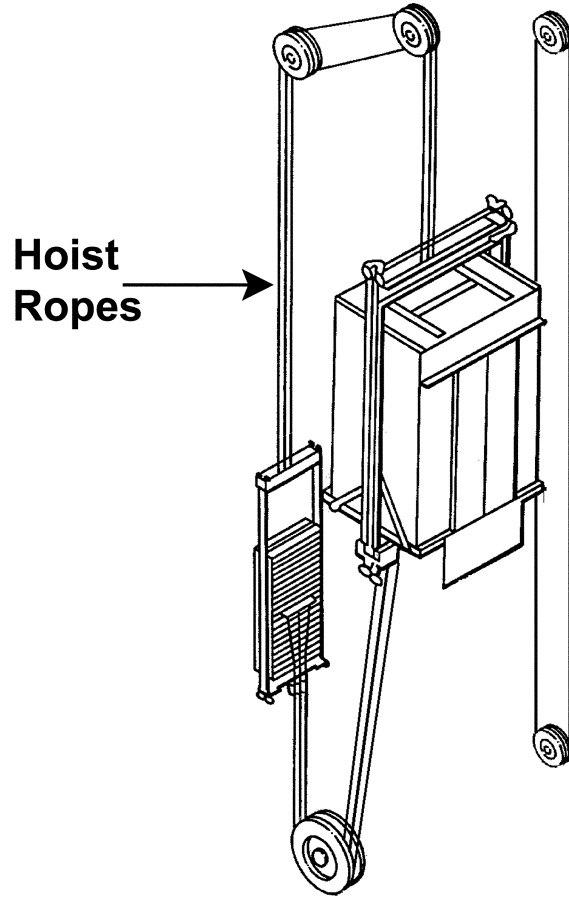

PART No.	DESCRIPTION			
	HOIST ROPE APPLICATION	LAY	CONSTRUCTION	GRADE
AAA712P30	1/2 in. 6 x 19 Traction	Regular	6 x 19	M
AAA712P55	1/2 in. 6 x 19 EHS	Regular	6 x 19	EHS
AAA712Q30	1/2 in. 8 x 19 Traction	Regular	8 x 19	M
AAA712Q55	1/2 in. 8 x 19 EHS	Regular	8 x 19	EHS
AAA712P90	1/2 in. 6 x 19 EHS	Lang	6 x 19	EHS
AAA712Q78	1/2 in. 8 x 19 Traction	Lang	8 x 19	M
AAA712Q90	1/2 in. 8 x 19 EHS	Lang	8 x 19	EHS

# Compensation Rope Replacement Guidelines

11-AAA712P/Q

To order compensation rope, you need to know the following six features:

1. Compensation Rope
2. Lay: Regular
3. Construction: 6-strand or 8-strand
4. Grade: Traction Steel = M; Iron = L; EH = EHS
5. Diameter
6. Number of Ropes and Rope Length

When you have the above information, use it to fill out the order form at the end of this leaflet.

- **Guidelines:**

In general, you should “replace-in-kind” with the same type rope originally installed. The original rope type can usually be found on the rope data tag or elevator layout, or identify the six features listed above. Note all compensation rope is preformed, which replaces non-preformed for compensation applications.

**NOTE:** Traction steel rope has been the standard for compensation rope material since 1989. From a technical standpoint, traction steel can replace iron compensation in almost all cases; the rope strength is not an issue. The main issue is on some older jobs where the compensation sheave grooves may be “softer” and will wear faster from the use of traction steel. Iron grade tensile ropes are much less readily available. For this reason, dual tensile ropes are recommended for compensation applications. Then traction steel rope is specified for an elevator, the following machine types use single tensile ropes: 18ATF, 156MST, PM138, 30T, 40T, 70T, and 100T. For other machines, use dual tensile rope.

- **Lay:**

Regular Lay

- **Construction:**

The number of strands in each rope: 6-strand or 8-strand.

- **Grade:**

From layout or rope data tag. Generally traction steel (M) grade.

- **Diameter:**

Measure rope diameter, if not available from records or rope data tag.

If there is any doubt about the correct rope choice, contact OSC customer service with the rope information you have and the appropriate machine number(s). OSC can verify the correct rope via the layout and engineering data for a given job.

For replacement hoist rope selection, the following path is recommended.

1. Identify the wire rope construction from the rope date plate mounted on the termination. Data plates are required to be present by the ASME A17.1 elevator code.
2. Obtain the machine number and check the layout for the hoist rope construction.
3. If neither are available, the rope selection can be reverse engineered. Obtain TIP 11.0-13 and complete the table in Appendix C. Provide the information to Service Engineering for a recommendation.

# Compensation Rope Construction

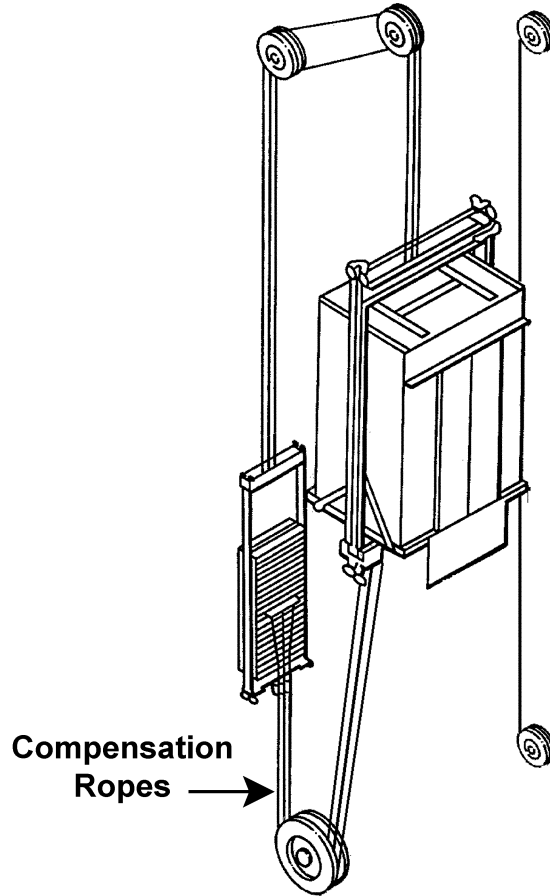

PART No.	DESCRIPTION			
	COMPENSATION ROPE APPLICATION	LAY	CONSTRUCTION	GRADE
AAA712P5	1/2 in. Iron	Regular	6 x 19	L
AAA712P30	1/2 in. Traction	Regular	6 x 19	M
AAA712Q5	1/2 in. Iron	Regular	8 x 19	L
AAA712Q30	1/2 in. Traction	Regular	8 x 19	M
AAA712W44	25 mm	Regular	8 x 19	M
AAA712W62	30 mm	Regular	6 x 36	M



# Governor Rope Replacement Guidelines

11-AAA712P/Q

To order governor rope, you need to know the following six features:

1. Governor Rope
2. Lay: Regular, Non-Preformed
3. Construction: 6-strand or 8-strand
4. Grade: Traction Steel = M; Iron = L
5. Diameter
6. Rope Length

When you have the above information, use it to fill out the order form at the end of this leaflet.

- **Guidelines:**

“Replace-in-kind” the same rope originally specified on the elevator layout, governor data tag, or rope data tag (Regular Lay + 6-strand or 8-strand, + Iron [L] or Traction [M] grade).

- **Lay:**

Regular Lay Non-Preformed

- **Construction:**

The number of strands in each rope: 6-strand or 8-strand.

- **Grade:**

From layout or governor data plate and rope data tag.

- **Diameter:**

Measure rope diameter, if not available from records or rope data tag.

If there is any doubt about the correct rope choice, contact OSC customer service with the rope information you have and the appropriate machine number(s). OSC can verify the correct rope via the layout and engineering data for a given job.

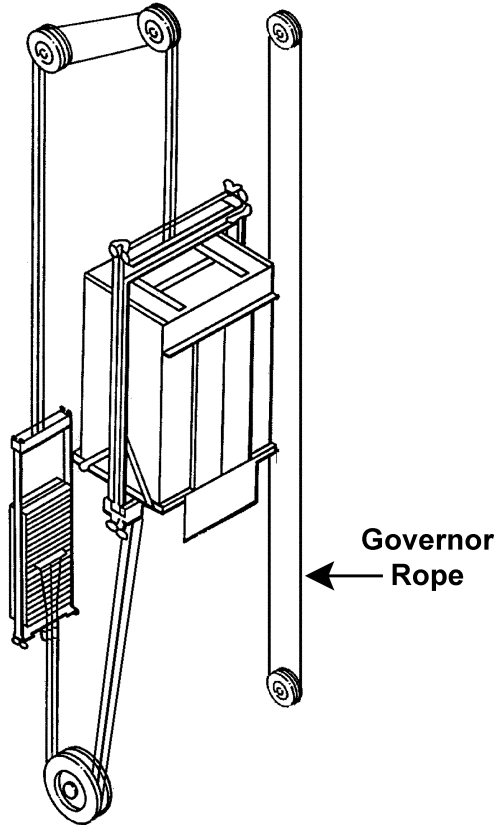



<b>DESCRIPTION</b>				
<b>PART No.</b>	<b>REPLACES</b>	<b>LAY</b>	<b>CONSTRUCTION</b>	<b>GRADE</b>
AAA712P102	3/8 in. Iron, Non-Preformed	Regular	6 x 25	L
AAA712Q112	3/8 in. Traction, Non-Preformed	Regular	8 x 19	M
AAA712Q113	1/2 in. Traction, Non-Performed	Regular	8 x 19	M

<b>PART No.</b>	<b>DESCRIPTION</b>	<b>LAY</b>	<b>CONSTRUCTION</b>	<b>GRADE</b>
AAA712W57	9.5 mm (3/8"), Typically Used in Gen2 System	Regular	8 x 19	EH
AAA712W58	9.5 mm (3/8"), Dual Tensile 1370/1770 Polypropylene Non-Lubricated Core, Used on Apollo Governors	Regular	8 x 19	M
AAA713W59	6.3 mm (.25 in.), 1370/1770 SFC Car Mounted Governor	Regular	8 x 19	M
AAA712W60	6.3 mm (.25 in.), 1960, SFC, Galvanized Car Mounted Governor	Regular	6 x 19	EH
AAA712W1	0.25 in., 1960 Galvanized	Regular	6 x 19	1960
AAA712W61	8 mm (0.315 in.) HSXMR Governor Rope	Regular	8 x 19	M

# Miscellaneous Ropes Replacement Guidelines

**11-AAA712P/Q**

<b>PART No.</b>	<b>DESCRIPTION</b>
VP-843600	3/16 in. Bronze Wire Rope, 8 x 19 Construction
<del>VP-843650</del> AAA712P131	7/16 in. 6 x 36 Stainless Steel Rope for Wedge Clamp Safeties
VP-844350	3/8 in. Iron Rope, Type 6LT
VP-844400	1/2 in. Iron Rope, Type 6LT
VP-844700	5/8 in. Hawser Laid Manila Rope (not for hoisting)
VP-845000	5/8 in. Premium Grade Manila Rope (not for hoisting)
<del>VP-845650</del> AAA712Q26	1/4 in. Steel Wire Rope, Type 8M
<del>VP-845750</del> AAA712Q28	3/8 in. Steel Wire Rope, Type 8M
<del>VP-845850</del> AAA712Q32	5/8 in. Steel Wire Rope, Type 8M
ESCO-1-103-003	0.600 in.  , .437 in. Rope Dia., Nylon Coated, 6 x 36 FC, EHS
ESCO-1-103-020	0.800 in.  , 0.625 in. Rope Dia., Nylon Coated 6 x 36 FC, EHS

**NOTE:** Ropes listed here are for information only; they may not be in stock or available. If there is any doubt about the correct rope choice, contact OSC Customer Service. OSC can verify the correct rope via the layout and engineering data for a given job.

**Physical Characteristics:  
6-Strand & 8-Strand Wire Rope**

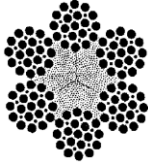
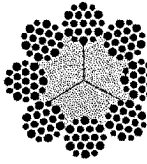
	 <b>6-STRAND</b>			 <b>8-STRAND</b>	
	<b>DIAMETER (IN.)</b>	<b>NOMINAL BREAKING LOAD (LB.)</b>	<b>APPROXIMATE WEIGHT (LB./FT.)</b>	<b>NOMINAL BREAKING LOAD (LB.)</b>	<b>APPROXIMATE WEIGHT (LB./FT.)</b>
<b>Iron (L)</b>	3/8	5,000	0.23	---	0.14
	1/2	8,400	0.40	---	0.36
	5/8	12,800	0.63	11,200	0.57
	11/16	---	0.76	13,400	0.69
	3/4	18,200	0.90	---	0.82
	7/8	24,800	1.23	---	1.11
	1	32,000	1.60	---	1.45
<b>Traction Steel (M) Single tensile 1570 N/mm2</b>	1/4	---	---	---	---
	5/16	7463	0.16	6609	0.14
	3/8	10520	0.23	9329	0.20
	7/16	14094	0.31	12521	0.28
	1/2	18793	0.40	16680	0.36
	9/16	22929	0.51	20276	0.46
	5/8	29898	0.63	26526	0.57
	11/16	31125	0.76	31700	0.69
	3/4	42037	0.90	37320	0.82
	13/16	43129	1.03	38293	0.96
	7/8	56424	1.23	50130	1.11
	15/16	57568	1.41	51114	1.27
	1	65569	1.60	57217	1.45
1-1/16	74090	1.81	65783	1.64	

(Continued on next page)

# Physical Characteristics: 6-Strand & 8-Strand Wire Rope

**11-AAA712P/Q**

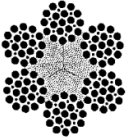
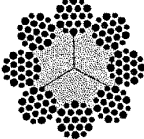
		 <b>6-STRAND</b>		 <b>8-STRAND</b>	
	<b>DIAMETER (IN.)</b>	<b>NOMINAL BREAKING LOAD (LB.)</b>	<b>APPROXIMATE WEIGHT (LB./FT.)</b>	<b>NOMINAL BREAKING LOAD (LB.)</b>	<b>APPROXIMATE WEIGHT (LB./FT.)</b>
<b>Steel (M) Dual tensile 1370/1770 N/mm2</b>	1/4	3600	---	3600	---
	5/16	7126	0.16	6316	0.14
	3/8	10048	0.23	8924	0.20
	7/16	13465	0.31	11959	0.28
	1/2	17939	0.40	15938	0.36
	9/16	21805	0.51	19355	0.46
	5/8	28549	0.63	25402	0.57
	11/16	34078	0.76	30257	0.69
	3/4	40239	0.90	35743	0.82
	13/16	47221	1.03	41927	0.96
	7/8	53952	1.23	47882	1.11
	15/16	63031	1.41	55964	1.27
	1	71791	1.60	63742	1.45
	1-1/16	81120	1.81	72025	1.64
<b>Extra High Strength Traction Steel (EHS)</b>	1/2	21176	0.40	18793	0.36
	5/8	33720	0.63	29898	0.57
	11/16	40239	0.76	35740	0.69
	3/4	47432	0.90	42040	0.82
	13/16	55750	1.03	46000	0.96
	7/8	63618	1.23	56424	1.11

**METRIC TABLE**

<b>DIAM. (MM)</b>	<b>CONSTRUCTION</b>	<b>TENSILE (N/MM2)</b>	<b>NOMINAL BREAKING LOAD (LB.)</b>	<b>NOMINAL BREAKING LOAD (KN)</b>	<b>APPROX. WEIGHT (LB. / FT.)</b>	<b>APPROX. WEIGHT (KN / 100M)</b>
8	8 x 19	1570	6610	29.4	0.146	21.8
10	IWRC 8 Strand	1570	12930	57.5	0.282	42.0
10	IWRC 9 Strand	1570	13890	61.8	0.302	45.0
12	IWRC 9 Strand	1570	20010	89.0	0.437	65.0
13	IWRC 9 Strand	1570	23470	104.4	0.511	76.0
13	8 x 19	1770	19690	87.6	0.386	57.5
13	6 x 19	1770	22190	98.7	0.408	60.7
18	IWRC 9 Strand	1570	44960	200.0	0.981	146.0
18	8 x 19	1770	37770	168.0	0.739	110.0
19	IWRC 9 Strand	1570	50130	223.0	1.095	163.0
19	8 x 19	1770	42040	187.0	0.827	123.0
22	IWRC 9 Strand	1570	66990	298.0	1.465	218.0
22	6 x 19	1770	63620	283.0	1.169	174.0
22	8 x 19	1770	56430	251.0	1.109	165.0
22	8 x 19	1570	50130	223.0	1.109	165.0
24	8 x 19	1570	57570	265.0	1.317	196.0
25	8 x 19	1570	64740	288.0	1.431	213.0
30	6 x 36	1570	104760	466.0	2.217	330.0

# Wire Rope Part Numbers

**11-AAA712P/Q**

The following items are "A" items. See Ordering Instructions.						
PART No.	OLD OTIS DESIGNATION	CLASS	DIA. (IN.)	CONSTRUCTION	MATERIAL	LAY
AAA712W26	1/2 8X19S1570FCRRL	8X19	1/2	8M	Traction Steel	Regular
AAA712W27	1/2 8X19S1570FCRLL	8X19	1/2	8M	Traction Steel	Lang
AAA712W28	1/2 8X19S1770FCRRL	8X19	1/2	8EH	Extra High	Regular
AAA712Q112	R-819W-MRF-4N-3/8	8X19	3/8	8M	Traction Steel	Regular
AAA712W12	5/8 8X19S1570FCRRL	8X19	5/8	8M	Traction Steel	Regular
AAA712W31	5/8 8X19S1570FCRLL	8X19	5/8	8M	Traction Steel	Lang
AAA712W13	5/8 8X19S1770FCRRL	8X19	5/8	8EH	Extra High	Regular
AAA712W30	5/8 6X19F1770FCRRL	6X19	5/8	6EH	Extra High	Regular

The following items are "B" items. See Ordering Instructions.						
PART No.	OLD OTIS DESIGNATION	CLASS	DIA.	CONSTRUCTION	MATERIAL	LAY
AAA712W59	1/4 8x19 1370/1770 SFC RRL	8X19	1/4	8M	Traction	Regular
AAA712W60	1/4 6x19 1960 SFC RRL	6X19	1/4	6EH	EHS	Regular Galvanized
AAA712P1	1/4 6X19S800FCRRL	6X19	1/4	6L	Iron	Regular
AAA712P26	1/4 6X19S1370/1770FCRRL	6X19	1/4	6M Dual Tensile	Traction	Regular
AAA712W1	1/4 6X191960FCRRL	6X19	1/4	EHS	1960	Regular
AAA712Q1	1/4 8X19S800FCRRL	8X19	1/4	8L	Iron	Regular
AAA712Q26	1/4 8X19S1370/1770FCRRL	8X19	1/4	8M dual tensile	Traction	Regular
AAA712Q51	1/4 8X19S1770FCRRL	8X19	1/4	8 EHS	EHS	Regular
AAA712W7	5/16 8X19S 1570FCRRL	8X19	5/16	8M	Traction Steel	Regular
AAA712P2	5/16 6X19S800FCRRL	6X19	5/16	6L	Iron	Regular
AAA712P101	5/16 6X19S800FCRRLNP	6X19	5/16	6L NP	Iron	Regular
AAA712P27	5/16 6X19S1370/1770FCRRL	6X19	5/16	6M Dual Tensile	Traction	Regular

(Continued on next page)

**11-AAA712P/Q****Wire Rope Part Numbers**

The following items are "B" items. See Ordering Instructions.

<b>PART No.</b>	<b>OLD OTIS DESIGNATION</b>	<b>CLASS</b>	<b>DIA.</b>	<b>CONSTRUCTION</b>	<b>MATERIAL</b>	<b>LAY</b>
AAA712P76	5/16 6X19S1370/1770FCRLL	6X19	5/16	6M dual tensile	Traction	Lang
AAA712P111	5/16 6X19S1370/1770FCRRLNP	6X19	5/16	6M dual tensile NP	Traction	Regular
AAA712P52	5/16 6X19S1770FCRRL	6X19	5/16	6 EHS	EHS	Regular
AAA712P88	5/16 6X19S1770FCRLL	6X19	5/16	6 EHS	EHS	Lang
AAA712Q2	5/16 8X19S800FCRRL	8X19	5/16	8L	Iron	Regular
AAA712Q101	5/16 8X19S800FCRRLNP	8X19	5/16	8L NP	Iron	Regular
AAA712Q27	5/16 8X19S1370/1770FCRRL	8X19	5/16	8M dual tensile	Traction	Regular
AAA712Q76	5/16 8X19S1370/1770FCRLL	8X19	5/16	8M dual tensile	Traction	Lang
AAA712Q111	5/16 8X19S1370/1770FCRRLNP	8X19	5/16	8M dual tensile NP	Traction	Regular
AAA712Q52	5/16 8X19S1770FCRRL	8X19	5/16	8 EHS	EHS	Regular
AAA712Q88	5/16 8X19S1770FCRLL	8X19	5/16	8 EHS	EHS	Lang
AAA712W58	3/8 8X19 1370/1770PCRRL	8X19	3/8	8M	Dual-Tensile Traction, Poly Core (no core lubrication)	Regular
AAA712P3	3/8 6X19S800FCRRL	6X19	3/8	6L	Iron	Regular
AAA712P102	3/8 6X19S800FCRRLNP	6X19	3/8	6L NP	Iron	Regular
AAA712P28	3/8 6X19S1370/1770FCRRL	6X19	3/8	6M Dual Tensile	Traction	Regular
AAA712P77	3/8 6X19S1370/1770FCRLL	6X19	3/8	6M dual tensile	Traction	Lang
AAA712P112	3/8 6X19S1370/1770FCRRLNP	6X19	3/8	6M dual tensile NP	Traction	Regular
AAA712P53	3/8 6X19S1770FCRRL	6X19	3/8	6 EHS	EHS	Regular
AAA712P89	3/8 6X19S1770FCRLL	6X19	3/8	6 EHS	EHS	Lang
AAA712Q3	3/8 8X19S800FCRRL	8X19	3/8	8L	Iron	Regular
AAA712Q102	3/8 8X19S800FCRRLNP	8X19	3/8	8L NP	Iron	Regular
AAA712Q28	3/8 8X19S1370/1770FCRRL	8X19	3/8	8M dual tensile	Traction	Regular

(Continued on next page)

# Wire Rope Part Numbers

**11-AAA712P/Q**

The following items are "B" items. See Ordering Instructions.

<b>PART No.</b>	<b>OLD OTIS DESIGNATION</b>	<b>CLASS</b>	<b>DIA.</b>	<b>CONSTRUCTION</b>	<b>MATERIAL</b>	<b>LAY</b>
AAA712Q77	3/8 8X19S1370/1770FCRLL	8X19	3/8	8M dual tensile	Traction	Lang
AAA712Q112	3/8 8X19S1370/1770FCRRLNP	8X19	3/8	8M dual tensile NP	Traction	Regular
AAA712Q53	3/8 8X19S1770FCRRL	8X19	3/8	8 EHS	EHS	Regular
AAA712Q89	3/8 8X19S1770FCRLL	8X19	3/8	8 EHS	EHS	Lang
AAA712Q428	3/8 8X19S1370/1770FCRRL GALV	8X19	3/8	8M dual tensile	Traction	Regular
AAA712Q453	3/8 8X19S1770FCRRL GALV	8X19	3/8	8 EHS	EHS	Regular
AAA712P4	7/16 6X19S800FCRRL	6X19	7/16	6L	Iron	Regular
AAA712P29	7/16 6X19S1370/1770FCRRL	6X19	7/16	6M dual tensile	Traction	Regular
AAA712P131	7/16 6X36 304SS IWRC RRL	6X36	7/16	IWRC	SS	Regular
AAA712P54	7/16 6X19S1770FCRRL	6X19	7/16	6 EHS	EHS	Regular
AAA712Q4	7/16 8X19S800FCRRL	8X19	7/16	8L	Iron	Regular
AAA712Q29	7/16 8X19S1370/1770FCRRL	8X19	7/16	8M dual tensile	Traction	Regular
AAA712Q82	7/16 8X19S1370/1770FCRLL	8X19	7/16	8M dual tensile	Traction	Lang
AAA712Q54	7/16 8X19S1770FCRRL	8X19	7/16	8 EHS	EHS	Regular
AAA712Q94	7/16 8X19S1770FCRLL	8X19	7/16	8 EHS	EHS	Lang
AAA712W25	1/2 6X19F1570FCRRL	6X19	1/2	6M	Traction Steel	Regular
AAA712W47	1/2 6X19F1770FCRRL	6X19	1/2	6EH	Extra High	Regular
AAA712W29	1/2 IWRC 1570	9X19	1/2	IWRC 9M	Traction Steel	Regular
R-642T-WRF- 11-1/2-W	7x7x7 TILLER 1/2	---	1/2	---	---	---
AAA712P5	1/2 6X19S800FCRRL	6X19	1/2	6L	Iron	Regular
AAA712P103	1/2 6X19S800FCRRLNP	6X19	1/2	6L NP	Iron	Regular
AAA712P30	1/2 6X19S1370/1770FCRRL	6X19	1/2	6M dual tensile	Traction	Regular
AAA712P78	1/2 6X19S1370/1770FCRLL	6X19	1/2	6M dual tensile	Traction	Lang
AAA712P113	1/2 6X19S1370/1770FCRRLNP	6X19	1/2	6M dual tensile NP	Traction	Regular

(Continued on next page)



**11-AAA712P/Q****Wire Rope Part Numbers**

The following items are "B" items. See Ordering Instructions.

<b>PART No.</b>	<b>OLD OTIS DESIGNATION</b>	<b>CLASS</b>	<b>DIA.</b>	<b>CONSTRUCTION</b>	<b>MATERIAL</b>	<b>LAY</b>
AAA712P90	1/2 6X19S1770FCRLL	6X19	1/2	6 EHS	EHS	Lang
AAA712Q5	1/2 8X19S800FCRRL	8X19	1/2	8L	Iron	Regular
AAA712Q103	1/2 8X19S800FCRRLNP	8X19	1/2	8L NP	Iron	Regular
AAA712Q30	1/2 8X19S1370/1770FCRRL	8X19	1/2	8M dual tensile	Traction	Regular
AAA712Q42	DP9	9x21	1/2	9M dual tensile	Traction	Regular Parallel
AAA712Q78	1/2 8X19S1370/1770FCRLL	8X19	1/2	8M dual tensile	Traction	Lang
AAA712Q113	1/2 8X19S1370/1770FCRRLNP	8X19	1/2	8M dual tensile NP	Traction	Regular
AAA712Q90	1/2 8X19S1770FCRLL	8X19	1/2	8 EHS	EHS	Lang
AAA712Q430	1/2 8X19S1370/1770FCRRL GALV	8X19	1/2	8M dual tensile	Traction	Regular
AAA712Q455	1/2 8X19S1770FCRRL GALV	8X19	1/2	8 EHS	EHS	Regular
AAA712Q478	1/2 8X19S1370/1770FCRLL GALV	8X19	1/2	8M dual tensile	Traction	Lang
AAA712Q513	1/2 8X19S1370/1770FCRRLNP GALV	8X19	1/2	8M dual tensile NP	Traction	Regular
AAA712P6	9/16 6X19S800FCRRL	6X19	9/16	6L	Iron	Regular
AAA712P31	9/16 6X19S1370/1770FCRRL	6X19	9/16	6M dual tensile	Traction	Regular
AAA712P56	9/16 6X19S1770FCRRL	6X19	9/16	6 EHS	EHS	Regular
AAA712Q6	9/16 8X19S800FCRRL	8X19	9/16	8L	Iron	Regular
AAA712Q31	9/16 8X19S1370/1770FCRRL	8X19	9/16	8M dual tensile	Traction	Regular
AAA712Q83	9/16 8X19S1370/1770FCRLL	8X19	9/16	8M dual tensile	Traction	Lang
AAA712Q56	9/16 8X19S1770FCRRL	8X19	9/16	8 EHS	EHS	Regular
AAA712Q95	9/16 8X19S1770FCRLL	8X19	9/16	8 EHS	EHS	Lang
AAA712W14	5/8 MM IWRC 1570	9X19	5/8	IWRC 9M	Traction Steel	Regular
AAA712P7	5/8 6X19S800FCRRL	6X19	5/8	6L	Iron	Regular
AAA712P104	5/8 6X19S800FCRRLNP	6X19	5/8	6L NP	Iron	Regular

(Continued on next page)

# Wire Rope Part Numbers

**11-AAA712P/Q**

The following items are "B" items. See Ordering Instructions.

<b>PART No.</b>	<b>OLD OTIS DESIGNATION</b>	<b>CLASS</b>	<b>DIA.</b>	<b>CONSTRUCTION</b>	<b>MATERIAL</b>	<b>LAY</b>
AAA712P32	5/8 6X19S1370/1770FCRRL	6X19	5/8	6M dual tensile	Traction	Regular
AAA712P79	5/8 6X19S1370/1770FCRLL	6X19	5/8	6M dual tensile	Traction	Lang
AAA712P114	5/8 6X19S1370/1770FCRRLNP	6X19	5/8	6M dual tensile NP	Traction	Regular
AAA712P91	5/8 6X19S1770FCRLL	6X19	5/8	6 EHS	EHS	Lang
AAA712Q7	5/8 8X19S800FCRRL	8X19	5/8	8L	Iron	Regular
AAA712Q104	5/8 8X19S800FCRRLNP	8X19	5/8	8L NP	Iron	Regular
AAA712Q32	5/8 8X19S1370/1770FCRRL	8X19	5/8	8M dual tensile	Traction	Regular
AAA712Q44	DP9	9x25	5/8	9M dual tensile	Traction	Regular Parallel
AAA712Q79	5/8 8X19S1370/1770FCRLL	8X19	5/8	8M dual tensile	Traction	Lang
AAA712Q114	5/8 8X19S1370/1770FCRRLNP	8X19	5/8	8M dual tensile NP	Traction	Regular
AAA712Q91	5/8 8X19S1770FCRLL	8X19	5/8	8 EHS	EHS	Lang
AAA712Q432	5/8 8X19S1370/1770FCRRL GALV	8X19	5/8	8M dual tensile	Traction	Regular
AAA712W33	11/16 8X19S1570FCRRL	8X19	11/16	8M	Traction Steel	Regular
AAA712W34	11/16 8X19S1570FCRLL	8X19	11/16	8M	Traction Steel	Lang
AAA712W36	11/16 IWRC 1570	9X19	11/16	IWRC 9M	Traction Steel	Regular
AAA712W32	11/16 6X19F1770FCRLL	6X19	11/16	6EH	Extra High	Regular
AAA712P8	11/16 6X19S800FCRRL	6X19	11/16	6L	Iron	Regular
AAA712P33	11/16 6X19S1370/1770FCRRL	6X19	11/16	6M dual tensile	Traction	Regular
AAA712P80	11/16 6X19S1370/1770FCRLL	6X19	11/16	6M dual tensile	Traction	Lang
AAA712P115	11/16 6X19S1370/1770FCRRLNP	6X19	11/16	6M dual tensile NP	Traction	Regular
AAA712P92	11/16 6X19S1770FCRLL	6X19	11/16	6 EHS	EHS	Lang
AAA712W35	11/16 8 x 19 1770RRL	8x19	11/16	8EH	EHS	Regular
AAA712Q8	11/16 8X19S800FCRRL	8X19	11/16	8L	Iron	Regular
AAA712Q105	11/16 8X19S800FCRRLNP	8X19	11/16	8L NP	Iron	Regular

(Continued on next page)

**11-AAA712P/Q****Wire Rope Part Numbers**

The following items are "B" items. See Ordering Instructions.

<b>PART No.</b>	<b>OLD OTIS DESIGNATION</b>	<b>CLASS</b>	<b>DIA.</b>	<b>CONSTRUCTION</b>	<b>MATERIAL</b>	<b>LAY</b>
AAA712Q33	11/16 8X19S1370/1770FCRRL	8X19	11/16	8M dual tensile	Traction	Regular
AAA712Q45	DP9	9X25	11/16	9M dual tensile	Traction	Regular Parallel
AAA712Q80	11/16 8X19S1370/1770FCRLL	8X19	11/16	8M dual tensile	Traction	Lang
AAA712Q115	11/16 8X19S1370/1770FCRRLNP	8X19	11/16	8M dual tensile NP	Traction	Regular
AAA712Q92	11/16 8X19S1770FCRLL	8X19	11/16	8 EHS	EHS	Lang
AAA712Q458	11/16 8X19S1370/1770FCRRL GALV	8X19	11/16	8M dual tensile	Traction	Regular
AAA712Q47	11/16 8 x 19 2050FCRRL	8x19	11/16	8UHS	UHS	Regular
AAA712Q48	11/16 8 x 19 2050FCRRL	8X19	11/16	8UHS	UHS	Regular Compacted
AAA712W38	3/4 8X19S 1570FCRRL	8X19	3/4	8M	Traction Steel	Regular
AAA712P9	3/4 6X19S800FCRRL	6X19	3/4	6L	Iron	Regular
AAA712P106	3/4 6X19S800FCRRLNP	6X19	3/4	6L NP	Iron	Regular
AAA712P34	3/4 6X19S1370/1770FCRRL	6X19	3/4	6M dual tensile	Traction	Regular
AAA712P81	3/4 6X19S1370/1770FCRLL	6X19	3/4	6M dual tensile	Traction	Lang
AAA712P116	3/4 6X19S1370/1770FCRRLNP	6X19	3/4	6M dual tensile NP	Traction	Regular
AAA712P59	3/4 6X19S1770FCRRL	6X19	3/4	6 EHS	EHS	Regular
AAA712P93	3/4 6X19S1770FCRLL	6X19	3/4	6 EHS	EHS	Lang
AAA712Q9	3/4 8X19S800FCRRL	8X19	3/4	8L	Iron	Regular
AAA712Q106	3/4 8X19S800FCRRLNP	8X19	3/4	8L NP	Iron	Regular
AAA712Q34	3/4 8X19S1370/1770FCRRL	8X19	3/4	8M dual tensile	Traction	Regular
AAA712Q81	3/4 8X19S1370/1770FCRLL	8X19	3/4	8M dual tensile	Traction	Lang
AAA712Q116	3/4 8X19S1370/1770FCRRLNP	8X19	3/4	8M dual tensile NP	Traction	Regular
AAA712Q93	3/4 8X19S1770FCRLL	8X19	3/4	8 EHS	EHS	Lang
AAA712Q49	3/4 8 x 19 2050FCRRL	8X19	3/4	8UHS	UHS	Regular

(Continued on next page)

# Wire Rope Part Numbers

**11-AAA712P/Q**

The following items are "B" items. See Ordering Instructions.

<b>PART No.</b>	<b>OLD OTIS DESIGNATION</b>	<b>CLASS</b>	<b>DIA.</b>	<b>CONSTRUCTION</b>	<b>MATERIAL</b>	<b>LAY</b>
AAA712Q50	3/4 8 x 19 2050FCRRL	8X19	3/4	8UHS	UHS	Regular Compacted
AAA712P10	13/16 6X19S800FCRRL	6X19	13/16	6L	Iron	Regular
AAA712P107	13/16 6X19S800FCRRLNP	6X19	13/16	6L NP	Iron	Regular
AAA712P35	13/16 6X19S1370/1770FCRRL	6X19	13/16	6M dual tensile	Traction	Regular
AAA712P60	13/16 6X19S1770FCRRL	6X19	13/16	6 EHS	EHS	Regular
AAA712Q10	13/16 8X19S800FCRRL	8X19	13/16	8L	Iron	Regular
AAA712Q35	13/16 8X19S1370/1770FCRRL	8X19	13/16	8M dual tensile	Traction	Regular
AAA712Q60	13/16 8X19S1770FCRRL	8X19	13/16	8 EHS	EHS	Regular
AAA712P11	7/8 6X19S800FCRRL	6X19	7/8	6L	Iron	Regular
AAA712P36	7/8 6X19S1370/1770FCRRL	6X19	7/8	6M dual tensile	Traction	Regular
AAA712P61	7/8 6X19S1770FCRRL	6X19	7/8	6 EHS	EHS	Regular
AAA712Q11	7/8 8X19S800FCRRL	8X19	7/8	8L	Iron	Regular
AAA712Q36	7/8 8X19S1370/1770FCRRL	8X19	7/8	8M dual tensile	Traction	Regular
AAA712Q61	7/8 8X19S1770FCRRL	8X19	7/8	8 EHS	EHS	Regular
AAA712P12	15/16 6X19S800FCRRL	6X19	15/16	6L	Iron	Regular
AAA712P37	15/16 6X19S1370/1770FCRRL	6X19	15/16	6M dual tensile	Traction	Regular
AAA712P62	15/16 6X19S1770FCRRL	6X19	15/16	6 EHS	EHS	Regular
AAA712Q12	15/16 8X19S800FCRRL	8X19	15/16	8L	Iron	Regular
AAA712Q37	15/16 8X19S1370/1770FCRRL	8X19	15/16	8M dual tensile	Traction	Regular
AAA712Q62	15/16 8X19S1770FCRRL	8X19	15/16	8 EHS	EHS	Regular
AAA712P39	1-1/16 6X19S1370/1770FCRRL	6X19	1-1/16	6M dual tensile	Traction	Regular
AAA712P64	1-1/16 6X19S1770FCRRL	6X19	1-1/16	6 EHS	EHS	Regular
AAA712P13	1 6X19S800FCRRL	6X19	1	6L	Iron	Regular
AAA712P38	1 6X19S1370/1770FCRRL	6X19	1	6M dual tensile	Traction	Regular
AAA712P63	1 6X19S1770FCRRL	6X19	1	6 EHS	EHS	Regular

(Continued on next page)

**11-AAA712P/Q****Wire Rope Part Numbers**

The following items are "B" items. See Ordering Instructions.

<b>PART No.</b>	<b>OLD OTIS DESIGNATION</b>	<b>CLASS</b>	<b>DIA.</b>	<b>CONSTRUCTION</b>	<b>MATERIAL</b>	<b>LAY</b>
AAA712Q38	1 8X19S1370/1770FCRRL	8X19	1	8M dual tensile	Traction	Regular
AAA712Q63	1 8X19S1770FCRRL	8X19	1	8 EHS	EHS	Regular
AAA712W61	8 8X191570FCRRL	8X19	8	8 M	Traction	Regular
AAA712W19	9.5 8 X 19S1570FCRRL	8X19	9.5	8 M	Traction	Regular
AAA712W9	10 mm IWRC 1570	8X19	10	IWRC 8M	Traction Steel	Regular
AAA712W46	10 mm IWRC 1570	9X19	10	IWRC 9M	Traction Steel	Regular
AAA712W24	12 mm IWRC 1570	9X19	12	IWRC 9M	Traction Steel	Regular
AAA712W11	13 mm IWRC 1570	9X19	13	IWRC 9M	Traction Steel	Regular
AAA712W49	13 mm 8 x 19 1770RRL	8X19	13	8EH	EHS	Regular
AAA712W48	13 mm 6 x 19 1770RRL	6X19	13	6EH	EHS	Regular
AAA712W16	18 mm IWRC 1570	9X19	18	IWRC 9M	Traction Steel	Regular
AAA712W15	18 mm 8X19S 1570 FC RRL	8X19	18	8M	Traction Steel	Regular
AAA712W51	18 mm 8 x 19 1770RRL	8X19	18	8EH	EHS	Regular
AAA712W50	18 mm 6 x 19 1770RRL	6X19	18	6EH	EHS	Regular
AAA712W39	19 mm IWRC 1570	9X19	19	IWRC 9M	Traction Steel	Regular
AAA712W52	19 mm 8 x 19 1770RRL	8X19	19	8EH	EHS	Regular
AAA712W42	22 mm IWRC 1570	9X19	22	IWRC 9M	Traction Steel	Regular
AAA712W40	22 mm 6 x 19 1770RRL	8X19	22	6EH	EHS	Regular
AAA712W53	22 8 X 19 S1770FCRRL	8X19	22	8 EHS	EHS	Regular
AAA712W41	22 8 X 19S1570FCRRL	8X19	22	8 M	Traction	Regular
AAA712Q46	22 mm 8 x 19 1770FC RLL	8X19	22	8EHS	EHS	Lang
AAA712AJ1	IWRC WITH SYN FILLER	8X25 7X7	22.4	1620	Traction	Regular
AAA712AJ2	IWRC WITH SYN FILLER	8X25 7X7	22.4	1770	EHS	Regular
AAA712W43	24 8X19S1570FCRRL	8X19	24	8 M	Traction	Regular
AAA712W44	25 8X19S1570FCRRL	8X19	25	8 M	Traction	Regular
AAA712W62	30 6X361570FCRRL	6X36	30	8 M	Traction	Regular
AAA712W8	10 mm 8 x 19 1570 FC RRL	8X19	10	8 M	Traction	Regular
AAA712AJ3	IWRC WITH SYN FILLER	8X25 7X7	18	1620	Traction	Regular
AAA712AJ4	IWRC WITH SYN FILLER	8X25 7X7	18	1770	EHS	Regular

# Coated Steel Belt (CSB) for Gen2® Applications

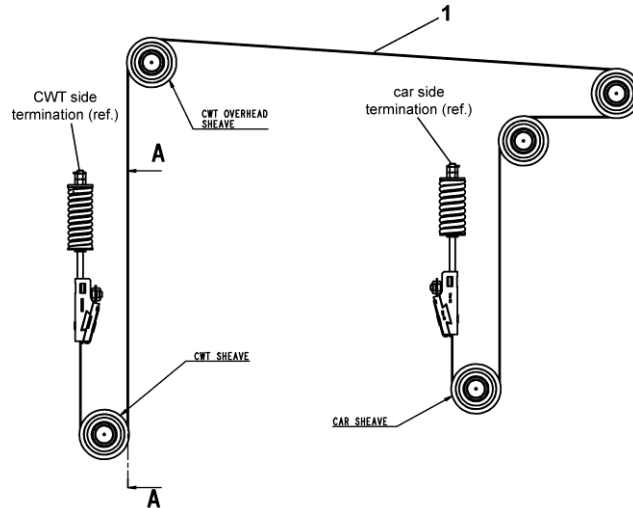

For 32kN terminations, SPL 11-TAA20650F.  
 For 32kN terminations (cast wedge clamp), SPL 11-AAA20650E.  
 For 43kN terminations, SPL 11-AAA20650Y.  
 For 64kN terminations, SPL 11-AAA20650S.

For 86kN terminations SPL 11-AAA20650AK

REF. No.	PART No.	DESCRIPTION	FTI FIRE RATED	MANUFACTURER
1	AAA717W1	CSB, 32kN Gen2 Limited Duty, 30 mm, Approximate Weight: 0.205 kg/m = 0.137 lb./ft.	No	Contitech
	AAA717X1	CSB, 32kN Gen2 Limited Duty, 30 mm, Approximate Weight: 0.203 kg/m = 0.136 lb./ft. Minimum breaking load 7173 lb.	No	Brugg
	AAA717R1	CSB, 64kN Gen2 Extended Duty, 60 mm Approximate Weight: 0.410 kg/m = 0.275 lb./ft.	Yes	Contitech
	AAA717AD1	CSB, 64kN Gen2 Extended Duty, 60 mm, Approximate Weight: 0.406 kg/m = 0.272 lb./ft. Minimum breaking load 14387 lb.	Yes	Brugg
	AAA717AJ2 AAA717AJ4	CSB, 43kN Gen2, 30 mm, Approximate Weight: 0.232 kg/m = 0.156 lb./ft. Minimum breaking load 9666 lb.	Yes	Contitech
	AAA717AJ4	CSB, 43kN Gen2, 30 mm Approximate Weight: 0.242 kg/m = 0.163 lb./ft. Minimum breaking load 9666 lb.	Yes	Contitech
	AAA717AJ5	CSB, 86kN Gen2, 60 mm Approximate Weight: 0.464 kg/m = 0.312 lb./ft. Minimum breaking load 19332 lb.	Yes	Contitech

**NOTE:** For correct CSB identification, check the part numbers and minimum breaking load printed on current belt. The termination belt data plate and layout will also identify the correct belt.

# Wire Rope Cutters

**11-AAA712P/Q**

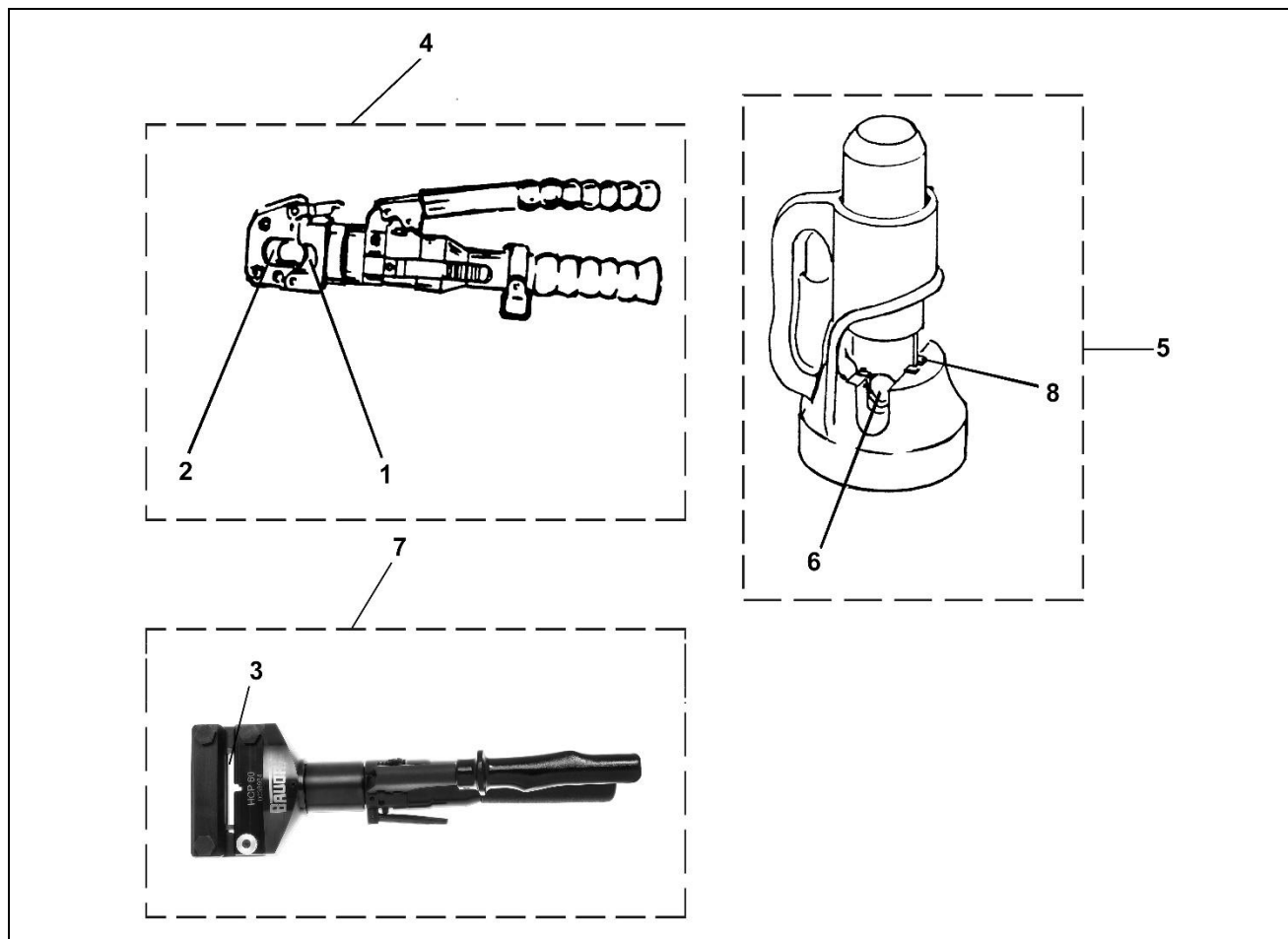

REF. No.	PART No.	DESCRIPTION
*	VP-703180	Band, Cable, 1/2 in., Morse Starrett. Used as Seizing.
	VP-703185	Band, Cable, 3/4 in., Morse Starrett. Used as Seizing.
	VP-703170	Band, Cable, 3/8 in., Morse Starrett. Used as Seizing.
	VP-703175	Band, Cable, 5/8 in., Morse Starrett. Used as Seizing.
1	MT-114364	Blade, Moveable Replacement, for MT-114281, Blade # 20-07
2	MT-114365	Blade, Stationary Replacement, for Huskie Cable Cutter S-16, Blade # 16-16, 5/8 in.
3	MT-114419-2	Blades (Replacements). For CSB cutting tool MT-114419-1.
4	MT-114281	Cutter, Cable, 3/4 in. Wire Rope
5	MT-114280	Cutter, Hammer Drive Wire Rope, 3/4 in. Max.
6	MT-114319	Cutter, Wire Rope, Guillotine Type, "V" Blades and Pin, for MT-114280
7	MT-114419-1	Cutting Tool. For CSBs.
*	VP-912900	Wire, Black Soft Steel, 21 Gauge, 1/4 lb. Spools
8	MT-114320	Yoke, Guide Blade, for MT-114280

\* Parts not shown.

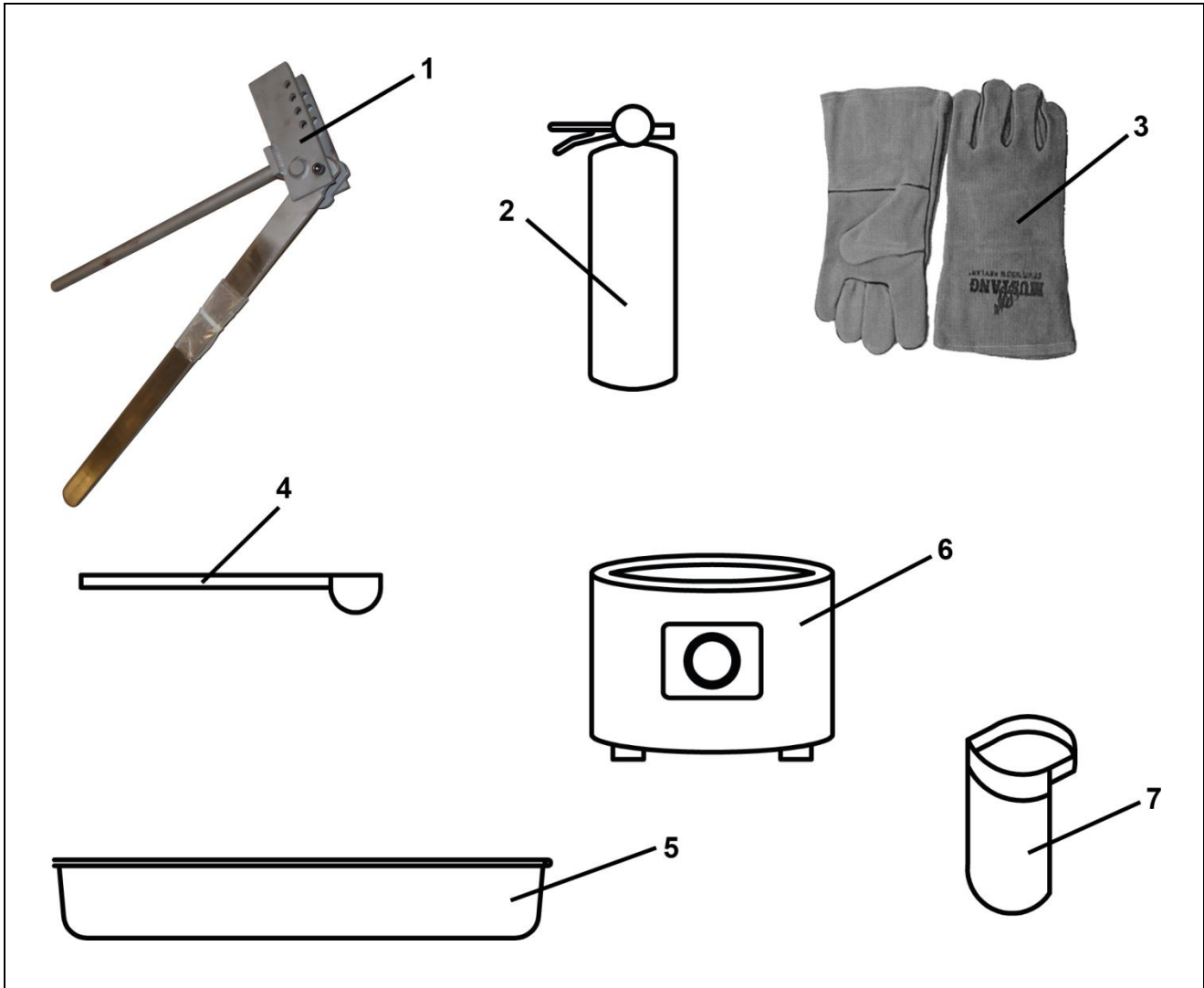

REF. No.	PART No.	DESCRIPTION
*	VP-702650	Babbitt #3, Common
1	MT-114256	Crimpers, Rosette
2	VP-846417	Extinguisher, Fire
3	VP-846392	Gloves, Welding
4	MT-114406-1	Ladle, 3 in.
*	VP-419750	Lubricant #60, 1-Gallon
*	VP-419755	Lubricant #60, 1-Quart
5	MT-114406-2	Pan, Drip, 16" x 17" x 2.5" Steel
6	WURT16-405	Pot, Melting (for Babbitt 30# capacity)
7	VP-846321	Shield, Face

\* Parts not shown.

(Continued on next page)



# Supplies

**11-AAA712P/Q**

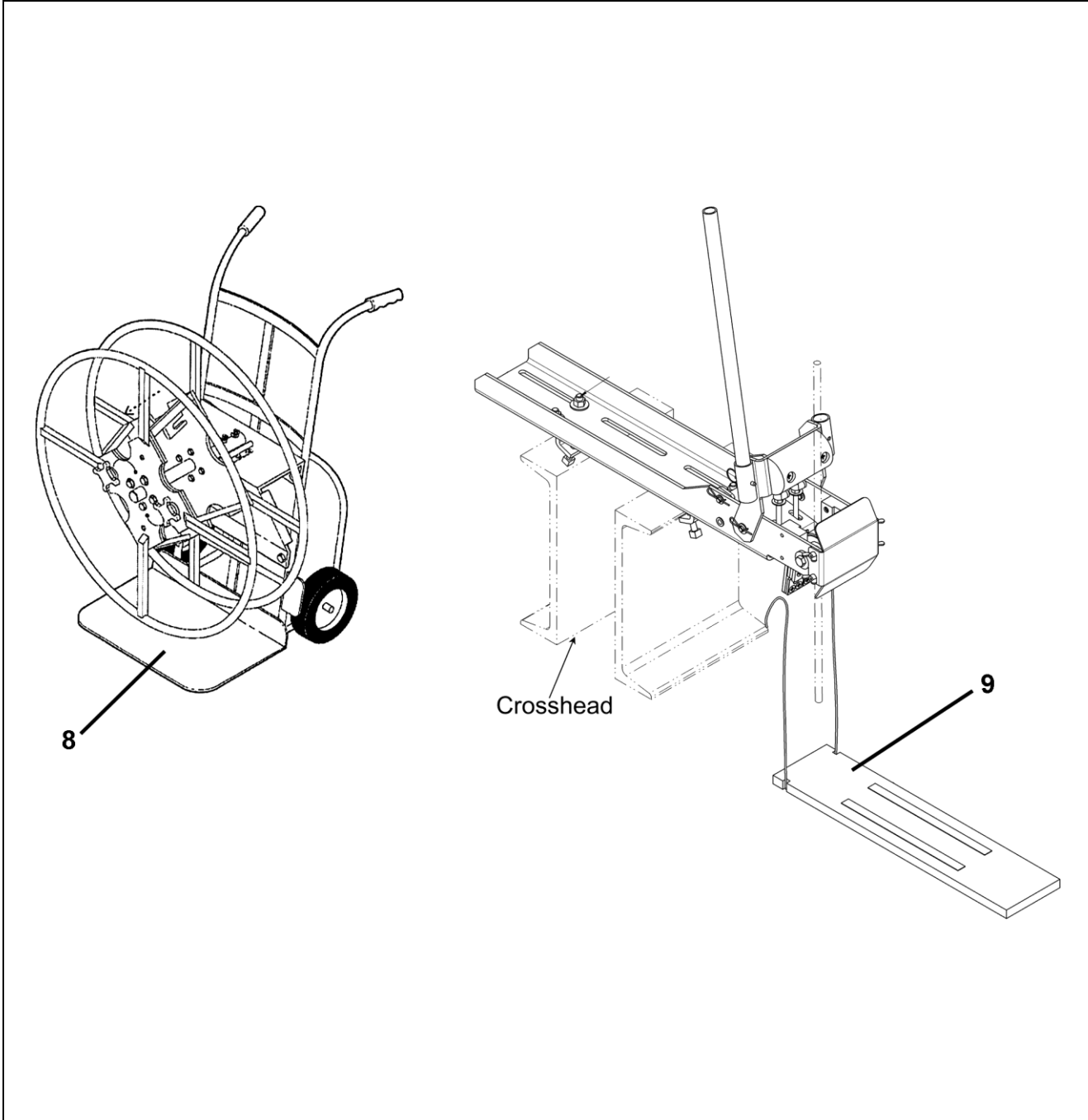

REF. No.	PART No.	DESCRIPTION
*	VP-420535	Cleaner, #2, 1 Quart, for CSB
*	VP-420550	Conditioner, CSB Belt, 1 Quart
8	MT-131008-1	Device, Rope Reeling
9	AAA22242C1	Tool, Re-Roping Service

\* Parts not shown.

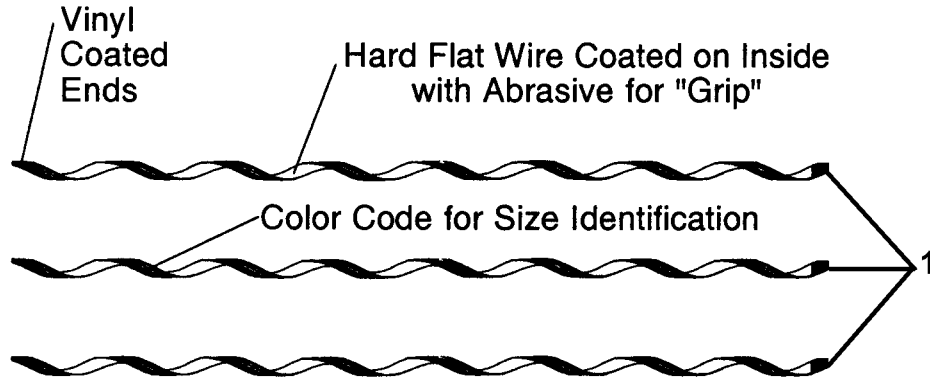

<b>REF. No.</b>	<b>PART No.</b>	<b>ROPE SIZE (IN.)</b>	<b>COLOR CODE</b>	<b>DESCRIPTION</b>
1	MT-131009-1	3/8	Yellow	Splice, Reeving (1 set includes 3 splices)
	MT-131009-2	1/2	Orange	
	MT-131009-3	5/8	Black	
	MT-131009-4	11/16	Red	
	MT-131009-5	3/4	Green	
	MT-131009-6	13/16	Yellow	
	MT-131009-7	7/8	Blue	
	MT-131009-8	1	Red / Orange	
	MT-131009-9	9/16	Yellow	

# Rope Damping Block

**11-AAA712P/Q**

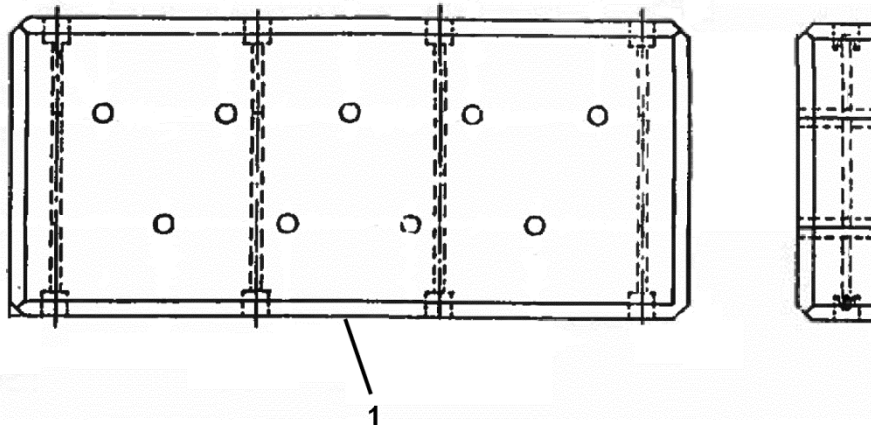

REF. No.	PART No.	DESCRIPTION
1	A336KG11	Damping Block 5 Rope, 0.5 Diameter Rope
	A336KG12	Damping Block 6 Rope, 0.5 Diameter Rope
	A336KG13	Damping Block 7 Rope, 0.5 Diameter Rope
	A336KG14	Damping Block 8 Rope, 0.5 Diameter Rope
	A336KG15	Damping Block 9 Rope, 0.5 Diameter Rope
	A336KG16	Damping Block 5 Rope, 0.625 Diameter Rope
	A336KG17	Damping Block 6 Rope, 0.625 Diameter Rope
	A336KG18	Damping Block 7 Rope, 0.625 Diameter Rope
	A336KG19	Damping Block 8 Rope, 0.625 Diameter Rope
	A336KG20	Damping Block 9 Rope, 0.625 Diameter Rope

2

**BRUGG CABLES** **Elastomeric Coated Steel Belt**

Width 60 mm Thickness 3 mm **64 kN MBL** Brugg

Otis P/N AAA717AD1

Installed by: Otis Elevator

Date of installation Month: Year:

Date first shortened Month Year

**Criteria for Replacement**  
 If indicated by inspection via Otis document  
 #AAA29000AC\_INSPG  
 Visual inspection each year  
 Inspect via MFL or PULSE™ each year after 5 years of service  
 -OR- Replace after 5 years of service

**DO NOT LUBRICATE BELTS** PART: AAA102AGW

1

ROPE MANUFACTURER

ELEVATOR WIRE ROPE

- NON PREFORMED ●
- TRACTION ●
- E.H. STRENGTH ●
- HOIST ●
- GOVERNOR ●
- COMPENSATING ●
- NATURAL FIBER CORE ●
- SYNTHETIC FIBER CORE ●

- HWRC ●
- 6X19W ●
- 6X25F ●
- 8X19S ●
- 8X19W ●
- 8X25F ●
- GALVANIZED ●
- REGULAR LAY ●
- LANG LAY ●

NOMINAL STRENGTH (LBS)

1/4"	3,600	5/8"	23,000
5/16"	5,600	5/8"	27,200
3/8"	4,200	5/8"	31,600
3/8"	5,000	11/16"	13,400
3/8"	8,200	11/16"	27,000
3/8"	9,200	11/16"	32,800
7/16"	5,600	11/16"	38,200
7/16"	11,000	3/4"	16,000
7/16"	13,500	3/4"	32,000
1/2"	7,200	3/4"	38,900
1/2"	8,400	3/4"	45,200
1/2"	14,500	13/16"	18,700
1/2"	17,500	13/16"	37,000
1/2"	20,400	13/16"	46,000
9/16"	9,200	13/16"	52,900
9/16"	18,500	7/8"	21,400
9/16"	22,100	7/8"	42,000
5/8"	11,200	7/8"	52,800
5/8"	12,800	7/8"	61,200

OTHER DIAMETER  NOMINAL B.S. (LBS.)

ROPE TO BE LUBRICATED PER MANUFACTURES AND/OR INSTALLATION COMPANIES RECOMMENDATIONS.

ROPES INSTALLED BY: (COMPANY NAME AND DATE)

DATE ROPES FIRST SHORTENED

JAN. ● FEB. ● MAR. ● APR. ●

MAY ● JUNE ● JULY ● AUG. ●

SEPT. ● OCT. ● NOV. ● DEC. ●

2  2011 ● 2012 ● 2013 ●

2014 ● 2015 ● 2016 ● 2017 ●

REF. No.	PART No.	DESCRIPTION
1	AAA102ACD2	Data Plate, Wire Rope
2	AAA102AGW1	Data Plate, CSB, 64kN, Brugg (AAA717AD1 Belt)
	AAA102AGW2	Data Plate, CSB, 32kN, Brugg (AAA717X1 Belt)
	AAA717W1-TAG AAA102AGW3	Data Plate, CSB, 32kN, Contitech (AAA717W1 Belt)
	AAA717R1-TAG AAA102AGW4	Data Plate, CSB, 64kN, Contitech (AAA717R1 Belt)
	AAA102AGW5	Data Plate, CSB, 43kN, Contitech (AAA717AJ2 Belt)
	AAA102AGW6	Data Plate, CSB 43kN, Contitech (AAA717AJ4 Belt)
	AAA102AGW7	Data Plate, CSB 86kN, Contitech (AAA717AJ5 Belt)

Page 28

December 14, 2022

This document does not contain any technical data subject to EAR or ITAR  
 Unpublished Work—Otis Elevator Co., 2022

# Order Form Instructions

**11-AAA712P/Q**

## I. Parts Identification Instructions

“A” items are stocked at all Brugg stocking locations.

“B” items are stocked at Brugg in Rome, GA.

“Class” 6 x 19 and 8 x 19 refer to wire rope classifications.

6 x 19 and 6 x 25 construction fall within the 6 x 19 classification and are considered interchangeable.

8 x 19, 8 x 21, and 8 x 25 construction fall within the 8 x 19 classification and are considered interchangeable.

See page 5 for further clarification on hoist ropes.

## II. Machine Identification

Order single-tensile rope for machines 18ATF, 156MST, PM138, and 30T. For other machines, order dual-tensile rope.

## III. Top-of-Car Handrails and WWJSSS Machine Guard

For information on top-of-car handrails, refer to TIP 0.1.5-7.

For information on WWJSSS Machine Guard Installation, refer to the TIPs listed in the table.

Machine	TIP No.
74, 77	6.1.1-16
29CT	6.2.4-2
17CT, 22CT, 19BT, 27BT	6.2.0-15
70, 72	6.1.1-15
Foreign Equipment	6.0-11
130HT, 131HT, 139HT	6.1.1-14
219HT	6.1.3-3

## IV. How To Fill Out Wire Rope Order Form

When filling out the **Wire Rope Order Form**, pay special attention to the Dates and Priority sections. These items must be filled in. To avoid shipping delays, use the following two tables as reference.

### A. Required Dates Section

Date	Description	Reason/Resulting Action
Ordered Date	Indicates the date the field placed an order for ropes.	For tracking purposes.
Wanted Date	Indicates the date the field desires to have the rope arrive at the desired shipping location.	If the Wanted Dates are not filled in, the order will be shipped ground. The word “ASAP” will also be shipped ground.

### B. Required Priority Section

Priority	Description	Resulting Action
Routine	Standard order with more than one-week lead-time.	Routine orders will ship via best means.
Urgent	Needed within one week.	Urgent orders will ship to best way to meet wanted date.
Shutdown	Needed next day.	Shutdown orders will ship air.

**NOTE:** Standard ropes ship within 24 hours after the order is received at Brugg.

11-AAA712P/Q

# Wire Rope Order Form

## Standard Wire Rope Order Form

OSC REGULAR LAY WIRE ROPE ORDER FORM

Email to: [CSEmailorders@otis.com](mailto:CSEmailorders@otis.com)

Ordered by: \_\_\_\_\_

Phone #: \_\_\_\_\_

Office Prefix: \_\_\_\_\_

Bldg Name: \_\_\_\_\_

Machine / Contract#: \_\_\_\_\_

Machine Type: (e.g. 17CT, 131HT, etc) \_\_\_\_\_

Charge # \_\_\_\_\_

Charge # \_\_\_\_\_

**IF REQUESTING SHIPMENT VIA AIR, OBTAIN AND ATTACH RFOM APPROVAL BEFORE SUBMITTING THIS ORDER FORM!**

Ordered Date: \_\_\_\_\_

Wanted by date: \_\_\_\_\_

Ship to Branch: Yes  If no, address below

SHIP TO ADDRESS

Special Requirements: \_\_\_\_\_

Application (CHECK ONE):  Hoist  Comp  Gov  Tiller

NOTE: >>ORDERS FOR IRON HOIST ROPES MUST BE APPROVED BY OSC FOR APPLICATION AND SAFETY FACTOR

	SIZE <small>PLACE AN "X" IN BOX UNDER THE SIZE WANTED FOR DESIRED ROPE</small>							SPECIFY NUMBER OF PIECES & LENGTH OF PIECES		
	5/16	3/8	1/2	5/8	11/16	3/4	13/16	OTHER METRIC	PIECES	FEET (EA.)
<b>Hoist &amp; Compensation Ropes</b>										
(6M) 6 x 19 TRACTION STEEL REGULAR LAY										
(6EH) 6 x 19 Ex. HIGH STRENGTH REGULAR LAY										
(8M) 8 x 19 TRACTION STEEL REGULAR LAY										
(8EH) 8 x 19 Ex. HIGH STRENGTH REGULAR LAY										
IWRC STEEL CORE ROPE										
<b>Governor Ropes</b>										
(8M4) 8 x 19 STEEL REG. LAY NON-PREFORMED										
(6L4) 6 x 19 IRON REG. LAY NON-PREFORMED										
Poly Core										
<b>Tiller Rope</b>										
7/16" 6x36 AAA712P131										

### List Shackles That Need to be Ordered with Ropes

Other Ropes	5/16	3/8	1/2	5/8	11/16	3/4	13/16	PIECES	FEET (EA.)

Customer OSC Order Number (by OSC): \_\_\_\_\_

Rev. Date: December 5, 2022

# Wire Rope Order Form

11-AAA712P/Q

## OSC "LANG LAY" WIRE ROPE, LINERS & CSB ORDER FORM

Email to: [CSEmailorders@otis.com](mailto:CSEmailorders@otis.com)  
 Ordered by: \_\_\_\_\_  
 Phone #: \_\_\_\_\_  
 Office Prefix: \_\_\_\_\_  
 Bldg Name: \_\_\_\_\_  
 Machine/Contract #: \_\_\_\_\_  
 Machine Type: (e.g. 17CT, 131HT etc)  
 Charge #: \_\_\_\_\_

Ordered Date: \_\_\_\_\_  
 Wanted by date: \_\_\_\_\_  
 Ship to Branch: Yes  If no, address below

SHIP TO ADDRESS

\_\_\_\_\_  
 \_\_\_\_\_  
 \_\_\_\_\_

### Special Requirement

Application (CHECK ONE):  Hoist  Comp  Gov

NOTE: >>ORDERS FOR IRON HOIST ROPES MUST BE APPROVED BY OSC FOR APPLICATION AND SAFETY FACTOR

PLACE AN "X" IN BOX UNDER THE SIZE WANTED FOR DESIRED ROPE

SPECIFY NUMBER OF PIECES & LENGTH OF PIECES

	SIZE							OTHER	
	5/16	3/8	1/2	5/8	11/16	3/4	13/16	METRIC	FEET (EA)
<b>Hoist Ropes - "LANG LAY" ONLY</b>									
6 x 19 TRACTION STEEL LANG LAY									
6 x 19 EXTRA HIGH STRENGTH LANG LAY									
8 x 19 TRACTION STEEL LANG LAY									
8 x 19 EXTRA HIGH STRENGTH LANG LAY									
<b>Coated Steel Belts (CSB)</b> <b>ALL CSB ORDERS REQUIRE RFOM APPROVAL! PLEASE OBTAIN AND ATTACH RFOM APPROVAL BEFORE SUBMITTING THIS ORDER FORM!</b>									
Machine Number required:		32 kN	43 kN	64 kN	86 kN				
		non FT1	FT1	FT1	FT1				
<b>Sheave liner and Sheave to be ordered (if required)</b>									
Sheave diameter:									
Liners:		Treaded		Smooth:					

### List Shackles That Need to be Ordered with Ropes

	SIZE							OTHER	
	5/16	3/8	1/2	5/8	11/16	3/4	13/16	METRIC	FEET (EA)
<b>Other Ropes</b>									

Customer order number by OSC: \_\_\_\_\_

Rev. Date: December 5, 2022