

**Tape Reader Assembly
(HydroFit® / HydroAccel®)**

Spare Parts Leaflet

12-AAA27076JA

August 16, 2023 / Page 1 of 4

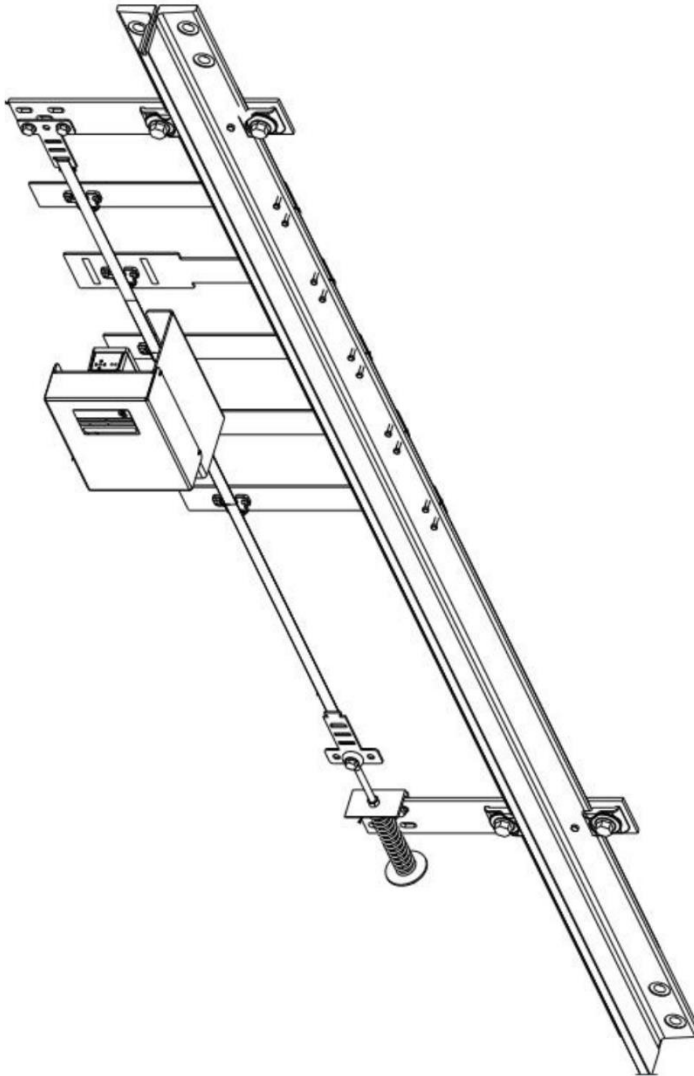

W/O VINTAGE

12

A – AAA27076JA

OTIS

This document does not contain any technical data subject to EAR or ITAR

**SERVICE ENGINEERING
Otis Elevator Company
Bloomfield, Connecticut USA**

Unpublished Work—© Otis Elevator Co.; 2023

Leaflet Description

This leaflet provides spare parts information for the tape reader assemblies used with GCS hydraulic control system for HydroFit® and HydroAccel.

Leaflet Revisions

Date Revised	Subject Matter Expert	Reason for Revision
July 19, 2023	Gary Mendrala	New SPL
August 16, 2023	Gary Mendrala	Crossed out AAA102VY56 on p. 3

Related Drawings

Drawing No.	Title	Drawing No.	Title
AAA21242E	Holeless Hydro Controller Assembly and Arrangement	AAA25590AJ	HydroFit® Limit Switch Assembly
AAA27800T	HydroFit™ APS Sensor	AAA27076JA	HydroFit® Position Reference System GCS Hydraulic (Holeless & Telescopic)
AAA25580DZ	HydroFit® Discrete Interface PCBA	AAA22440Z_FMI	HydroFit® Position Reference System GCS Hydraulic (Holeless & Telescopic) Field Micro Instruction
AAA21600KQ	HydroFit® Tape Reader Electrical Cable	AAA297CE	Code Tape
AAA22440V	Clip Bracket Kit	AAA22440W	Tape Termination Kit

Related Documents

Document ID	Title
SPL 05-AAA25590AJ	<i>HydroFit® Limit Switch Assembly</i>
AAA21242F	<i>HydroFit® System Wiring Diagram</i>
AAA21242F-CMS	<i>HydroFit® Construction Startup FMI</i>
AAA21242F-SA	<i>HydroFit® Adjusting FIM</i>

Subject Matter Expert

Name	Department
Gary Mendrala	OSC Service Engineering

About Spare Parts Leaflets...

This document lists the lowest replaceable units (LRUs) for the standard version of the product. The LRUs are chosen by a team of Otis associates representing engineering and manufacturing. While goal of this document is to make parts identification as easy as possible, the document cannot be all-inclusive. Elevator and escalator contracts classified as "special" or "custom" are not addressed here. For such contracts, please refer to specified information, the contract folder, TIPs, Field Education Articles, Construction Letters, etc. for further information. If you have any suggestions about this document, please contact the subject matter expert listed on this page.

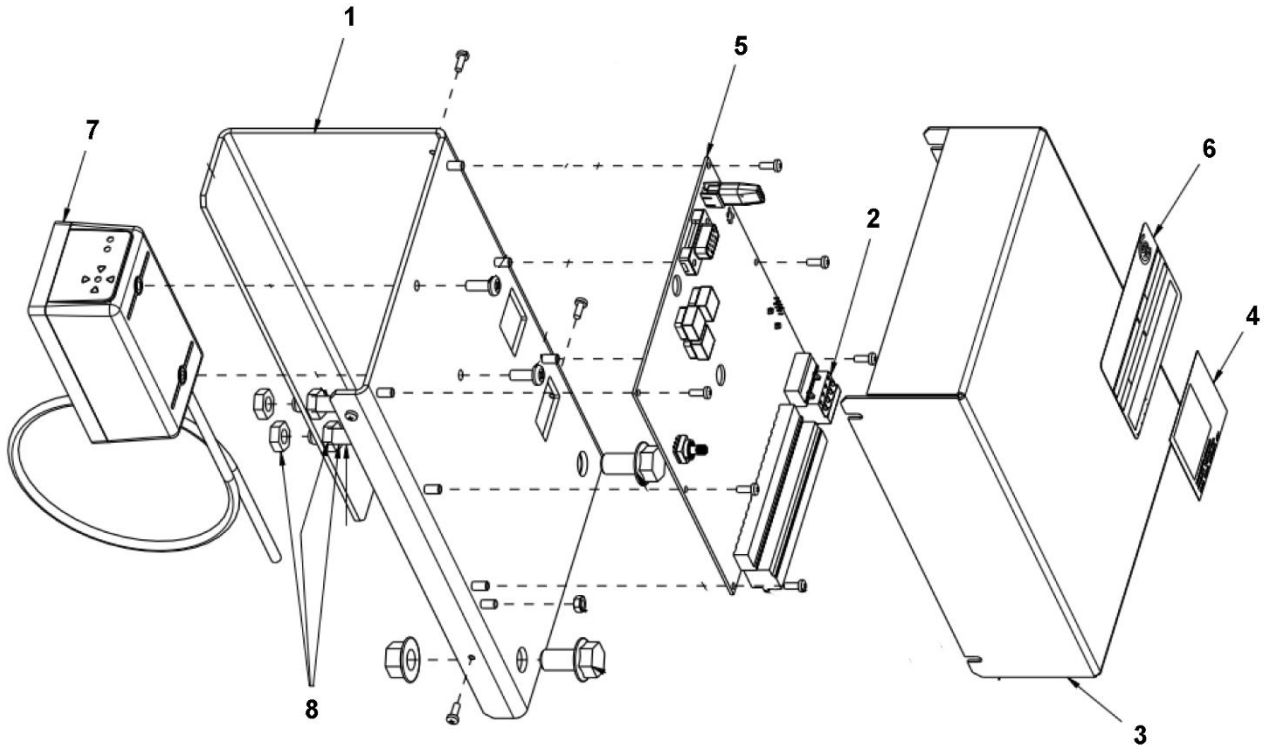

ABA25580EA		
REF. No.	PART No.	DESCRIPTION
1	AAA316KQY2	Bracket (as shown)
	AAA316KQY4	Bracket (opposite hand)
*	AAA21600KQ1	Cable, Electrical (not shown)
2	AAA378D25	Connector
3	ABA316KTB1	Cover
4	AAA102BFE1_QR50064	Label, QR Code
5	AAA25580DZ1	PCB, Discrete Interface SIE
6	AAA102VY56	Plate, Data
7	AAA27800T1	Sensor, APS
8	AAA608B2	Switches, Proximity

* part not shown.

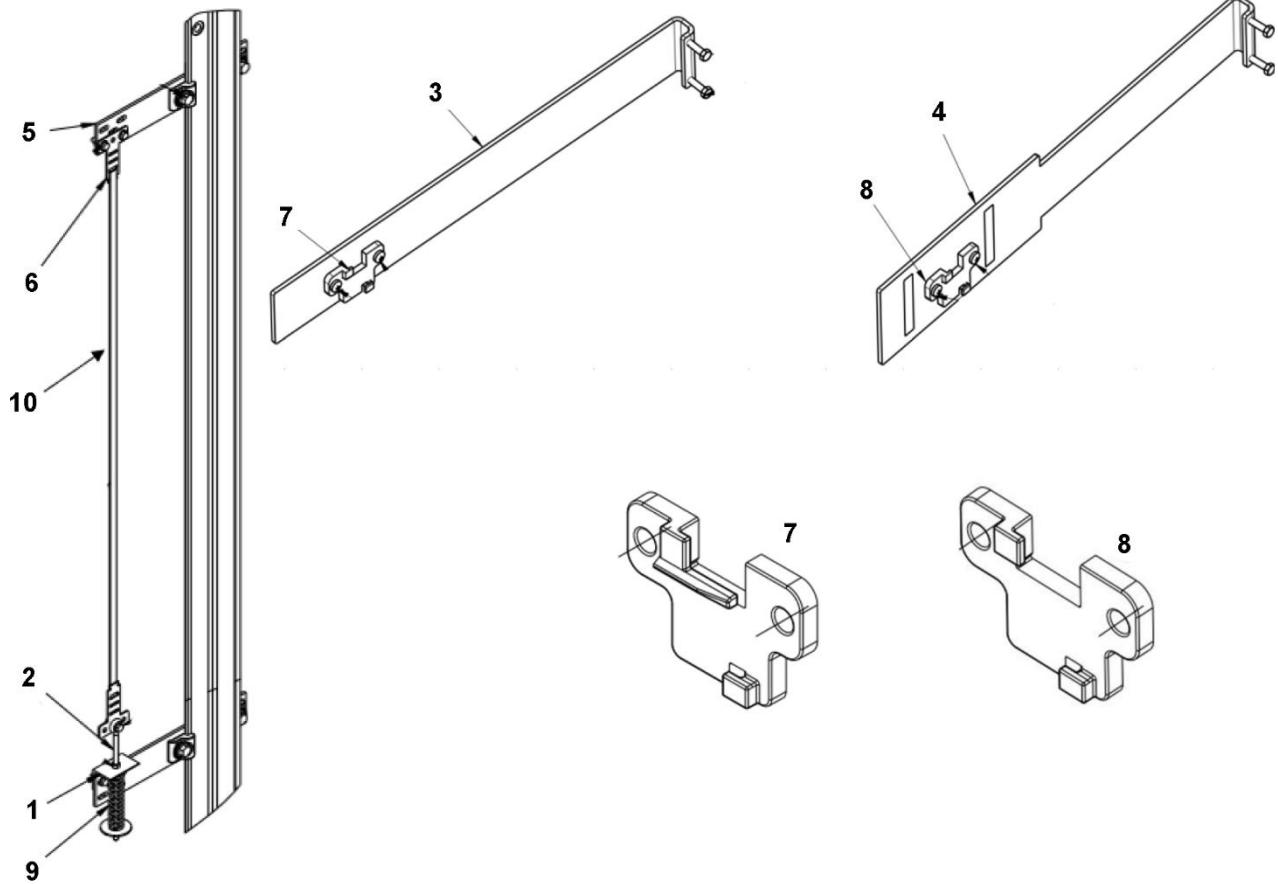

AAA22440V
AAA22440W

REF. No.	PART No.	DESCRIPTION
1	272FC108	Angle
2	65GB9	Bolt, Eye
3	AAA316KSE1	Bracket, Clip Mounting
4	AAA316KSE2	Bracket, Clip Mounting
5	AAA316JLS2	Bracket, Tape Hanging
6	AAA316KSD1	Bracket, Tape Termination
7	AAA339RM1	Clip, Position (used to indicate floor level)
8	AAA339RM2	Clip, Guide (used to secure tape)
*	339GM1	Clip, Rail #1-1/2
*	339D1	Clip, Rail #1
*	AAA233J40	Magnet, 60 mm L, (w/ adhesive),  NOTES 1 and 2
9	90FC5	Spring, Compression
10	AAA297CE999	Tape, Code, Rise + 14 ft. (4318 mm). Length must be specified
*	VP-420422	Wipes, Alcohol (box of 50, each wipe is 6 in. x 6 in.)

* Parts not shown.

NOTE 1: Alcohol wipes can be used for cleaning the tape.

NOTE 2: For hoistway magnet position, refer to AAA22440Z_FMI.