

**RPD Device Assembly
PRS Skyrise® / E2**

**Spare Parts Leaflet
12-AAA29505P**

July 28, 2021 / Page 1 of 3

Landing Sill

Car Sill

W/O VINTAGE

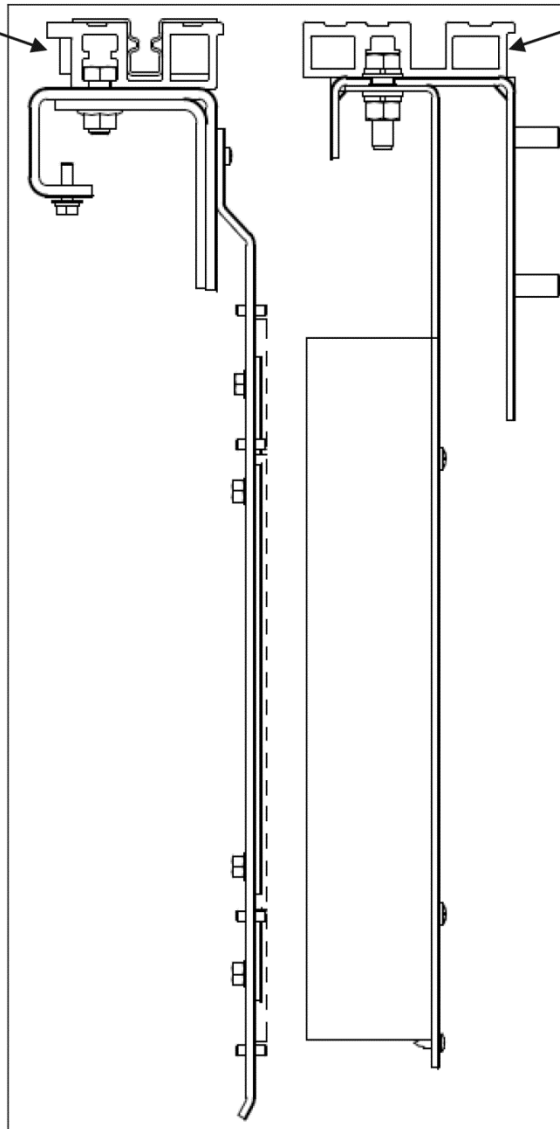

OTIS

SERVICE ENGINEERING
Otis Elevator Company
HRSIT, Shanghai China

Unpublished Work—© Otis Elevator Co.; 2021

Leaflet Description

This leaflet provides spare parts information for Skyrise® (GMH) RPD (Relative Position Device) in Position Reference System of E2 control system.

Leaflet Revisions

Date Revised	Subject Matter Expert	Reason for Revision
September 1, 2014	Jiang Cheng	New SPL
July 28, 2021	Gary Mendrala	Added KAA233AAC11, 12 and ACA29505M3, 4

Related Drawings

Drawing No.	Title	Drawing No.	Title
AAA29505P	RPD Device Assembly Arrangement	AAA29505M	RPD Sensor Assembly
KAA233AAC	Magnet for RPD	AAA29505L	Vane Bracket Assembly
ACA29505M	RPD Sensor Assembly		

Related Documents

Document ID	Title

Subject Matter Expert

Name	Department
Gary Mendrala	OSC Service Engineering

About Spare Parts Leaflets...

This document lists the lowest replaceable units (LRUs) for the standard version of the product. The LRUs are chosen by a team of Otis associates representing engineering and manufacturing.

While goal of this document is to make parts identification as easy as possible, the document cannot be all-inclusive. Elevator and escalator contracts classified as “special” or “custom” are not addressed here. For such contracts, please refer to specified information, the contract folder, TIPs, Field Education Articles, Construction Letters, etc. for further information.

If you have any suggestions about this document, please contact the subject matter expert listed on this page.

Position Reference System

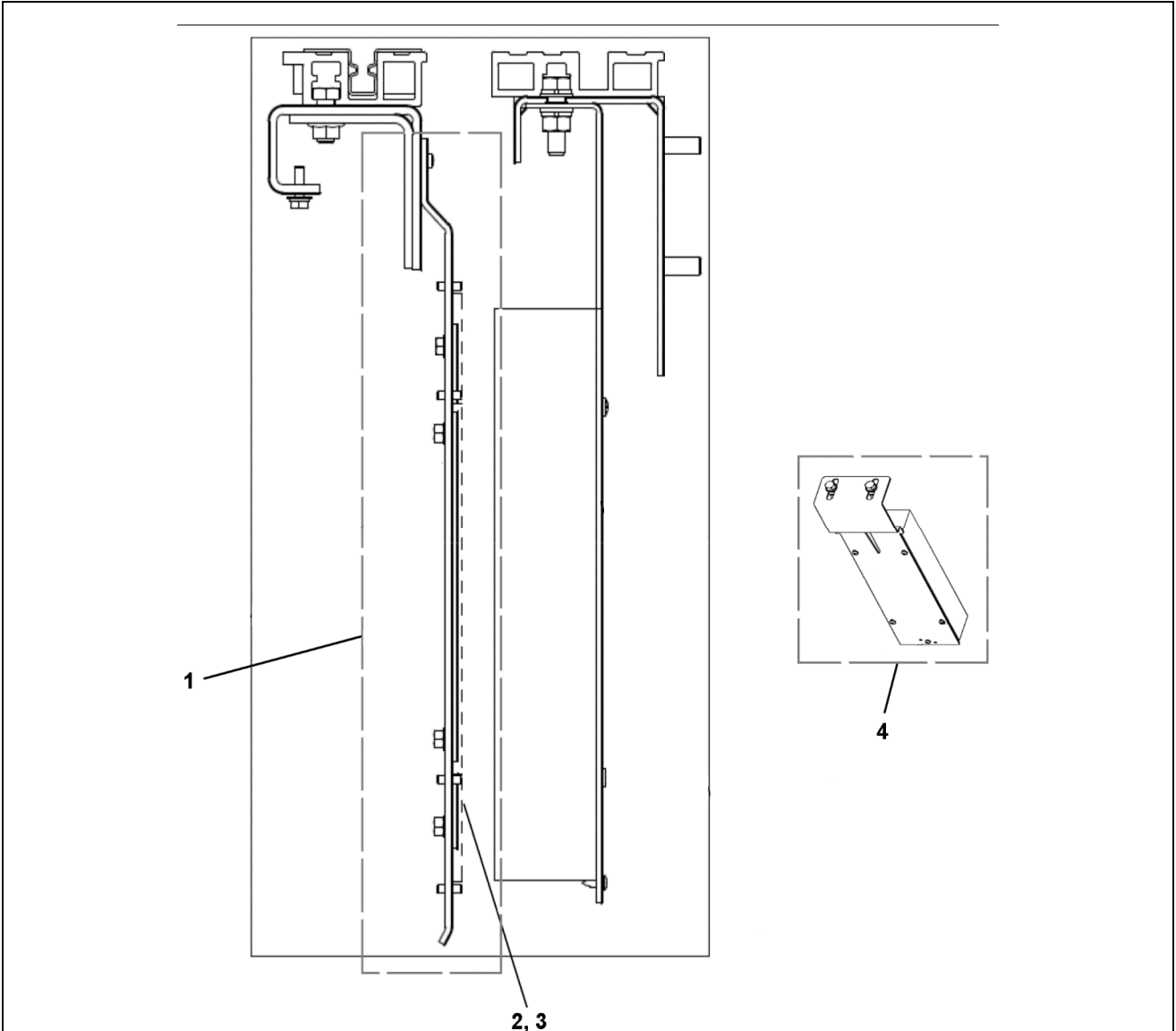

VINTAGE		
REF. No.	PART No.	DESCRIPTION
1	AAA29505L1	Vane Bracket Assembly
2	KAA233AAC4 KAA233AAC11	Magnet for RPD , length = 270 mm (ODZ Track)
3	KAA233AAC2 KAA233AAC12	Magnet for RPD, length = 170 mm (DZ Track)
4	AAA29505M1	RPD Sensor, ANSI ODZ = 9 in.
	ACA29505M3	RPD Sensor, ANSI ODZ = 6 in.
	AAA29505M2 ACA29505M4	RPD Sensor Assembly for JIS