

**Gen2[®] Underslung
(2100–4000 lb. Duties) and
HydroFit[®] Car Frame
(2100–3500 lb. Duties)**

**Spare Parts Leaflet
14-AAA29507K**

May 26, 2021 / Page 1 of 17

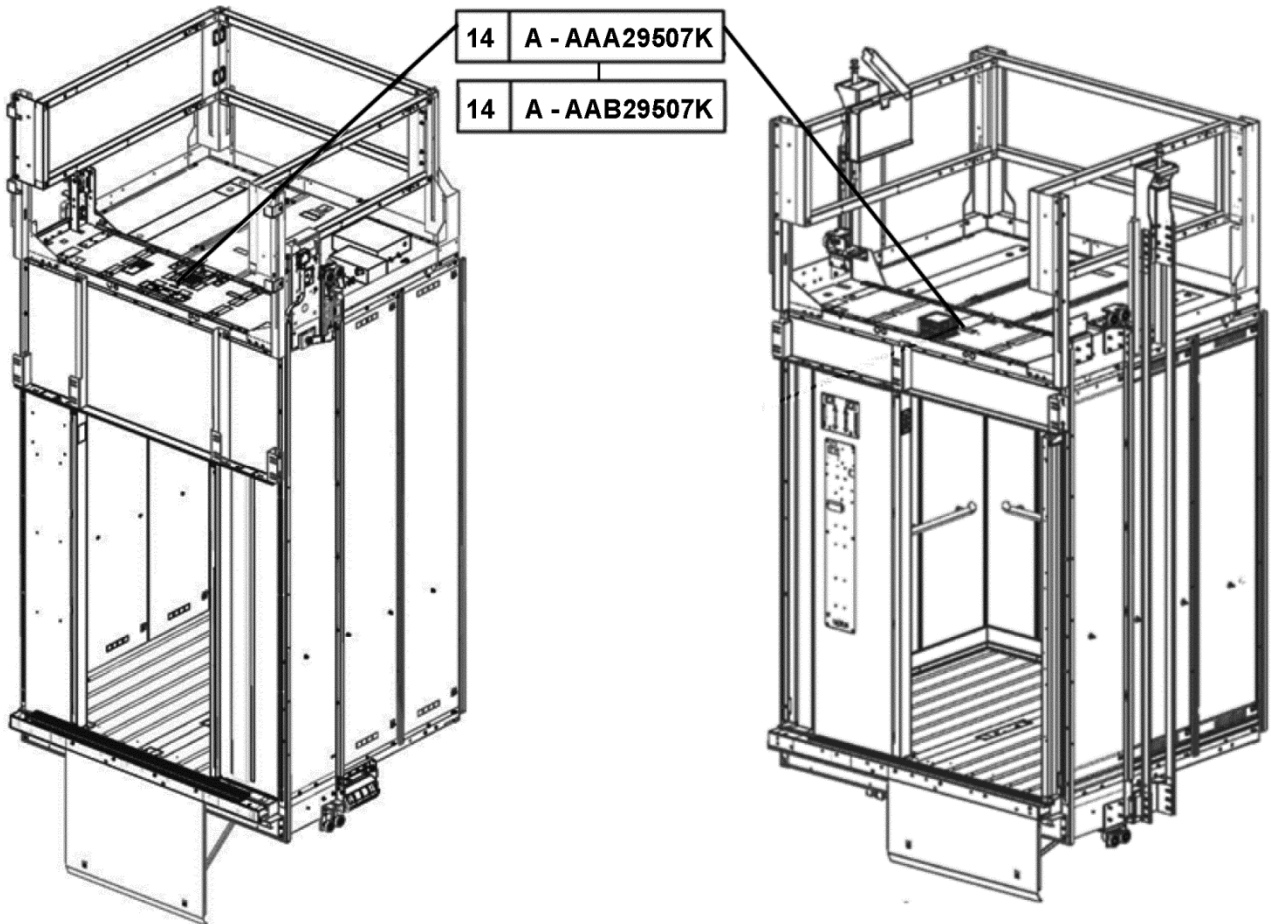

OTIS

This document does not contain any technical data subject to EAR or ITAR

SERVICE ENGINEERING

Otis Elevator Company

Bloomfield, Connecticut USA

Unpublished Work—© Otis Elevator Co.; 2021

Leaflet Description

This spare parts leaflet covers the car frame spare parts used on the Gen2 150/200/350 (also known as the Gen2 Underslung or G2S), 2100–4000 lb. duties, and the HydroFit, 2100–3500 lb. duties.

Leaflet Revisions

Date Revised	Subject Matter Expert	Reason for Revision
December 18, 2013	Kyle Pereira	New SPL
July 30, 2014	Kyle Pereira	Updated references 1–3 on p. 5 (former page 6)
November 26, 2014	Jay Lengacher and Kyle Pereira	Updated page numbers and parts on pp. 9, 12, and 13
March 16, 2016	Troy Chicoine and Charles Lowd	Updated to reflect AAB29507K vintage parts
February 8, 2017	Juan Murillo	Added new p/n AAA29507L453 on p. 10
May 24, 2017	Juan Murillo	Corrected p. 5; Added new illustration for Ref. 2 on p. 9
May 26, 2021	Cuauhtemoc Castro	Added p/n AAA321MJ1 to p. 8; Updated LEDs from 4W to 2W part numbers on p. 16

Related Drawings

Drawing No.	Title	Drawing No.	Title
AAA29507K_TDS	G2S & HydroFit Car Technical Data Sheets	AAA29503J_TDS	G2S & HydroFit Cab TDS

Related Documents

Document ID	Title	Document ID	Title
SPL 14-KAA24120AAJ	P45A Progressive Safety - ASME A17.1 Applications	SPL 14-AAA20780Y	Integrated Sheave Kit
SPL 15-TAA20641J	Governor	SPL 15-TAA20641H	Governor
SPL 14-AAA24180BC	Roller Guides	SPL 14-AAA24180BE	Roller Guides
SPL 17-AAA25580CA	Top-of-Car Handrail		

Subject Matter Expert

Name	Department
Juan Murillo	OSC Service Engineering

About Spare Parts Leaflets...

This document lists the lowest replaceable units (LRUs) for the standard version of the product. The LRUs are chosen by a team of Otis associates representing engineering and manufacturing.

While goal of this document is to make parts identification as easy as possible, the document cannot be all-inclusive. Elevator and escalator contracts classified as “special” or “custom” are not addressed here. For such contracts, please refer to specified information, the contract folder, TIPs, Field Education Articles, Construction Letters, etc. for further information.

If you have any suggestions about this document, please contact the subject matter expert listed on this page.

Table of Contents

14-AAA29507K

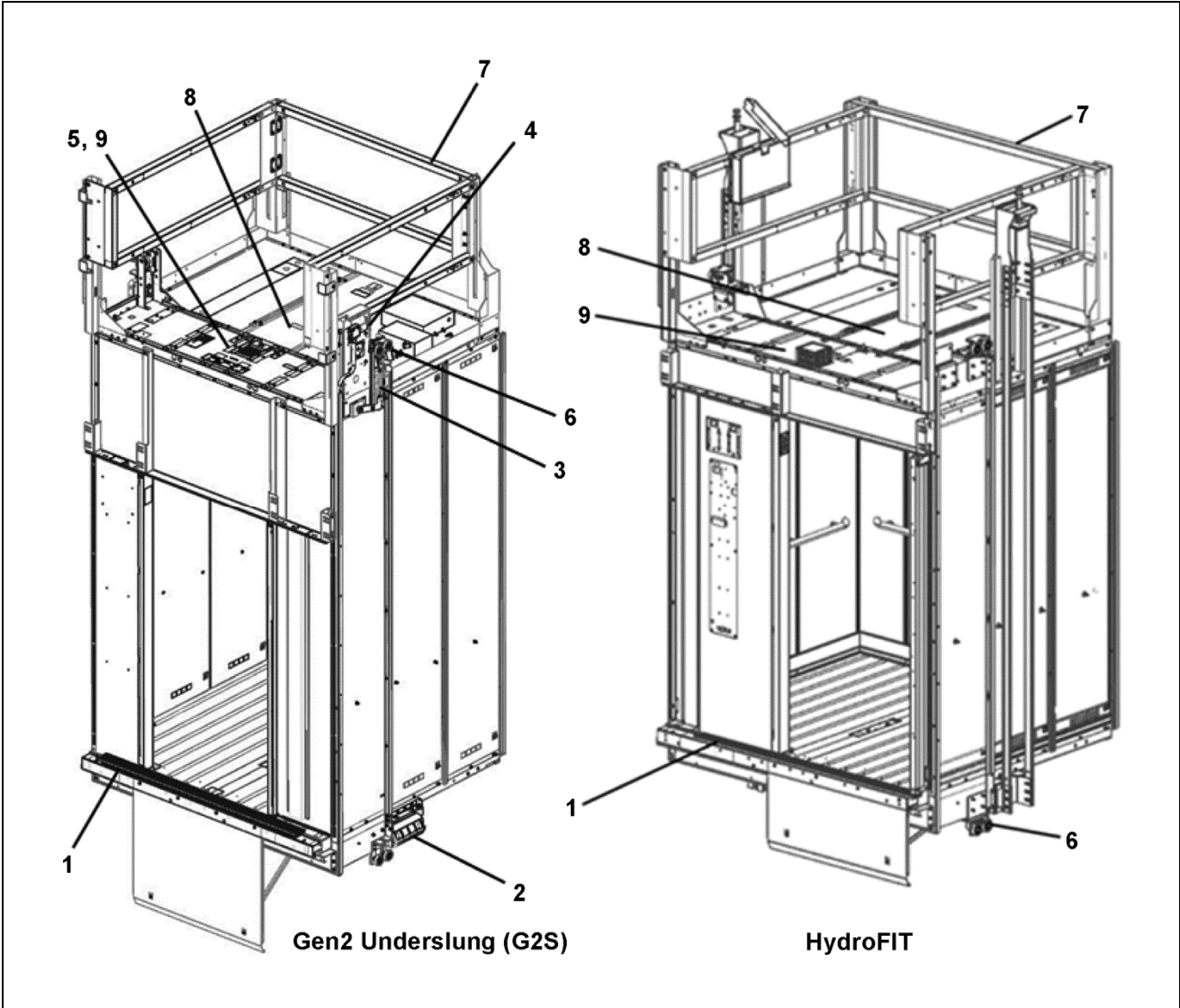

REF. No.	PAGE No.	DESCRIPTION
1	4	Threshold
2	5	Sheave Assembly
3	6	Safeties
4	7	Governor
5	8–9	Safety Linkages
6	10	Roller Guides
7	11	Top-of-Car Handrail
8	12	Top-of-Car Emergency Exit
9	13	Crosshead Electrical Components and Variable Speed Fan
*	14–15	Handrails, In-Car
*	16	Drop Ceiling (Light Bulb, Light Socket, and Ring)
*	17	Miscellaneous Spare Parts

* Not shown

14-AAA29507K

Threshold

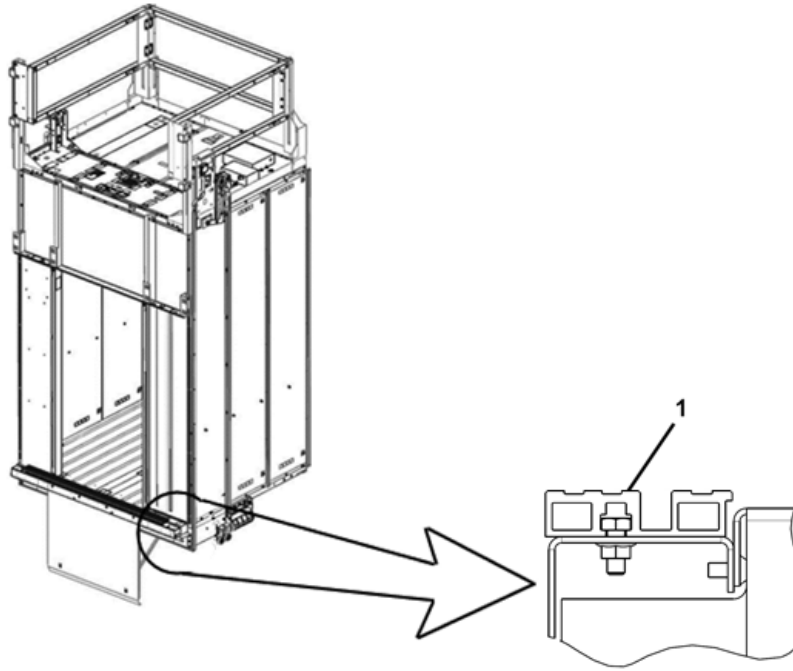

AAA29507K
AAB29507K

REF. No.	PART No.	OPENING WIDTH	LENGTH	OPENING TYPE	MATERIAL	DESCRIPTION
1	AAA280BJ1	42 in. (1067 mm)	67.34 in. (1711 mm)	Center-Opening	Aluminum	Threshold
	AAA280BJ3	48 in. (1219 mm)	76.32 in. (1938.5 mm)			
	AAA280BJ5	36 in. (914 mm)	59.49 in. (1511 mm)	Single-Slide		
	AAA280BJ8	42 in. (1067 mm)	68.52 in. (1741 mm)			
	AAA280BJ18	N/A	76.32 in. (1938.5 mm)	CO or SS		
	AAA280BN1	42 in. (1067 mm)	67.34 in. (1711 mm)	Center-Opening	Bronze	Threshold
	AAA280BN3	48 in. (1219 mm)	76.32 in. (1938.5 mm)			
	AAA280BN5	36 in. (914 mm)	59.49 in. (1511 mm)	Single-Slide		
	AAA280BN8	42 in. (1067 mm)	68.52 in. (1741 mm)			
	AAA280BN18	N/A	76.32 in. (1938.5 mm)	CO or SS		
	AAA280BM1	42 in. (1067 mm)	67.34 in. (1711 mm)	Center-Opening	Nickel Silver	Threshold
	AAA280BM3	48 in. (1219 mm)	76.32 in. (1938.5 mm)			
	AAA280BM5	36 in. (914 mm)	59.49 in. (1511 mm)	Single-Slide		
	AAA280BM8	42 in. (1067 mm)	68.52 in. (1741 mm)			
	AAA280BM18	N/A	76.32 in. (1938.5 mm)	CO or SS		

Sheave Assembly

14-AAA29507K

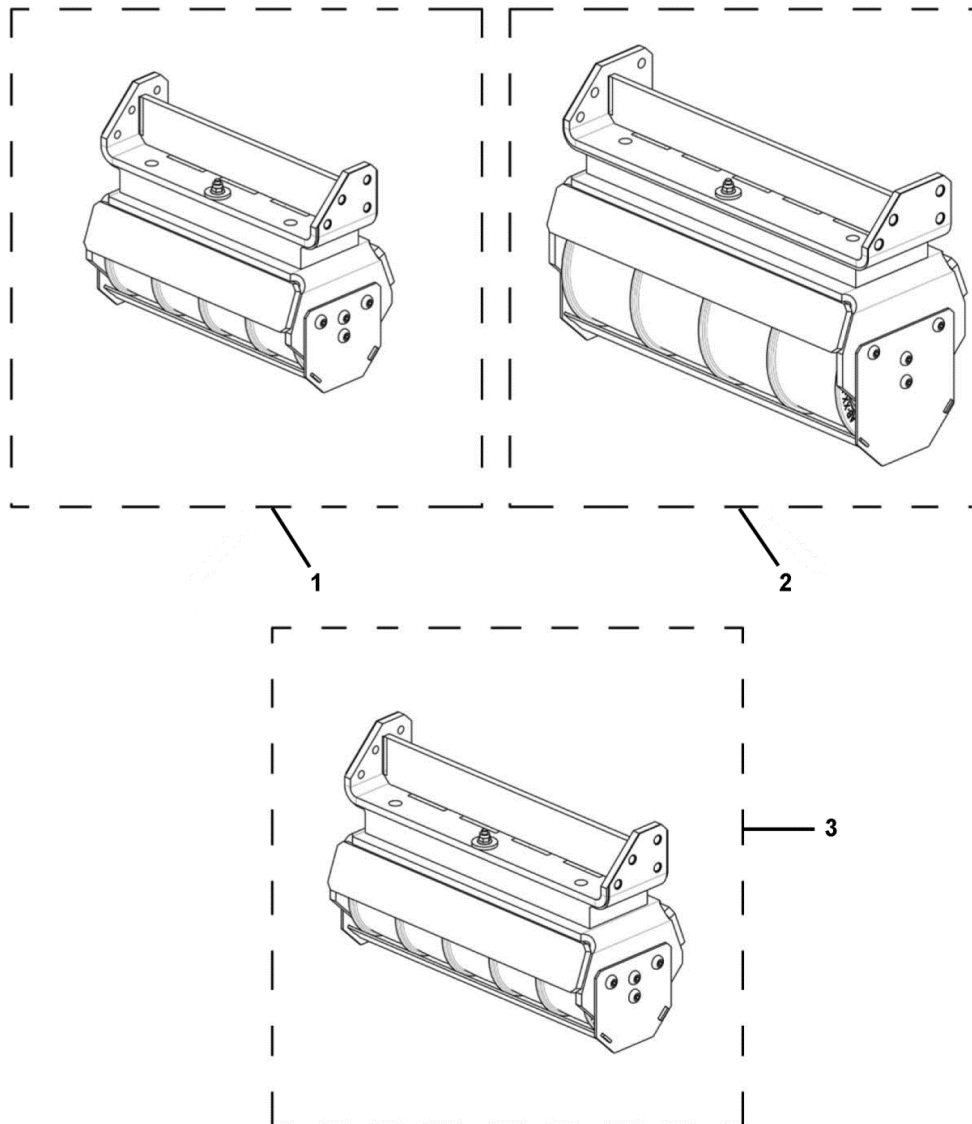

AAA29507K AAB29507K		
REF. No.	PART No.	DESCRIPTION
1	AAA20780Y1 ABA20780Y1	Assembly, Sheave and Housing, 4 Grooves, 43 kN
2	AAA20780Z1 ABA20780Z1	Assembly, Sheave and Housing, 4 Grooves, 64 kN
3	AAA20780Y2 ABA20780Y2	Assembly, Sheave and Housing, 5 Grooves, 43 kN
*	N0N1241M8X20-8.8Z	Bolt, Mounting, M8X20, 8 Required for 43 kN Sheave
*	N0N1241M10X20-8.8Z	Bolt, Mounting, M10X20, 8 Required for 64 kN Sheave

* Not shown

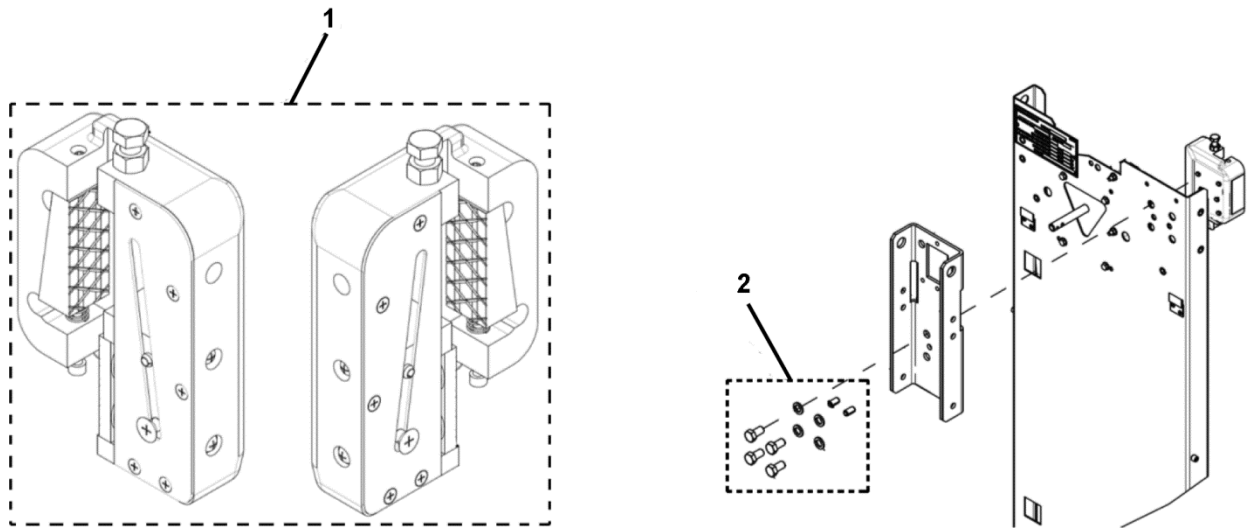

REF. No.	PART No.	DESCRIPTION
	AAA29507K AAB29507K	
1	---	Kit, Safety Assembly. See SPL 14-KAA24120AAJ for details.
2	AAA29507E425	Kit, Safety Mounting Hardware. Includes (8) M16X30 Bolts and (8) M16 Spring Lockwashers.

Governor

14-AAA29507K

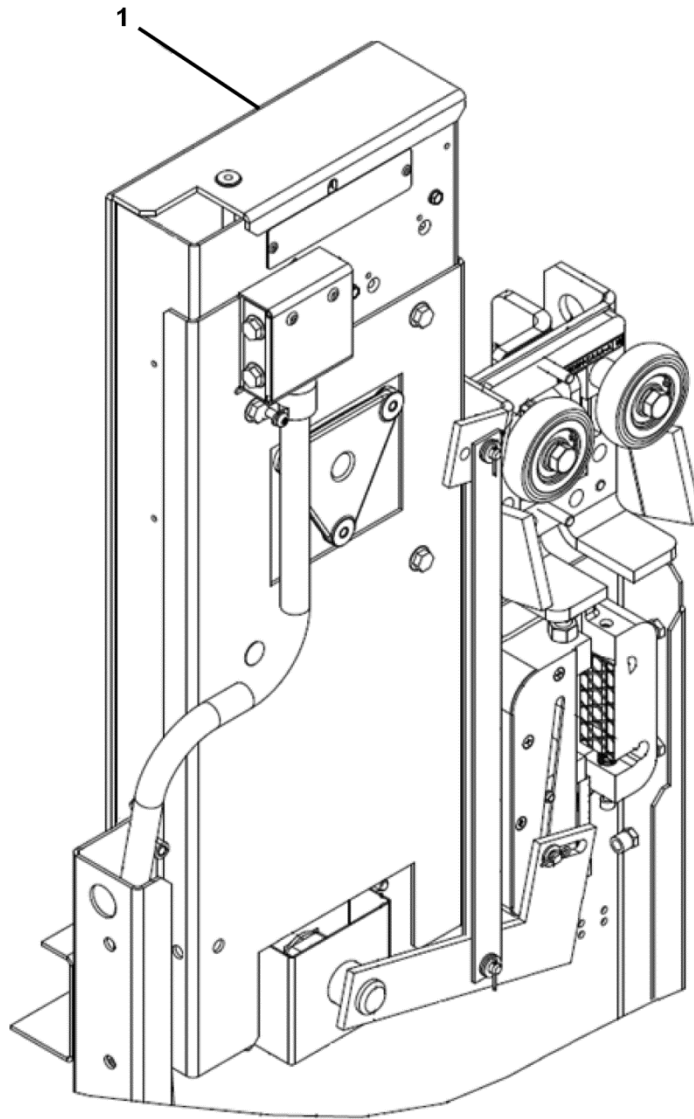

	AAA29507K AAB29507K	
REF. No.	PART No.	DESCRIPTION
1	---	Governor, Manual and Remote Set (150 & 200 fpm). See SPL 15-TAA20641J.
		Governor, Manual and Remote Set (350 fpm). See SPL 15-TAA20641H.

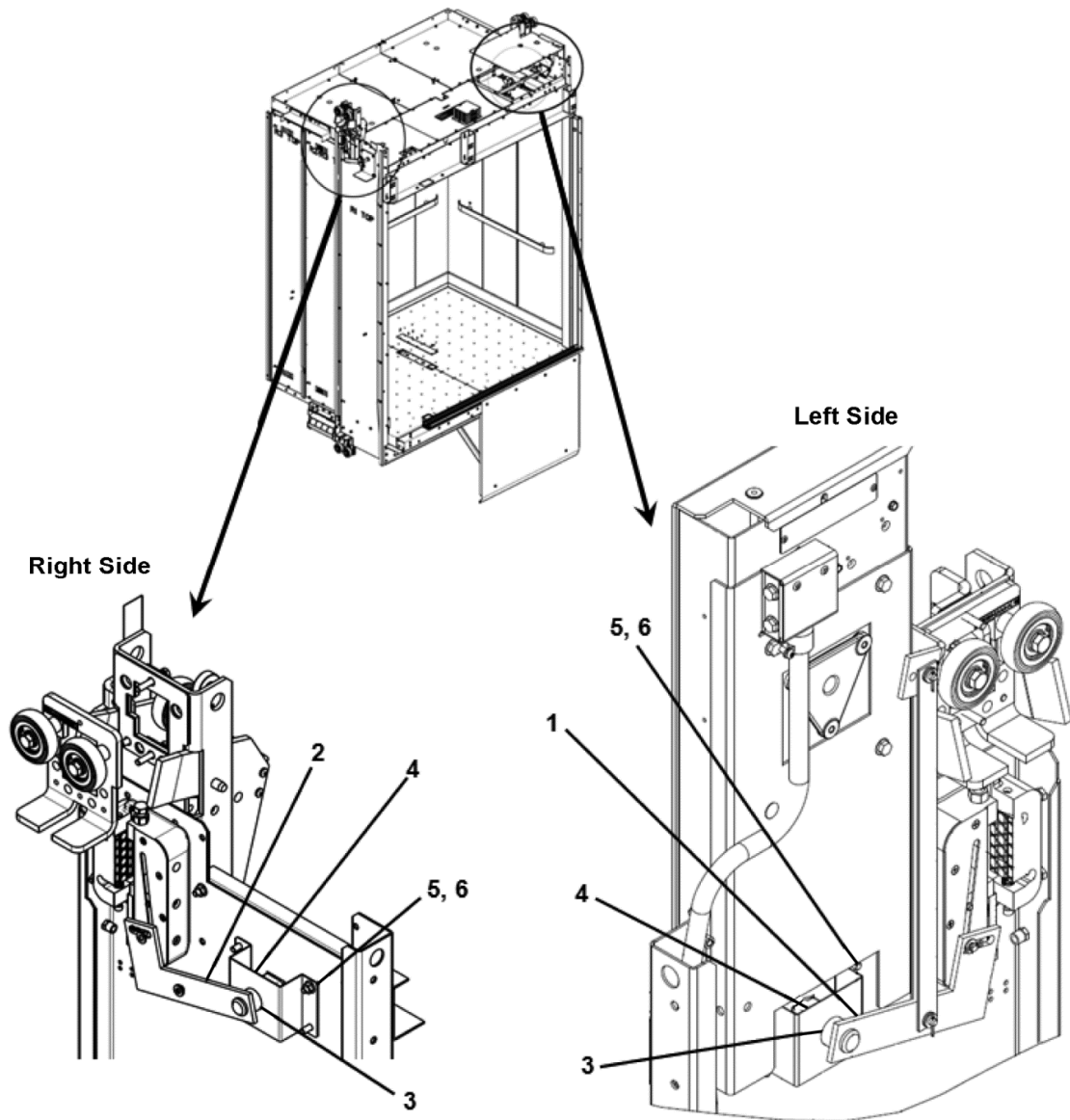

AAA29507K AAB29507K		
REF. No.	PART No.	DESCRIPTION
1	AAA288AEZ2	Arm, Safety Lever, Left Side
2	AAA288AEZ1	Arm, Safety Lever, Right Side
3	AAA321LL2 AAA321MJ1	Bushing
4	AAA315ADS2	Channel, Formed
5	N0N7201M8-8-Z	Nut, M8 Hex Nut w/Serrated Flange
6	N0N1241M8X20-8.8Z	Screw, M8X20 Hex Head w/ Serrated Flange

(Continued on Next Page)

Safety Linkages

14-AAA29507K

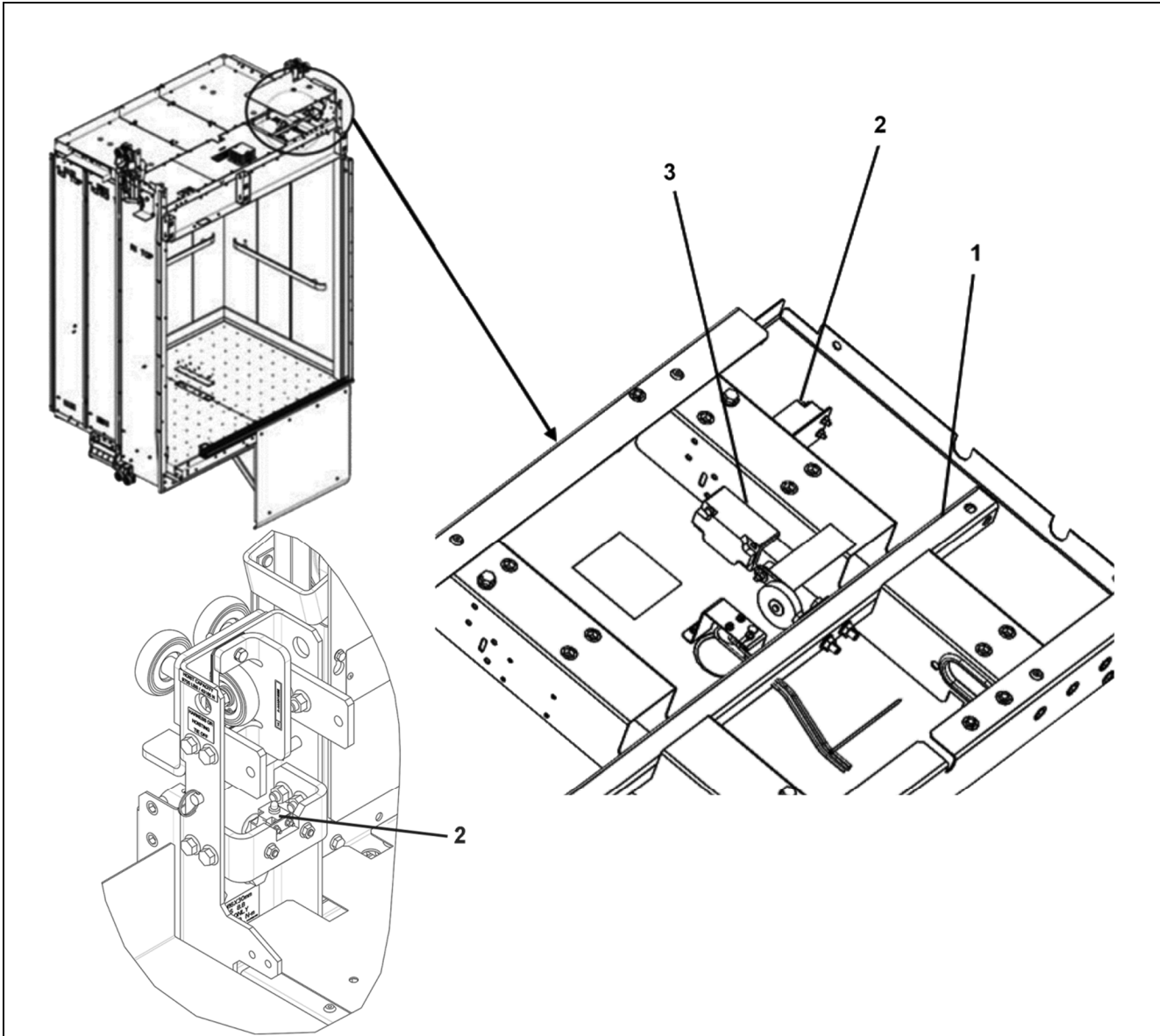

AAA29507K AAB29507K		
REF. No.	PART No.	DESCRIPTION
1	AAA135HT1	Assembly, Safety Linkage Shaft, 64.47 in. (1638 mm) Long. For 2100 lb. Duty
	AAA135HT2	Assembly, Safety Linkage Shaft, 73.72 in. (1873 mm) Long. For 2500, 3000, and 3500 lb. Duties
	AAA135HT3	Assembly, Safety Linkage Shaft, 85.73 in. (2178 mm) Long. For 4000 lb. Duty
2	AAA22800T6	Switch, Blocking
3	AAA22800T3	Switch, SOS

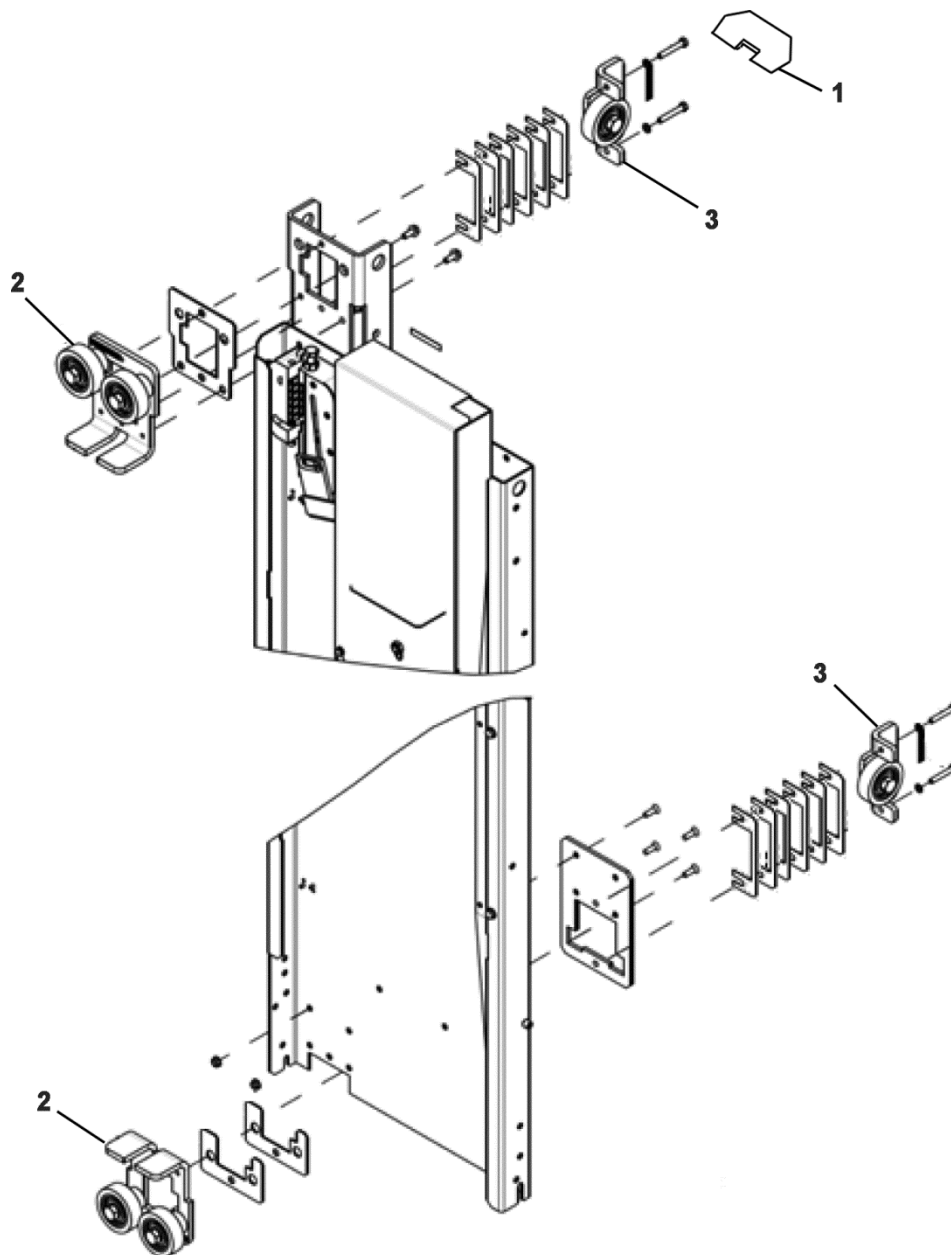

**AAA29507K
AAB29507K**

REF. No.	PART No.	DESCRIPTION
1	AAA29507L453	Kit, Hardware, Roller Guide Top Guard, NOTE
2	---	Rollers, Front/Back and Post. SPL 14-AAA24180BC.
3		

NOTE: This top guard will only be supplied to the city of LA.

Top-of-Car Handrail

14-AAA29507K

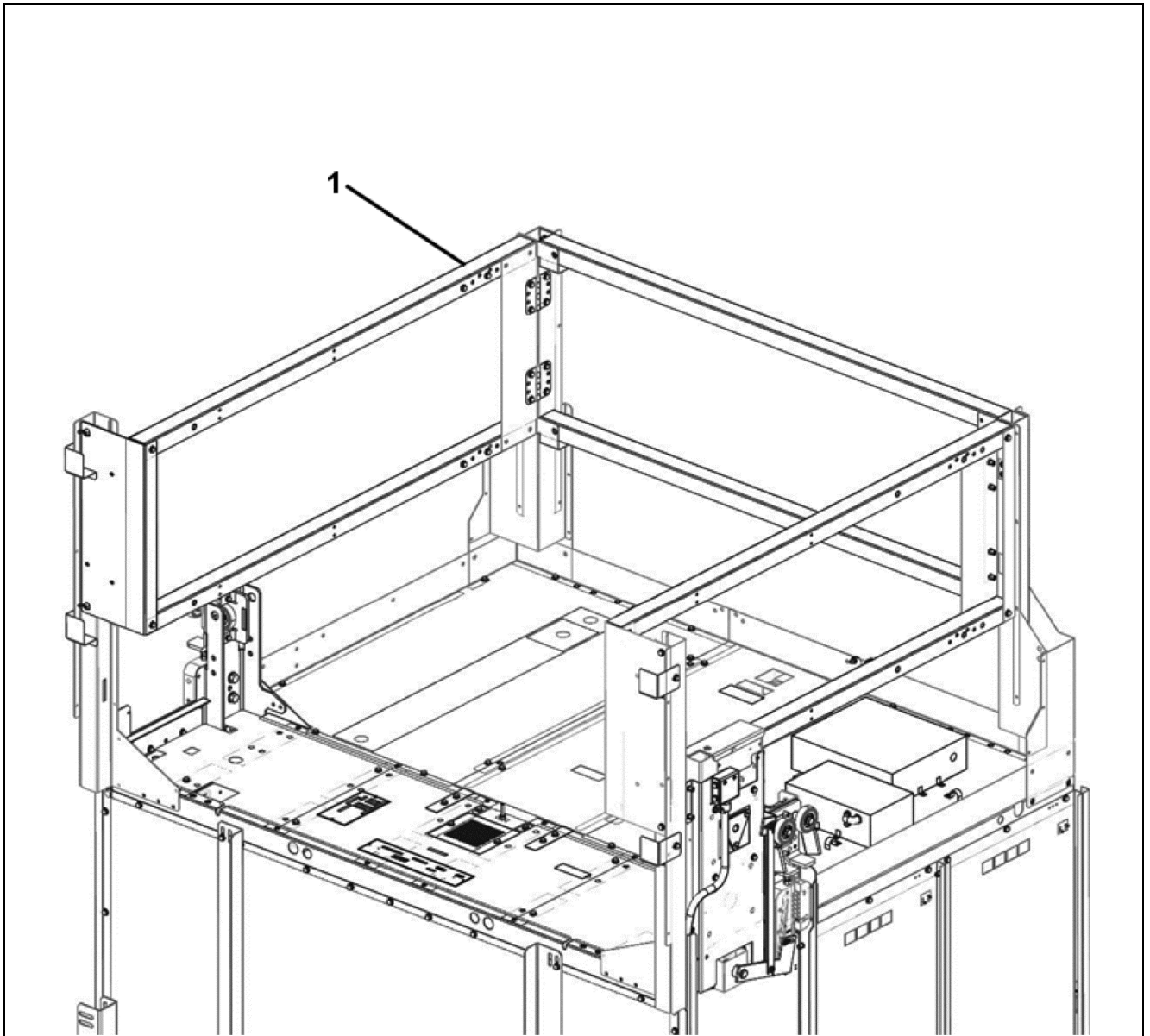

REF. No.	PART No.	DESCRIPTION
1	AAA29507K AAB29507K	Top-of-Car Handrail. See SPL 17-AAA25580CA.

14-AAA29507K

Top-of-Car Emergency Exit

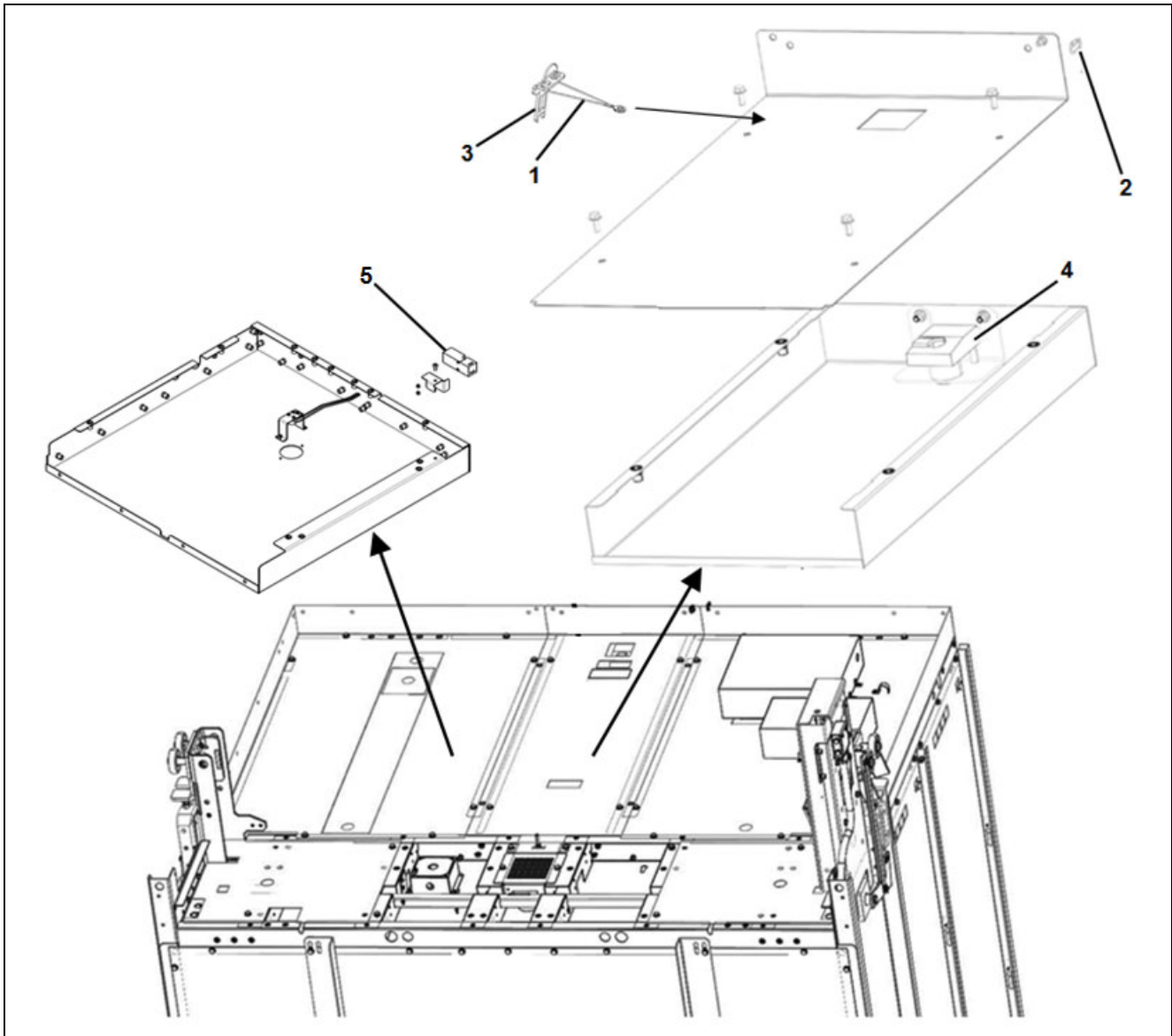

AAA29507K
AAB29507K

REF. No.	PART No.	DESCRIPTION
1	AAA712AK1	Cable Rope, Lanyard
2	AAA176HZ1	Connector
3	AAA22800T5	Keyswitch
4	AAA431AM1	Lock, 5-Pin, with 2 Keys (# 1245)
	AAA431AM2	Lock, 5-Pin, with 2 Keys (# 3502). For Massachusetts only.
5	AAA22800T4	Switch, Emergency Exit

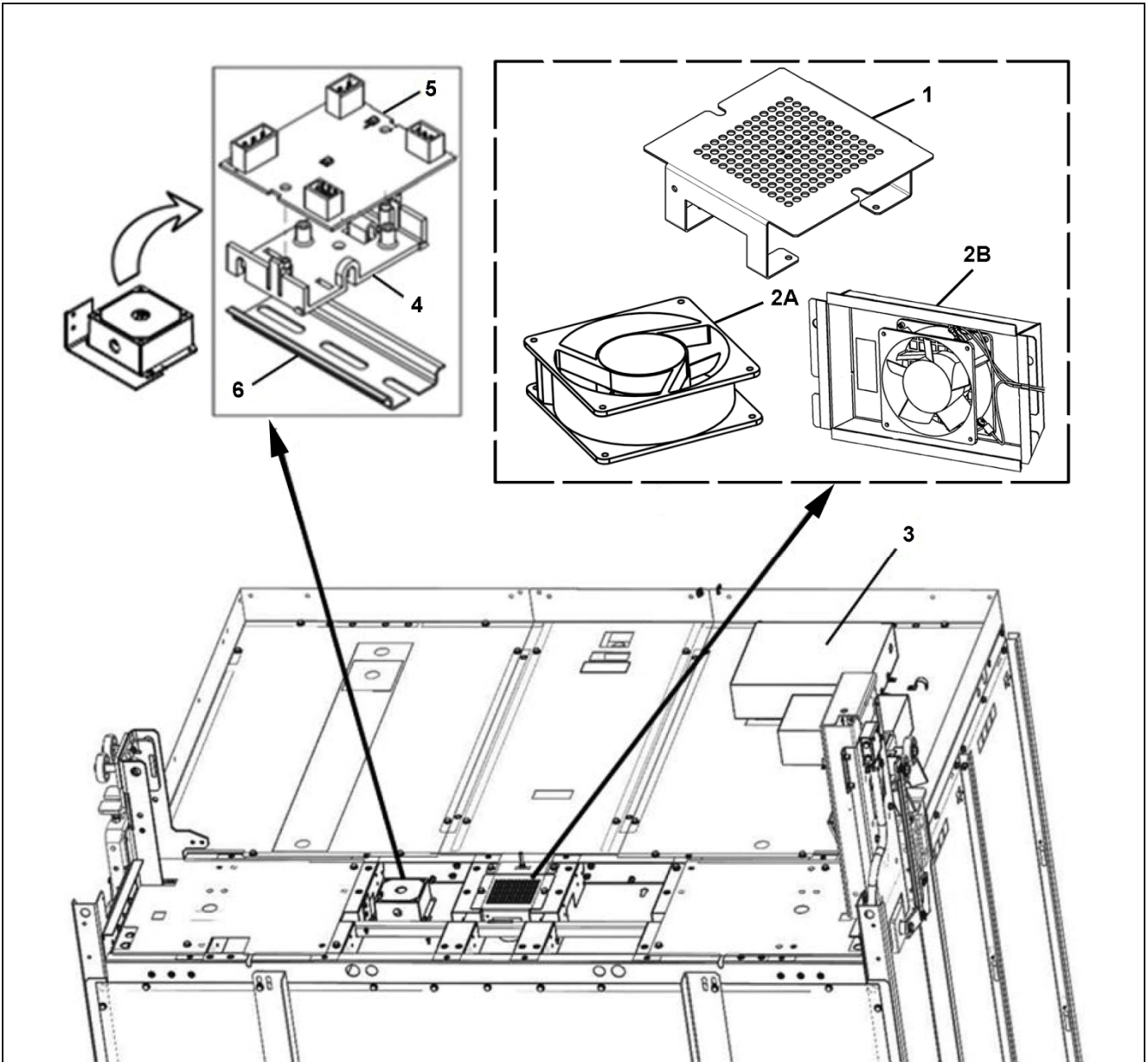

	AAA29507K	AAB29507K	
REF. No.	PART No.		DESCRIPTION
1	AAA346BKY1	---	Cover, Fan
2A	AAA24720T10	---	Fan
2B	---	AAA24720AB1	Fan
3	AAA24720M7		Fan, Variable Speed
4	AAA180FE1		Holder, PC Board
5	AAA24591AM117		PC Board, OPTIGUARD™
6	401B89		Rail

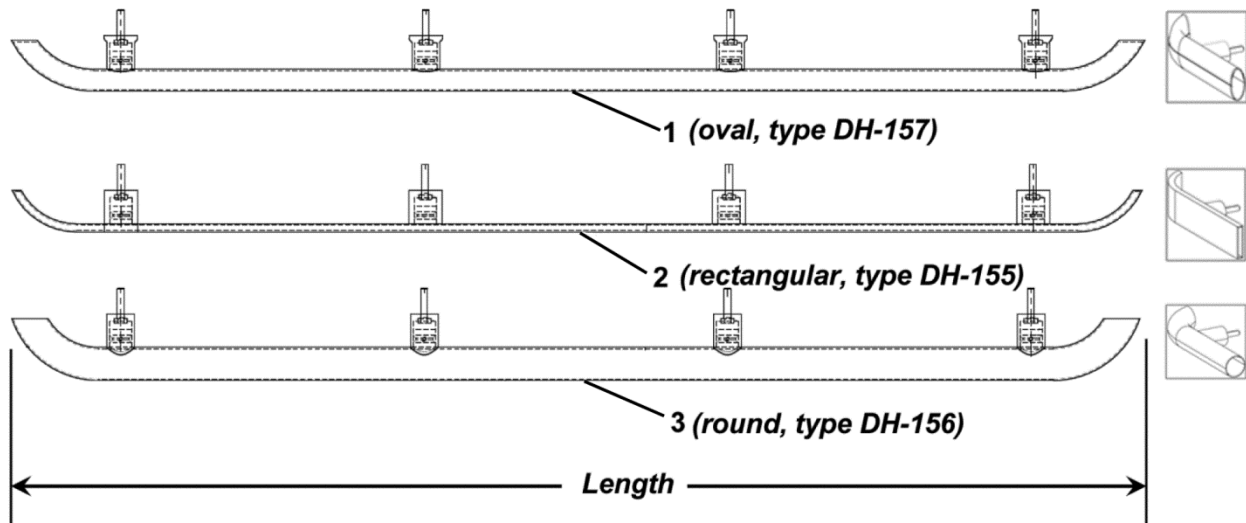

AAA29507K AAB29507K		REF. No.	PART No.	FINISH	DUTIES (lb.)	LENGTH	HANDRAIL SHAPE
1	AAA139BT1	Brushed Steel	2100	59.65 in. (1515 mm)	Oval, DH-157, 24.5 x 50.8 mm (1 x 2 in.)		
	AAA139BT2		2500, 3000, 3500	68.9 in. (1750 mm)			
	AAA139BT6		4000P	80.9 in. (2055 mm)			
2	AAA139BQ15	Bronze Tinted	2100	59.65 in. (1515 mm)	Rectangular, DH-155, 50.8 x 9.5 mm (2 x 0.375 in.)		
	AAA139BQ16		2500, 3000, 3500	68.9 in. (1750 mm)			
	AAA139BQ20		4000P	80.9 in. (2055 mm)			
	AAA139BQ1	Brushed Steel	2100	59.65 in. (1515 mm)			
	AAA139BQ2		2500, 3000, 3500	68.9 in. (1750 mm)			
	AAA139BQ6		4000P	80.9 in. (2055 mm)			
3	AAA139BS15	Bronze Tinted	2100	59.65 in. (1515 mm)	Round, DH-156, 38.1 mm (1.5 in.) Diameter		
	AAA139BS16		2500, 3000, 3500	68.9 in. (1750 mm)			
	AAA139BS20		4000P	80.9 in. (2055 mm)			
	AAA139BS1	Brushed Steel	2100	59.65 in. (1515 mm)			
	AAA139BS2		2500, 3000, 3500	68.9 in. (1750 mm)			
	AAA139BS6		4000P	80.9 in. (2055 mm)			

In-Car Handrails, Side

14-AAA29507K

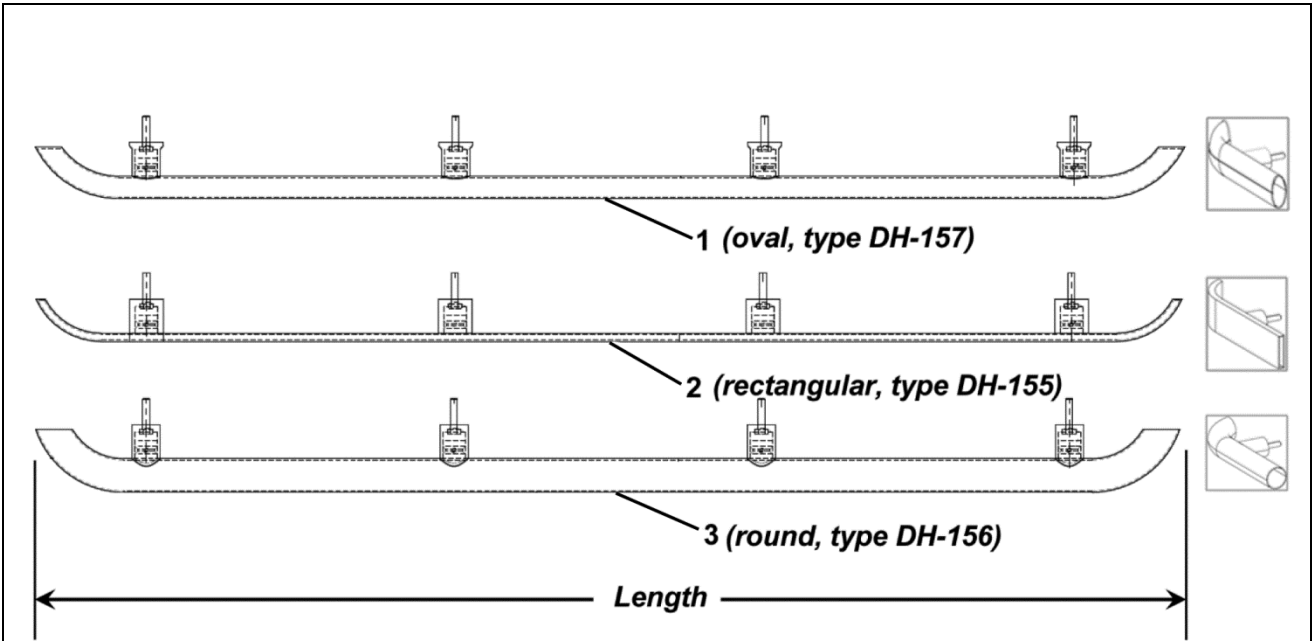

AAA29507K AAB29507K					
REF. No.	PART No.	FINISH	DUTIES (lb.)	LENGTH	HANDRAIL SHAPE
1	AAA139BT4	Brushed Steel	3000	50.9 in. (1293 mm)	Oval, DH-157, 24.5 x 50.8 mm (1 x 2 in.)
	AAA139BT3		2100, 2500	42.28 in. (1074 mm)	
	AAA139BT5		3500, 4000P	56.3 in. (1430 mm)	
2	AAA139BQ18	Bronze Tinted	3000	50.9 in. (1293 mm)	Rectangular, DH-155, 50.8 x 9.5 mm (2 x 0.375 in.)
	AAA139BQ17		2100, 2500	42.28 in. (1074 mm)	
	AAA139BQ19		3500, 4000P	56.3 in. (1430 mm)	
	AAA139BQ4	Brushed Steel	3000	50.9 in. (1293 mm)	
	AAA139BQ3		2100, 2500	42.28 in. (1074 mm)	
	AAA139BQ5		3500, 4000P	56.3 in. (1430 mm)	
3	AAA139BS18	Bronze Tinted	3000	50.9 in. (1293 mm)	Round, DH-156, 38.1 mm (1.5 in.) Diameter
	AAA139BS17		2100, 2500	42.28 in. (1074 mm)	
	AAA139BS19		3500, 4000P	56.3 in. (1430 mm)	
	AAA139BS4	Brushed Steel	3000	50.9 in. (1293 mm)	
	AAA139BS3		2100, 2500,	42.28 in. (1074 mm)	
	AAA139BS5		3500, 4000P	56.3 in. (1430 mm)	

**Ceiling & Drop Ceiling
Light Bulb, Light Socket, Trim Ring**

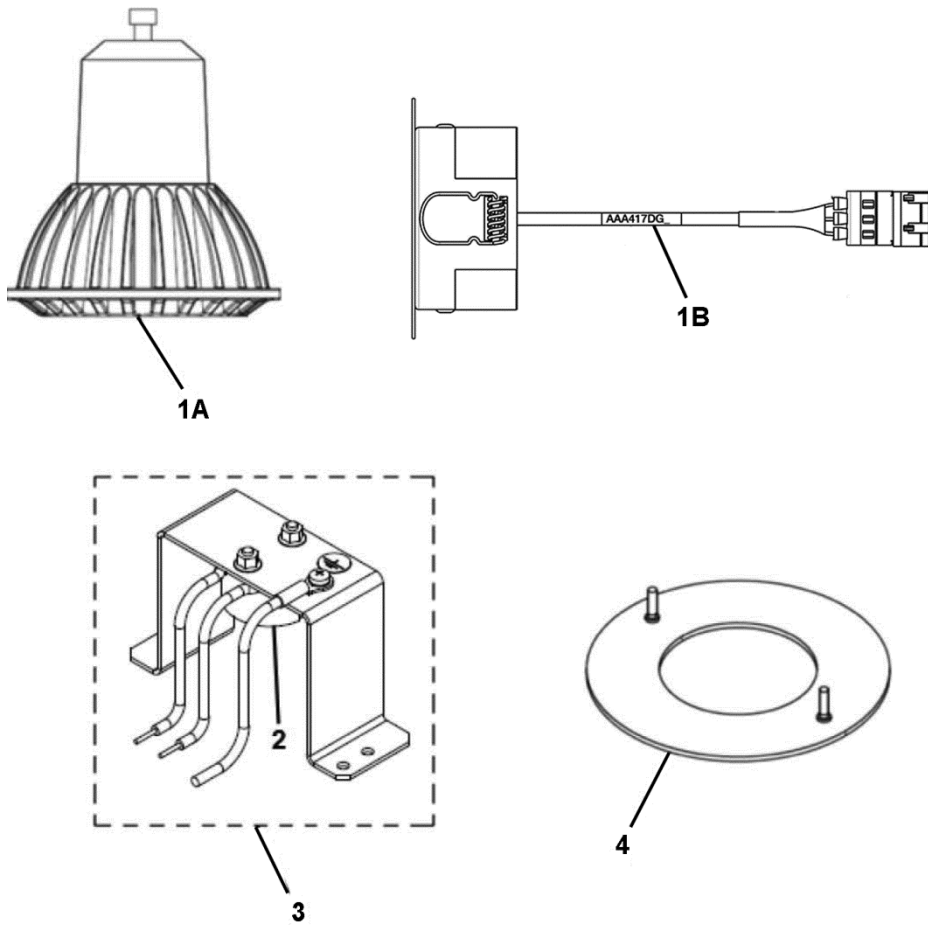

	AAA29507K	AAB29507K	
REF. No.	PART No.		DESCRIPTION
1A	AAA417CX1	---	Bulb, LED
1B	---	AAA417DG1	Bulb, LED, Brushed Nickel Finish, 4W
	---	AAA417DG6	Bulb, LED, Brushed Nickel Finish, 2W
	---	AAA417DG2	Bulb, LED, White Finish, 4W
	---	AAA417DG7	Bulb, LED, White Finish, 2W
	---	AAA417DG3	Bulb, LED, Black Finish, 4W
	---	AAA417DG8	Bulb, LED, Black Finish, 2W
2	AAA618BD5	---	Socket, Light
3	AAA458K2	---	Socket, Light, w/ Frame
4	AAA458H2	---	Trim Ring

Miscellaneous Spare Parts

14-AAA29507K

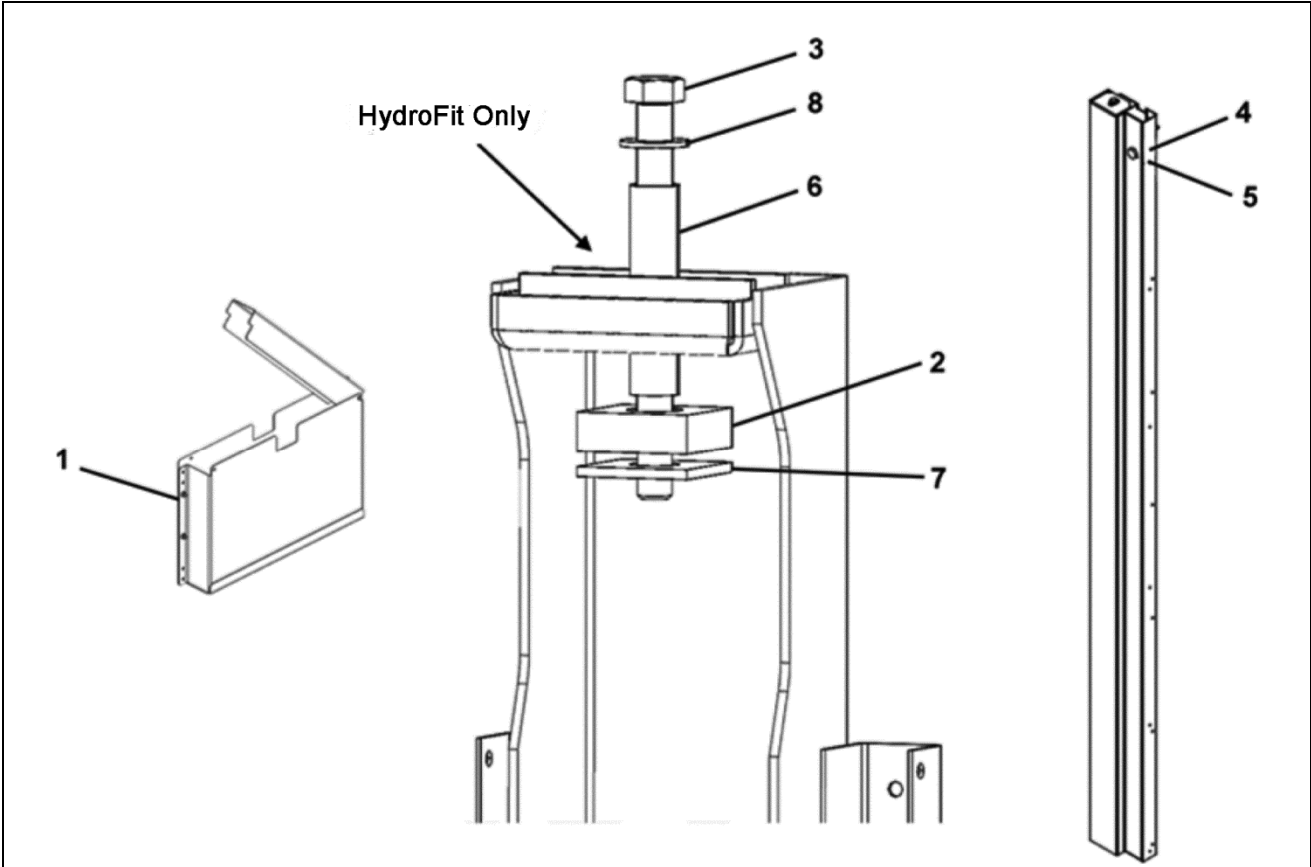

AAA29507K AAB29507K		
REF. No.	PART No.	DESCRIPTION
1	AAA308ABY1	Box, for Wiring Diagram (located on top-of-car handrail)
2	310JJ6	Block, Isolation
3	BTFH 7/8X10ZP	Bolt, Hex Head, 7/8 x 10 in. Long (22.2 x 254 mm), 2-Stage Telescopic
	BTFH 3/4X3-1/2ZP	Bolt, Hex Head, 3/4 x 3-1/2 in. Long (19 x 89 mm), Single-Stage Holeless
4	320CV2	Bumper, Strike
5	ISO1234-2x40Z	Pin, Cotter, 2 mm Dia., 40 mm Long
6	377CH53	Pipe, 1.25 in. (31.8 mm) O.D., 11.8 in. (300 mm) Long, 2-Stage Telescopic
	377CH50	Pipe, 0.75 in. (19 mm) O.D., 2.5 in. (63.5 mm) Long, Single-Stage Holeless
7	127XA69	Washer, Steel
8	WSR SAE7/8ZP	Washer, 7/8 in. (22.2 mm) Flat, 2-Stage Telescopic
	WSR SAE3/4ZP	Washer, 3/4 in. (19 mm) Flat, Single-Stage Holeless