

# TAA20641H Speed Governor CMG

Spare Parts Leaflet

15-TAA20641H

January 2017 / Page 1 of 9

15	TAA20641H
SERIAL	

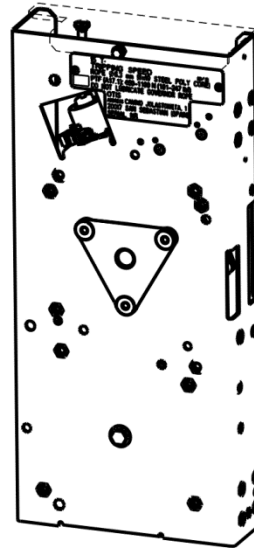
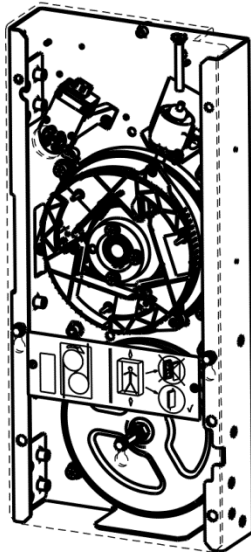

15	TAB20641H
15	TBA20641H
SERIAL	

# OTIS

This document does not contain any technical data subject to EAR or ITAR

OTIS ENGINEERING CENTER

Madrid

Otis Elevator Company

Unpublished Work—© Otis Elevator Co.; 2017

## Leaflet Description

CMG XS for governor required.

### Leaflet Revisions

Date Revised	Subject Matter Expert	Reason for Revision
2013-09-30	J. M. Aguado	New arrangement
2013-10-04	J. M. Aguado	Document correction
2014-01-07	J. M. Aguado	New arrangement
2014-11-14	J. M. Aguado	New arrangement
2017-1-31	J. M. Aguado	Added arrangements 5–8 on p. 3

### Related Drawings

Drawing No.	Title	Drawing No.	Title
TAB20641H	CMG XS Governor		
TBA20641H	CMG XS Governor		

### Related Documents

Document ID	Title
TAB20641H-BD	Basic Data
T__20641H-FCM	Field Component Manual
TBA20641H-BD	Basic Data

### Subject Matter Expert

Name	Department
J. M. Aguado	OEC-M

### About Spare Parts Leaflets...



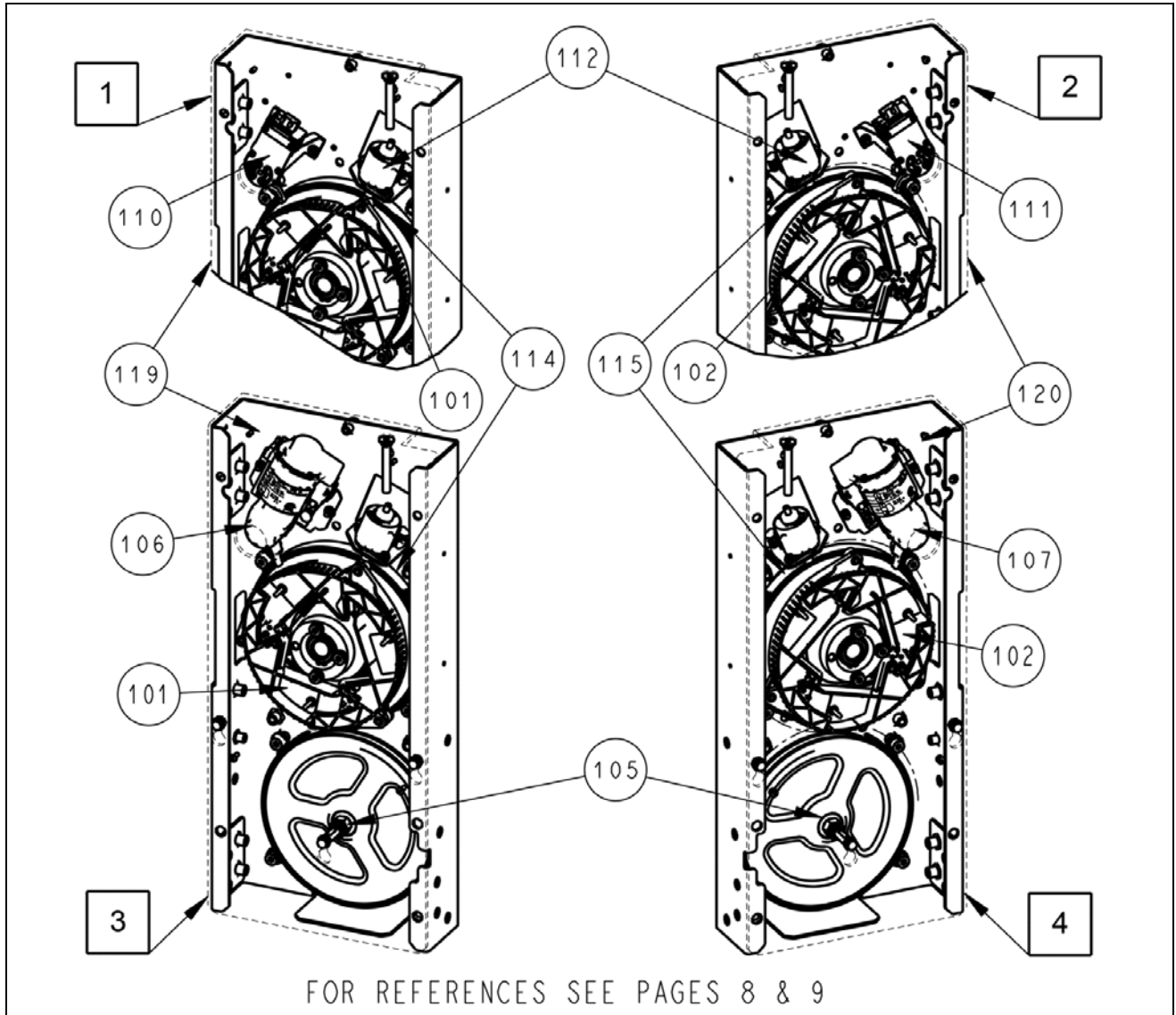

This document lists the lowest replaceable units (LRUs) for the standard version of the product. The LRUs are chosen by a team of Otis associates representing engineering and manufacturing.

While goal of this document is to make parts identification as easy as possible, the document cannot be all-inclusive. Elevator and escalator contracts classified as “special” or “custom” are not addressed here. For such contracts, please refer to specified information, the contract folder, TIPS, Field Education Articles, Construction Letters, etc. for further information.

If you have any suggestions about this document, please contact the subject matter expert listed on this page.

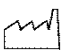





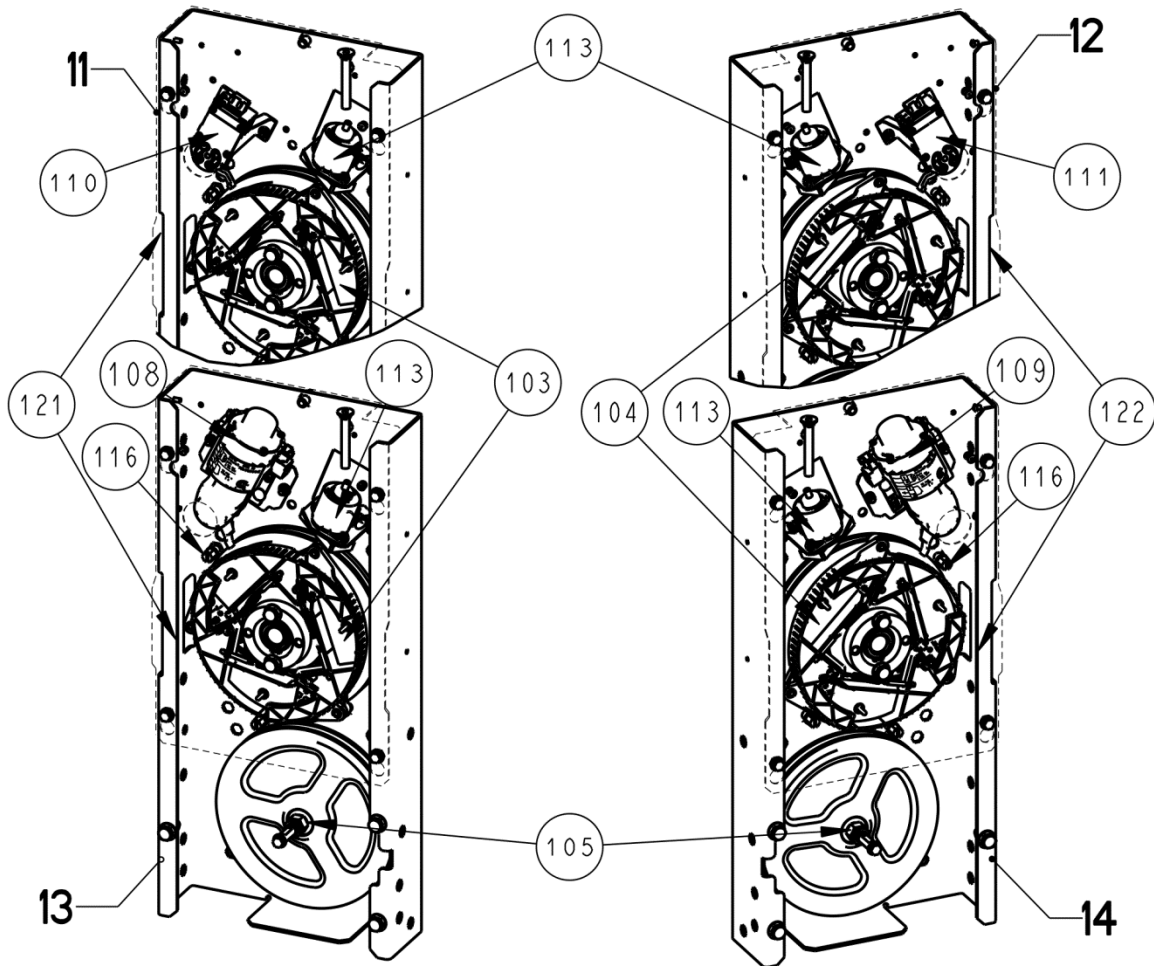



FOR REFERENCES SEE PAGES 8 & 9

REF. No.	VINTAGE		DESCRIPTION			
			NOMINAL SPEED	HAND	RRD	CODE
1	TAA20641H1	TAB20641H1 TBA20641H1 TBA20641H5	1.78 m/s		without	A17
2	TAA20641H2	TAB20641H2 TBA20641H2 TBA20641H6				
3	TAA20641H3	TAB20641H3 TBA20641H3 TBA20641H7			with	
4	TAA20641H4	TAB20641H4 TBA20641H4 TBA20641H8				



FOR OTHER REFERENCES SEE PAGES 8 & 9

REF. No.	VINTAGE	DESCRIPTION			
	PART NO.	NOMINAL SPEED	HAND	RRD	CODE
11	TAB20641H111 TBA20641H111	1.6 m/s		without	EN
12	TAB20641H112 TBA20641H112				
13	TAB20641H113 TBA20641H113			with	
14	TAB20641H114 TBA20641H114				
11	TAB20641H115 TBA20641H115	1.75 m/s		without	
12	TAB20641H116 TBA20641H116				
13	TAB20641H117 TBA20641H117			with	
14	TAB20641H118 TBA20641H118				

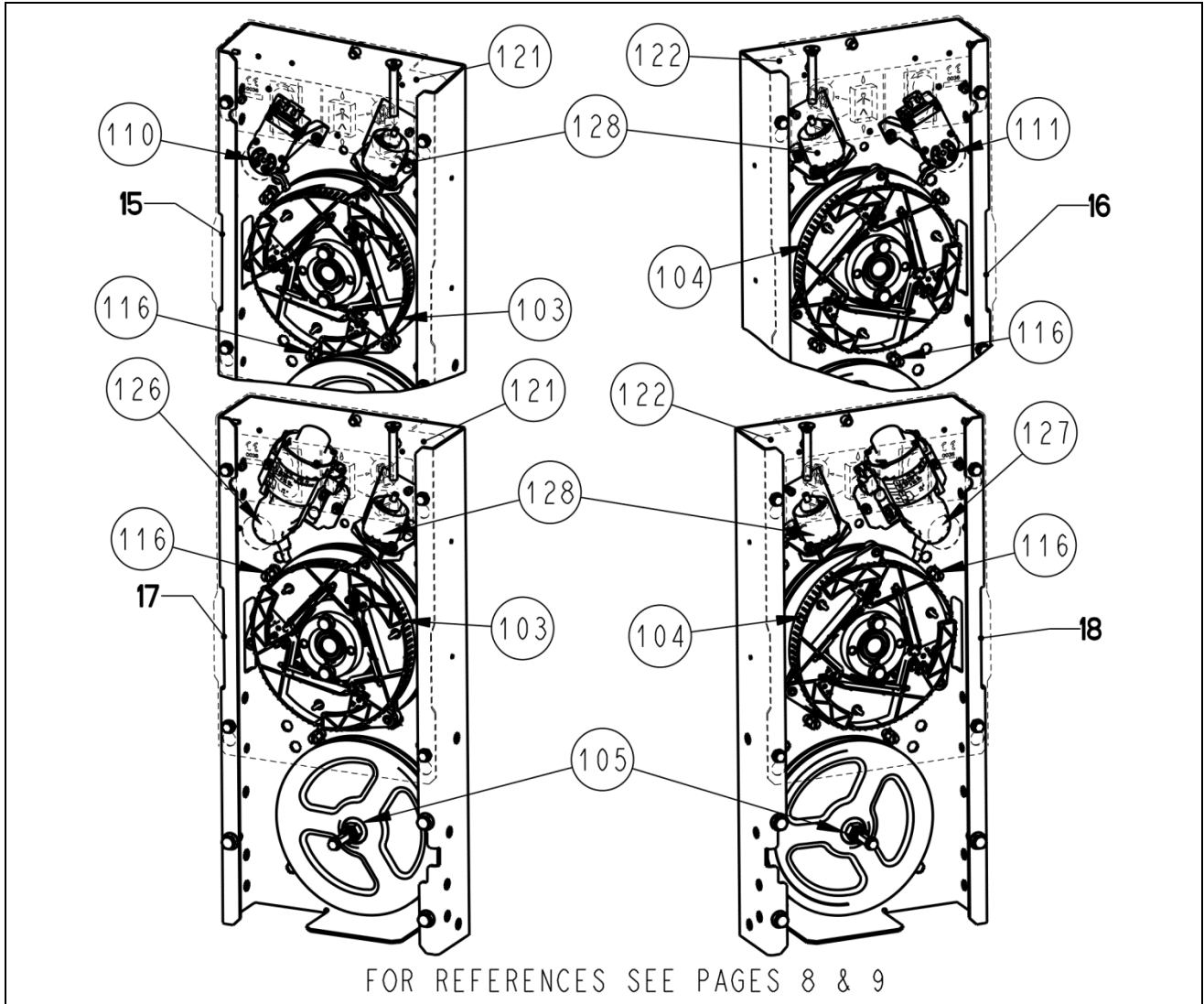

FOR REFERENCES SEE PAGES 8 & 9

REF. No.	VINTAGE	DESCRIPTION			
	PART NO.	NOMINAL SPEED	HAND	RRD	CODE
15	TAB20641H211 TBA20641H211	1.6 m/s		without	EN
16	TAB20641H212 TBA20641H212				
17	TAB20641H213 TBA20641H213			with	
18	TAB20641H214 TBA20641H214				
15	TAB20641H215 TBA20641H215	1.75 m/s		without	
16	TAB20641H216 TBA20641H216				
17	TAB20641H217 TBA20641H217			with	
18	TAB20641H218 TBA20641H218				

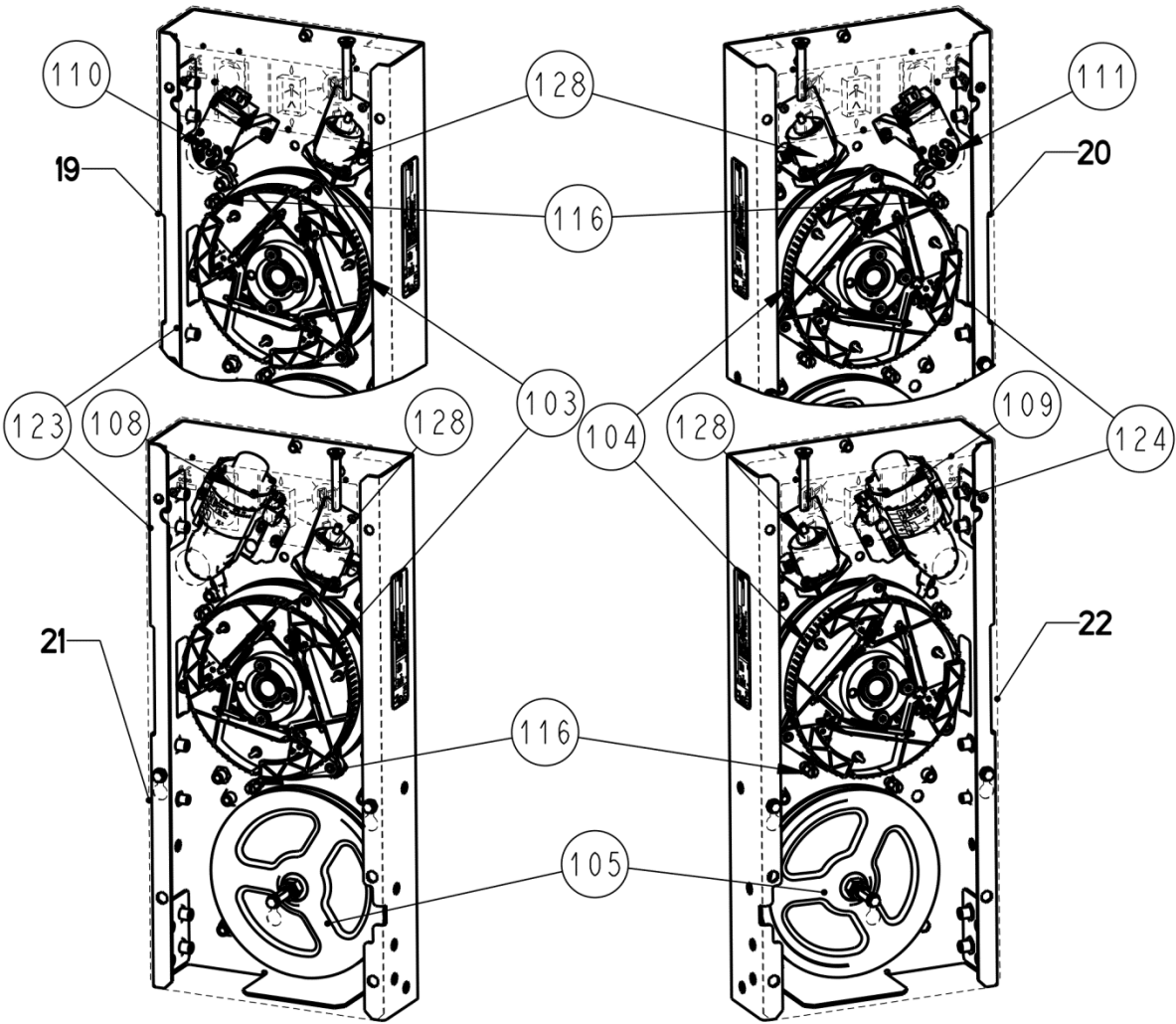

FOR REFERENCES SEE PAGES 8 & 9

REF. No.	VINTAGE	DESCRIPTION			
	PART NO.	NOMINAL SPEED	HAND	RRD	CODE
19	TAB20641H301 TBA20641H301	1.6 m/s	↖	without	EN (GIEN)
20	TAB20641H302 TBA20641H302		↘		
21	TAB20641H303 TBA20641H303		↖	with	
22	TAB20641H304 TBA20641H304		↘		
19	TAB20641H305 TBA20641H305	1.75 m/s	↖	without	
20	TAB20641H306 TBA20641H306		↘		
21	TAB20641H307 TBA20641H307		↖	with	
22	TAB20641H308 TBA20641H308		↘		

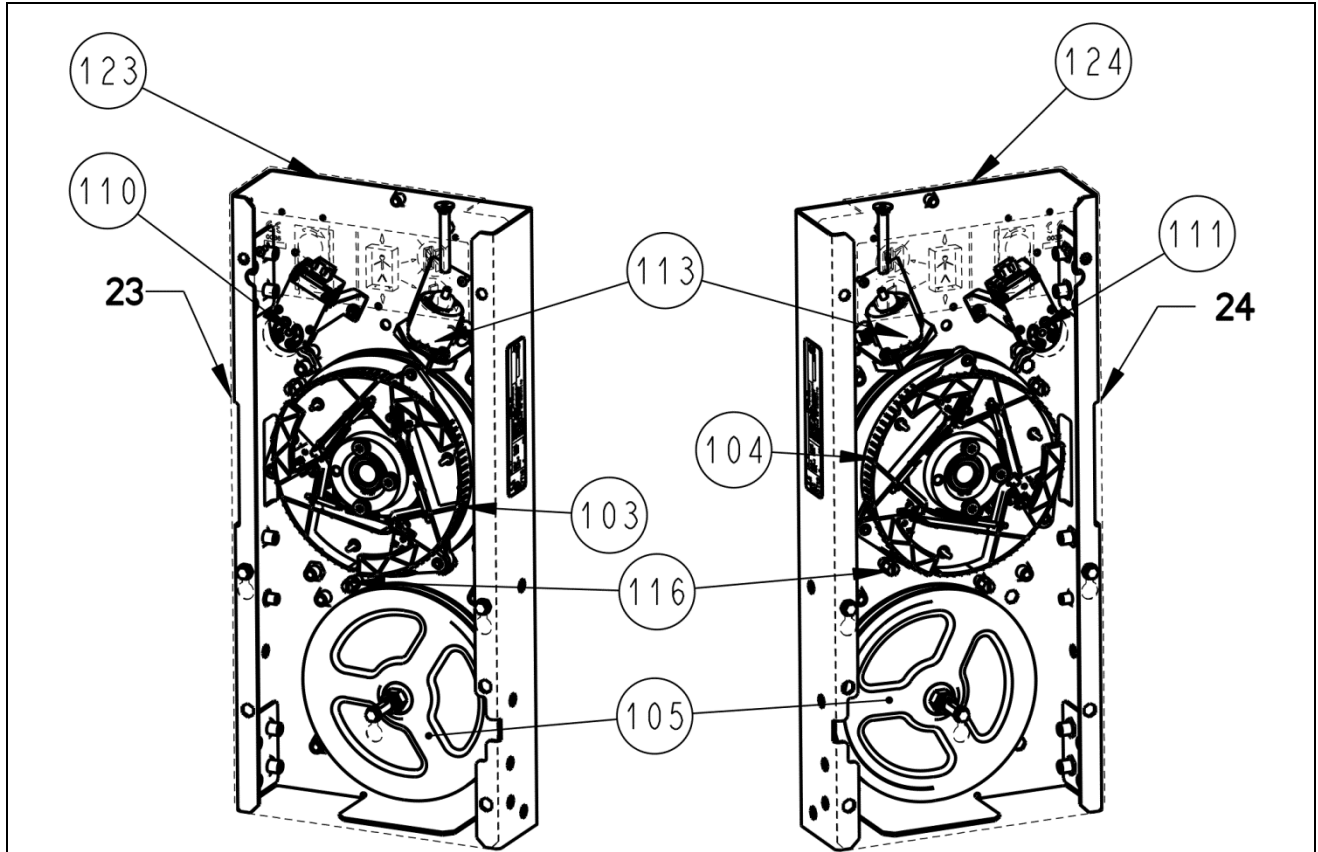

FOR REFERENCES SEE PAGES 8 & 9



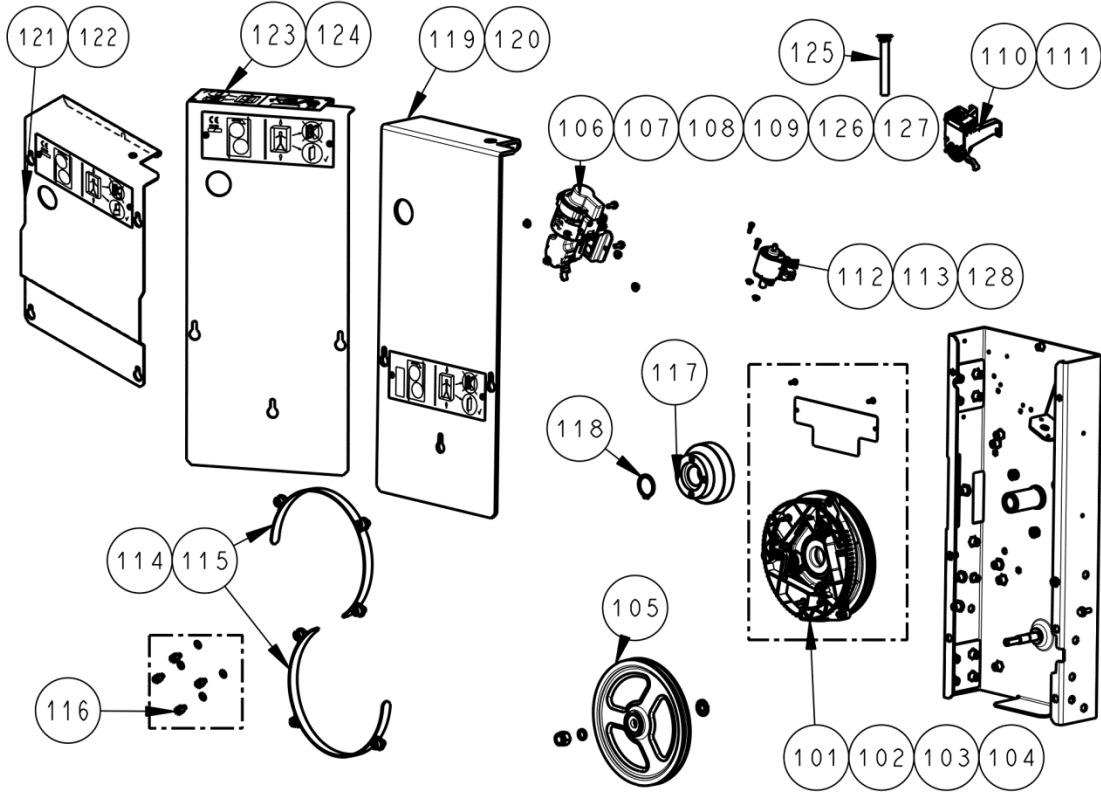















REF. No.	VINTAGE	DESCRIPTION			
	PART NO.	NOMINAL SPEED	HAND	RRD	CODE
23	TAB20641H119 TBA20641H119	1.6 m/s		without	EN (GIEN)
24	TAB20641H120 TBA20641H120				
23	TAB20641H121 TBA20641H121	1.75 m/s			
24	TAB20641H122 TBA20641H122				



OTHER REFERENCES SEE NEXT PAGE

VINTAGE				
REF. No.	PART No.	HAND	DESCRIPTION	USE
101	TAA27076AFE11		Tripping Sheave + Tag	T__20641H1 – H3
102	TAA27076AFE12		Tripping Sheave + Tag	T__20641H2 – H4
103	TAA27076AFE13		Tripping Sheave + Tag	T__20641H111 -113 -115 -117 -211 – 213 –215 -217
	TAA27076AFE15			T__20641H119 -121 -301 -303 -305 -307
	TAA27076AFE17			TBA20641H111 -113 -115 -117 -211 – 213 –215 -217
	TAA27076AFE19			TBA20641H119 -121 -301 -303 -305 -307
104	TAA27076AFE14		Tripping Sheave + Tag	T__20641H112 -114 -116 -118 -212 -214 -216 -218
	TAA27076AFE16			T__20641H120 -122 -302 -304 -306 -308
	TAA27076AFE18			TBA20641H112 -114 -116 -118 -212 -214 -216 -218
	TAA27076AFE20			TBA20641H120 -122 -302 -304 -306 -308
105	<del>TAA27076ZF1</del> TAA27076ZF2 TAA27076ZF3	Both	Idler Sheave + Accessories	All



VINTAGE				
REF. No.	PART No.	HAND	DESCRIPTION	USE
106	TAA27076ADC1		OS Switch + RD 	T__20641H3
107	TAA27076ADC2			T__20641H4
108	TAA27076ADC3			T__20641H113 – H117
109	TAA27076ADC4			T__20641H114 – H118
126	TAA27076ADC5			T__20641H213 –H217 -H303 –H307
127	TAA27076ADC6			T__20641H214 –H218 -H304 –H308
110	TAA27076ZE1		OS Switch+ 	T__20641H1 –H111 –H115 –H119 -H121 –H211 –H215 –H301 –H305
111	TAA27076ZE2			T__20641H2 –H112 –H116 –H120 -H122 –H212 –H216 –H302 –H306
112	<del>TAA27076ZD2</del> TAA27076ZD3	Both	RTD + 	T__20641H1 ÷ H4
113	TAA27076ZD5	Both		T__20641H111 ÷ H122
128	TAA27076ZD6	Both		T__20641H211 ÷ H218 –H301 ÷ H308
114	TAA384QG2		Rope Guard	T__20641H1 –H3
115	TAA384QG1			T__20641H2 –H4
116	TAA27076ADD2	Both	Rope Guard	Only for TBA20641H11 ÷ H122 TBA20641H211 + H218 –H301 ÷ H308
	TAA27076ADD1	Both		T__20641H11 ÷ H122 -H211 + H218 –H301 ÷ H308
117	TAA172AL1	Both	Tripping Ring	All
118		Both	Circlip DIN471 N 30 480HV-B	All
119	TAA27076AHZ3		Cover	T__20641H1 – H3
120	TAA27076AHZ4			T__20641H2 – H4
121	TAA27076AHZ7			T__20641H111 H113 –H211 –H213 T__20641H115 H117 –H215 –H217
				T__20641H112 H114 –H212 –H214 T__20641H116 H118 –H216 –H218
122	TAA27076AHZ8			T__20641H119 –H121 -H301 –H303 –H305 –H307
123	TAA27076AHZ5			T__20641H120 –H122 -H302 –H304 –H306 –H308
124	TAA27076AHZ6			
125	TAA321KJ1	Both	Bushing	All