

NG Car Door  
Hanger/Track System  
C/O, S/S, and 2/S

Spare Parts Leaflet

19-AAA24600H

November 13, 2019 / Page 1 of 12

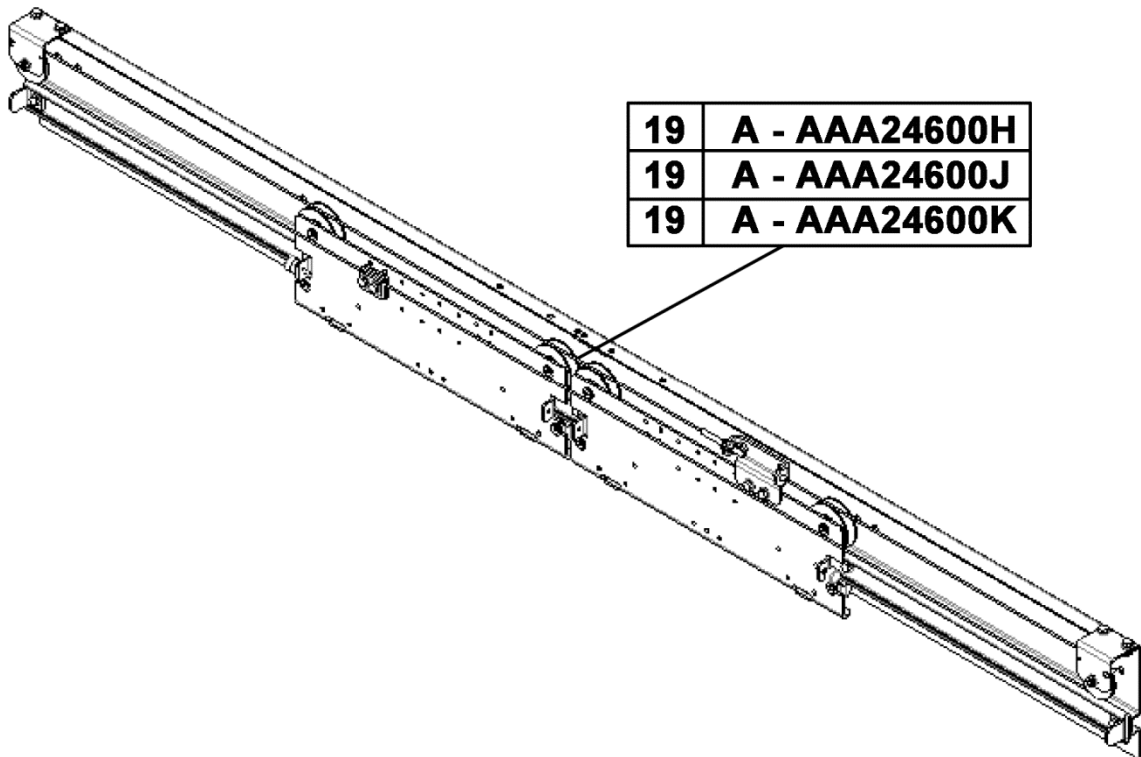

**OTIS**

This document does not contain any  
technical data subject to EAR or ITAR

SERVICE ENGINEERING  
Otis Elevator Company  
Bloomfield, Connecticut USA

Unpublished Work—© Otis Elevator Co.; 2019

## Leaflet Description

This leaflet provides information for the lowest replaceable units for next generation (NG) door systems track and hanger equipment.

### Leaflet Revisions

Date Revised	Subject Matter Expert	Reason for Revision
June 1, 2012	Mike Tracey and Rick Kulak	New SPL
March 19, 2014	Brian Regan	Updated information; New template
June 14, 2017	Brian Regan	Added p/ns AAA65KT2 and FAA198V1 on p. 3
March 27, 2019	Brian Regan	Corrected Ref. 1 on p. 11
November 13, 2019	Peter Kelley	Revised history page

### Related Drawings

Drawing No.	Title	Drawing No.	Title
AAA24450AE	Glide Door Operator System	AAA24520Z	Cab Interface
AAA24350CE	Glide Door Operator	AAA24600H	Header Assembly, C/O
AAA24600J	Header Assembly, S/S	AAA24600K	Header Assembly, 2/S

### Related Documents

Document ID	Title
SPL 23-AAA24350CE	Glide Door Operator System
SPL 24-AAA24390N	Door Coupler

### Subject Matter Expert

Name	Department
Peter Kelley	OSC Service Engineering

### About Spare Parts Leaflets...

This document lists the lowest replaceable units (LRUs) for the standard version of the product. The LRUs are chosen by a team of Otis associates representing engineering and manufacturing.

While goal of this document is to make parts identification as easy as possible, the document cannot be all-inclusive. Elevator and escalator contracts classified as "special" or "custom" are not addressed here. For such contracts, please refer to specified information, the contract folder, TIPs, Field Education Articles, Construction Letters, etc. for further information.

If you have any suggestions about this document, please contact the subject matter expert listed on this page.

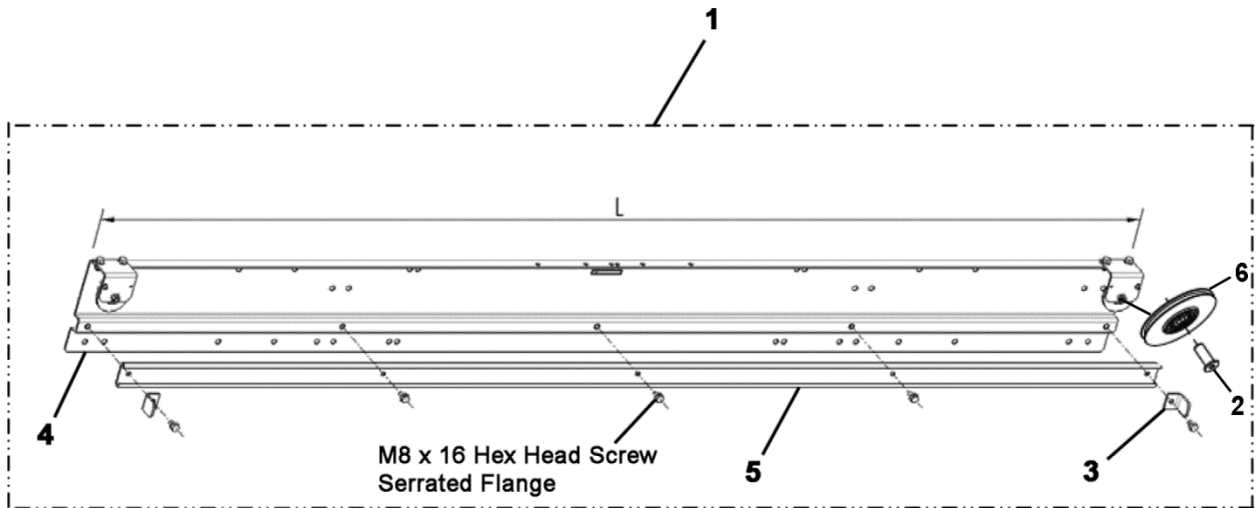



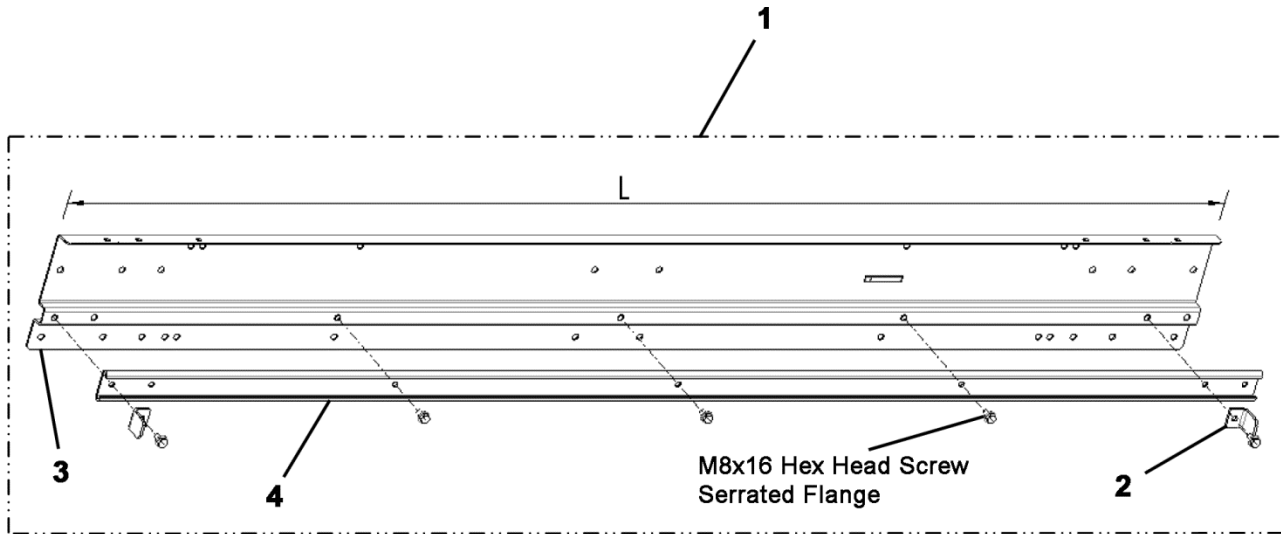

REF. No.	PART No.	DESCRIPTION	OPENING WIDTH (mm / in.)	L (mm / in.)
1	AAA409JK9	Assembly, Header Track	1067 mm / 42 in.	2213 mm / 87.12 in.
	AAA409JK10		1219 mm / 48 in.	2517 mm / 99.09 in.
2	AAA65KT2	Bolt, M8, Low Profile	---	---
3	AAA477GY1	Bracket, Stop	---	---
4	AAA409JN3	Header	1067 mm / 42 in.	---
	AAA409JN4	Header	1219 mm / 48 in.	---
*	AAA255PD402	Kit, Cab Interface Shim and Hardware		
5	AAA483XD28	Track	1067 mm / 42in.	---
	AAA483XD29	Track	1219 mm / 48 in.	---
6	FAA198V1	Pulley	---	---

\* Hardware kit includes all shims and hardware for mounting header track assembly.





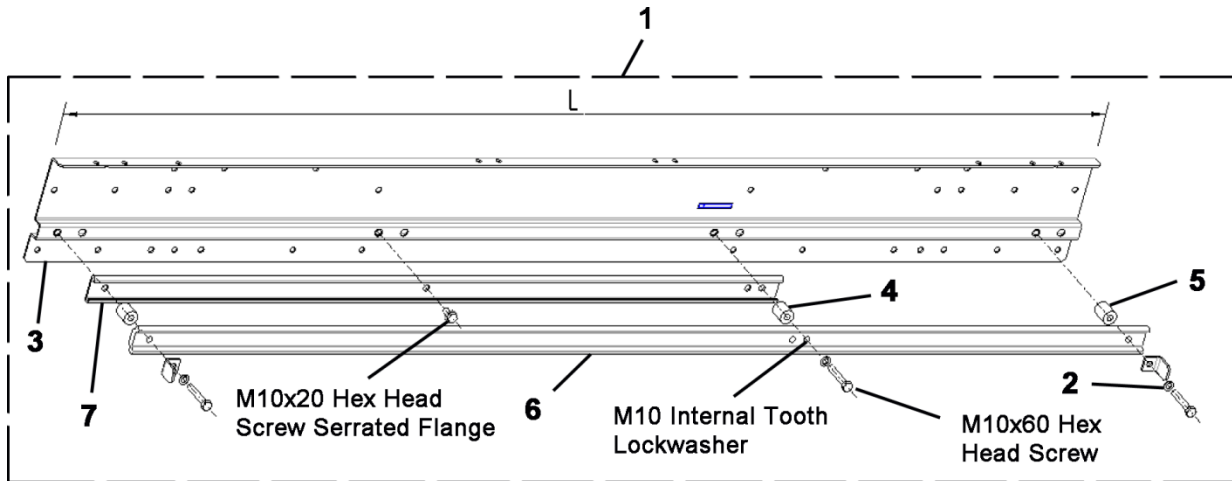

Right Hand Shown

REF. No.	PART No.	DESCRIPTION	OPENING WIDTH (mm / in.)	L (mm / in.)
	AAA24600J			
1	AAA409JL13	Assembly, Header Track 	914 mm / 36 in.	1978 mm / 77.88 in.
	AAA409JL14	Assembly, Header Track 		
	AAA409JL15	Assembly, Header Track 	1067 mm / 42 in.	
	AAA409JL16	Assembly, Header Track 		
2	AAA477GY1	Bracket, Stop	---	---
3	AAA409JH3	Header	914 mm / 36 in.	---
	AAA409JH4	Header	1067 mm / 42 in.	---
*	AAA255PD401	Kit, Cab Interface Shim and Hardware	--	--
4	AAA483XD30	Track	914 mm / 36 in.	---
	AAA483XD31	Track	1067 mm / 42 in.	---

\* Hardware kit includes all shims and hardware for mounting header track assembly.



Right Hand Shown

REF. No.	PART No.	DESCRIPTION	OPENING WIDTH (mm / in.)	L (mm / in.)
	AAA24600K			
1	AAA409JM5	Assembly, Header Track 	1219 mm / 48 in.	1988 mm / 78.27 in.
	AAA409JM6	Assembly, Header Track 		
	AAA409JM7	Assembly, Header Track 	1372 mm / 54 in.	2218 mm / 87.32 in.
	AAA409JM8	Assembly, Header Track 		
2	AAA477GY2	Bracket, Stop	---	---
3	AAA409JJ3	Header	1219 mm / 48 in.	---
	AAA409JJ4	Header	1372 mm / 54 in.	---
*	AAA255PD401	Kit, Cab Interface Shim and Hardware	---	---
4	AAA462BK6	Spacer	---	---
5	AAA462BK7	Spacer	---	---
6	AAA483XE8	Track, Fast	1219 mm / 48 in.	---
	AAA483XE9	Track, Fast	1372 mm / 54 in.	---
7	AAA483XD21	Track, Slow	1219 mm / 48 in.	---
	AAA483XD22	Track, Slow	1372 mm / 54 in.	---

\* Hardware kit includes all shims and hardware for mounting header track assembly.

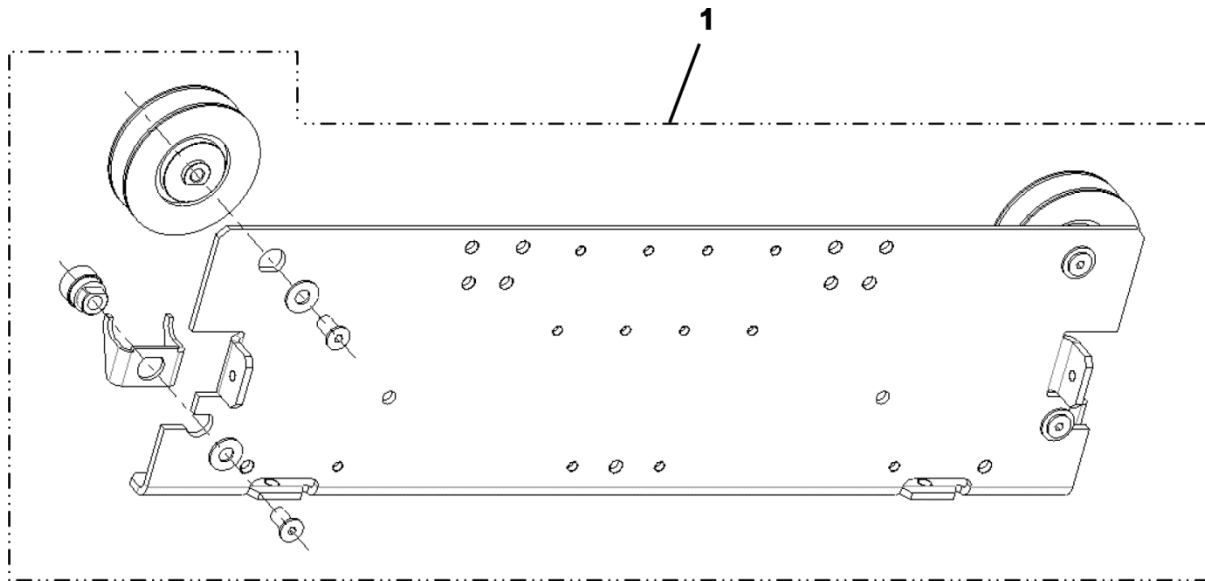

**Hanger Assembly  
Non-Contacting Upthrust  
Roller Diameter = 18 mm / 0.7 in.**

	AAA24600H AAA24600J AAA24600K			
REF. No.	PART No.	DOOR TYPE	DOOR	OPENING WIDTH (mm / in.)
1	AAA389CZ1	C/O	Otis	1067 mm / 42 in.
	AAA389CZ2			1219 mm / 48 in.
	AAA389CZ3	2/S	Otis Fast Door	1219 mm / 48 in.
	AAA389CZ4			1372 mm / 54 in.
	AAA389CZ5	C/O	Vendor	1067 mm / 42 in.
	AAA389CZ6			1219 mm / 48 in.
	AAA389CZ7	2/S	Vendor Fast Door	1219 mm / 48 in.
	AAA389CZ8			1372 mm / 54 in.
	AAA389CZ9	S/S	Otis	914 mm / 36 in.
	AAA389CZ10			1067 mm / 42 in.
	AAA389CZ11		Vendor	914 mm / 36 in.
	AAA389CZ12			1067 mm / 42 in.
	AAA389CZ13	2/S	Otis Slow Door	1219 mm / 48 in.
	AAA389CZ14			1372 mm / 54 in.
	AAA389CZ15		Vendor Slow Door	1219 mm / 48 in.
	AAA389CZ16			1372 mm / 54 in.

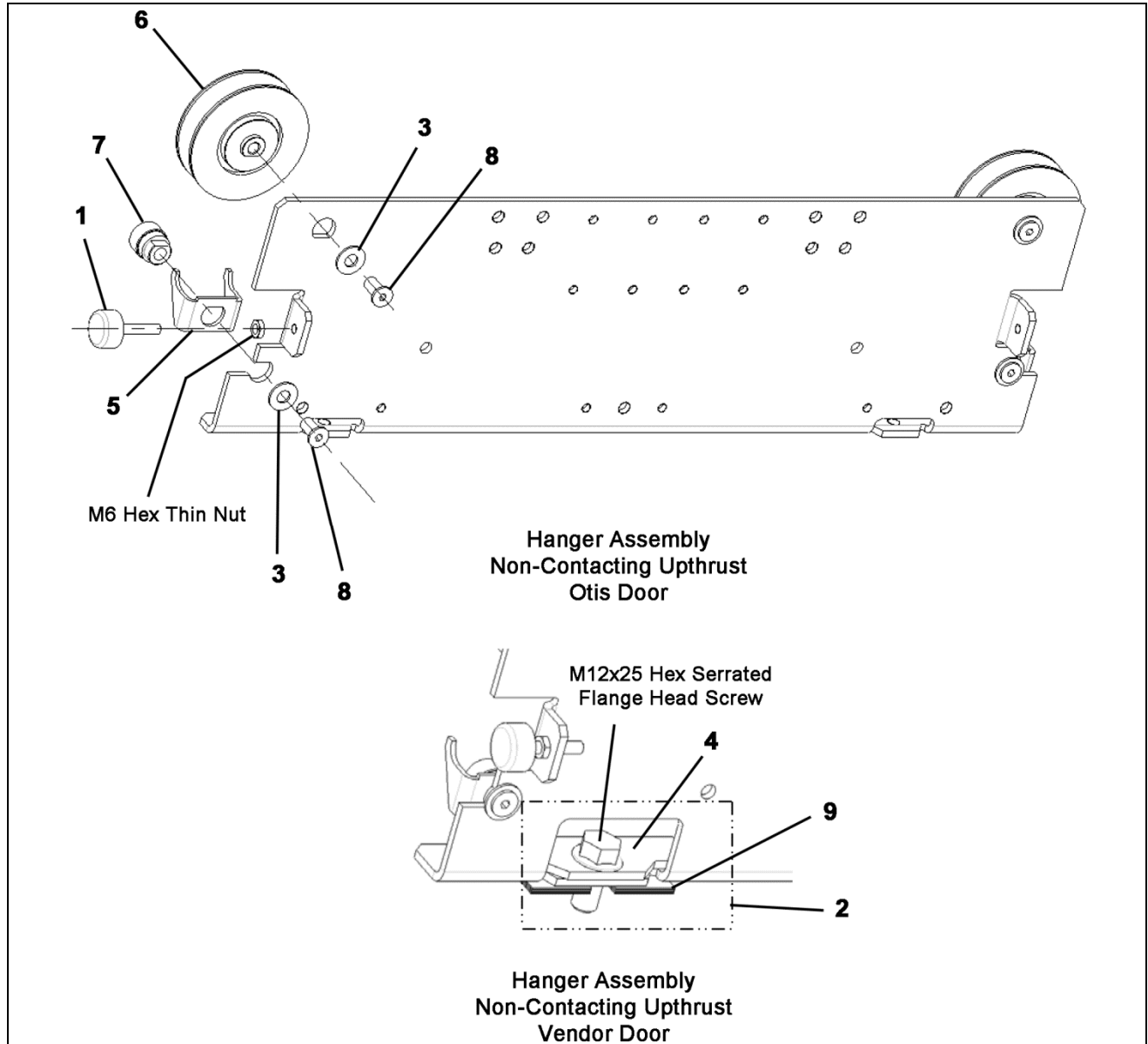

	AAA24600H AAA24600J AAA24600K	
REF. No.	PART No.	DESCRIPTION
1	AAA320EG1	Bumper
2	AAA389CZ400	Kit, Vendor Field Sundries. Includes: (24) Shims, (2) Plates, (2) M12 X 25 Hex Serrated Flange Head Screws
3	AAA130BP3	Lockwasher, M8 Special
4	AAA386MTP1	Plate
5	AAA316HEB1	Retainer
6	AAA456ZB1	Roller
7	AAA456YZ1	Roller, Upthrust, Diameter = 18 mm / 0.7 in.
8	AAA65KT1	Screw, Head, M8x16 Special Flat
9	AAA255MY2	Shim

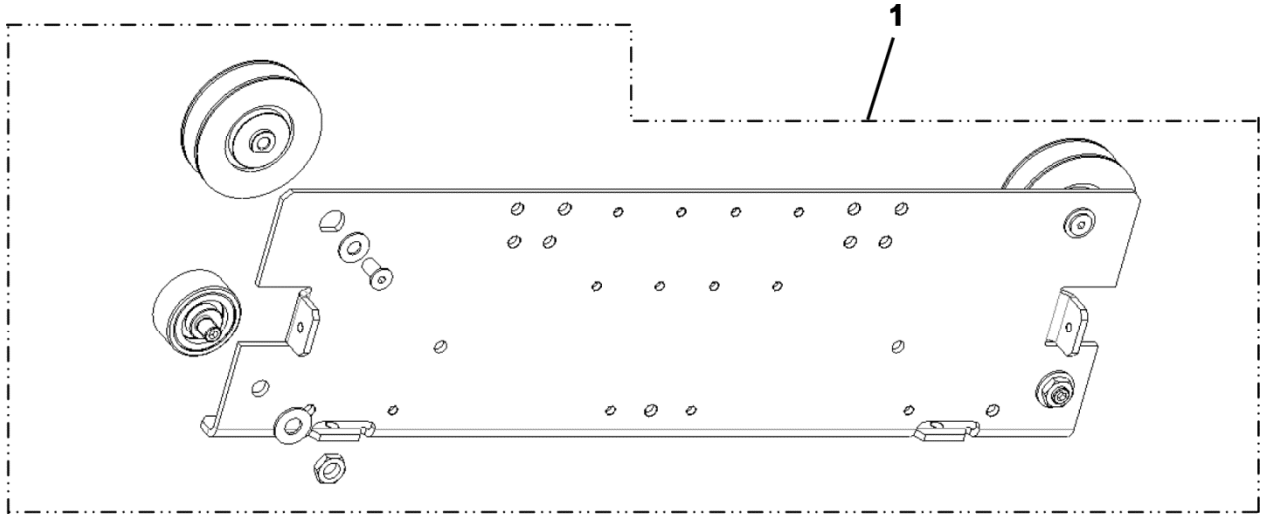

**Hanger Assembly  
Contacting Upthrust  
Roller Diameter = 45 mm / 1.8 in.**

AAA24600H  
AAA24600J  
AAA24600K

REF. No.	PART No.	DOOR TYPE	DOOR	OPENING WIDTH (mm / in.)
1	AAA389CY1	C/O	Otis	1067 mm / 42 in.
	AAA389CY2			1219 mm / 48 in.
	AAA389CY3	2/S	Otis Fast Door	1219 mm / 48 in.
	AAA389CY4			1372 mm / 54 in.
	AAA389CY5	C/O	Vendor	1067 mm / 42 in.
	AAA389CY6			1219 mm / 48 in.
	AAA389CY7	2/S	Vendor Fast Door	1219 mm / 48 in.
	AAA389CY8			1372 mm / 54 in.
	AAA389CY9	2/S	Otis Slow Door	1219 mm / 48 in.
	AAA389CY10			1372 mm / 54 in.
	AAA389CY11		Vendor Slow Door	1219 mm / 48 in.
	AAA389CY12			1372 mm / 54 in.



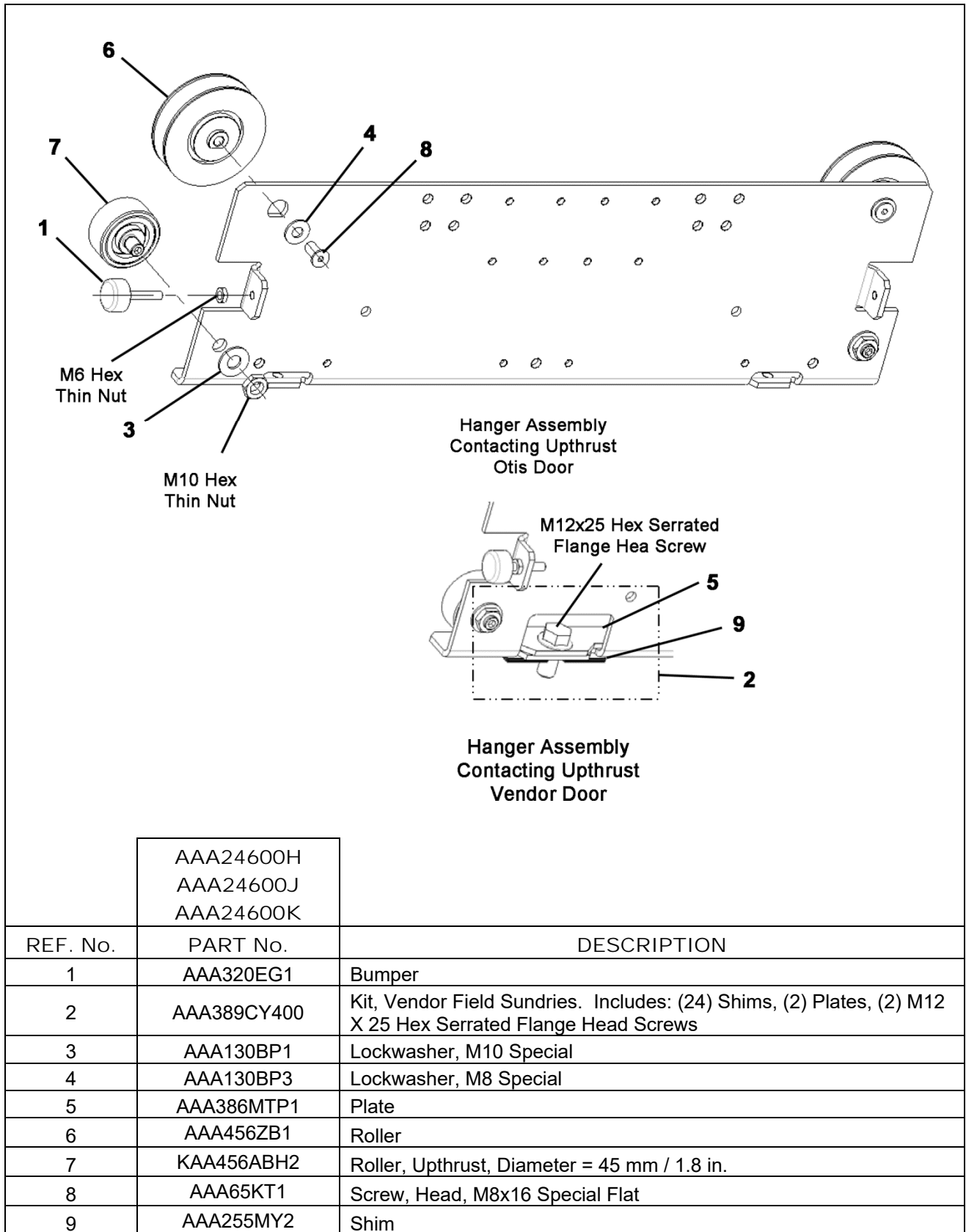

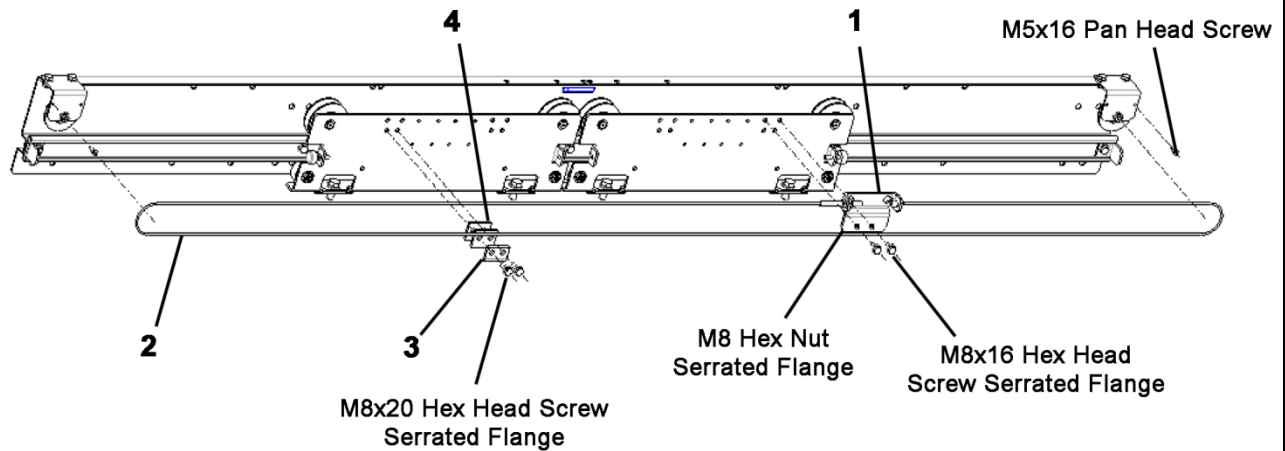



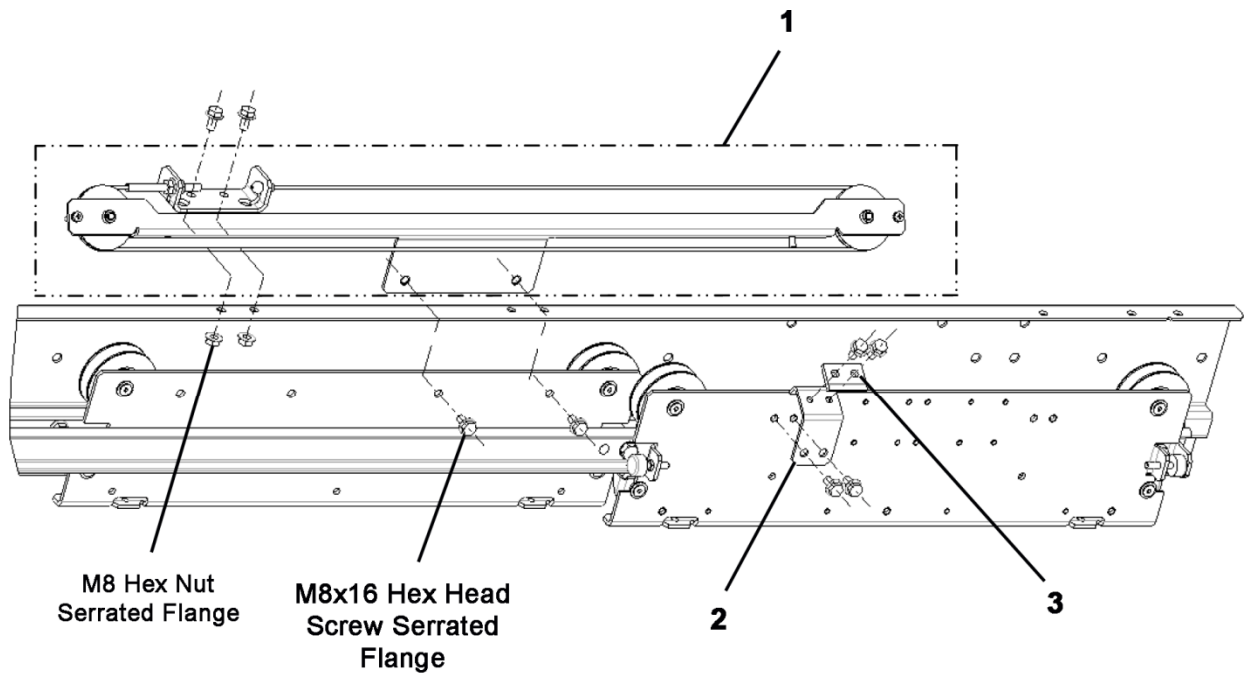

REF. No.	PART No.	DESCRIPTION	OPENNING WIDTH (mm / in.)
	AAA24600H		
1	AAA316HWC1	Bracket, Termination	---
2	AAA712AD10	Cable, Aircord	1067 mm / 42 in.
	AAA712AD12	Cable, Aircord	1219 mm / 48 in.
3	AAA336NJ1	Clamp	---
4	AAA386MMB1	Plate	---



Right Hand Shown

REF. No.	PART No.	DESCRIPTION	OPENING WIDTH (mm / in.)	HAND
	AAA24600K			
1	AAA24660L1	Assembly, Relator, Two-Speed	1219 mm / 48 in.	
	AAA24660L2	Assembly, Relator, Two-Speed		
	AAA24660L3	Assembly, Relator, Two-Speed	1372 mm / 54 in.	
	AAA24660L4	Assembly, Relator, Two-Speed		
2	AAA316HWP1	Bracket, Termination	---	---
3	AAA336NJ1	Clamp	---	---

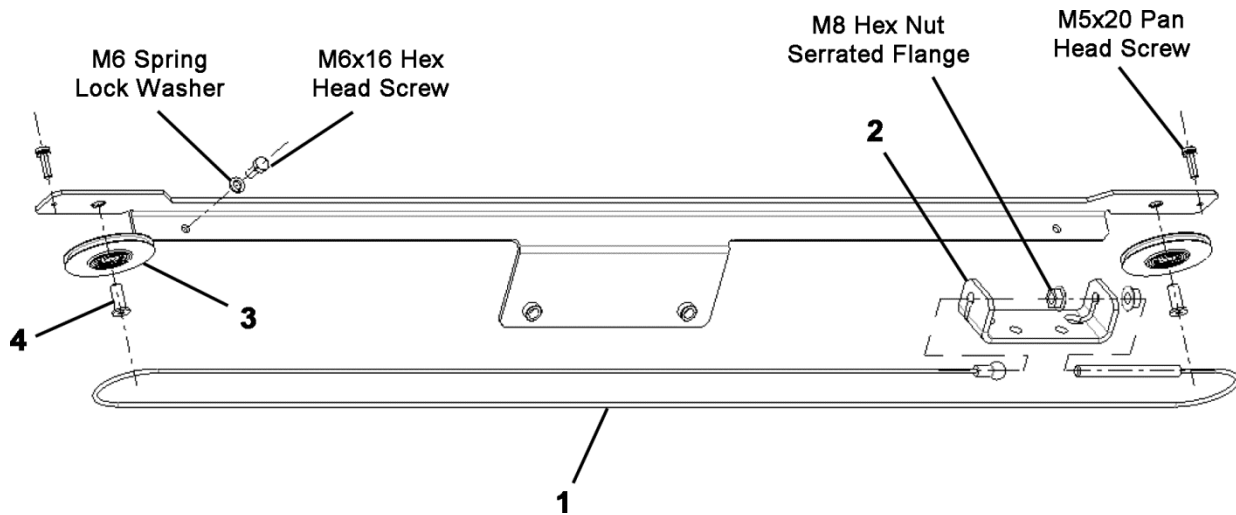

REF. No.	PART No.	DESCRIPTION	OPENING WIDTH (mm / in.)
1	AAA712AD6	Assembly, Cable	1219 mm / 48 in.
	AAA712AD8	Assembly, Cable	1372 mm / 54 in.
2	AAA316HWN1	Bracket, Termination	---
3	FAA198V1	Pulley	---
4	AAA65KT2	Screw, Head, M8x20 Low Socket	---