

**Door Operator, AT400
Engine Unit**

**Spare Parts Leaflet
23-AAA24350BK**

September 18, 2024 / Page 1 of 11

OBSOLESCENCE NOTICE

The product listed in this SPL is obsolete. Some components may still be available, but Otis recommends an upgrade (see TIP 32.2-1 for potential upgrade).

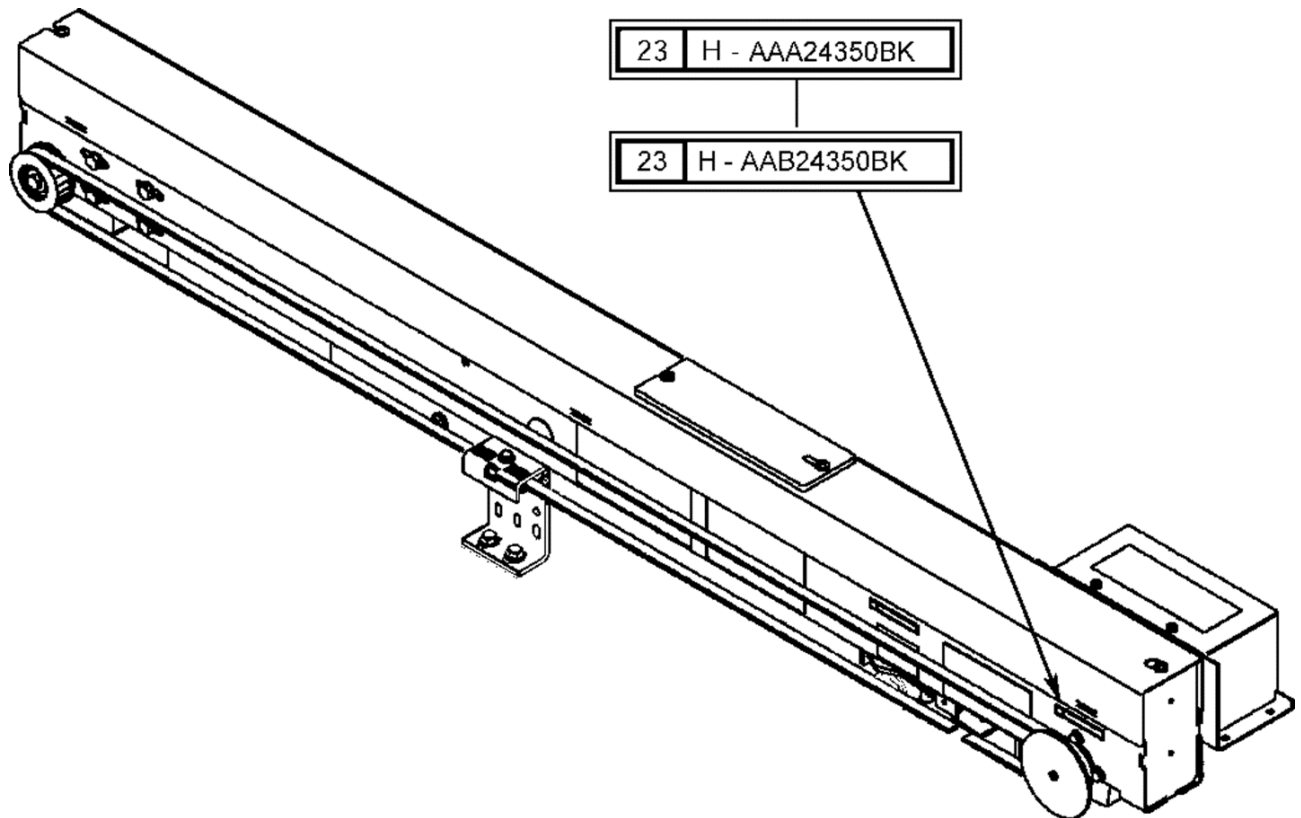

OTIS

This document does not contain any technical data subject to EAR or ITAR

**SERVICE ENGINEERING
Otis Elevator Company
Bloomfield, Connecticut USA**

Unpublished Work—© Otis Elevator Co.; 2024

Leaflet Description

This leaflet provides spare parts information for the AT400 door operator. Only the lowest replaceable units (LRU) for the engine unit/controller are covered here. LRU part numbers for center-open, single-slide, and two-speed linkage apparatus are defined in separate SPLs.

Leaflet Revisions

Date Revised	Subject Matter Expert	Reason for Revision
April 5, 2002	Pankaj Kothari	New SPL
October 28, 2003	Jeffrey A. Smith	Added new gate switch and update part numbers pages: 4–6.
September 21, 2006	Diem Tran	Inserted new page 4 w/AT400 operator engine unit p/ns; Updated kit contents descriptions in ref. 2 and 3 on p.6.
January 7, 2008	Diem Tran	Added Motor Assembly page.
July 8, 2008	Brian Regan	Added AAA24350BW vintage information.
December 22, 2010	Sohaib Shaikh	Added AAA816AJ1 on page 12.
May 30, 2013	Brian Regan	Removed AAA24350BW and made separate SPL
March 5, 2014	Brian Regan	Removed Vintage AAA24350BW
September 13, 2017	Brian Regan	Updated table format on pp. 5–6 to clarify parts ordering; Added clamp bolt and cover parts on p. 7
November 20, 2019	Peter Kelley	Revised history page
September 18, 2024	Juan Murillo	Added Obsolescence Notice.

Related Drawings

Drawing No.	Title	Drawing No.	Title
AAA24350BK	AT400 Door Operator Assembly	AAA24460G	Arrangement, AT400 Door Operator, Two Speed Doors, 914.4 to 1371.6 Openings
AAB24350BK	AT400 Door Operator Assembly	AAA24460M	Arrangement, AT400 Door Operator, Two Speed Doors
AAA24450T	Arrangement, AT400 Door Operator, Single Slide Doors, 914.4 to 1066.8 Openings	AAA24470R	Arrangement, AT400 Door Operator Center Opening Doors, 914.4 to 1219.2 Openings
AAA24470X	Arrangement, AT400 Door Operator, Center Opening Doors	AAA24450AA	Arrangement, AT400 Door Operator, Single Slide Doors

Related Documents	
Document ID	Title
SPL 23-AAA24470R	AT400 (new equipment) Center-Opening Door Operator
SPL 23-AAA24470S	AT400 (modernization) Center-Opening Door Operator
SPL 23-AAA24470X	Door Operator AT400, S/S, C/O, 2/S, NG Door System
TIP 22.16-2	Driver and Idler Pulley Replacement Kits
TIP 22.16-5	Software Upgrade for AT400 (OMMS task 12V1S)
CI 16-07-029	AT400 Door Operator Software Update
Subject Matter Expert	
Name	Department
Peter Kelley	OSC Service Engineering

About Spare Parts Leaflets...

This document lists the lowest replaceable units (LRUs) for the standard version of the product. The LRUs are chosen by a team of Otis associates representing engineering and manufacturing.

While goal of this document is to make parts identification as easy as possible, the document cannot be all-inclusive. Elevator and escalator contracts classified as “special” or “custom” are not addressed here. For such contracts, please refer to specified information, the contract folder, TIPs, Field Education Articles, Construction Letters, etc. for further information.

If you have any suggestions about this document, please contact the subject matter expert listed on this page.

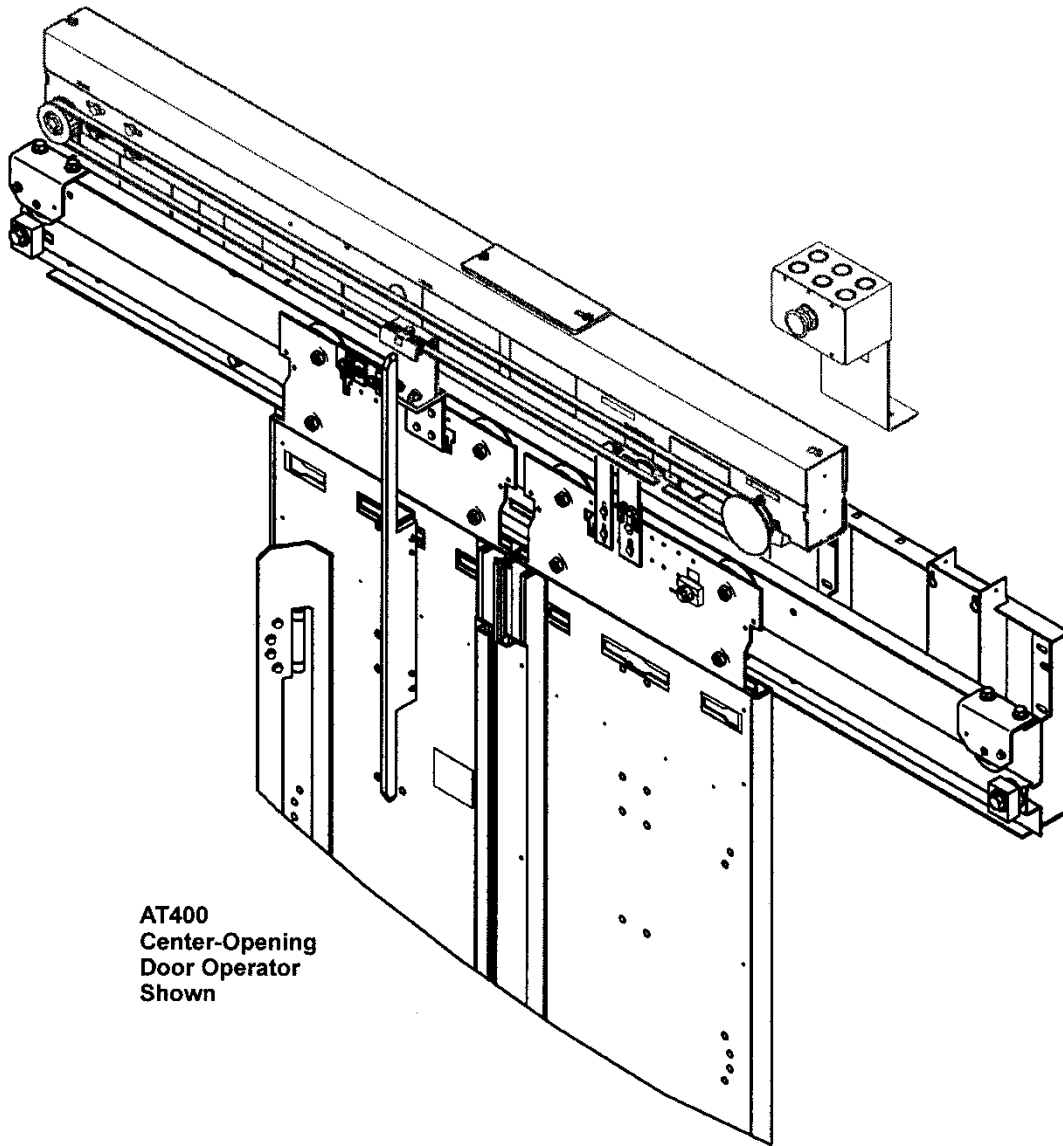

**AT400
Center-Opening
Door Operator
Shown**

Door Operator Linkage SPLs

Linkage Assembly, AT400 Door Operator Center-Opening Doors

Linkage Assembly, AT400 Door Operator Single-Slide Door

Linkage Assembly, AT400 Door Operator Two-Speed Doors



SPL 23-AAA24470R

AT400 Operator

23-AAA24350BK

Type AAB24350BK Engine Unit

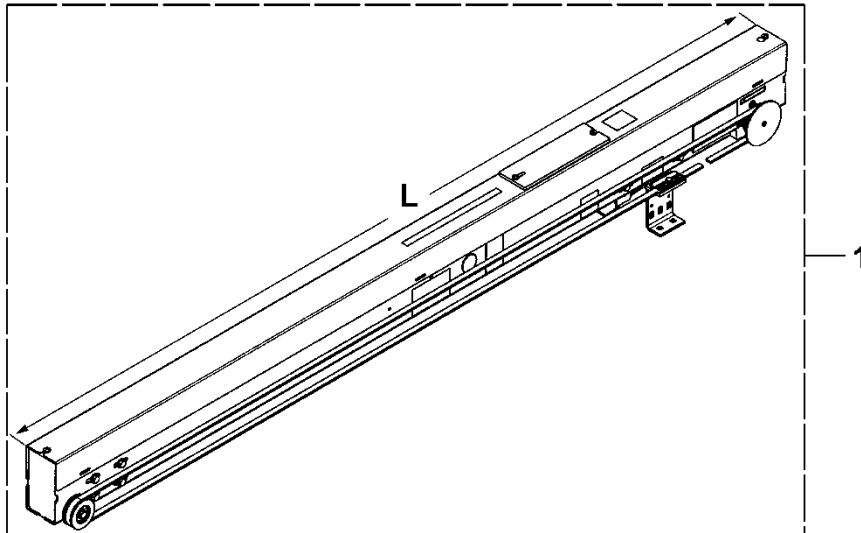

REF. No.	APPLICATION	AAA24350BK AAB24350BK		OPENING WIDTH			
		PART No.	OPERATOR LENGTH	DOOR HAND	DOOR TYPE	MIN	MAX
1	Otis Serial Link (Multidrop) Controller Communication such as Elevonic® R, Gen2®, 411, 335, GCSM, RSVF, RSDC, and GEM Systems	AAB24350BK5 ACA24350BW56	76.4 in. (1940 mm)	Hand	2SP & 1SP Side Slide	48	60
					C/O – aircord related	49	60
					C/O – belt related	42	53
		AAB24350BK10 ACA24350BW57	76.4 in. (1940 mm)	Hand	2SP & 1SP Side Slide	48	60
					C/O – aircord related	49	60
					C/O – belt related	42	53
		AAB24350BK34 ACA24350BW58	64.4 in. (1635 mm)	Hand	2SP & 1SP Side Slide	42	47
					C/O – aircord related	41	48
					C/O – belt related	-	41
		AAB24350BK20 ACA24350BW59	64.4 in. (1635 mm)	Hand	2SP & 1SP Side Slide	42	47
					C/O – aircord related	41	48
					C/O – belt related	-	41
		AAB24350BK38 AAB24350BK44 ACA24350BW60	59.4 in. (1509 mm)	Hand	2SP & 1SP Side Slide	33	41
					C/O – aircord related	33	40
AAB24350BK39 ACA24350BW61	59.4 in. (1509 mm)	Hand	2SP & 1SP Side Slide	33	41		
			C/O – aircord related	33	40		
AAB24350BK41 ACA24350BW62	52.9 in. (1343 mm)	Hand	2SP & 1SP Side Slide	-	32		
			C/O – aircord related	-	32		
AAB24350BK43 ACA24350BW63	52.9 in. (1343 mm)	Hand	2SP & 1SP Side Slide	-	32		
			C/O – aircord related	-	32		

* For replacing anything other than the existing AT400 engine units, see TIP 22.16-1, 7300AC, A7777 (PWM), 7777 Resistance Control to AT400 Door Operator Retrofit Kit with Existing Otis Controller.

(Continued on next page)

AT400 Operator

Type AAB24350BK Engine Unit

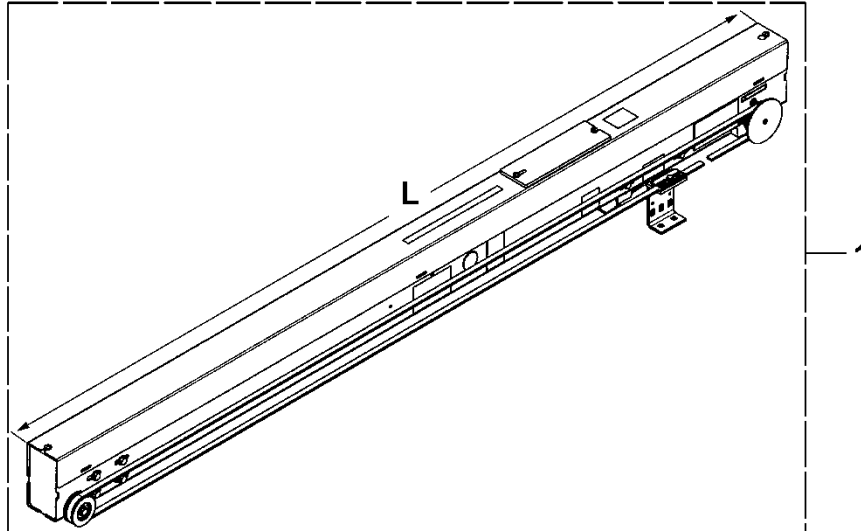

		AAA24350BK AAB24350BK	OPENING WIDTH				
REF. No.	APPLICATION	PART No.	OPERATOR LENGTH	DOOR HAND	DOOR TYPE	MIN	MAX
1	Discrete Controller Communication such as 211, LRVF, Hydro Accel, Relay Logic, and non- Otis Systems	AAB24350BK45 ACA24350BW45	76.4 in. (1940 mm)		2SP & 1SP Side Slide	48	60
					C/O – aircord related	49	60
					C/O – belt related	42	53
		AAB24350BK46 ACA24350BW46	76.4 in. (1940 mm)		2SP & 1SP Side Slide	48	60
					C/O – aircord related	49	60
					C/O – belt related	42	53
		AAB24350BK47 ACA24350BW47	64.4 in. (1635 mm)		2SP & 1SP Side Slide	42	47
					C/O – aircord related	41	48
					C/O – belt related	-	41
		AAB24350BK48 ACA24350BW48	64.4 in. (1635 mm)		2SP & 1SP Side Slide	42	47
					C/O – aircord related	41	48
					C/O – belt related	-	41
AAB24350BK49 ACA24350BW49	59.4 in. (1509 mm)		2SP & 1SP Side Slide	33	41		
			C/O – aircord related	33	40		
AAB24350BK50 ACA24350BW50	59.4 in. (1509 mm)		2SP & 1SP Side Slide	33	41		
			C/O – aircord related	33	40		
AAB24350BK51 ACA24350BW51	52.9 in. (1343 mm)		2SP & 1SP Side Slide	-	32		
			C/O – aircord related	-	32		
AAB24350BK52 ACA24350BW52	52.9 in. (1343 mm)		2SP & 1SP Side Slide	-	32		
			C/O – aircord related	-	32		

* For replacing anything other than the existing AT400 engine units, see TIP 22.16-1, 7300AC, A7777 (PWM), 7777 Resistance Control to AT400 Door Operator Retrofit Kit with Existing Otis Controller.

Operator Engine Components

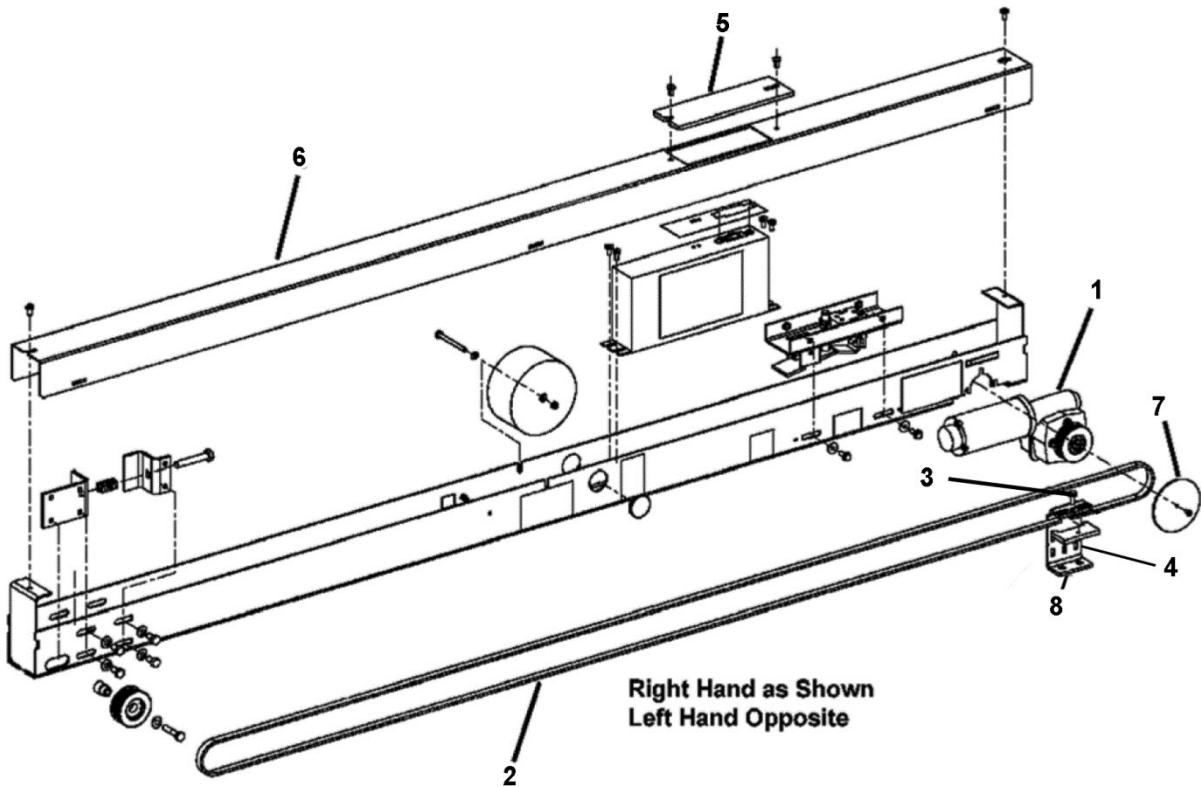

23-AAA24350BK

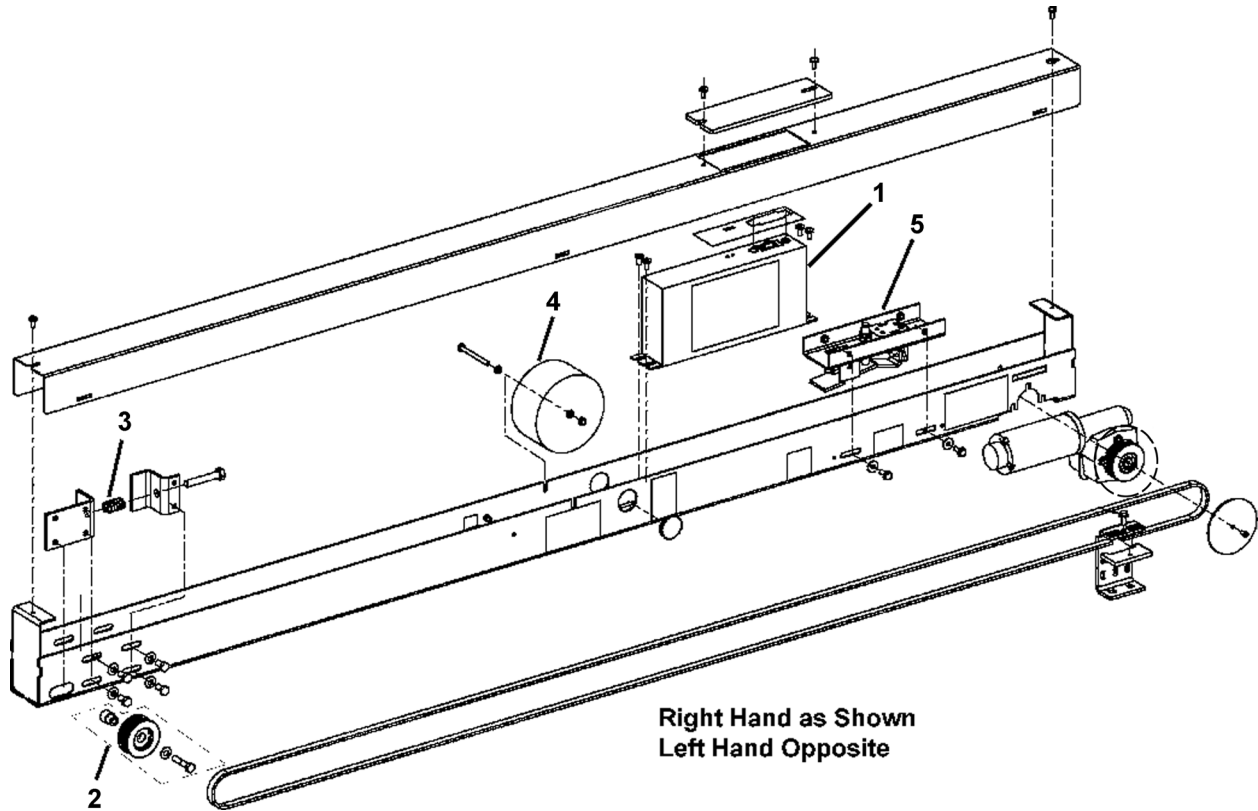

REF. No.	PART No.	DESCRIPTION
1	---	Assembly, Gear Motor, See Page 13
2	AAA717T2	Belt, Relating, w/Two-Speed (48 in. & 54 in. or 1219 mm & 1372 mm), Single-Slide (54 in. or 1372 mm), C/O (60 in. or 1524 mm) Doors
	AAA717T3	Belt, Relating, w/Two-Speed (36 in. & 42 in. or 914 mm & 1067 mm), Single-Slide (32 in., 36 in., & 42 in. or 813 mm, 914 mm, & 1067 mm), and C/O (48 in. or 1219 mm) Doors
	AAA717T4	Belt, Relating, w/Two-Speed (36 in. or 914 mm), C/O (32 in. & 36 in. or 813 mm & 914 mm), and Single-Slide (36 in. or 914 mm) Doors
	AAA717T5	Belt, Relating, w/Two-Speed (32 in. or 813 mm), and Single-Slide (32 in. or 813 mm) Doors
3	NON1241M6X16-8-8B	Bolt, Clamp
4	AAA386LQC1	Clamp
5	AAA346BAT4 AAA346BAT2	Cover
6	AAA346BAG1	Cover, L = 75.6 in. or 1920 mm
	AAA346BAG2	Cover, L = 63.6 in. or 1615 mm
	AAA346BAG3	Cover, L = 58.6 in. or 1489 mm
	AAA346BAG4	Cover, L = 52.1 in. or 1323 mm
7	AAA384AHJ1	Guard
8	AAA392CJ1	Hitch

(Continued on next page)



AAA24350BK AAB24350BK		
REF. No.	PART No.	DESCRIPTION
1	AAA25580AL2	Control Unit (AC Power Supply, Discrete I/O)
	AAA25580AL3	Control Unit (DC Power Supply, Discrete I/O)
	AAA25580AL4	Control Unit (AC Power Supply, Multi-Drop)
2	AAA198BF501	Kit, Idler Pulley Replacement,  TIP 22.16-2 Kit Contains: (1) Pin, (1) Idler Pulley, (1) M8 x 40 Hex Bolt, (1) Washer
3	AAA90EW1	Spring, Compression
4	AAA621BF2	Power Supply, 110 V
	AAA621BF3	Power Supply, 230 V
5	---	Switch, Gate ( p. 12)

Discrete AT400 Electronics Board

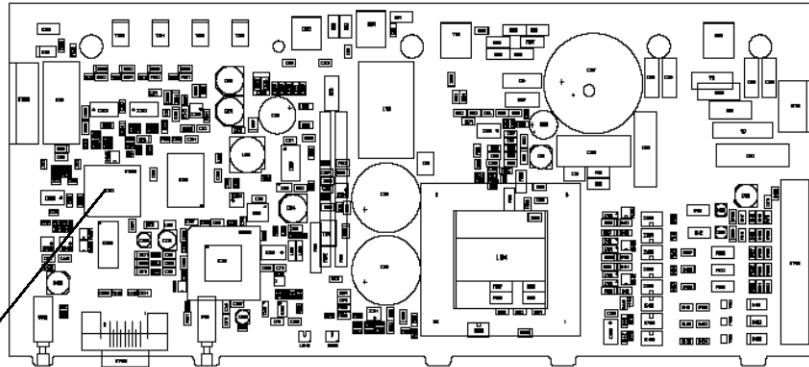

Multidrop AT400 Electronics Board

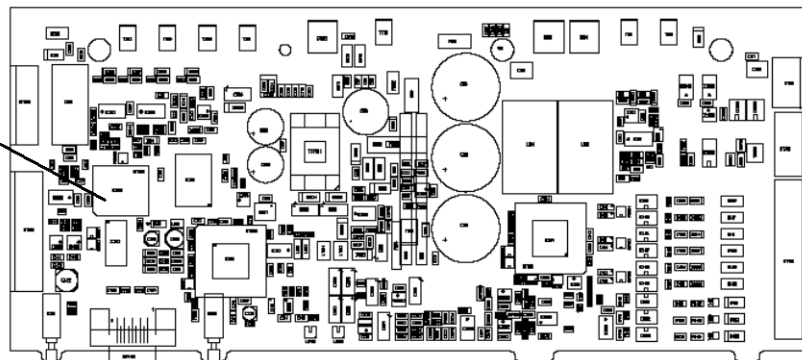

1

REF. No.	PART No.	DESCRIPTION
	AAA24350BK AAB24350BK	
1	AAA816AJ1	Kit, Programmed EPROM, NOTE

NOTE: This kit is for earlier versions of the EPROM-based AT400 controllers that have software version prior to V3.31 (refer to CI 16-07-029 or TIP 22.16-5). These controllers cannot be updated using the PDA and the chip must be replaced using this kit.

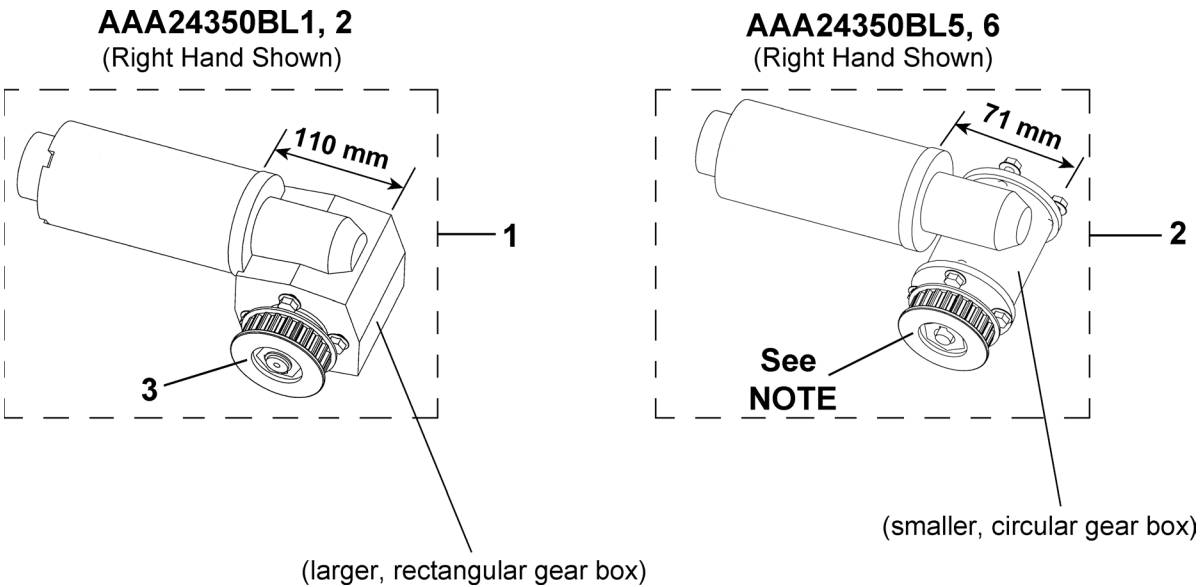

VINTAGE	
AAA24350BK AAB24350BK	
New Installation prior to 03/07	New Installation after 03/07

REF. No.	PART No.		DESCRIPTION	HAND
1	AAA24350BL1	---	Assembly, Gear Motor and Sheave, See NOTE	RH
	AAA24350BL2	---		LH
2	---	AAA24350BL5 AAA24350BL1		RH
	---	AAA24350BL6 AAA24350BL2		LH
3	AAA198BF500	---	Kit, Drive Pulley Replacement, 👁️ TIP 22.16-2 Kit Contains: (1) Driver Pulley, (1) Key, (1) Retaining Ring, (1) Loctite® Retainer, (1) Alcohol Wipes, (1) Scotch-Brite®, Fine Duty	---

NOTE: Drive sheave used in gear motor assembly installed after 03/07 cannot be replaced. Field needs to order gear motor assembly type AAA24350BL (ref. 1 and 2). The drive replacement kit (ref. 3) can be used to replace the drive pulley after the initial replacement of gear motor assembly

Gate Switch

23-AAA24350BK

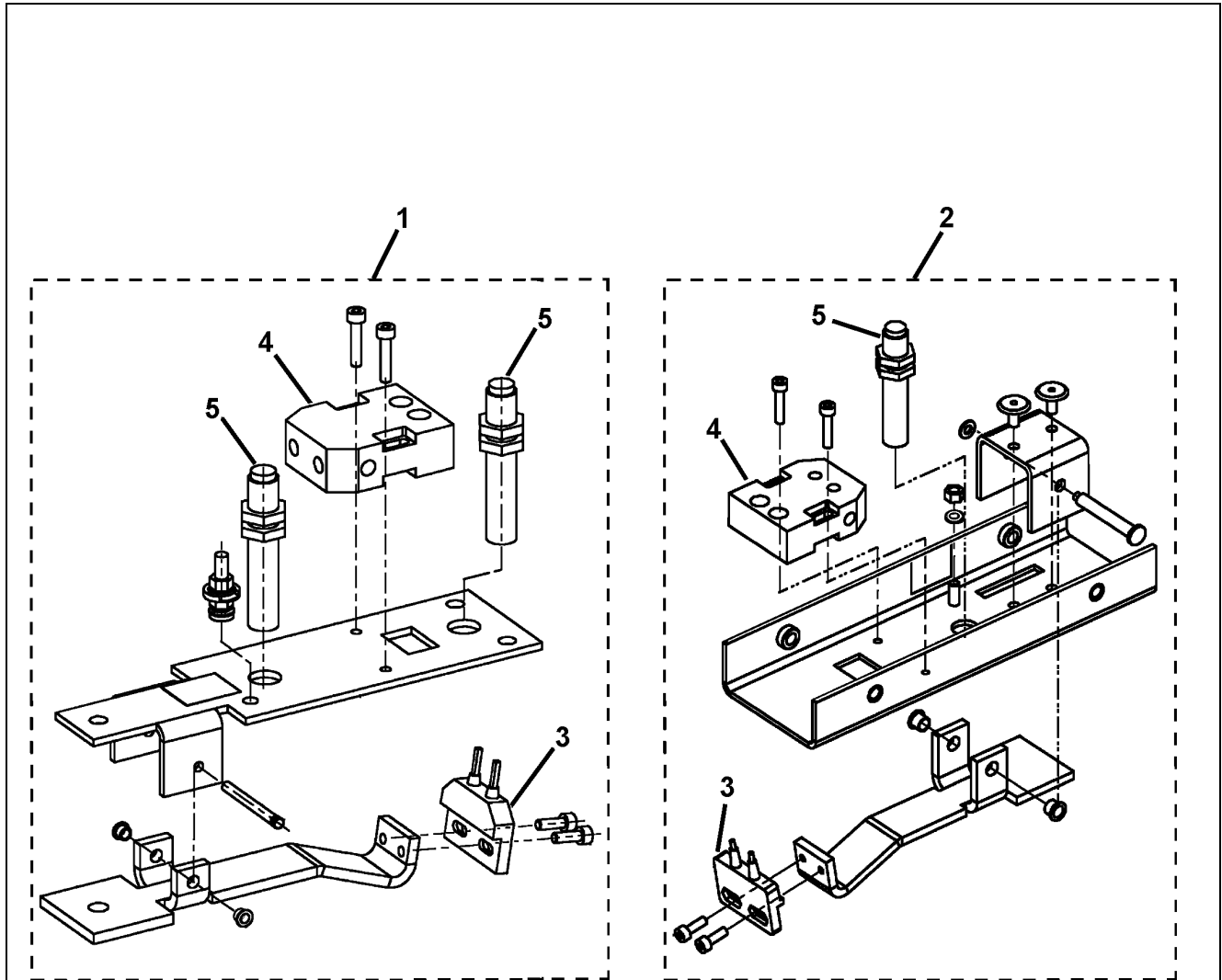

REF. NO.	AAA24350BK	AAB24350BK	DESCRIPTION
	PART or ML		
1	AAA25590T1	---	Assembly, Gate Switch (for Hydraulic/Modernization Units)
	AAA25590T2	---	Assembly, Gate Switch (for Gen2® R2 NAA)
2	AAA25590W1		Assembly, Gate Switch
3	AAA661B6	AAA661B8	Shunt
	AAA661B8		
4	AAA661B101		Switch
5	AAA24431B1		Switch, Proximity