

OTIS Glide® P Door
Operator System
Center-Opening

Spare Parts Leaflet

23-AAA24476ZA

November 20, 2019 / Page 1 of 11

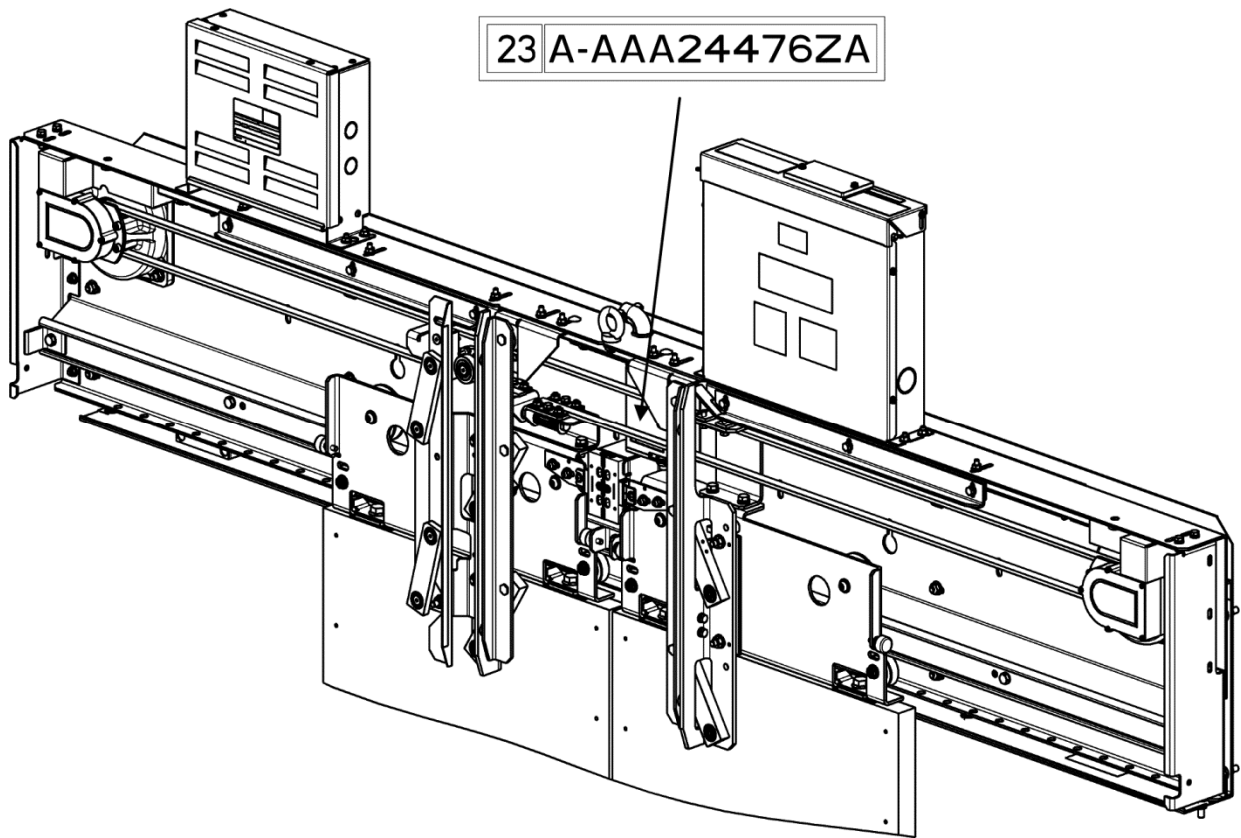

OTIS

This document does not contain any
technical data subject to EAR or ITAR

SERVICE ENGINEERING
Otis Elevator Company
Bloomfield, Connecticut USA

Unpublished Work—© Otis Elevator Co.; 2019

Leaflet Description

This leaflet provides the lowest replaceable units (LRUs) for NG premium car door operator module OTIS Glide® P.

Leaflet Revisions

Date Revised	Subject Matter Expert	Reason for Revision
February 25, 2010	Tricia Derwinski, Richard Kulak	New SPL
February 25, 2015	Brian Regan	Added OPTIGUARD information
November 20, 2019	Peter Kelley	Revised history page

Related Drawings

Drawing No.	Title	Drawing No.	Title
KAA24360AAQ, AAR	NGPOK Door Operator (2 coupler, 1 coupler)	AAA24520R	Car Door Arrangement NGPOK
AAA25580BR	Top-of-Car LWSS Assembly	AAA24520P	Cab Interface Arrangement
AAA24520Q	Car Door Seals		

Related Documents

Document ID	Title
SPL 23-KAA24360AAQ	Door Operator NGPOK System, 2P-CO (CLD), 2 Motor, 2 Coupler, for SIMBA
SPL 17-AAA25580BR	NGPOK LWSS Assembly for Traditional Traction

Subject Matter Expert

Name	Department
Peter Kelley	OSC Service Engineering

About Spare Parts Leaflets...

This document lists the lowest replaceable units (LRUs) for the standard version of the product. The LRUs are chosen by a team of Otis associates representing engineering and manufacturing.

While goal of this document is to make parts identification as easy as possible, the document cannot be all-inclusive. Elevator and escalator contracts classified as “special” or “custom” are not addressed here. For such contracts, please refer to specified information, the contract folder, TIPs, Field Education Articles, Construction Letters, etc. for further information.

If you have any suggestions about this document, please contact the subject matter expert listed on this page.

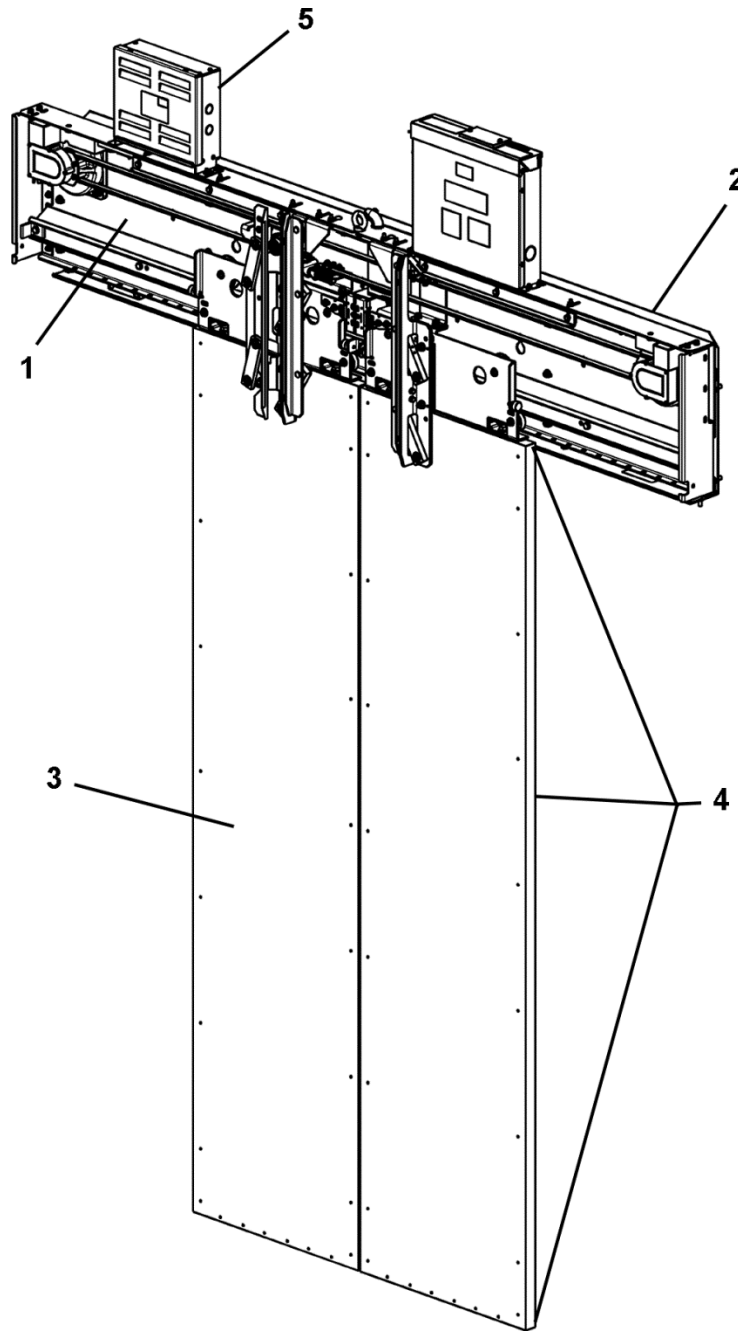

REF. No.	PAGE No.	DESCRIPTION
1	5	Door Operator, 2P-CO (CLD), 2 Motor, 2 Coupler or 1 Coupler
2	6	Cab Interface
3	7-9	Car Door Interface
4	10-11	Car Door Seals
5	---	LWSS, See SPL 17-AAA25580BR

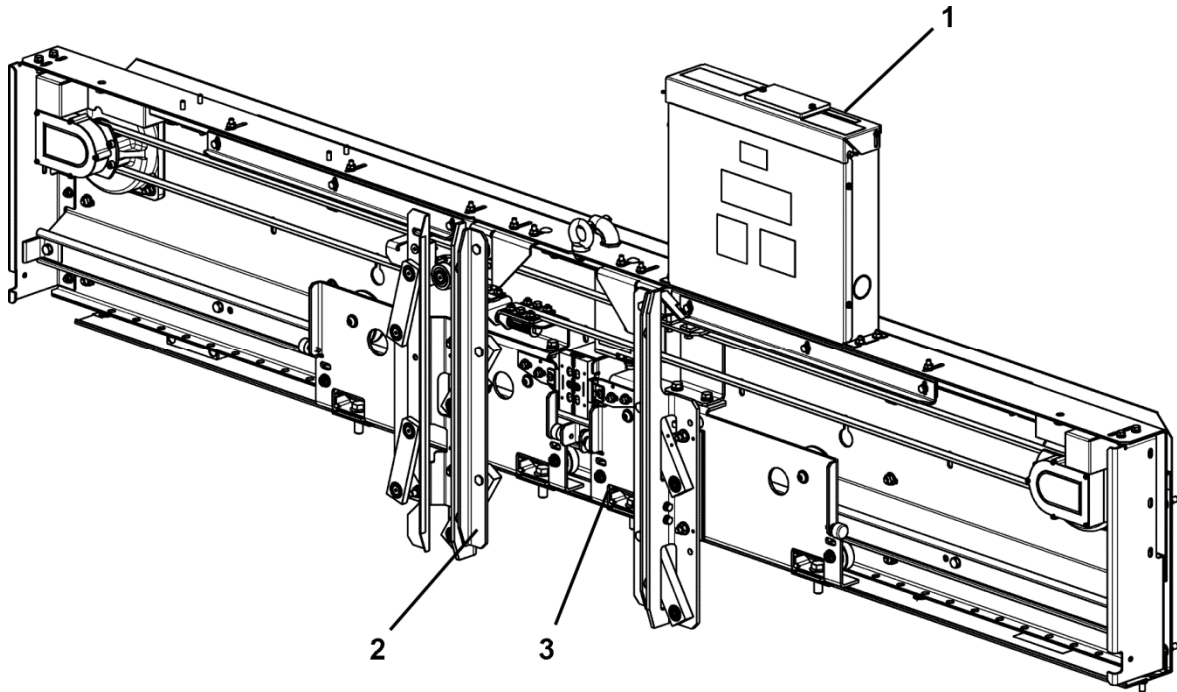

REF. No.	PART No.	DESCRIPTION
1	---	Controller, Door Operator, See SPL 10-KAA24360AAL
2	---	Coupler, See SPL 24-KAA24392AAQ
3	---	OTIS Glide® P Door Operator (not including coupler and controller), See SPL 23-KAA24360AAG
		OTIS Glide® P Door Operator (including coupler and controller), See SPL 23-KAA24360AAQ

Door Operator

23-AAA24476ZA

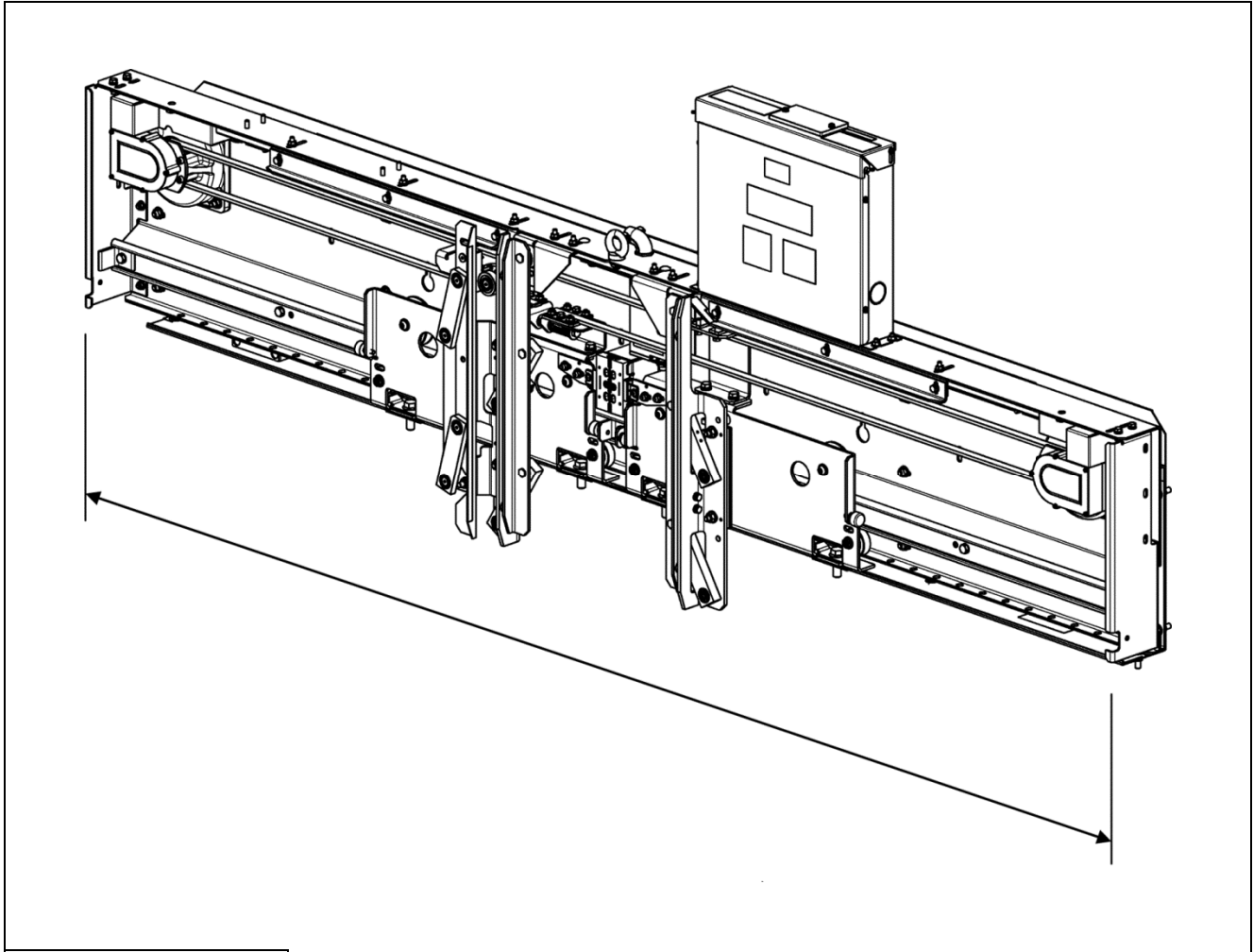

AAA24476ZA				
PART No.	DESCRIPTION	OPENING WIDTH mm (in.)	L mm (in.)	SYSTEM
KAA24360AAQ124	NGPOK Operator, Two Motors, Two Couplers	1000	2100	Traction
KAA24360AAQ132		1100	2300	
KAA24360AAQ140		1200	2500	
KAA24360AAQ148		1300	2700	
KAA24360AAQ156		1400	2900	
KAA24360AAQ172		1067 (42)	2234 (88)	
KAA24360AAQ180		1219 (48)	2538 (100)	
KAA24360AAQ188		1372 (54)	2844 (112)	
KAA24360AAQ196		1524 (60)	3148 (124)	
KAA24360AAQ168		1067 (42)	2234 (88)	
KAA24360AAQ176	1219 (48)	2538 (100)		
KAA24360AAR168	1067 (42)	2234 (88)		
KAA24360AAR176	1219 (48)	2538 (100)		

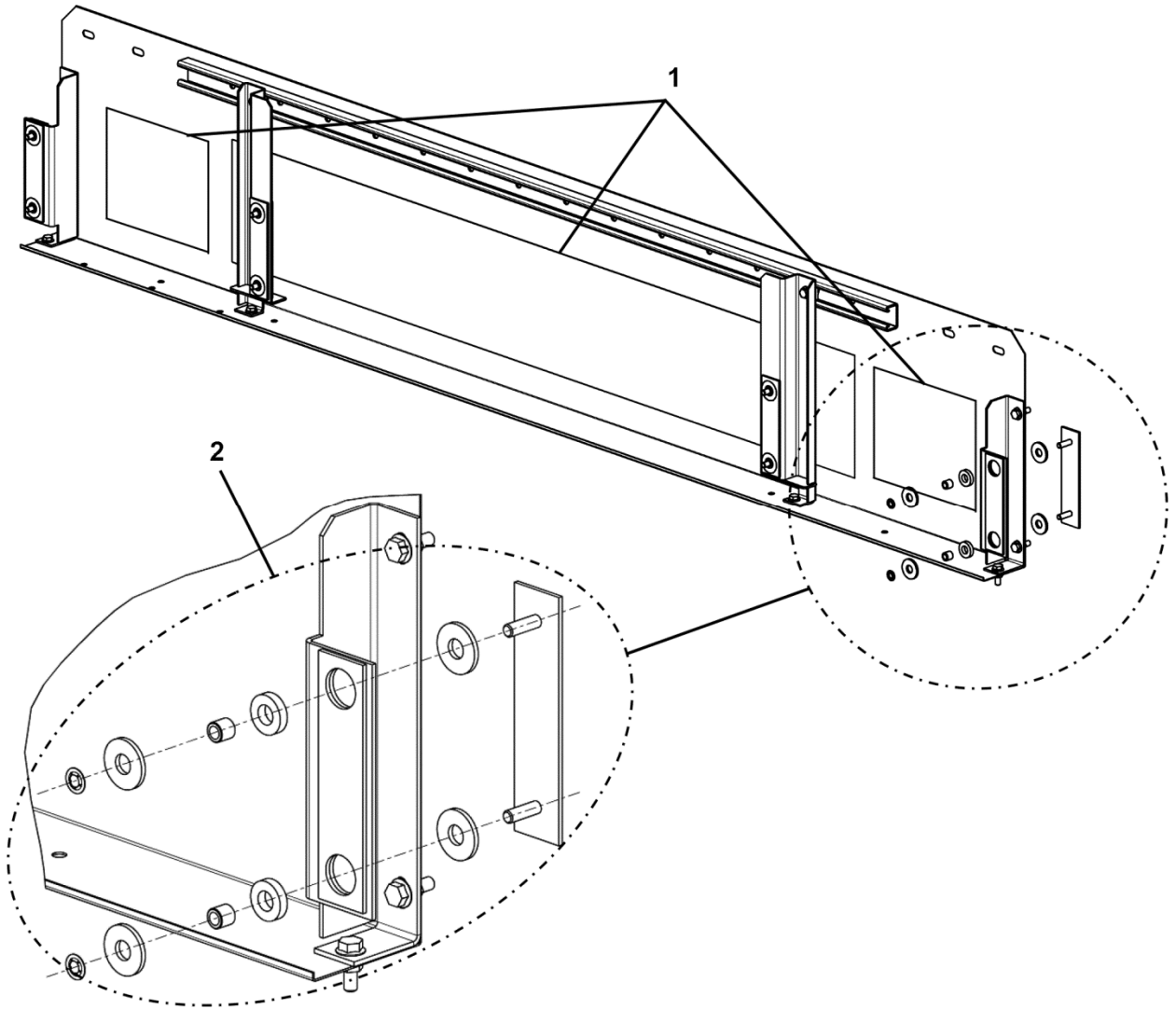

AAA24476ZA			
REF. No.	PART No.	DESCRIPTION	REMARKS
1	AAA386MGJ400	Damper, Foil	1372 x 610 mm Cut to match existing sheet that is being replaced.
2	AAA471KN400	Kit, Stand Isolation	One required per interface bracket, Four interface brackets per cab
---	NON7201M8-8-Z	Nut, M8 Hex, w/ Serrated Flange	Not shown Mounts operator to interface brackets Eight total (two per bracket)

Car Door Interface

23-AAA24476ZA

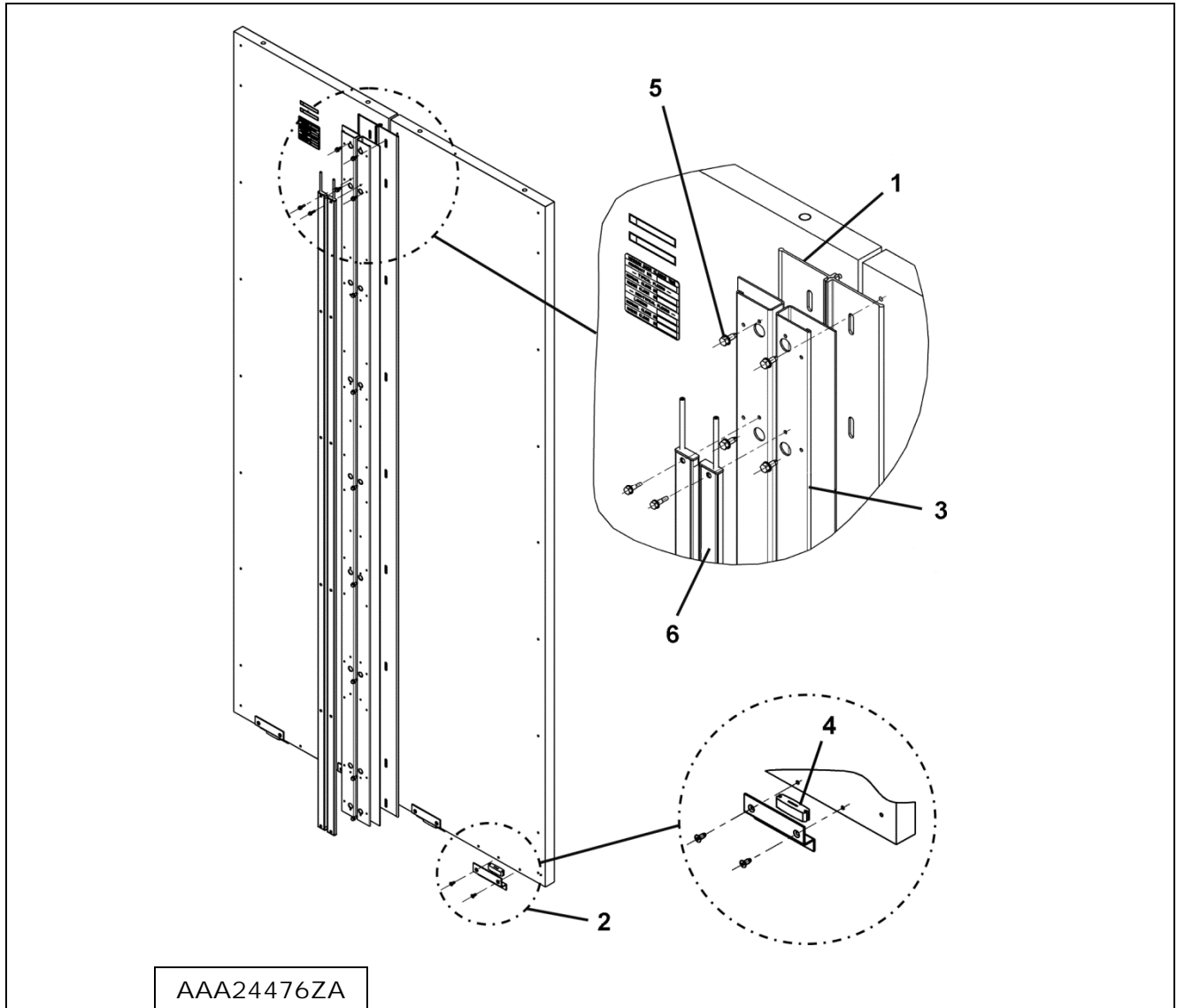

AAA24476ZA			
REF. No.	PART No.	DESCRIPTION	REMARKS
1	AAA402ZX4	Astragal	86 in. Length for 2134 mm (7 ft.) Opening Height
	AAA402ZX5		98 in. Length for 2438 mm (8 ft.) Opening Height
	AAA402ZX3		113.5 in. Length; Cut to length to match other opening height plus 2 in.
2	AAA24520T	Assembly, Door Guide	Two per Door Panel
3	AAA326AN1	Bracket, Lambda 2	2134 mm (7 ft.) Opening Height
	AAA326AN2		2438 mm (8 ft.) Opening Height
	AAA326AN5		2743 mm (9 ft.) Opening Height
4	JAA237ACR1	Insert, Door Guide	One per Guide Assembly
5	AAA24520R400	Kit, Hardware	Opening Height < 2642 mm (8 ft. 8 in.)
	AAA24520R401		Opening Height ≥ 2642 mm (8 ft. 8 in.)
6	---	Lambda 2D	See SPL 20-ABA24591AC

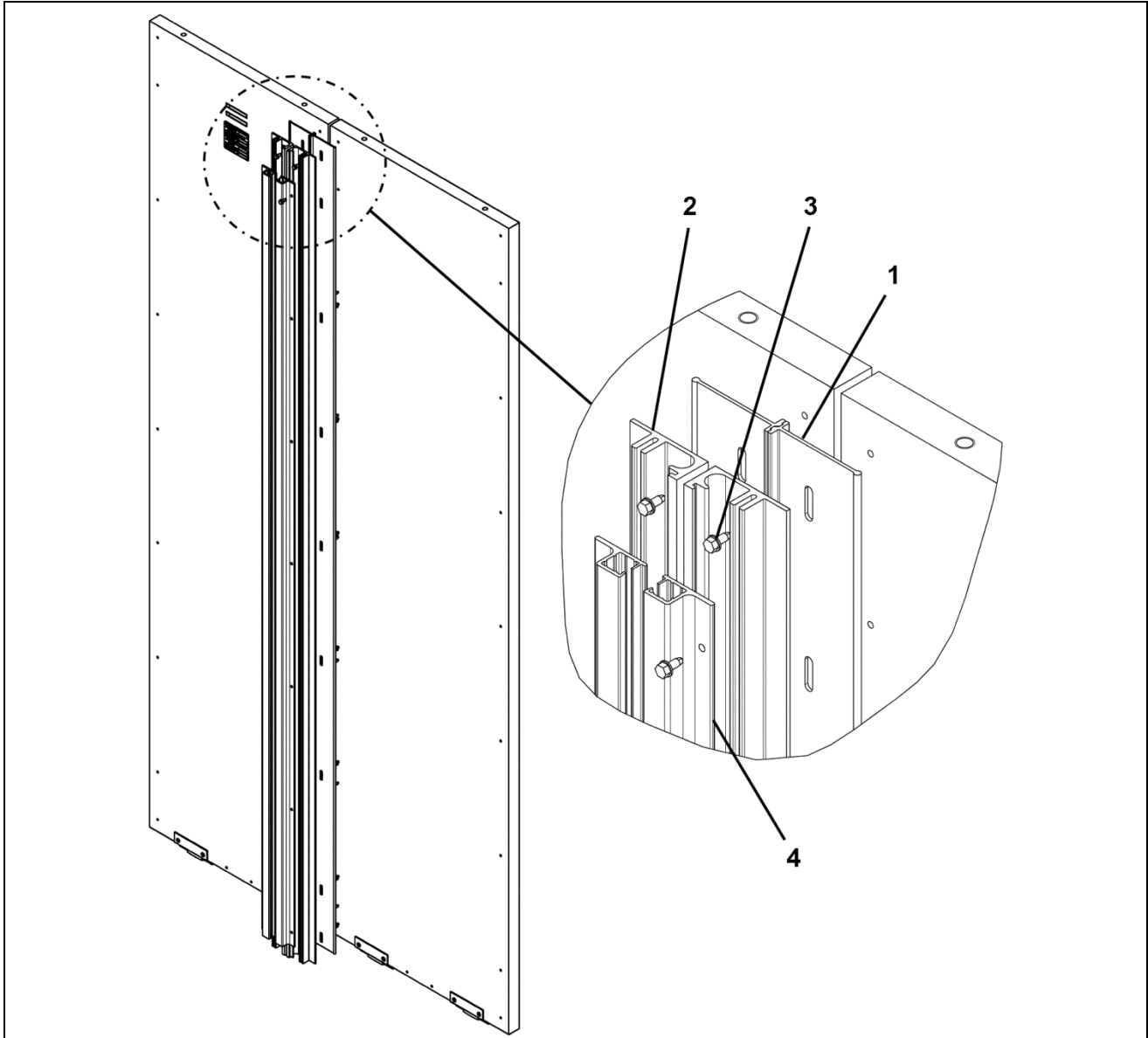

AAA24476ZA

REF. No.	PART No.	DESCRIPTION	REMARKS
1	AAA402ZX4	Astragal	86 in. Length for 2134 mm (7 ft.) Opening Height
	AAA402ZX5		98 in. Length for 2438 mm (8 ft.) Opening Height
	AAA402ZX3		113.5 in. Length—Cut to Length to Match Other Opening Height + 2 in.
2	AAA326AJ1	Bracket, Lambda 3D	2134 mm (7 ft.) Opening Height
	AAA326AJ2		2438 mm (8 ft.) Opening Height
	AAA326AJ8		2743 mm (9 ft.) Opening Height
3	AAA24520R400	Kit, Hardware	Opening Height < 2642 mm (8 ft. 8 in.)
	AAA24520R401		Opening Height ≥ 2642 mm (8 ft. 8 in.)
4	---	Lambda 3D	See SPL 20-AAA24591T

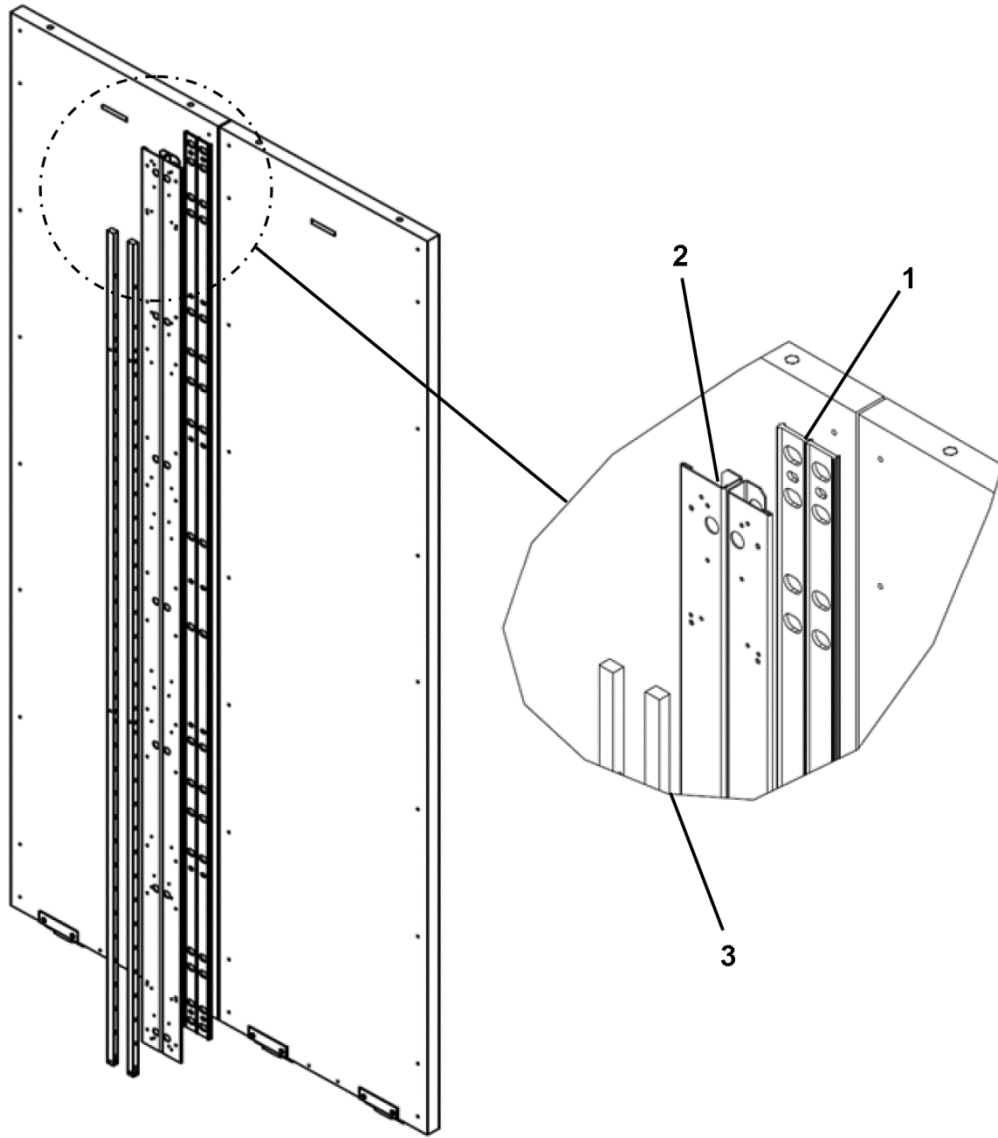

REF. No.	PART No.	DESCRIPTION	REMARKS
	AAA24476ZA		
1	AAA402AAF10	Astragal	2184 mm (86 in.) Length for 2134 mm (7 ft.) Opening Height
	AAA402AAF11		2489 mm (98 in.) Length for 2438 mm (8 ft.) Opening Height
2	AAA326AV1	Bracket, OPTIGUARD™	2134 mm (7 ft.) Opening Height
	AAA326AV2		2438 mm (8 ft.) Opening Height
---	AAA24520R400	Kit, Hardware	Opening Height < 2642 mm (8 ft. 8 in.)
3	---	OPTIGUARD™	See SPL 20-AAA24591AM

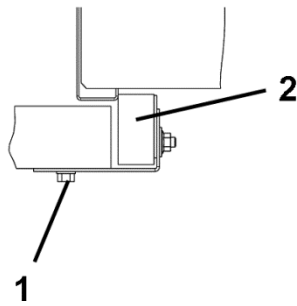
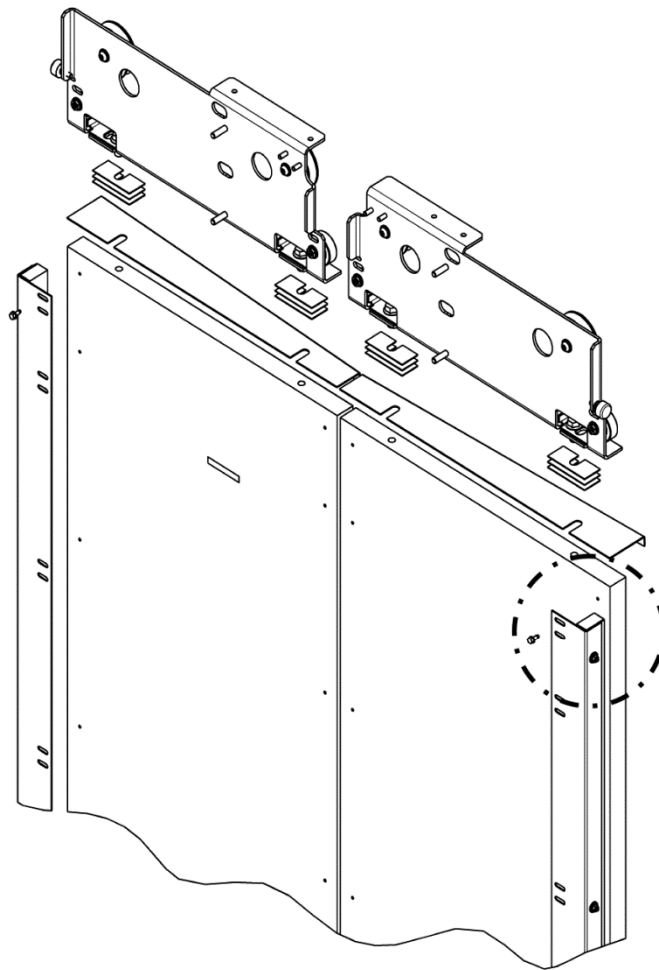

REF. No.	PART No.	DESCRIPTION	REMARKS
	AAA24476ZA		
1	DIN7500DM5X12-Z	Screw, M5 x 12 Hex Head, Thread Rolling	Hardware for Side Seal Brackets
2	AAA429CW101	Seal, Door, Lining Foam	20 mm (13/16 in.) Thick; Cut 36 mm (1-7/16 in.) Wide Strips and to Length Necessary to Fit in Bracket

Door Seal

23-AAA24476ZA

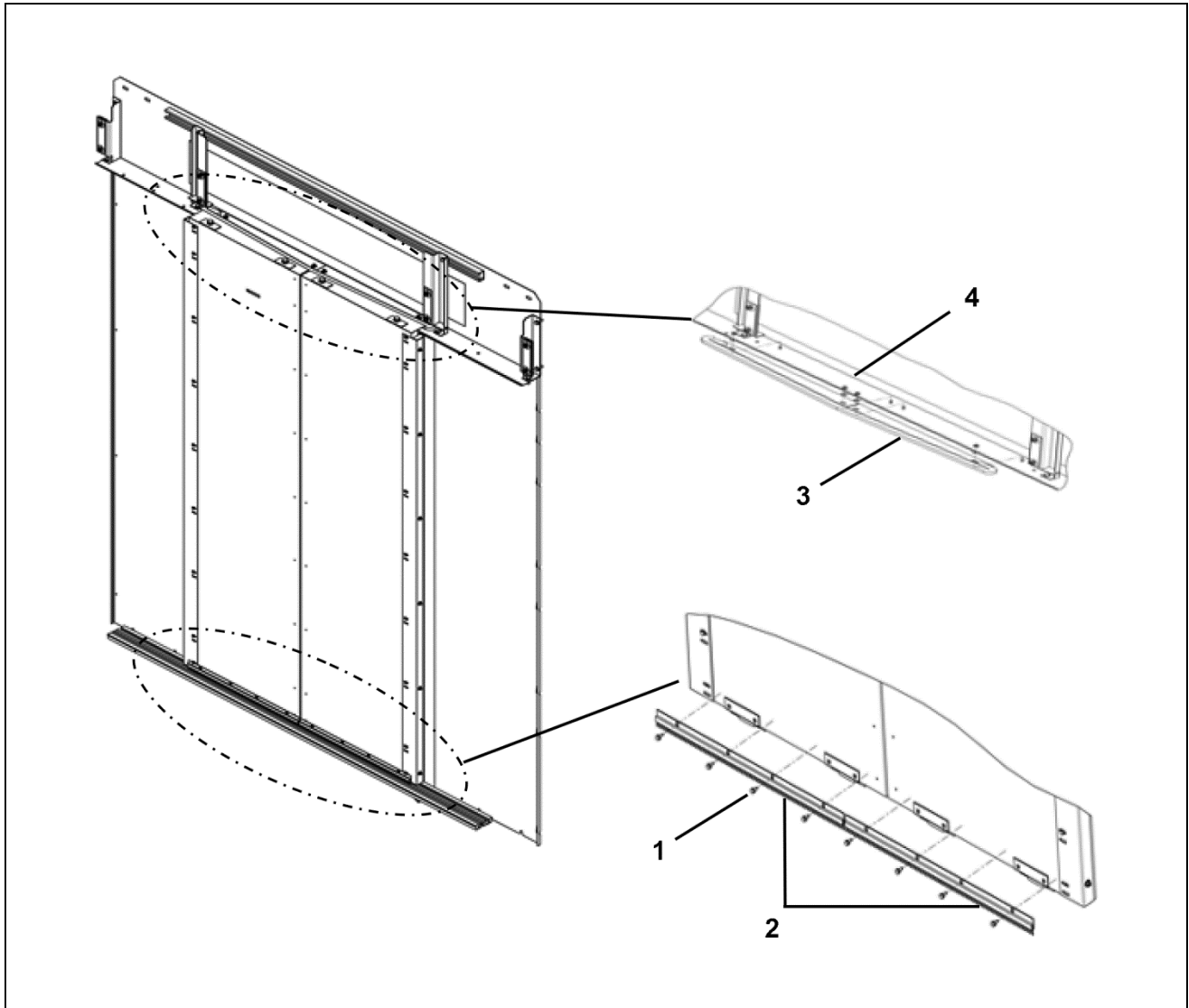

REF. No.	PART No.	DESCRIPTION	REMARKS
	AAA24476ZA		
1	DIN7500DM5X12-Z	Screw, M5 x 12 Hex Head, Thread Rolling	Hardware for Bottom Door Seal Brushes
2	AAA241L1	Seal, Bottom Door	1067 mm (42 in.) Opening Width
	AAA241L2		1219 mm (48 in.) Opening Width
	AAA241L11		1372 mm (54 in.) Opening Width
	AAA241L12		1524 mm (60 in.) Opening Width
3	AAA429CW101	Seal, Lining Door Foam	20 mm (13/16 in.) Thick; Cut 13 mm (1/2 in.) Wide Strips, to Length of = Opening Width +140 mm (5-1/2 in.)
4	ISO7093-M6-140HV-Z	Washer, M6 Flat Large Series	Hardware for Top Door Seal in Cab Header Area
	NON7201M6-8-Z	Nut, M6 Flange Serrated Hex	