

Door Coupler, NG Car Door System

Spare Parts Leaflet 24-AAA24390N

January 26, 2022/ Page 1 of 10

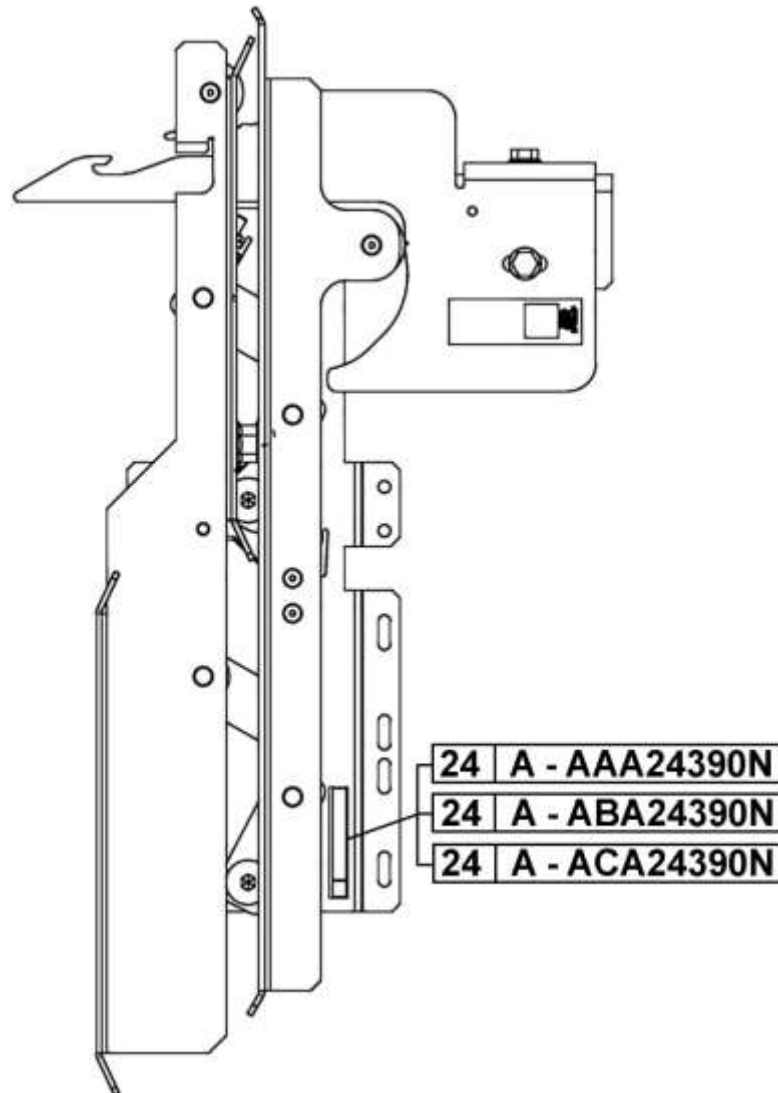

OTIS

This document does not contain any technical data subject to EAR or ITAR

SERVICE ENGINEERING
Otis Elevator Company
Bloomfield, Connecticut USA

Unpublished Work—© Otis Elevator Co.; 2022

Leaflet Description

This leaflet details the lowest replaceable units (LRUs) for door coupler used on NG car door system.

Leaflet Revisions

Date Revised	Subject Matter Expert	Reason for Revision
February 5, 2014	Brian Regan	New Leaflet
February 17, 2016	Brian Regan	Added arrangements ABA24390N17 through 24 (2013 A17 Code reduced the unlocking zone from +/-18 in. to +/-7 in. couple has reduced vane height); Added p/n AAA81PS2 on p. 6
February 6, 2019	Brian Regan	Added new parts to p. 8 Added code year information to pp. 3–6
November 27, 2019	Peter Kelley	Revised history page
September 16, 2020	Peter Kelley	Added Ref. 2 on p. 10
June 9, 2021	Peter Kelley	Added ACA Vintage Information
January 26, 2022	Peter Kelley	Updated cover illustration

Related Drawings

Drawing No.	Title	Drawing No.	Title
AAA24450AE	Glide Door Operator System	ACA24390N	Car Door Coupling

Related Documents

Document ID	Title
SPL 23-AAA24350CE	Glide Door Operator System
SPL 19-AAA24600H	Glide Car Door Hanger/Track System
SPL 19-AAA24600J	Glide SS Car Door Hanger/Track System (Pointer to SPL 19-AAA24600H)
SPL 19-AAA24600K	Glide 2/S Car Door Hanger/Track System (Pointer to SPL 19-AAA24600H)

Subject Matter Expert

Name	Department
Peter Kelley	OSC Service Engineering

About Spare Parts Leaflets...

This document lists the lowest replaceable units (LRUs) for the standard version of the product. The LRUs are chosen by a team of Otis associates representing engineering and manufacturing.

While goal of this document is to make parts identification as easy as possible, the document cannot be all-inclusive. Elevator and escalator contracts classified as "special" or "custom" are not addressed here. For such contracts, please refer to specified information, the contract folder, TIPs, Field Education Articles, Construction Letters, etc. for further information.

If you have any suggestions about this document, please contact the subject matter expert listed on this page.

Coupler Assembly

24-AAA24390N

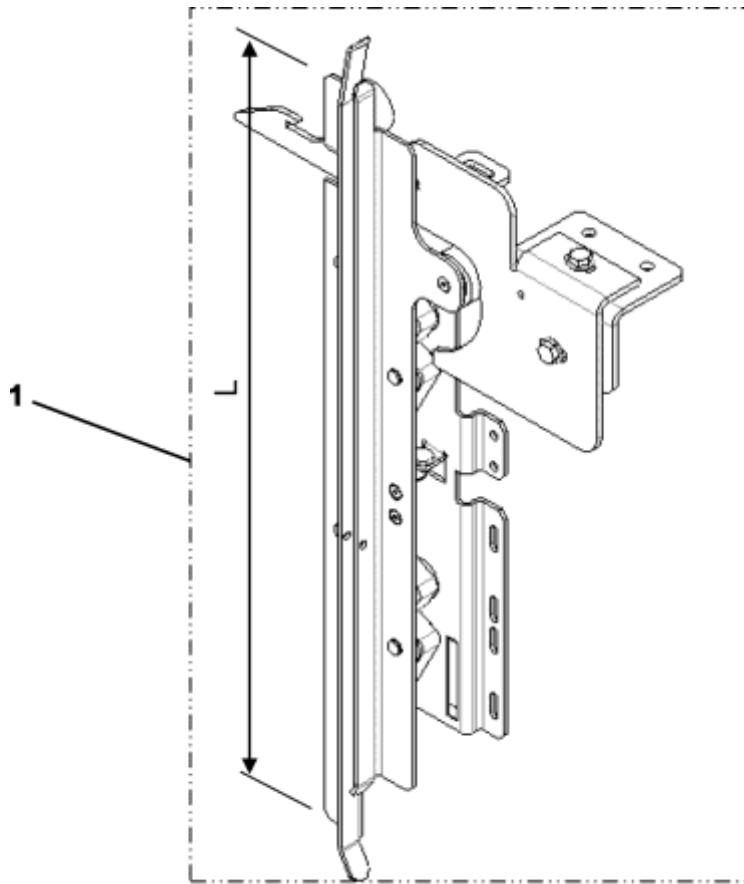

Right Hand Coupler Shown

REF. No.	PART No.	HAND	DOOR TYPE	SILL-TO-SILL DISTANCE (mm)	APPLICATION	VANE L (mm)
	AAA24390N ABA24390N ACA24390N					
1	ABA24390N1 ACA24390N25	Right	C/O and S/S	25	A17 2010 Code Year or Earlier	600
	ABA24390N2 ACA24390N26	Left				
	ABA24390N3 ACA24390N27	Right	2/S			
	ABA24390N4 ACA24390N28	Left				
	ABA24390N5 ACA24390N29	Right	C/O and S/S	32	All Regions Except Alberta Canada	
	ABA24390N6 ACA24390N30	Left				
	ABA24390N7 ACA24390N31	Right	2/S			
	ABA24390N8 ACA24390N32	Left				

Continued on Next Page

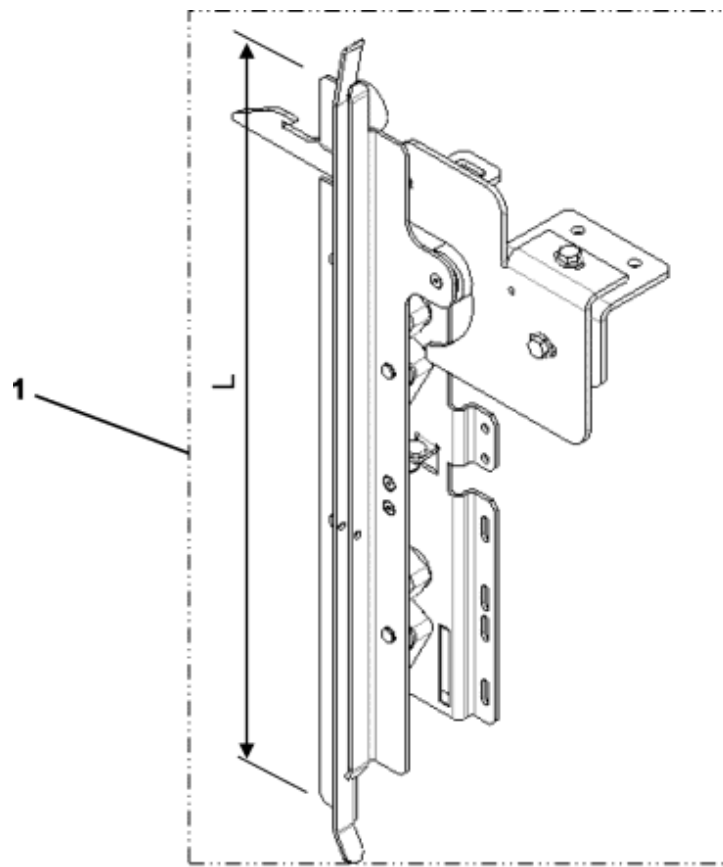

Right Hand Coupler Shown

AAA24390N
ABA24390N
ACA24390N

REF. No.	PART No.	HAND	DOOR TYPE	SILL-TO-SILL DISTANCE (mm)	APPLICATION	VANE L (mm)	
1	ABA24390N9 ACA24390N25	Right	C/O and S/S	25	A17 2010 Code Year or Earlier Alberta Canada	400	
	ABA24390N10 ACA24390N26	Left					
	ABA24390N11 ACA24390N27	Right	2/S				
	ABA24390N12 ACA24390N28	Left					
	ABA24390N13 ACA24390N29	Right	C/O and S/S				32
	ABA24390N14 ACA24390N30	Left					
	ABA24390N15 ACA24390N31	Right	2/S				
	ABA24390N16 ACA24390N32	Left					

Continued on Next Page

Coupler Assembly

24-AAA24390N

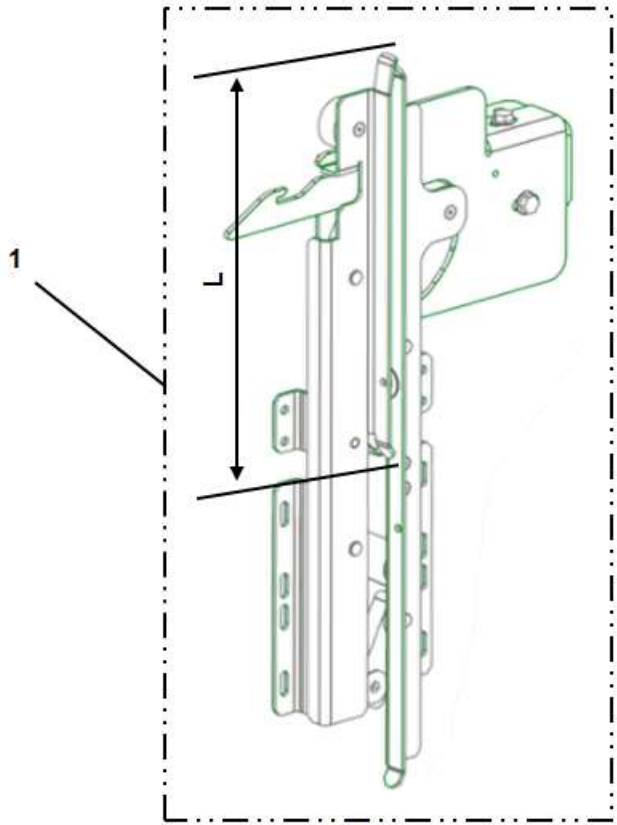

Right Hand Coupler Shown

AAA24390N
ABA24390N
ACA24390N

REF. No.	PART No.	HAND	DOOR TYPE	SILL-TO-SILL DISTANCE (mm)	APPLICATION	VANE L (mm)
1	ABA24390N17 ACA24390N25	Right	C/O and S/S	25	All Regions A17 2013 Code Year or Later Car Door Height = All Entrance Door Height	320
	ABA24390N18 ACA24390N26	Left				
	ABA24390N19 ACA24390N27	Right	2/S			
	ABA24390N20 ACA24390N28	Left				
	ABA24390N21 ACA24390N29	Right	C/O and S/S	32		
	ABA24390N22 ACA24390N30	Left				
	ABA24390N23 ACA24390N31	Right	2/S			
	ABA24390N24 ACA24390N32	Left				

Continued on Next Page

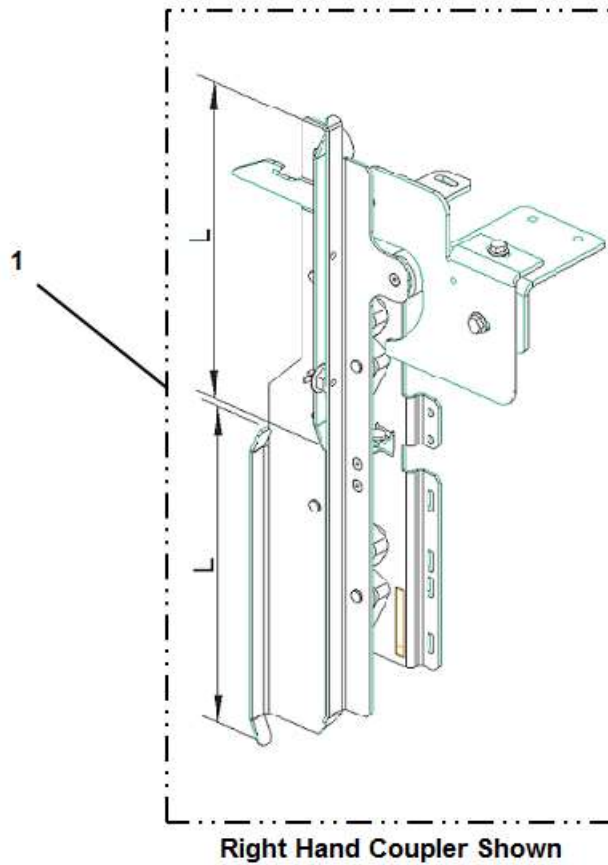

**AAA24390N
ABA24390N
ACA24390N**

REF. No.	PART No.	HAND	DOOR TYPE	SILL-TO-SILL DISTANCE (mm)	APPLICATION	VANE L (mm)	
1	ACA24390N25	Right	C/O and S/S	25	A17 2013 Code Year or Later: All Regions	299	
	ACA24390N26	Left					
	ACA24390N27	Right	2/S				
	ACA24390N28	Left					
	ACA24390N29	Right	C/O and S/S	32	A17 2010 Code Year or Earlier: All Regions		
	ACA24390N30	Left					
	ACA24390N31	Right	2/S				Car Door Height = Entrance Door Height + 1 ft.
	ACA24390N32	Left					

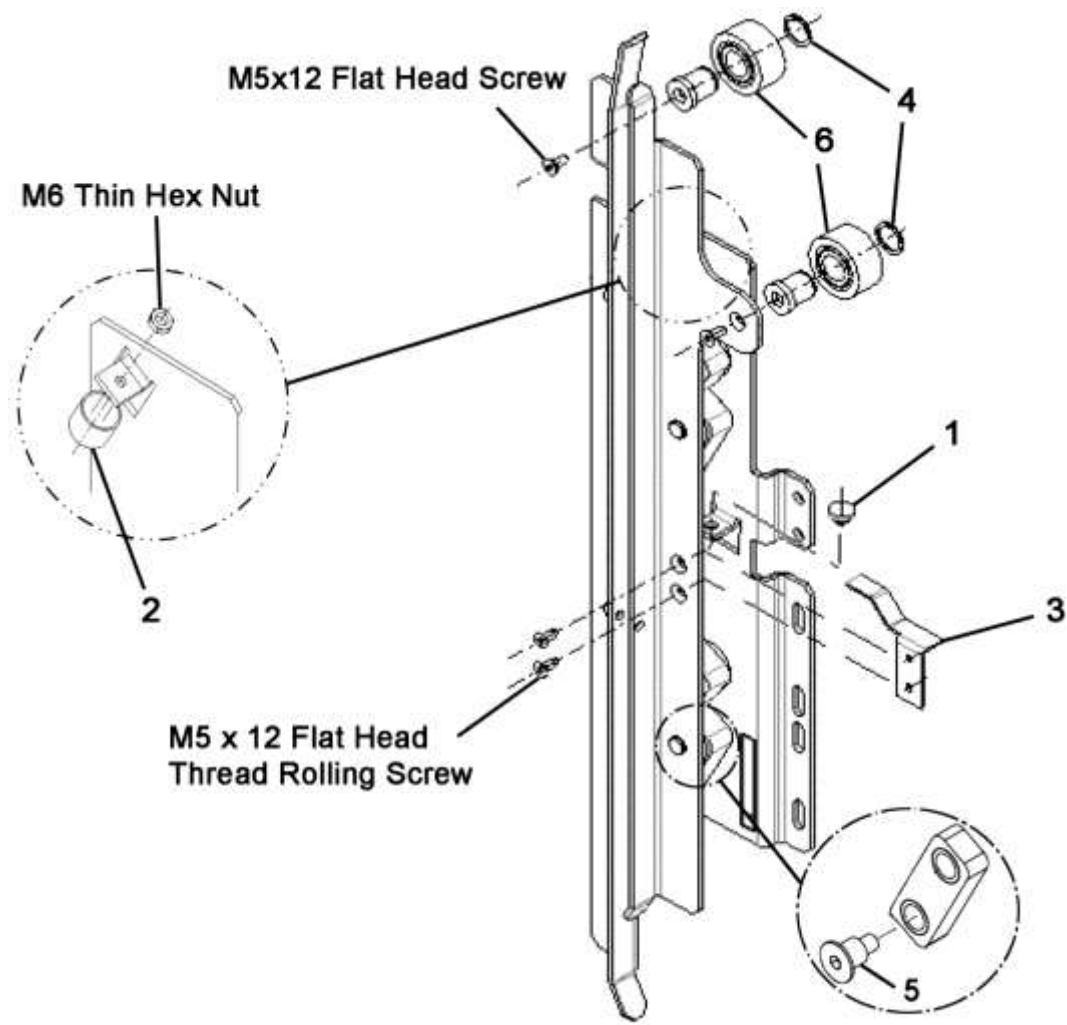

Right Hand Coupler Shown

**AAA24390N
ABA24390N
ACA24390N**

REF. No.	PART No.	DESCRIPTION
1	AAA320GK1	Bumper
2	AAA320GS1	Bumper
3	AAA327QA1	Cam, Right Hand (shown)
	AAA327QA2	Cam, Left Hand
4	172PM19	Clip, Retaining
5	AAA81PS2	Pin
6	AAA456XR1	Roller

Ramp

24-AAA24390N

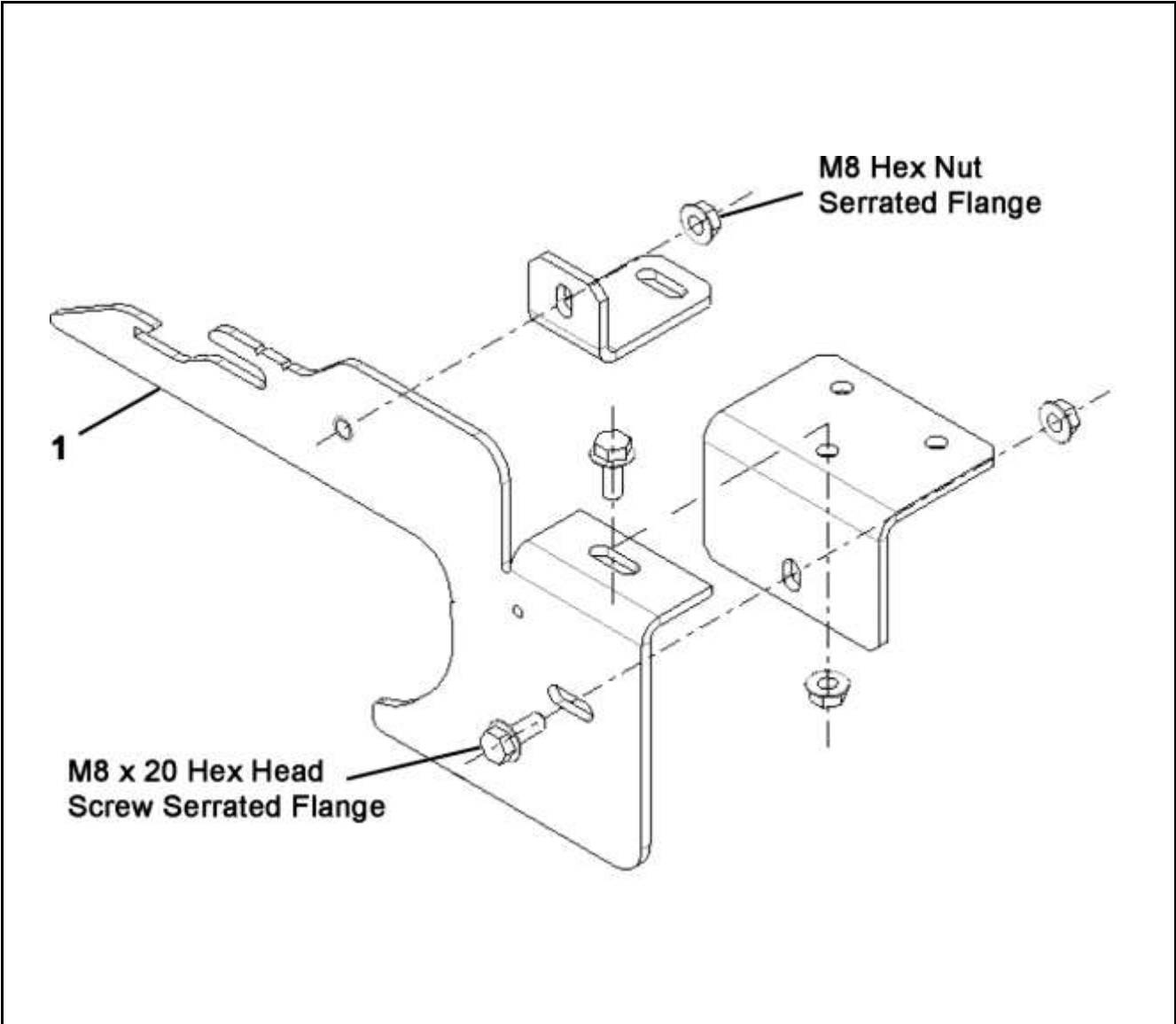

	AAA24390N ABA24390N ACA24390N	
REF. No.	PART No.	DESCRIPTION
1	AAA386MMX2 AAA386MMX6 AAA386MMX10*	Ramp, Right Hand (shown)
	AAA386MMX4 AAA386MMX8 AAA386MMX12*	Ramp, Left Hand

*This ramp requires up to (6) AAA255TG1 shims for proper alignment. See page 10.

24-AAA24390N

Shim

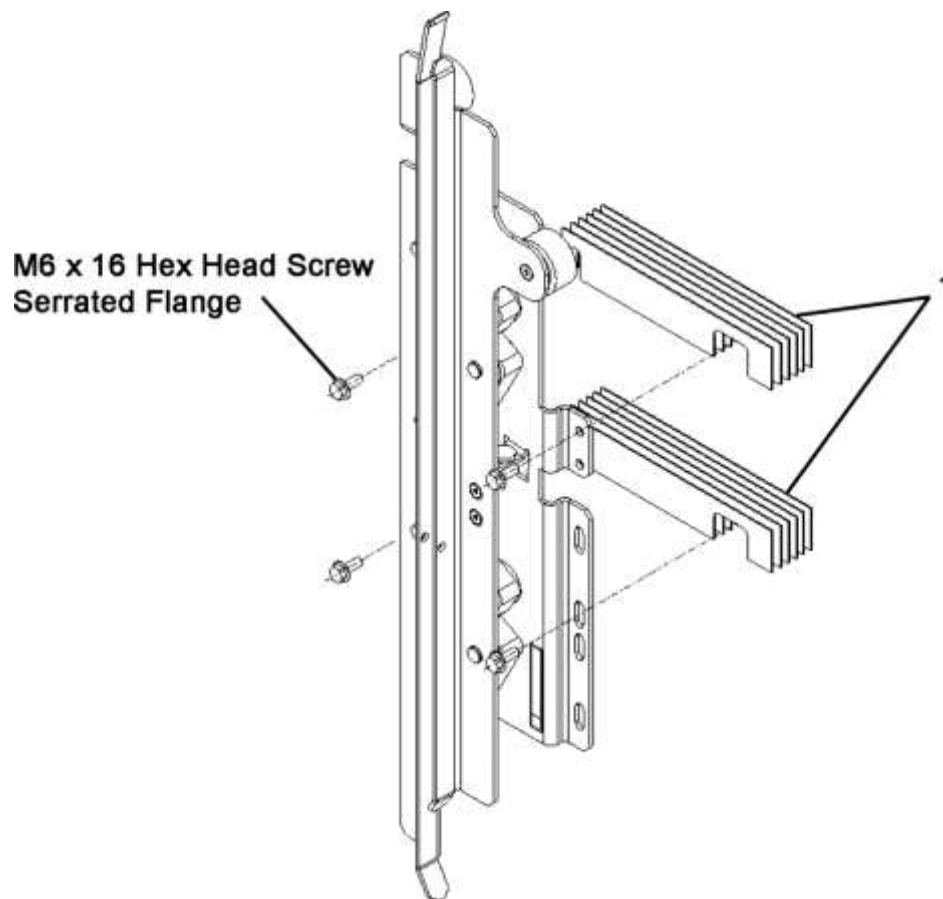

M6 x 16 Hex Head Screw
Serrated Flange

AAA24390N
ABA24390N
ACA24390N

REF. No.	PART No.	DESCRIPTION
1	AAA255NS1	Shim (qty. 16 per assembly)

Hardware and Shim

24-AAA24390N

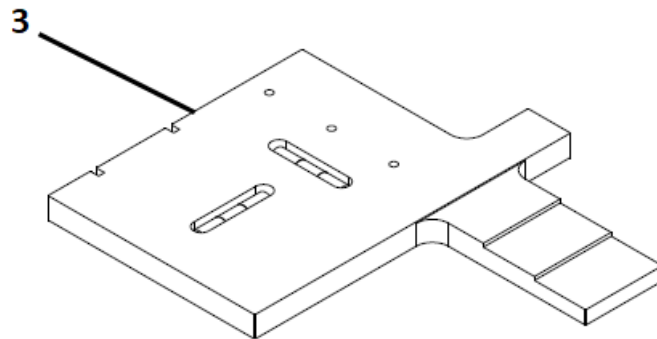
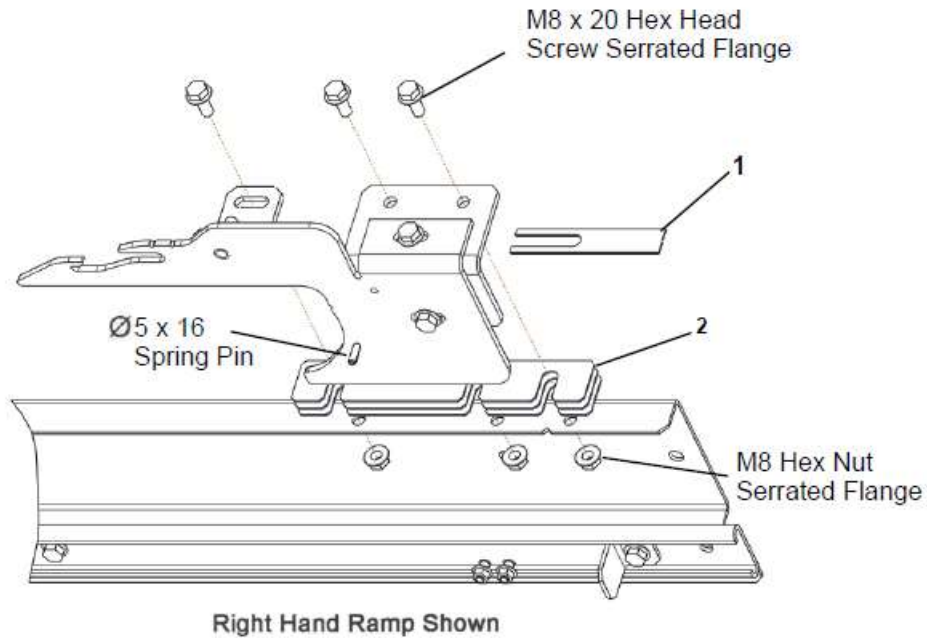

AAA24390N
ABA24390N
ACA24390N

REF. No.	PART No.	DESCRIPTION
*	ACA24390N400	Kit, Hardware
1	AAA255NZ1	Shim (qty. 4 per assembly)
2	AAA255TG1	Shim (qty. 6 per assembly)
3	AAA27ML1	Tool, Coupler Adjustment

* Hardware not shown. Hardware kit includes all shim and hardware for mounting coupler and ramp.