

# Collapsible Door Restrictor

**Spare Parts Leaflet**

**27-AAA6940BW**

**January 15, 2003 / Page 1 of 5**

**Supersedes SPL 27-AAA6940BW Dated December 1, 1999**

**W/O  
VINTAGE**

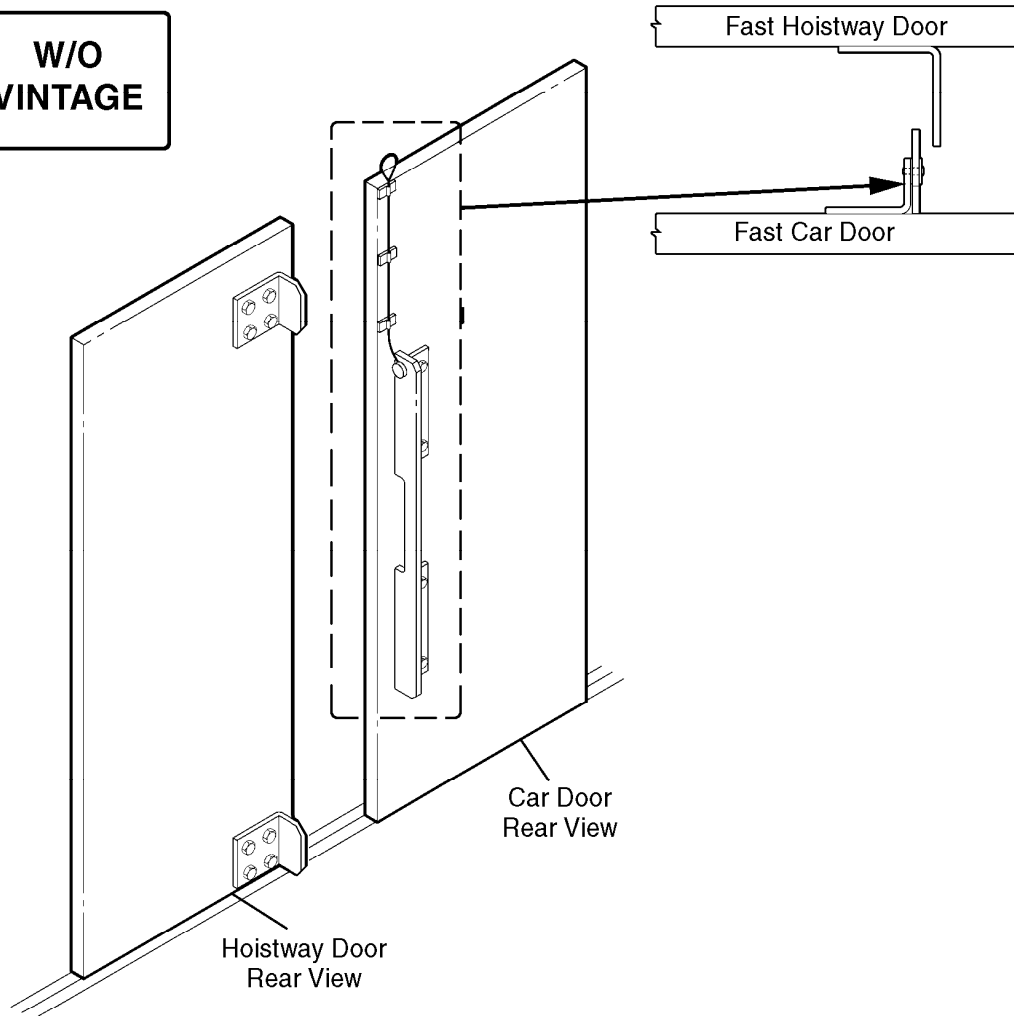

# OTIS

**Safety First!**

**SERVICE ENGINEERING**  
**Otis Elevator Company**  
**Bloomfield, Connecticut USA**

**Leaflet Description**

This leaflet provides spare parts information for type AAB6940BW collapsible door restrictor. Added chamfered hoistway angles. Chamfered angles should be used exclusively where complete new restrictor set ups are being installed. If service replacement of existing angles is being done, the conservative approach is to replace in kind. However, the chamfered angles are more mechanic friendly so if the minimum and maximum permissible restricted door car travel distances can be met (per ANSI code), the later chamfered angles would be more beneficial to field workers.

**Leaflet Revisions**

<b>Date Revised</b>	<b>Subject Matter Expert</b>	<b>Reason for Revision</b>
December 1, 1999	Duane Stupienski	New leaflet, initial release
January 15, 2003	Duane Stupienski	Changed callouts from AAA to AAB6940BW on page 3. Also included hoistway angle part numbers on page 5.

**Related Drawings**

<b>Drawing No.</b>	<b>Title</b>	<b>Drawing No.</b>	<b>Title</b>
AAA6940BW	Kit, Collapsible Door Restrictor	AAA6940BV	Assembly, Collapsible Door Restrictor
AAB6940BW	Kit, Collapsible Door Restrictor		

**Related Documents**

<b>Document ID</b>	<b>Title</b>
TIP 21.3-6	AAA6940BW Collapsible Door Restrictor (CDR)

**Subject Matter Expert**

<b>Name</b>	<b>Department</b>
Duane Stupienski	OSC Service Engineering

**About Spare Parts Leaflets...**

This document lists the lowest replaceable units (LRUs) for the standard version of the product. The LRUs are chosen by a team of Otis associates representing engineering and manufacturing.





While goal of this document is to make parts identification as easy as possible, the document cannot be all-inclusive. Elevator and escalator contracts classified as "special" or "custom" are not addressed here. For such contracts, please refer to specified information, the contract folder, TIPs, Field Education Articles, Construction Letters, etc. for further information.

If you have any suggestions about this document, please contact the subject matter expert listed on this page.

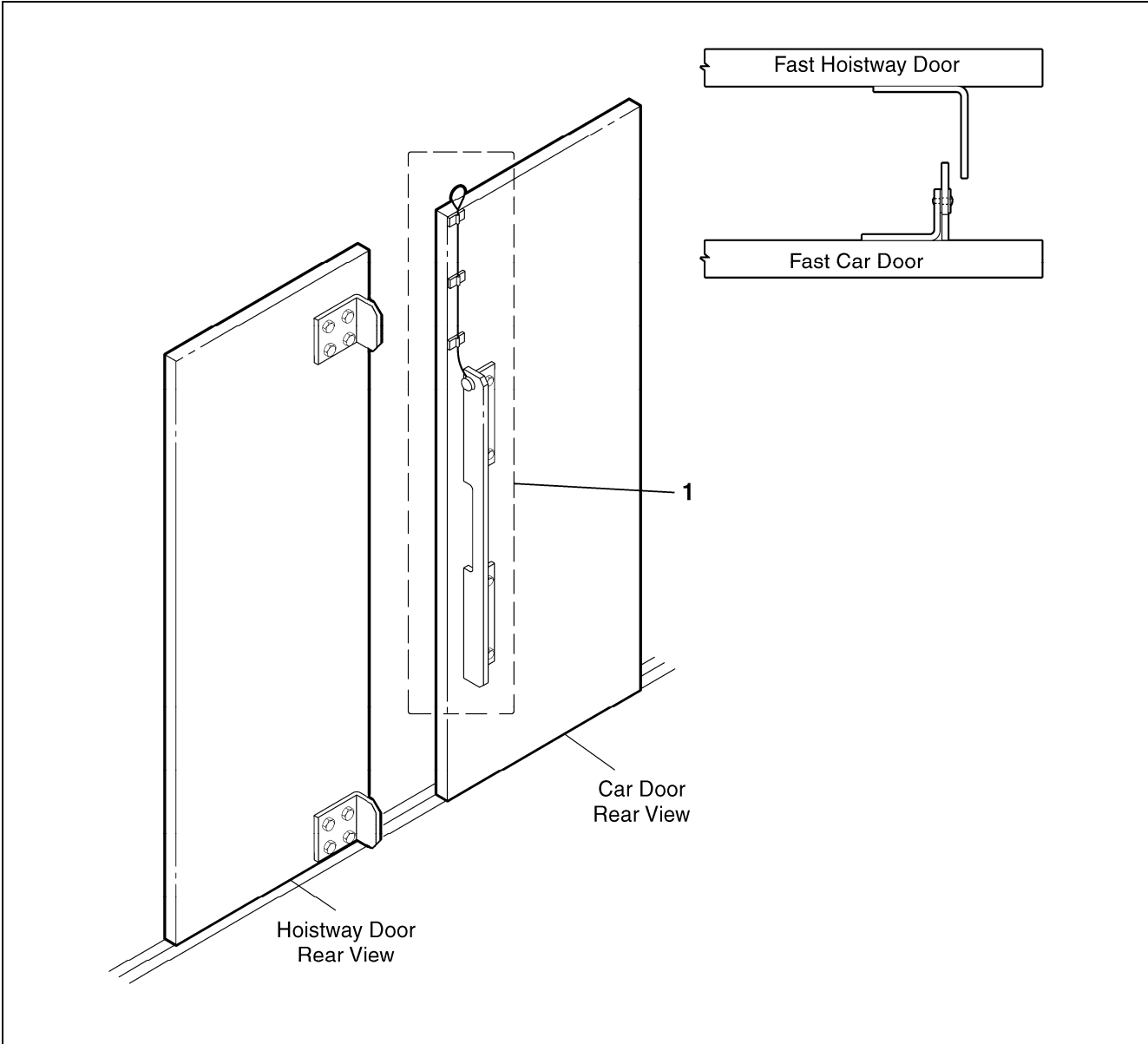
# Type AAB6940BW Collapsible Door Restrictor

**27-AAA6940BW**



<b>VINTAGE</b>				
<b>REF. No.</b>	<b>PART No.</b>	<b>DESCRIPTION</b>	<b>ENTRANCE HEIGHT</b>	<b>HAND</b>
1	AAB6940BW1	Kit, Collapsible Door Restrictor	84.0 in.	
	AAB6940BW2			
	AAB6940BW3		96.0 in.	
	AAB6940BW4			

**27-AAA6940BW**

## Collapsible Door Restrictor Components

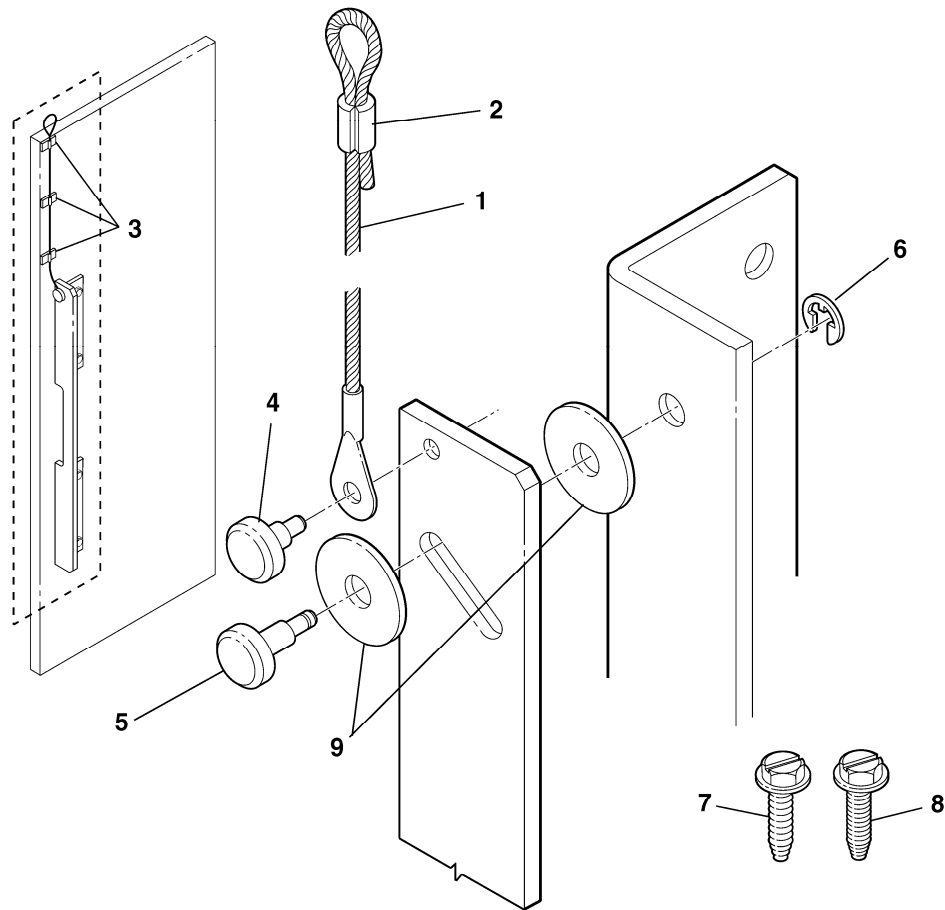

<b>VINTAGE</b>		
<b>REF. No.</b>	<b>PART No.</b>	<b>DESCRIPTION</b>
1	712AAA4	Cable, Aircraft
2	336GF3	Clamp, Cable
3	AAA385RR2	Guide, Aircord
---	AAA509AC1	Hook, Cable Release (part not shown)
4	AAA81KL1	Pin
5	AAA81KN1	Pin
6	172JR2	Ring, Retaining, Bowed
7	109P2	Screw, Thread-Forming 1/4-20 x 5/8 (for restrictor mounting)
8	109P16	Screw, Thread-Forming 8-32 x 3/8 (for aircord guide mounting)
9	129CP11	Washer, Non-Metallic

# Hoistway Formed Angles

**27-AAA6940BW**

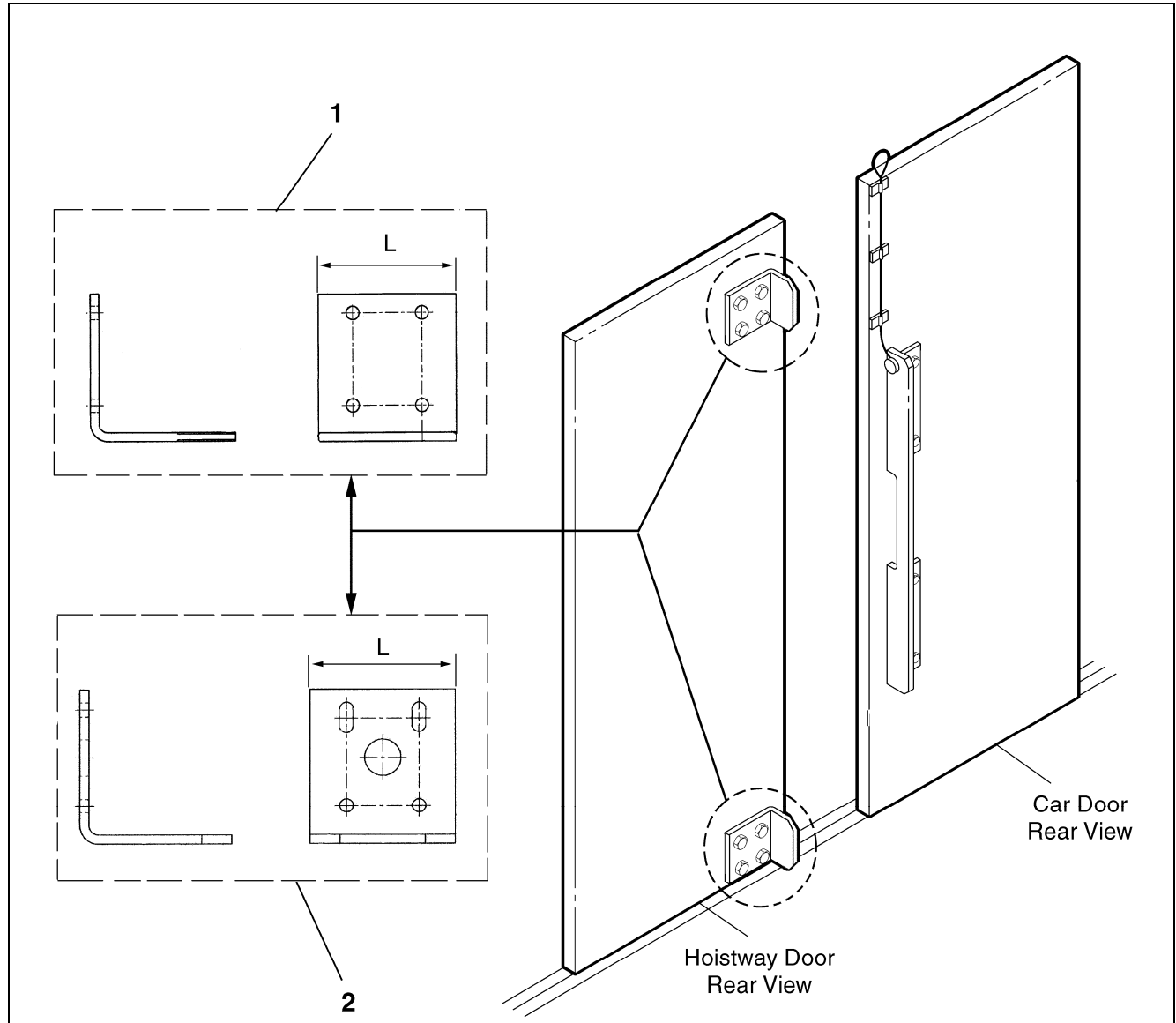

REF. No.	W/O VINTAGE		DESCRIPTION	L
	PART No.	AAB6940BW		
1	A283AAN1	---	Angle w/o Chamfers,  Note	3 in.
	A283AAN3		Angle, Formed	25 in.
2	---	ABA283ANE1	Angle, Formed w/Chamfers	3 in.

**NOTE:** It is highly advised that if the required maximum distances traveled outside of door zone are met by using the ref. 2 chamfered angle, you should order p/n AAA283ANE1. Check code and application and order accordingly.