

# Flat Hall Station Assembly

**Spare Parts Leaflet**

**32-AAA23500BE**

**September 17, 2003 / Page 1 of 10**

**Supersedes SPL 32-AAA23500BE Dated April 1, 2000**

**32 R-AAA23500BE**

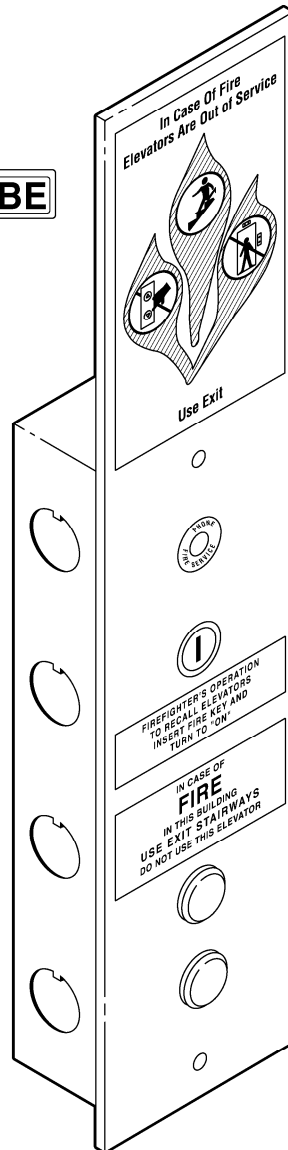

**OTIS**

**Safety First!**

**SERVICE ENGINEERING**  
Otis Elevator Company  
Bloomfield, Connecticut USA

**Leaflet Description**

This leaflet provides spare parts information for a flat hall station assembly type AAA23500BE.

**Leaflet Revisions**

<b>Date Revised</b>	<b>Subject Matter Expert</b>	<b>Reason for Revision</b>
April 1, 2000	Steve Karvazy	New SPL
September 17, 2003	Lisa K. Mitchell	Add new parts pp. 4 and 5

**Related Drawings**

<b>Drawing No.</b>	<b>Title</b>	<b>Drawing No.</b>	<b>Title</b>
AAA23500BE	Hall Station Assembly Flat Hall Stations	AAA147RJ	Faceplate

**Related Documents**

<b>Document ID</b>	<b>Title</b>
32-AAA23500BF	Low Profile Extended Hall Station Assembly
32-AAA23500BG	Surface Mount Extended Hall Station Assembly
31-AAA23500AL	Jewel, Micro-Motion III
31-AAA23500AK	Fixture-Part Luxury, Modular Micro-Motion 3 Pushbutton
31-AAA23500F	Luxury Fixtures, Keyswitch Assemblies, Light Rings, & Engraved Collars
31-AAA23500T	Phone Jack Assembly

**Subject Matter Expert**

<b>Name</b>	<b>Department</b>
Lisa K. Mitchell	OSC Service Engineering

**About Spare Parts Leaflets...**

This document lists the lowest replaceable units (LRUs) for the standard version of the product. The LRUs are chosen by a team of Otis associates representing engineering and manufacturing.

While goal of this document is to make parts identification as easy as possible, the document cannot be all-inclusive. Elevator and escalator contracts classified as "special" or "custom" are not addressed here. For such contracts, please refer to specified information, the contract folder, TIPS, Field Education Articles, Construction Letters, etc. for further information.

If you have any suggestions about this document, please contact the subject matter expert listed on this page.

# Buttons & Keyswitches

**32-AAA23500BE**

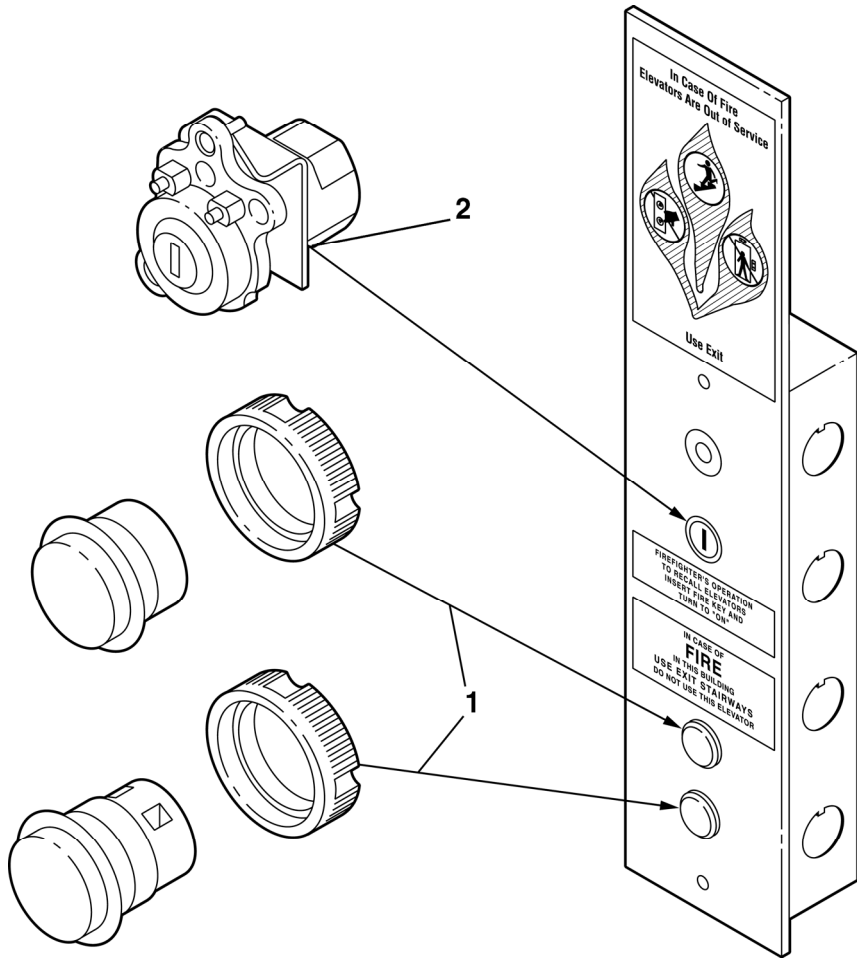

AAA23500BE		
REF. NO.	PART No.	DESCRIPTION
1	---	Button, Micromotion III, Vandal Resistant, Amber LED Illumination, Type AAA23500AM,  SPL 31-AAA23500AM
	---	Button, Micromotion III, Luxury, Amber LED Illumination, Type AAA23500AK,  SPL 31-AAA23500AK
2	---	Keyswitch Module, w/Engraved Collar, Type AAB23500G,  SPL 31-AAA23500F
	---	Keyswitch Module, SES Northeast Lock, Type AAB23500W,  SPL 31-AAA23500F
	---	Keyswitch Module, Conn. SES, Type AAB23500K,  SPL 31-AAA23500F
	---	Keyswitch, Module, Integral Lock & Switch, SES Type AAA23500AD,  SPL 31-AAA23500F
	---	Keyswitch Module, MEDECO, Type AA23500R,  SPL 31-AAA23500F

# Firefighters' Instruction Plates

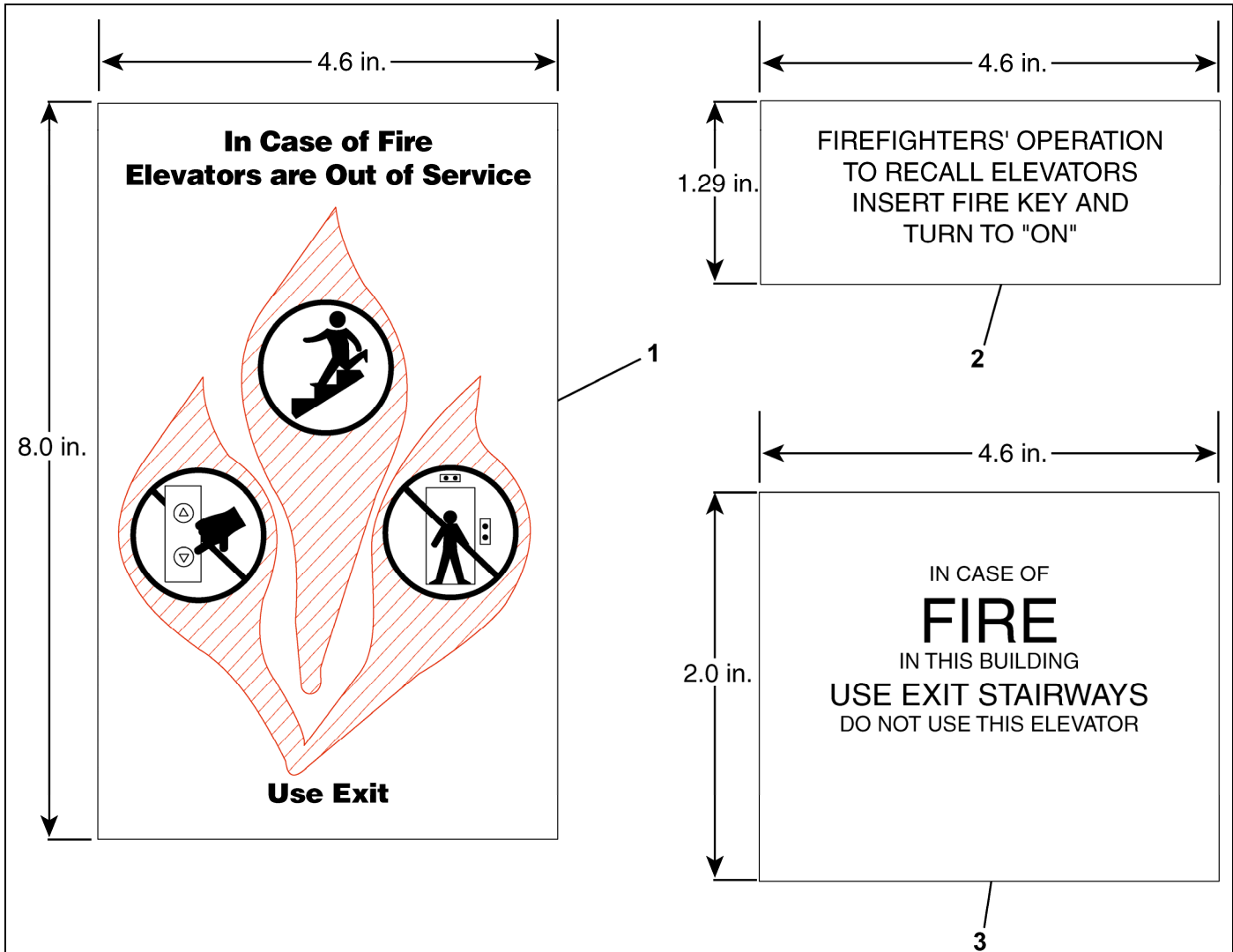



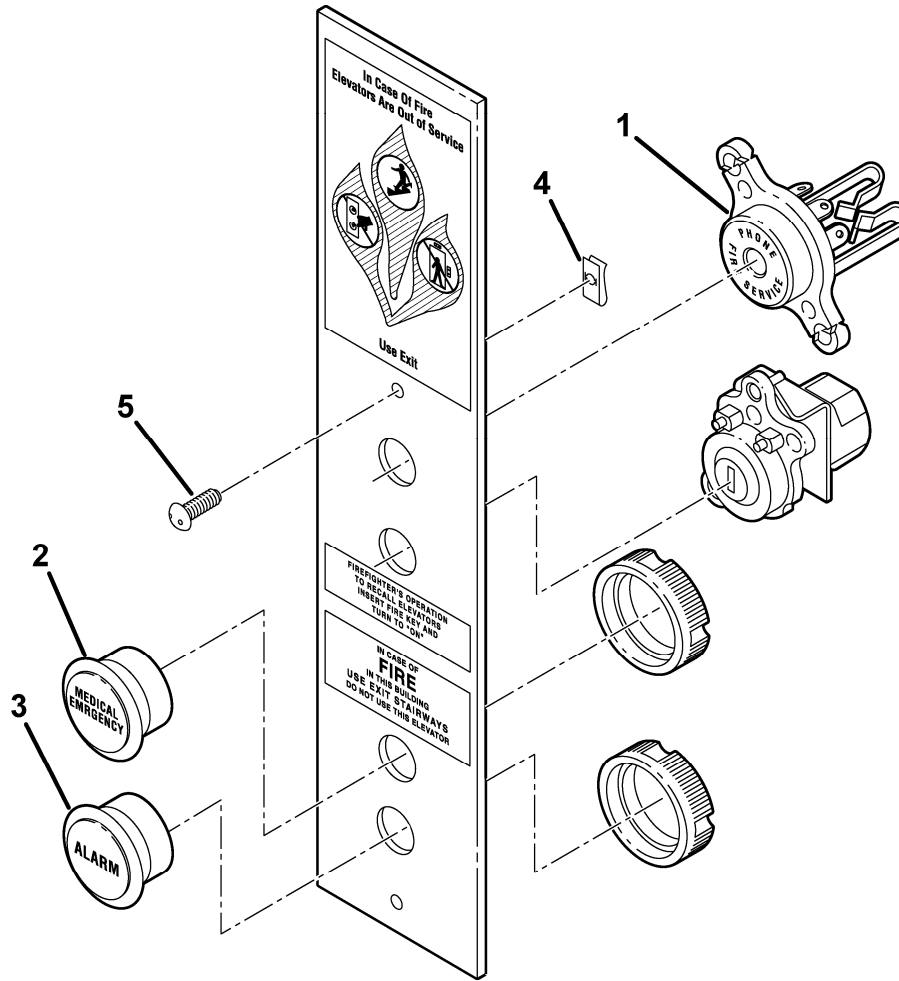

REF. NO.	PART No.	DESCRIPTION: Plate, Instruction	MATERIAL	FINISH
			AAA23500BF	
1	AAA102VB42	ANSI Flame ASME A17.1/CAN B44 2000	Stainless Steel	SS4
	AAA102VB60			MF4
	AAA102VB43		Bronze	BR7
	AAA102VB61			MF7
2	AAA102VB50	Firefighter's Instructions ANSI A17.1 Rule 211.7(a), Barclay California Code Title 8 Sec. 3041(4)	Stainless Steel	SS4
	AAA102VB68			MF4
	AAA102VB51		Bronze	BR7
	AAA102VB69			MF7
3	AAA102VB52	Massachusetts Evacuation Instructions	Stainless Steel	SS4
	AAA102VB70			MF4
	AAA102VB53		Bronze	BR7
	AAA102VB71			MF7

# Flat Hall Station Components

**32-AAA23500BE**



AAA23500BE			
REF. NO.	PART No.	DESCRIPTION	
1	AAA23500T6	Assembly, Phone Jack,  AAA270CE3, Black (for NAA)	 SPL
	AAA23500T8	Assembly, Phone Jack,  AAA270CE4, Red (for Canada)	31-AAA23500T
2	<del>AAA23500AL4-BLU-MED-EMG</del> AAA23500AL24	Jewel, Medical Emergency, 30 VDC	 SPL
	<del>AAA23500AL5-BLU-MED-EMG</del> AAA23500AL32	Jewel, Medical Emergency, 120 VAC	
3	<del>AAA23500AL6-RED-ALM</del> AAA23500AL35	Jewel, Alarm, 6 VDC	31- AAA23500AL
	<del>AAA23500AL7-RED-ALM</del> AAA23500AL37	Jewel, Alarm, 12 VDC	
4	72BX7	Nut, Speed	
5	AAA124GT1	Screw, Oval Head, Tamper Resistant, 8-32 x 0.75 in. L	Stainless Steel (SS4 Finish)
	AAA124GT2		Brass (BR7 Finish)

**Type AAA147RJ Faceplate**

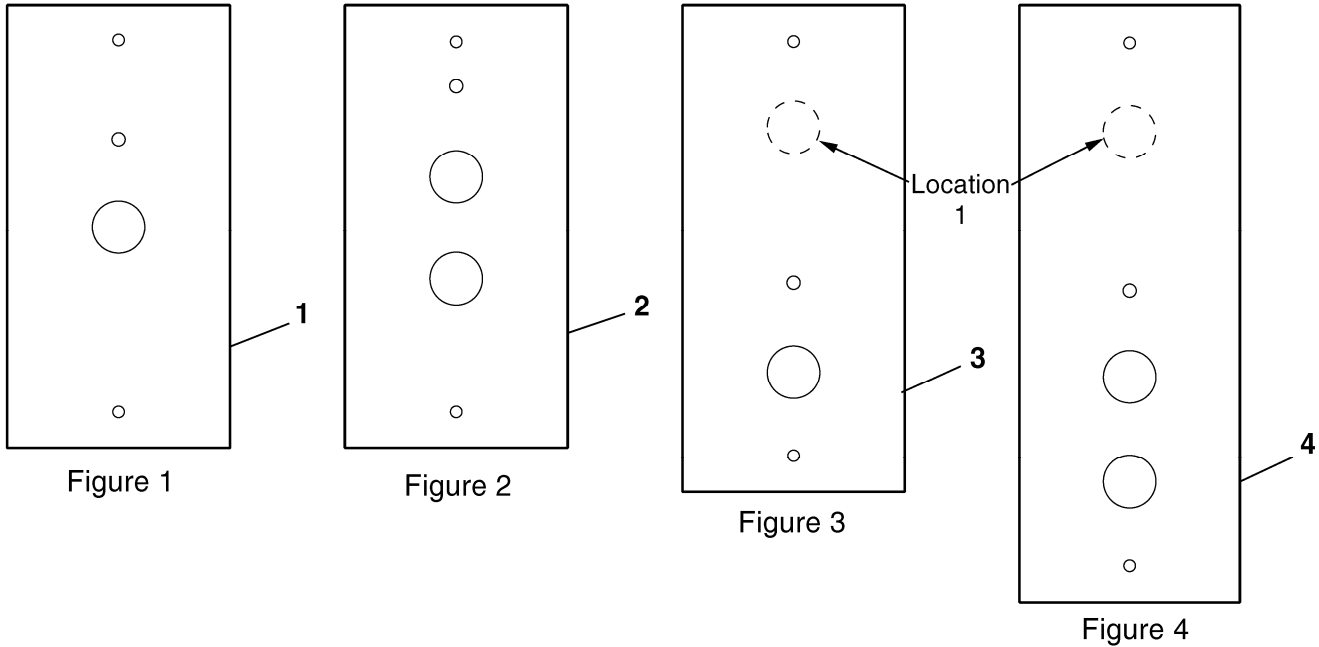

Location 1 Table

 Detail B Keyswitch Engraved Collar w/o LED	 Detail C Keyswitch Engraved Collar w/1 LED	 Detail D Keyswitch Engraved Collar w/2 LED's	 Detail E Fireman's Phone Jack
--	--	--	--------------------------------------

<b>AAA23500BE</b>					
<b>REF. NO.</b>	<b>PART No.</b>	<b>DESCRIPTION</b>	<b>FIGURE</b>	<b>LOCATION 1</b>	
1	AAA147RJ1-__*	Faceplate, Hall Station, Flat	1	---	
2	AAA147RJ2-__*		2		
3	AAA147RJ3-__*		3		B
	AAA147RJ4-__*				C
	AAA147RJ5-__*				D
	AAA147RJ6-__*				E
4	AAA147RJ7-__*		4		B
	AAA147RJ8-__*				C
	AAA147RJ9-__*				D
	AAA147RJ10-__*				E

\* When ordering, specify brushed stainless steel (SS4) or brushed bronze (BR7) material/finish e.g., AAA147RJ1-SS4.

(continued on next page)

# Type AAA147RJ Faceplate

**32-AAA23500BE**

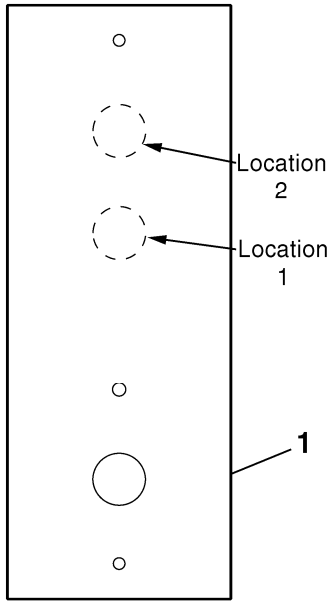
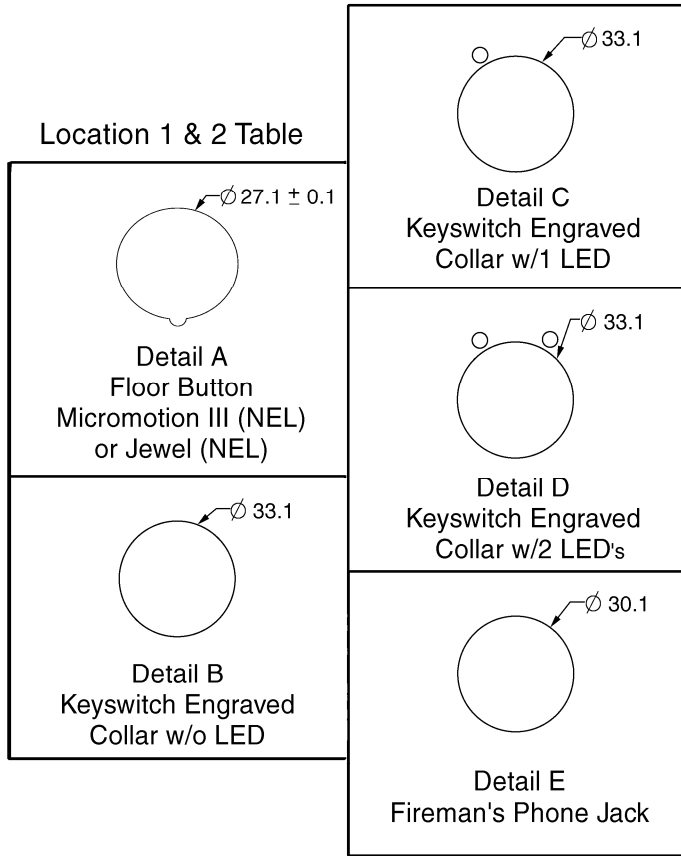

Figure 5



<b>AAA23500BE</b>					
REF. NO.	PART No.	DESCRIPTION	FIGURE	LOCATION 1	LOCATION 2
1	AAA147RJ11-__*	Faceplate, Hall Station, Flat	5	B	B
	AAA147RJ12-__*				C
	AAA147RJ13-__*				E
	AAA147RJ14-__*				A
	AAA147RJ15-__*			C	B
	AAA147RJ16-__*				C
	AAA147RJ17-__*				E
	AAA147RJ18-__*			D	B
	AAA147RJ19-__*				C
	AAA147RJ20-__*				E

\* When ordering, specify brushed stainless steel (SS4) or brushed bronze (BR7) material/finish. e.g. AAA147RJ1-SS4

(continued on next page)

# Type AAA147RJ Faceplate

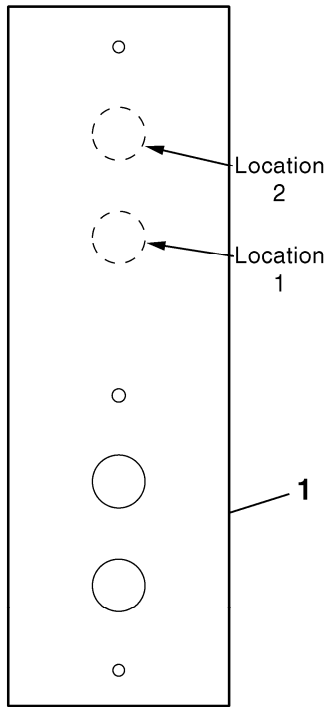
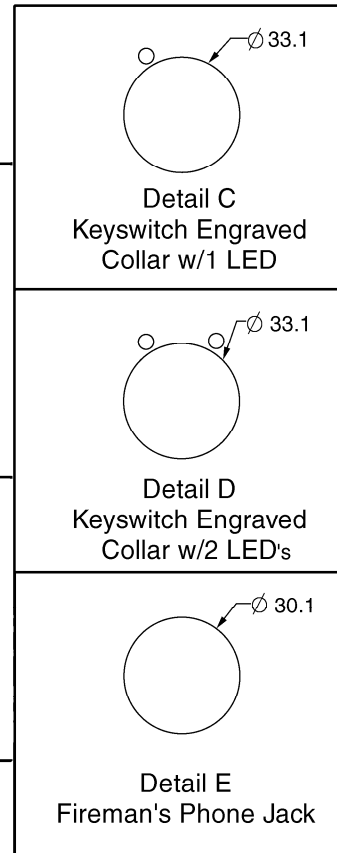
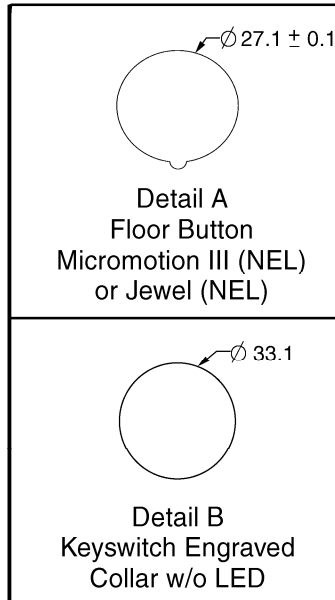

Figure 6

Location 1 & 2 Table



AAA23500BE					
REF. NO.	PART No.	DESCRIPTION	FIGURE	LOCATION 1	LOCATION 2
1	AAA147RJ21-__*	Faceplate, Hall Station, Flat	6	B	B
	AAA147RJ22-__*				C
	AAA147RJ23-__*				E
	AAA147RJ24-__*				A
	AAA147RJ25-__*			C	B
	AAA147RJ26-__*				C
	AAA147RJ27-__*				E
	AAA147RJ28-__*			D	B
	AAA147RJ29-__*				C
	AAA147RJ30-__*				E

\* When ordering, specify brushed stainless steel (SS4) or brushed bronze (BR7) material/finish. e.g. AAA147RJ1-SS4

(Continued on next page)



# Type AAA147RJ Faceplate

**32-AAA23500BE**

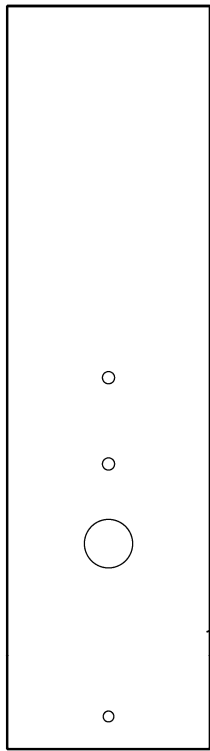

Figure 7

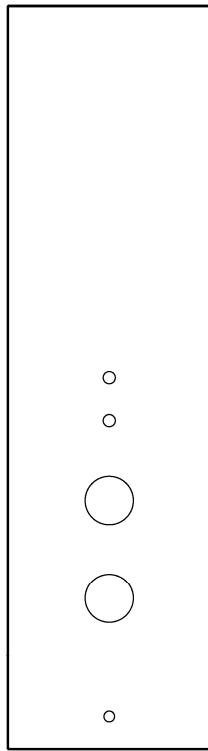

Figure 8

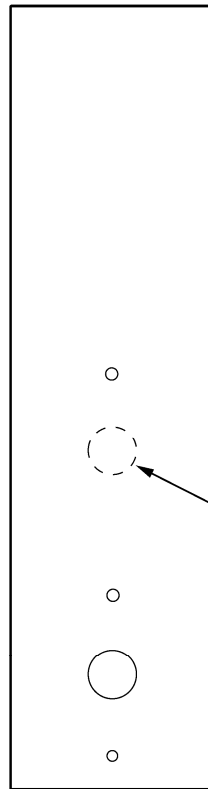

Figure 9

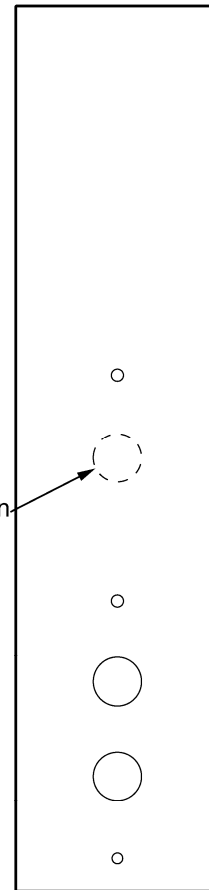
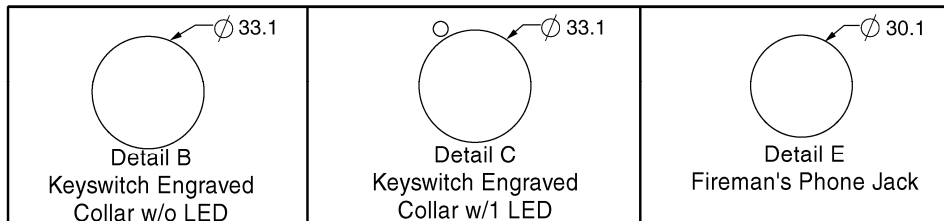

Figure 10

Location 1 Table



AAA23500BE		DESCRIPTION	FIGURE	LOCATION 1	
REF. NO.	PART No.				
1	AAA147RJ31-__*	Faceplate, Hall Station, Flat	7	---	
2	AAA147RJ32-__*		8		
3	AAA147RJ33-__*		9		B
	AAA147RJ34-__*				C
	AAA147RJ35-__*				E
4	AAA147RJ36-__*		10		B
	AAA147RJ37-__*				C
	AAA147RJ38-__*				E

\* When ordering, specify brushed stainless steel (SS4) or brushed bronze (BR7) material/finish.  
e.g. AAA147RJ1-SS4

(Continued on next page)

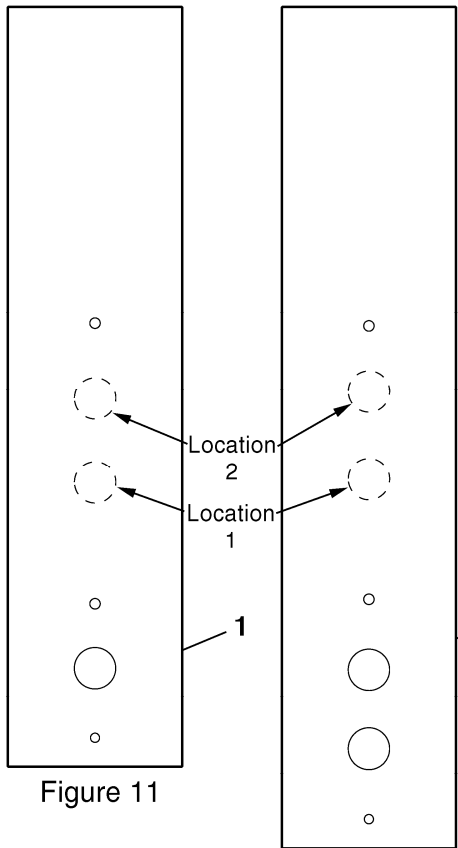

Figure 11

Figure 12

Location 1 & 2 Table

<p>Detail A Floor Button Micromotion III (NEL) or Jewel (NEL)</p>	<p>Detail C Keyswitch Engraved Collar w/1 LED</p>
<p>Detail B Keyswitch Engraved Collar w/o LED</p>	<p>Detail E Fireman's Phone Jack</p>

AAA23500BE						
REF. NO.	PART No.	DESCRIPTION	FIGURE	LOCATION 1	LOCATION 2	
1	AAA147RJ39-__*	Faceplate, Hall Station, Flat	11	B	B	
	AAA147RJ40-__*				C	
	AAA147RJ41-__*				E	
	AAA147RJ42-__*				C	A
	AAA147RJ43-__*			B		
	AAA147RJ44-__*			C		
	AAA147RJ45-__*			E		
2	AAA147RJ46-__*		12	B	B	
	AAA147RJ47-__*				C	
	AAA147RJ48-__*				E	
	AAA147RJ49-__*				C	A
	AAA147RJ50-__*			B		
	AAA147RJ51-__*			C		
	AAA147RJ52-__*			E		

\* When ordering, specify brushed stainless steel (SS4) or brushed bronze (BR7) material/finish.  
e.g. AAA147RJ1-SS4