

**NGH Passenger Interface,
CompassPlus® Fixture Refresh
Angle Mount Touch Pad**

**Spare Parts Leaflet
32-DAA23503A**

June 19, 2024 / Page 1 of 4

32 R-DAA23503A

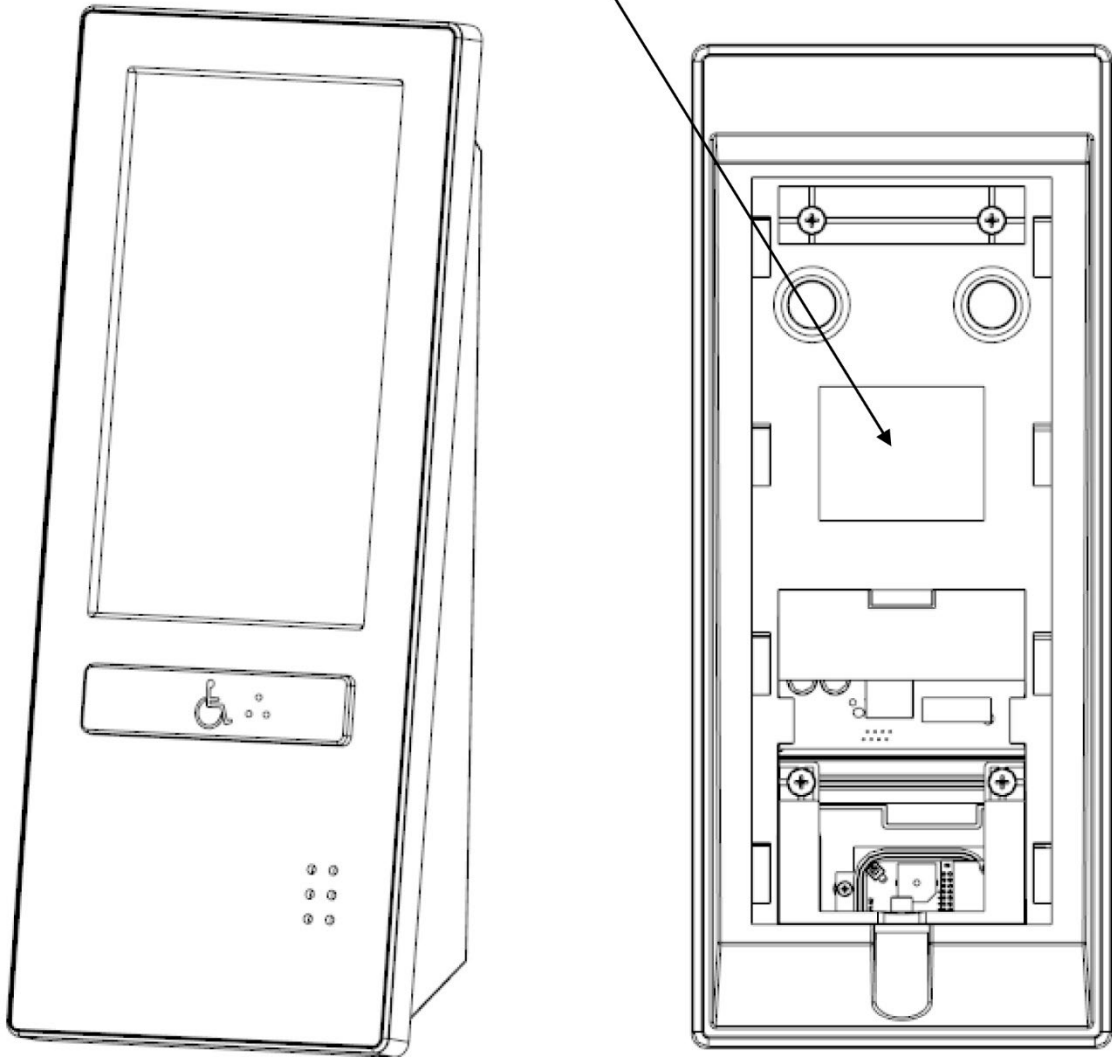

OTIS

This document does not contain any technical data subject to EAR or ITAR

**SERVICE ENGINEERING
Otis Elevator Company
ESSI, SHANGHAI**

Unpublished Work—© Otis Elevator Co.; 2024

History

32-DAA23503A

Leaflet Description

This leaflet summarizes the CompassPlus Refresh Fixture Destination Entry Computer (DEC) touchpad.

Leaflet Revisions

Date Revised	Subject Matter Expert	Reason for Revision
28-June-2017	Dengshuai Li	New SPL
31-Aug-2017	Dengshuai Li	Delete third page, removed the RFID logo
June 19, 2024	Vadzim Fedarenka	Added images with mounting dimensions on p. 3.

Related Drawings

Drawing No.	Title	Drawing No.	Title
DAA23503C	Compass Plus Refresh Fixture Flush Mount Touch Pad	AAA29000AG	NGH Passenger Interface, System Level
DAA23503D	Compass Plus Refresh Fixture Flush Mount Touch Screen	AAA25300AK	Compass controller

Related Documents

Document ID	Title
SPL 40-AAA29000AG	System Level SPL Compass Destination Dispatching
SPL 10-AAA25300AK	Compass Controller
DAA23503A_FMI	Compass Plus Refresh Fixture Angle Mount Touch Pad FMI

Subject Matter Expert

Name	Department
Dengshuai Li	ESSI, Shanghai, China

About Spare Parts Leaflets...

This document lists the lowest replaceable units (LRUs) for the standard version of the product. The LRUs are chosen by a team of Otis associates representing engineering and manufacturing.

While goal of this document is to make parts identification as easy as possible, the document cannot be all-inclusive. Elevator and escalator contracts classified as "special" or "custom" are not addressed here. For such contracts, please refer to specified information, the contract folder, TIPs, Field Education Articles, Construction Letters, etc. for further information.

If you have any suggestions about this document, please contact the subject matter expert listed on this page.

Touch Pad

32-DAA23503A

Numbering system (only for OSC & Berlin SSI):

DAA23503A * * * — * — * — *

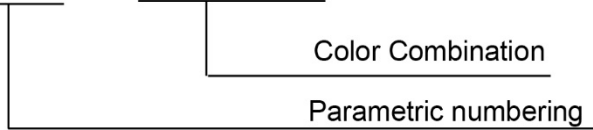

NOTE:

- When ordering replace the asterisks (*) referenced in each part number with the appropriate character from table 1.

Table 1

Base Part Number	Parametric Numbering				Color Combination				
DAA23503A	***				—	*—*—*			
Parameter Description	***	RFID	ADA Type (NOTE 1)	Mounting Type (NOTE 2)	*—*—*	DEFAPC (NOTE 3)	DEADAC (NOTE 4)	DEFRCC (NOTE 5)	
VALUE	999	YES	BACKL	WALLNA	1—1—1	BLACK	BLACK	BLACK	
	998	YES	BACKL	WALLPED	1—1—2	BLACK	BLACK	SILVER	
	997	YES	NOBACKL	WALLNA	1—1—3	BLACK	BLACK	GOLD	
	996	YES	NOBACKL	WALLPED	2—2—2	SILVER	SILVER	SILVER	
	995	YES	SANFR	WALLNA	2—2—1	SILVER	SILVER	BLACK	
	994	YES	SANFR	WALLPED	3—3—3	GOLD	GOLD	GOLD	
	993	NO	BACKL	WALLNA	3—3—1	GOLD	GOLD	BLACK	
	992	NO	BACKL	WALLPED	4—2—2	WHITE	SILVER	SILVER	
	991	NO	NOBACKL	WALLNA	1—2—2	BLACK	SILVER	SILVER	
	990	NO	NOBACKL	WALLPED	2—1—2	SILVER	BLACK	SILVER	
	989	NO	SANFR	WALLNA	3—1—3	GOLD	BLACK	GOLD	
	988	NO	SANFR	WALLPED	2—1—1	SILVER	BLACK	BLACK	
						4—1—1	WHITE	BLACK	BLACK

NOTES:

- BACKL means with backlight, NOBACKL means without backlight, SANFR means San Francisco style button.
- WALLPED means “A” type mounting plate (with conduit fitting), WALLNA means “C” type mounting plate (with slotted). The difference between “C” type and “A” type see the picture on page 4.
- DEFAPC: Faceplate glass color.
- DEADAC: ADA button color.
- DEFRCC: Front cover trim color.

Example1: DAA23503A999—1—1—1 means this fixture type is Touch Pad, with “RFID reader”, with “backlight”, with “WALLNA” (“A” type mounting plate), Faceplate glass color is black, ADA button color is black, Front cover trim color is black.

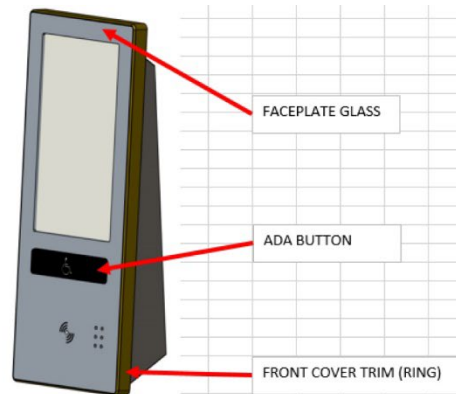
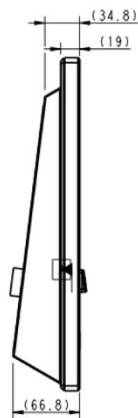
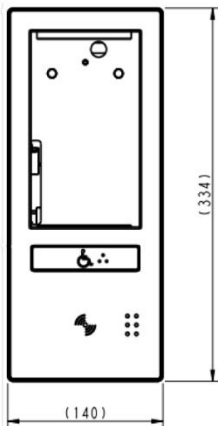

Touch Pad

32-DAA23503A

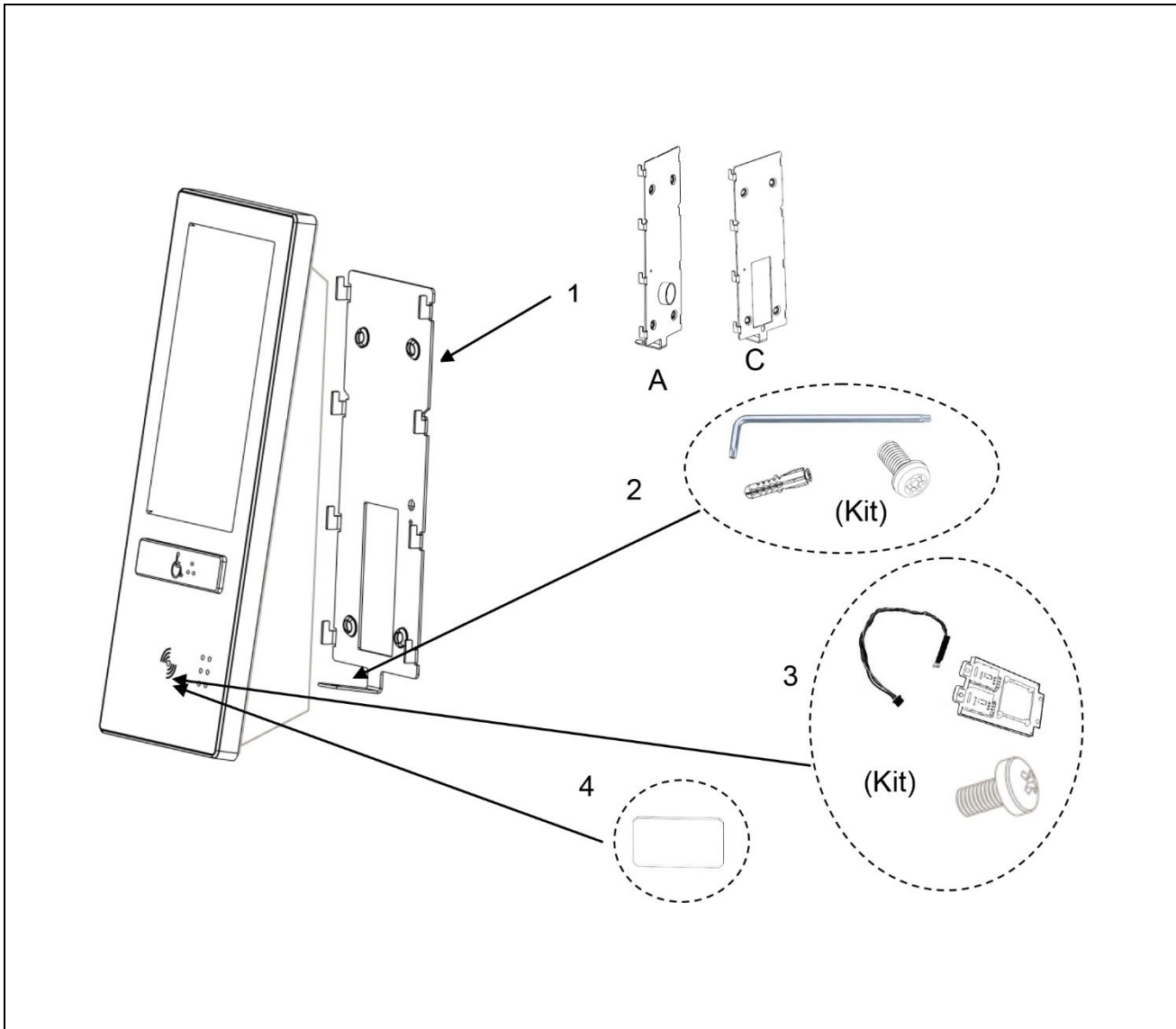

DAA23503A			
REF. No.	PART No.	DESCRIPTION	Remark
1	DAA316EMV999	Wall Mounting Plate-A (NAA type wall mount) w/ conduit mount	
	DAA316EMV998	Wall Mounting Plate-C (with slot)	
2	DAA23851C1	Tamper-Proof Screw & Expansion Screws & Tool	👁 Note1
3	DAA23851D1	RFID Reader & Cable & Screw	👁 Note2
4	HAA429T1	Lining	👁 Note3

NOTES:

1. Kit = Tamper proof screw & expansion screws & tool.
2. Kit = RFID reader PCB & cable & (4) M2.5x5 pan head screws.
3. The lining is only needed for black, silver, and gold glass (if silver and gold glass have clear logo). It is not needed for white glass.