

Escalator Operating Panel, Button Fixture

Spare Parts Leaflet

32-GO6533H

December 14, 2006 / Page 1 of 3

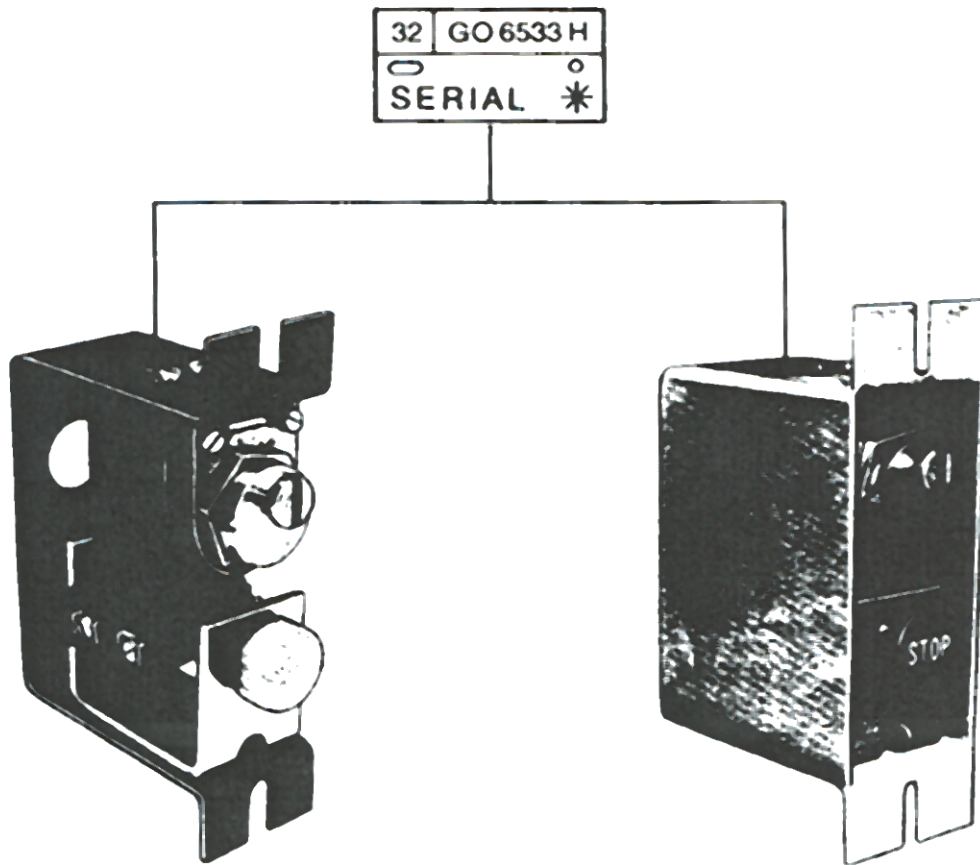

OTIS

Safety First!

SERVICE ENGINEERING

Otis Elevator Company

Bloomfield, Connecticut USA

Leaflet Description

The leaflet describes the LRUs (lowest replaceable parts) for an escalator button fixture

Leaflet Revisions

Date Revised	Subject Matter Expert	Reason for Revision
February 1976	Stadhagen Germany	New SPL
December 14, 2006	Tom Charney	Publication of SPL in NSAA

Related Drawings

Drawing No.	Title	Drawing No.	Title
GO6533H	---		

Related Documents

Document ID	Title
---	---

Subject Matter Expert

Name	Department
Tom Charney	OSC Service Engineering

About Spare Parts Leaflets...

This document lists the lowest replaceable units (LRUs) for the standard version of the product. The LRUs are chosen by a team of Otis associates representing engineering and manufacturing.

While goal of this document is to make parts identification as easy as possible, the document cannot be all-inclusive. Elevator and escalator contracts classified as "special" or "custom" are not addressed here. For such contracts, please refer to specified information, the contract folder, TIPs, Field Education Articles, Construction Letters, etc. for further information.

If you have any suggestions about this document, please contact the subject matter expert listed on this page.

Type GO6533H Button Fixture

32-GO6533H

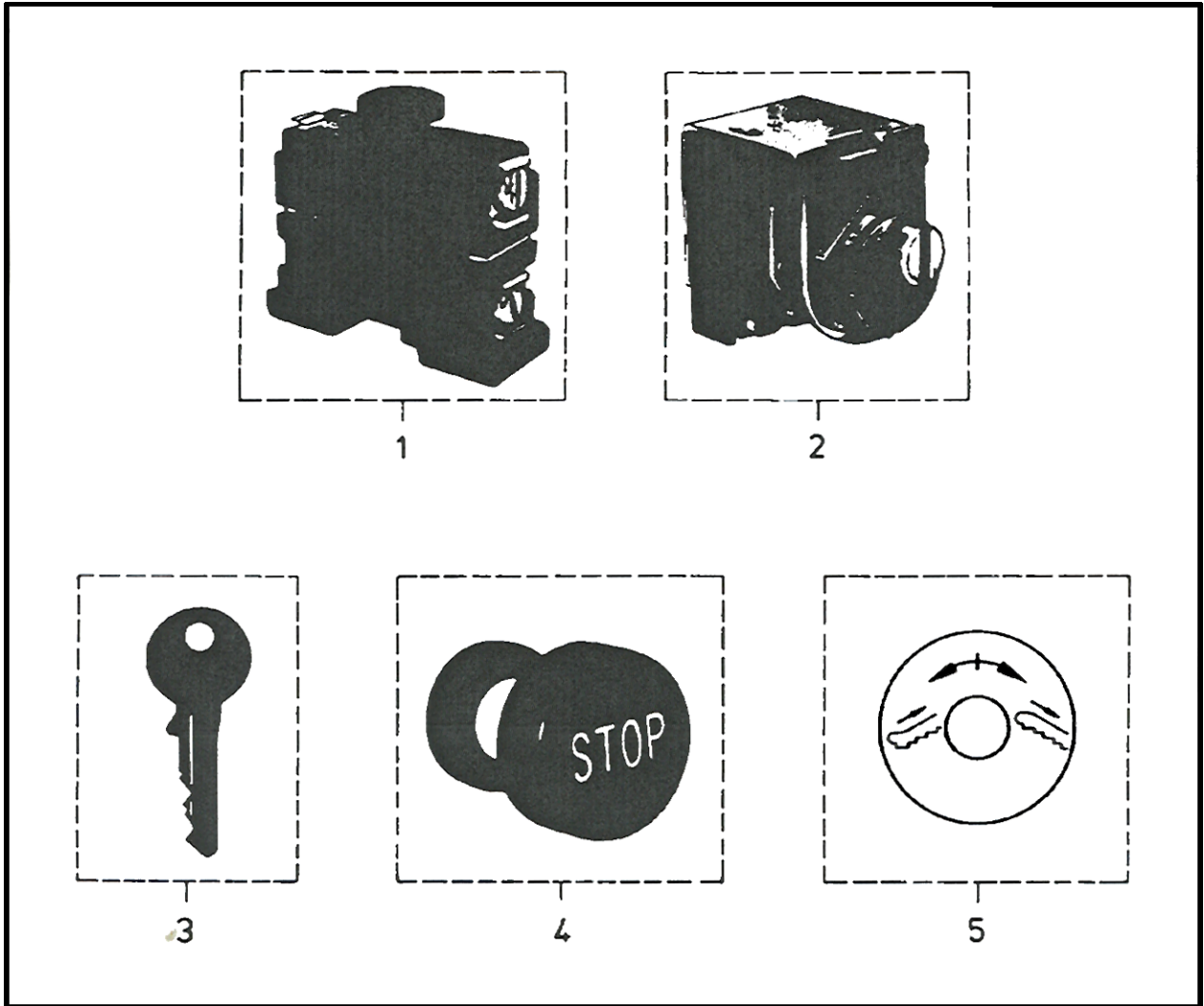

SERIAL G. 01		
REF. No.	PART No.	DESCRIPTION
1	7035A8	Unit, Break Making, Push Button
2	GX6410E6	Contact, Key Operated
3	GO194C1	Key
4	323BD7	Push Button, Red, Marked: STOP
5	GO102LD1	Self Adhesive Label