

Escalator 513 NPE
Opaque Main Drive

Spare Parts Leaflet

51-G..26170H

January 2000 / Page 1 of 5

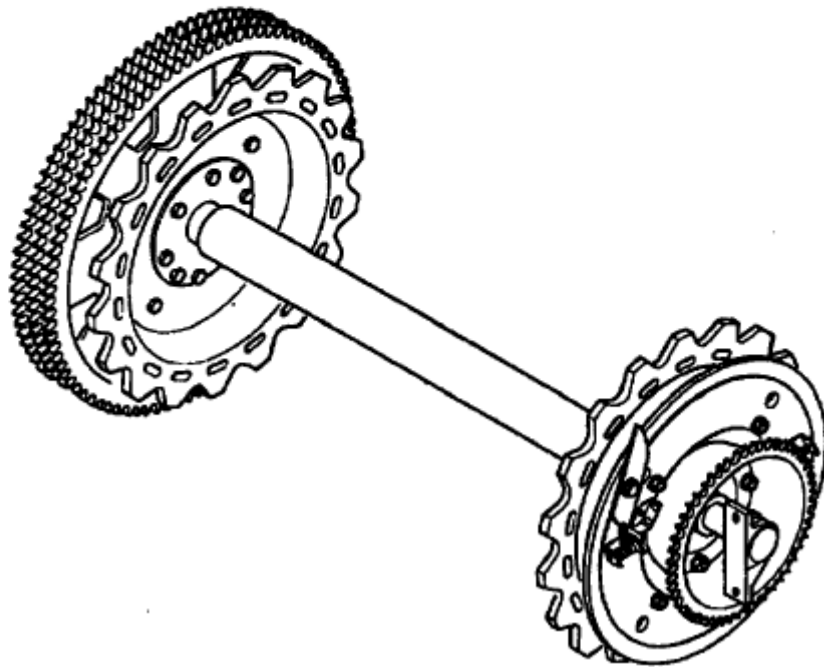

OTIS

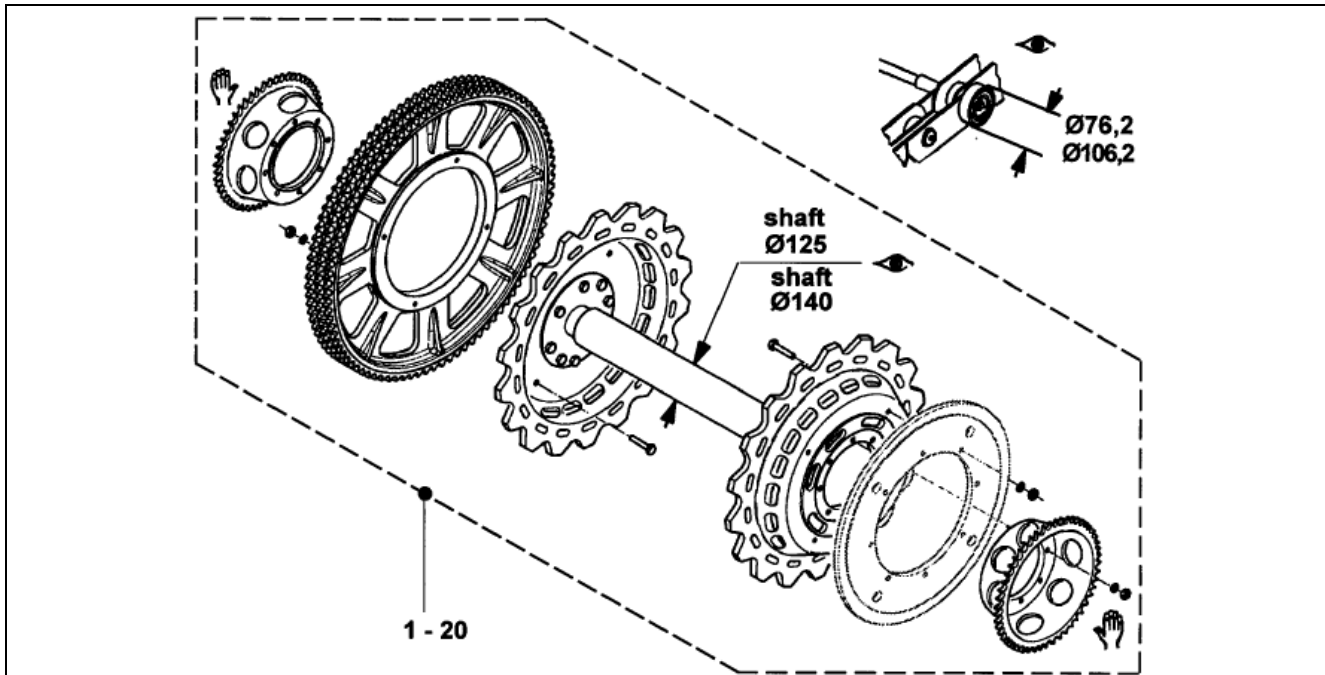

| GAA26170H | | | | |
|-----------|-------------|-------------------------------|--------|---------|
| REF. No. | PART No. | DESCRIPTION | | |
| 1 | GAA26170H1 | Main drive, Type 600 Ø 76,2 | indoor | |
| 2 | GAA26170H2 | Main drive, Type 600 Ø 106,2 | | |
| 3 | GAA26170H3 | Main drive, Type 800 Ø 76,2 | | |
| 4 | GAA26170H4 | Main drive, Type 800 Ø 106,2 | | |
| 5 | GAA26170H5 | Main drive, Type 1000 Ø 76,2 | | |
| 6 | GAA26170H6 | Main drive, Type 1000 Ø 106,2 | | |
| 7 | GAA26170H7 | Main drive, Type 600 Ø 76,2 | | Ø 125 |
| 8 | GAA26170H8 | Main drive, Type 600 Ø 106,2 | | |
| 9 | GAA26170H9 | Main drive, Type 800 Ø 76,2 | | outdoor |
| 10 | GAA26170H10 | Main drive, Type 800 Ø 106,2 | | |
| 11 | GAA26170H11 | Main drive, Type 1000 Ø 76,2 | indoor | |
| 12 | GAA26170H12 | Main drive, Type 1000 Ø 106,2 | | |
| 13 | GAA26170H13 | Main drive, Type 800 Ø 76,2 | | |
| 14 | GAA26170H14 | Main drive, Type 800 Ø 106,2 | | |
| 15 | GAA26170H15 | Main drive, Type 1000 Ø 76,2 | | |
| 16 | GAA26170H16 | Main drive, Type 1000 Ø 106,2 | | shaft |
| 17 | GAA26170H17 | Main drive, Type 800 Ø 76,2 | | Ø 140 |
| 18 | GAA26170H18 | Main drive, Type 800 Ø 106,2 | | |
| 19 | GAA26170H19 | Main drive, Type 1000 Ø 76,2 | | outdoor |
| 20 | GAA26170H20 | Main drive, Type 1000 Ø 106,2 | | |

w/o Brake



only for

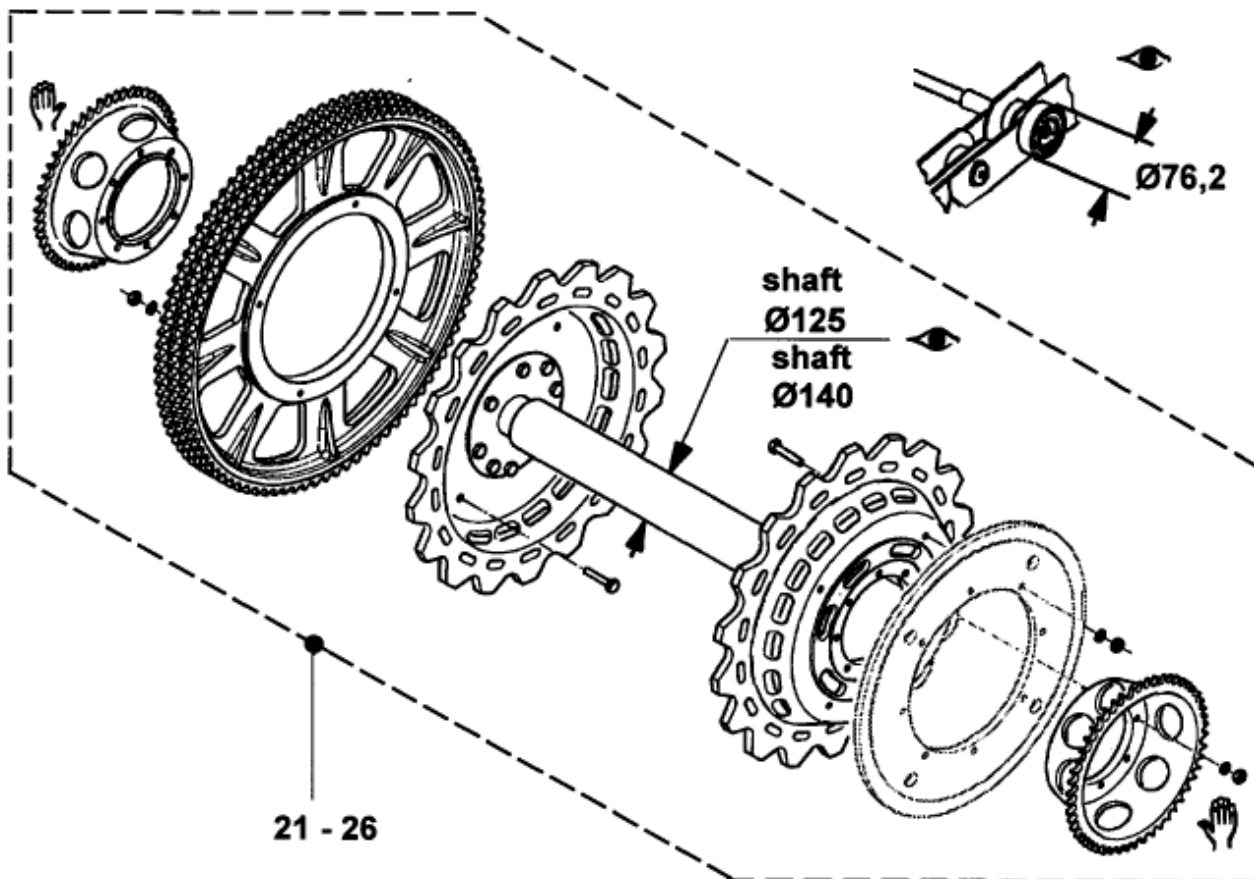

| GAA26170H | | DESCRIPTION | | | |
|-----------|-------------|------------------------------|---------|-------|---------------|
| REF. No. | PART No. | | | | |
| 21 | GAA26170H21 | Main drive, Type 800 Ø 76,2 | indoor | shaft | w/o Brake |
| 22 | GAA26170H22 | Main drive, Type 1000 Ø 76,2 | | | |
| 23 | GAA26170H23 | Main drive, Type 800 Ø 76,2 | outdoor | Ø 125 | |
| 24 | GAA26170H24 | Main drive, Type 1000 Ø 76,2 | | | |
| 25 | GAA26170H25 | Main drive, Type 800 Ø 76,2 | indoor | shaft | |
| 26 | GAA26170H26 | Main drive, Type 1000 Ø 76,2 | outdoor | Ø 140 | |

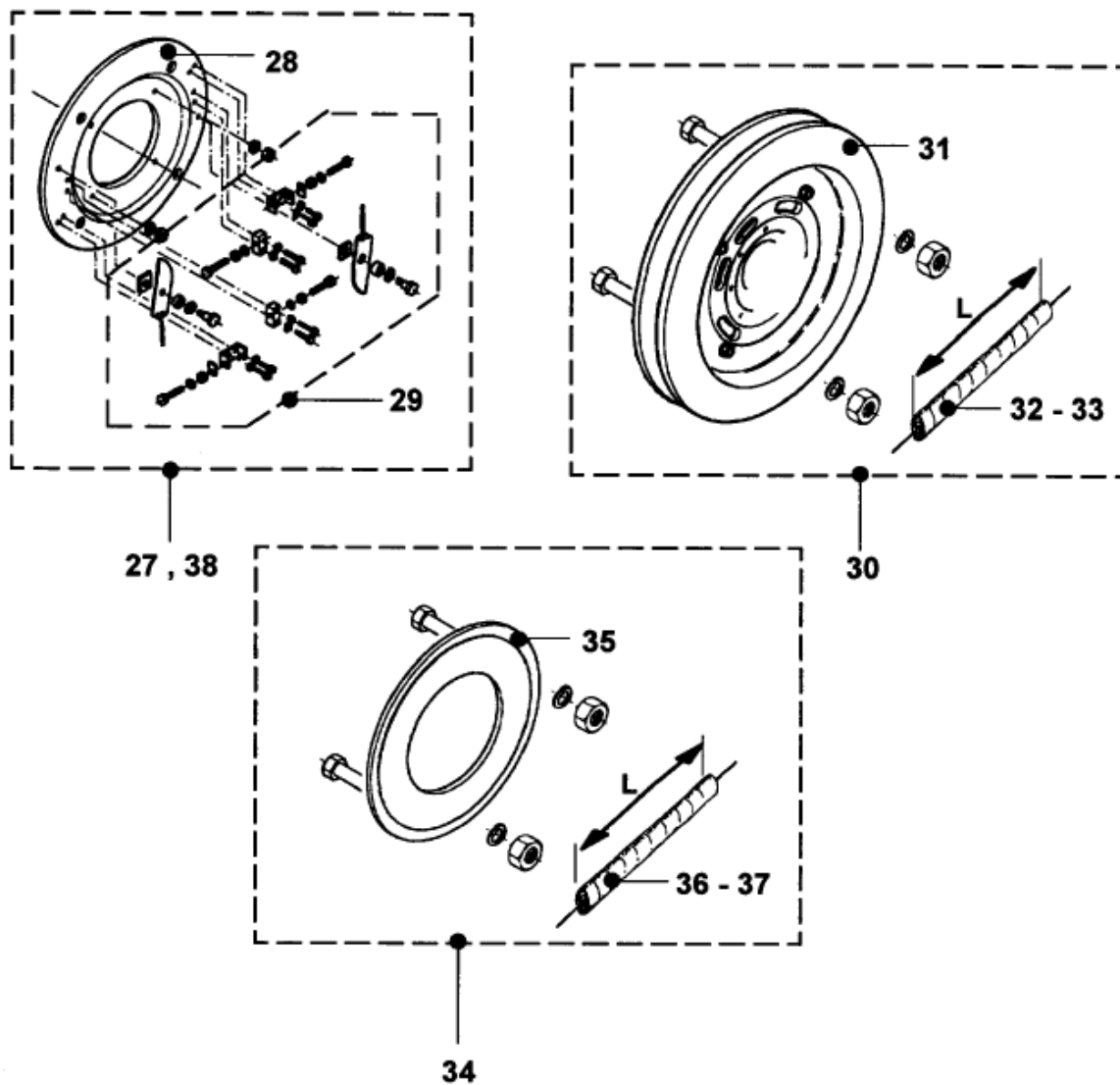

| GAA26170H | | |
|-----------|-------------|--|
| REF. No. | PART No. | DESCRIPTION |
| 27 | GAA26170H52 | Set: fitting parts for wedge brake |
| 28 | GO196R1 | Brake pulley, Wedge Type, also for REGION NAA |
| 29 | GO2215H12 | Set: Brake lever, ALL: EXCEPT NAA |
| 30 | GAA26170H51 | Set: fitting parts for caliper brake |
| 31 | GO196T1 | Brake pulley, caliper type |
| 32 | GAA33AG1 | Seal, L = 1900 |
| 33 | GAA33AG2 | Seal, L = 1200 |
| 34 | GAA26170H53 | Set: fitting parts for hydraulic brake |
| 35 | GAA196AT3 | Brake pulley, Hydraulic Type |
| 36 | GAA33AG6 | Seal, L = 1750 |
| 37 | GAA33AG2 | Seal, L = 1200 |
| 38 | GAA26170H61 | Set: fitting parts for wedge brake, for REGION NAA |

also for  NAA

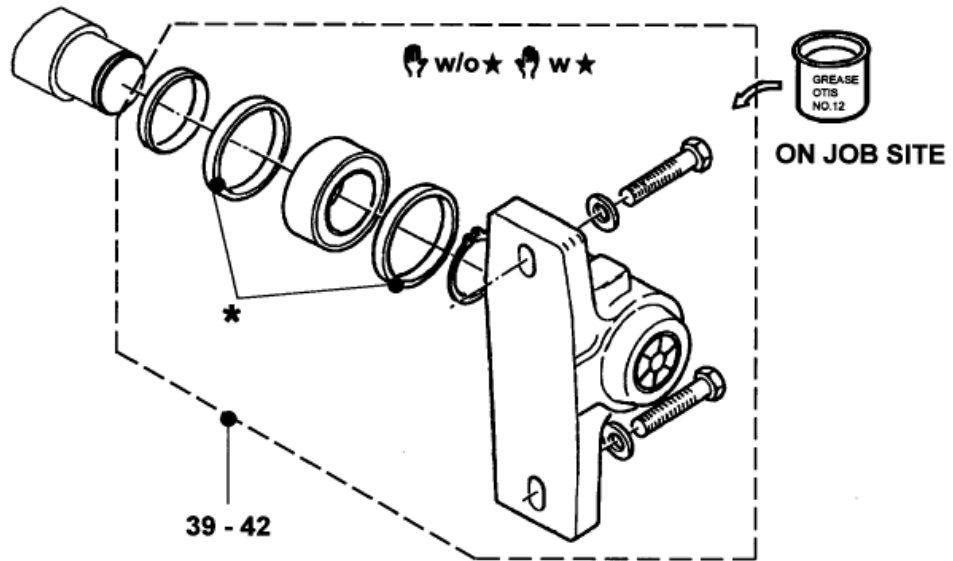
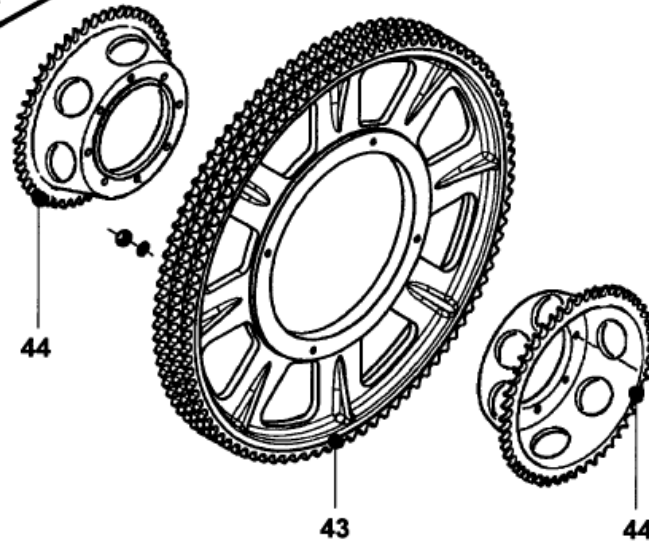

| GAA26170H | | DESCRIPTION | | | |
|-----------|--------------|------------------------------|-----------------------|----------------|------------|
| REF. No. | PART No. | | | | |
| 39 | GO2215H18 ★ | Set: Stand, moveable bearing | Ref. No. 1-12, 21-24 | shaft ∅ 125 | (GO472BA2) |
| 40 | GO2215H19 ★ | Set: Stand, fixed bearing | | | (GO472BA1) |
| 41 | GO2215H23 ★ | Set: Stand, moveable bearing | Ref. No. 13-20, 25-26 | shaft ∅ 140 | (GO472BA5) |
| 42 | GO2215H24 ★ | Set: Stand, fixed bearing | | | (GO472BA6) |
| 43 | GAA195NB11 ★ | Sprocket, triplex | | | |
| 44 | GO195JH1 ★ | Sprocket | | | |