

Escalator 513 NPE/SR  
Main Drive

Spare Parts Leaflet

51-G..26170N

January 2000 / Page 1 of 5

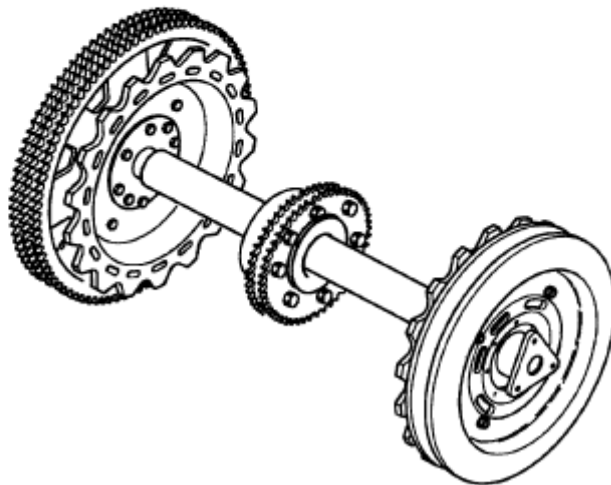

**OTIS**

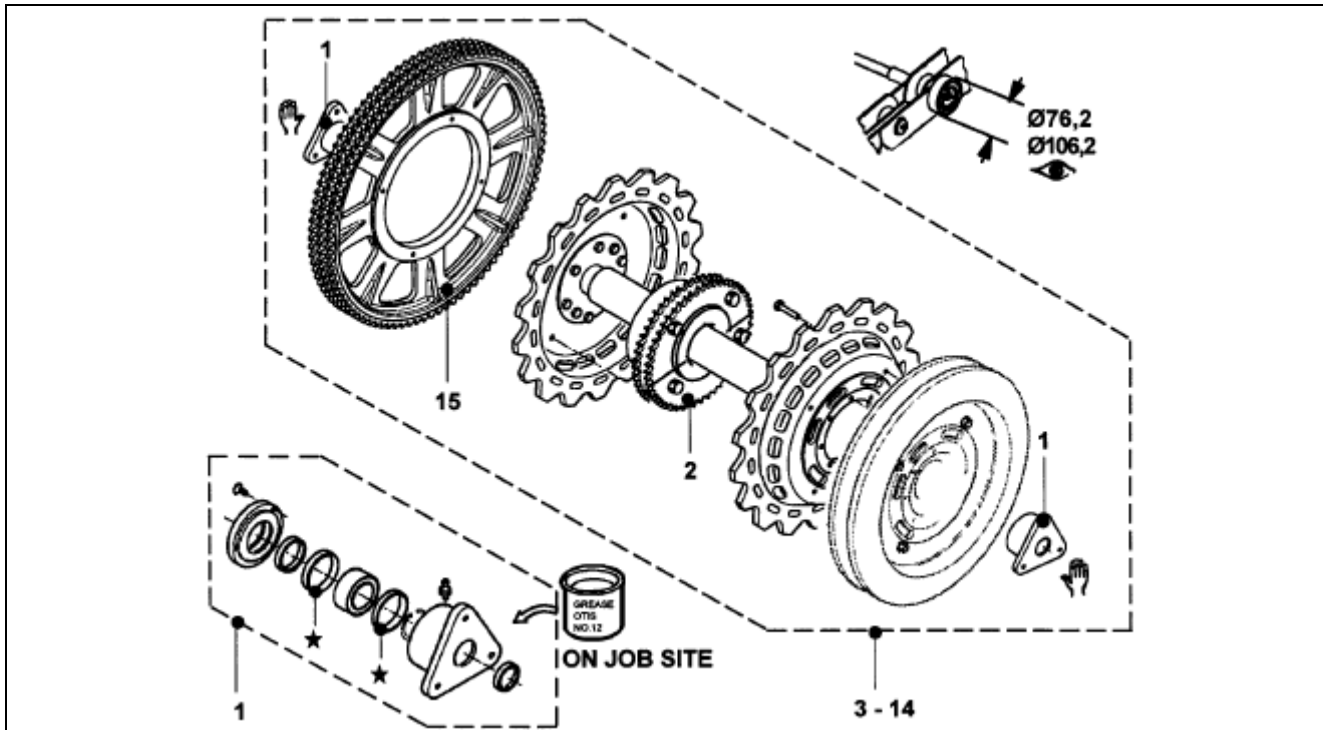

GAA26170N				
REF. No.	PART No.	DESCRIPTION	TYPE	
1	GAA2215H14 ★	Set: Stand, fixed bearing	w ★	
		Set: Stand, moveable bearing	w/o ★	
2	GAA195NH1	Sprocket, divided	replacement	
3	GAA26170N1	Main drive, Type 600 ∅ 76,2	indoor  w/o Brake	
4	GAA26170N2	Main drive, Type 600 ∅ 106,2		
5	GAA26170N3	Main drive, Type 800 ∅ 76,2		
6	GAA26170N4	Main drive, Type 800 ∅ 106,2		
7	GAA26170N5	Main drive, Type 1000 ∅ 76,2		
8	GAA26170N6	Main drive, Type 1000 ∅ 106,2		
9	GAA26170N7	Main drive, Type 600 ∅ 76,2		outdoor  Brake
10	GAA26170N8	Main drive, Type 600 ∅ 106,2		
11	GAA26170N9	Main drive, Type 800 ∅ 76,2		
12	GAA26170N10	Main drive, Type 800 ∅ 106,2		
13	GAA26170N11	Main drive, Type 1000 ∅ 76,2		
14	GAA26170N12	Main drive, Type 1000 ∅ 106,2		
15	GAA195NB11	Sprocket, triplex		

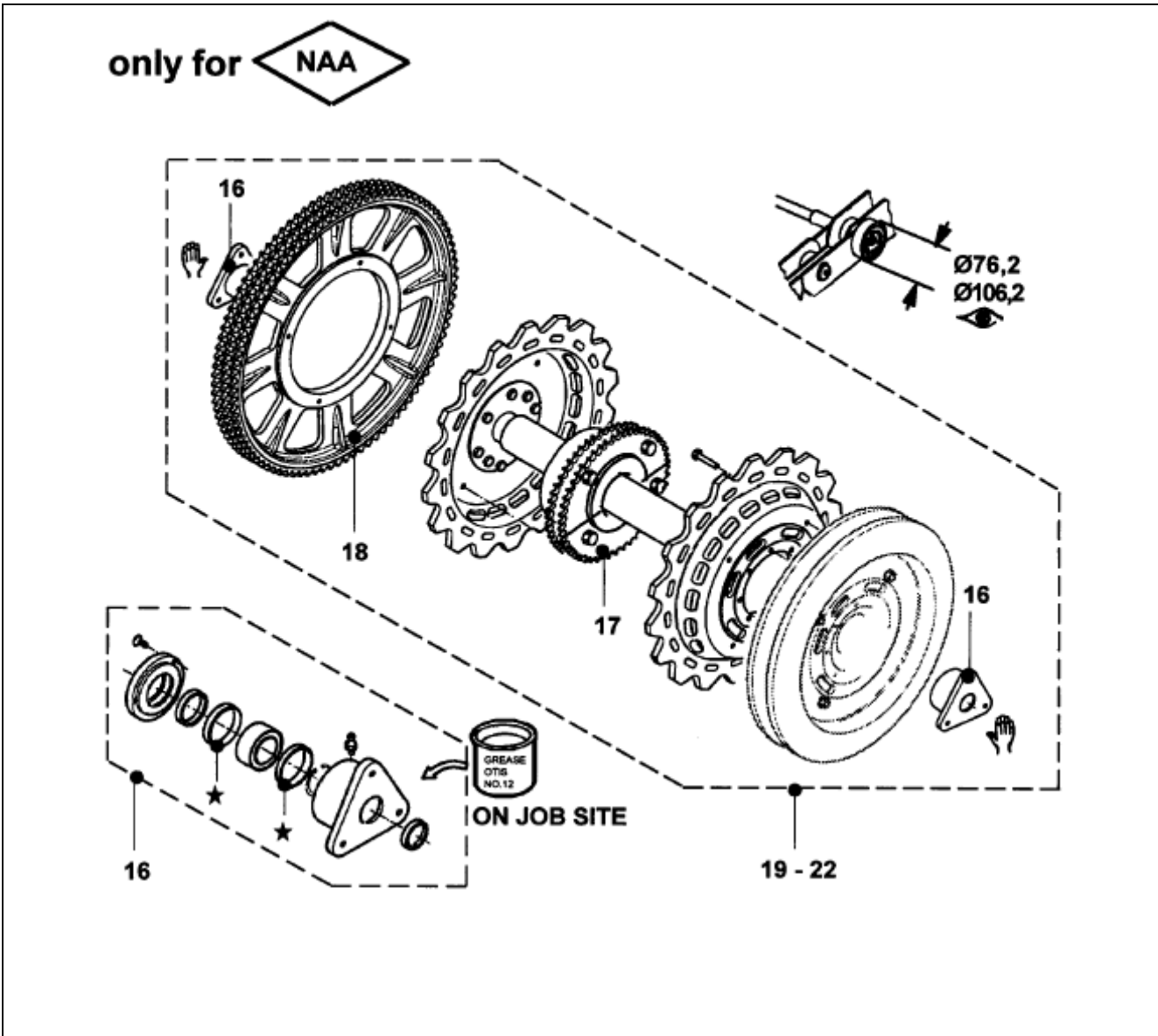

GAA26170N			
REF. No.	PART No.	DESCRIPTION	
16	GO2215H14 ★	Set: Stand, fixed bearing  w ★	
		Set: Stand, moveable Bearing  w/o ★	
17	GAA195NH1	Sprocket, divided <b>replacement</b>	
18	GAA195NB11	Sprocket, triplex	
19	GAA26170N21	Main drive, Type 800, Ø 76,2, indoor	w/o Brake  <b>Brake</b>
20	GAA26170N22	Main drive, Type 1000, Ø 76,2, indoor	
21	GAA26170N23	Main drive, Type 800, Ø 76,2, outdoor	
22	GAA26170N24	Main drive, Type 1000, Ø 76,2, outdoor	

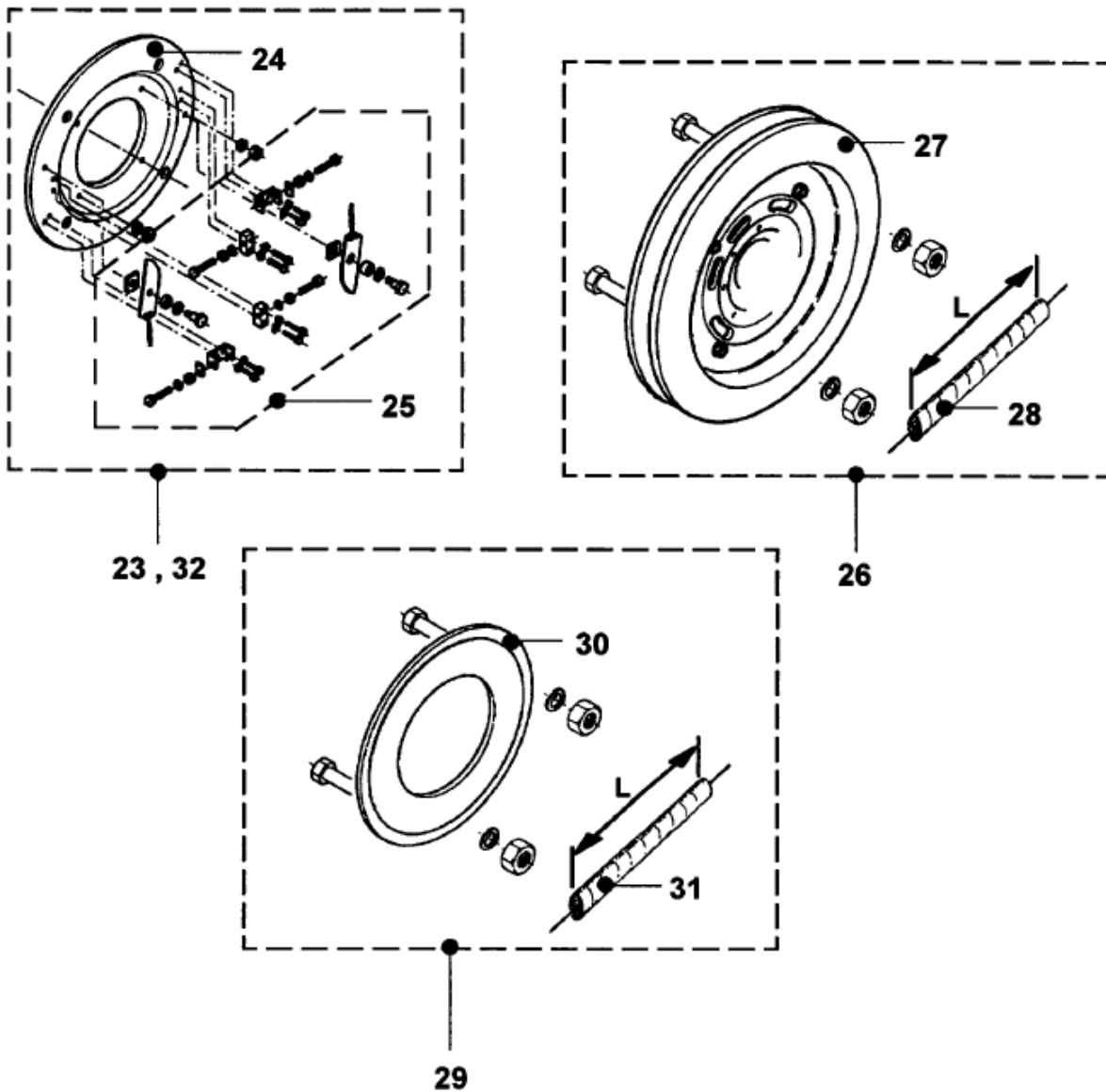

GAA26170N		
REF. No.	PART No.	DESCRIPTION
23	GAA26170N52	Set: fitting parts for wedge brake
24	GO196R1	Brake Pulley, Wedge Type, also for REGION NAA
25	GO2215H12	Set: Brake lever, ALL; EXCEPT NAA
26	GAA26170N51	Set: fitting parts for caliper brake
27	GO196AD1	Brake pulley, Caliper Type
28	GO196AG1	Seal, L = 1900
29	GAA26170N53	Set: fitting parts for hydraulic brake
30	GAA196AT3	Brake Pulley, Hydraulic Type
31	GAA33AG6	Seal, L = 1750
32	GAA26170N61	Set: fitting parts for wedge brake, for REGION NAA

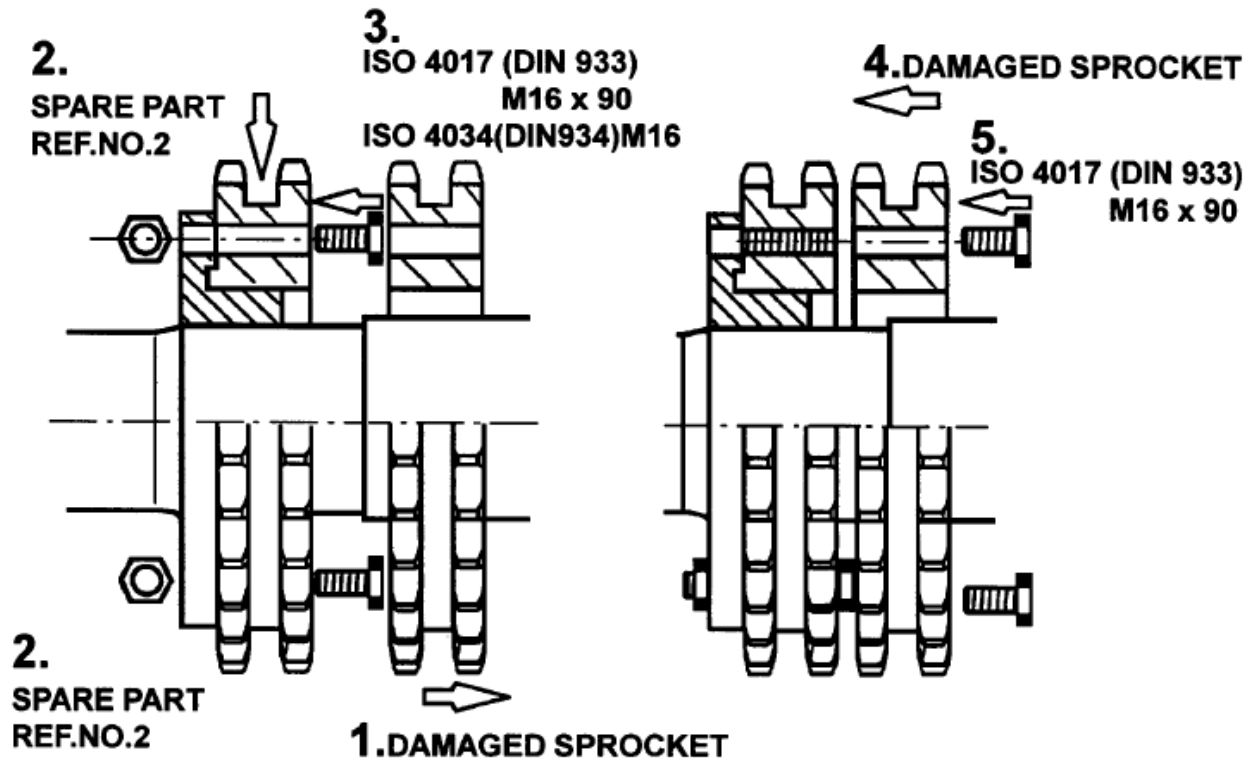

GAA26170N		
REF. No.	PART No.	DESCRIPTION