

OBSOLESCENCE NOTICE

The product covered in this SPL has been designated as obsolete and is no longer supported. See TIP 32.2-1, *Obsolete Components*, for potential upgrade. Replacement lower-level parts listed within and unique to this design will be reviewed for obsolescence.

6

June, 1984

Page 1

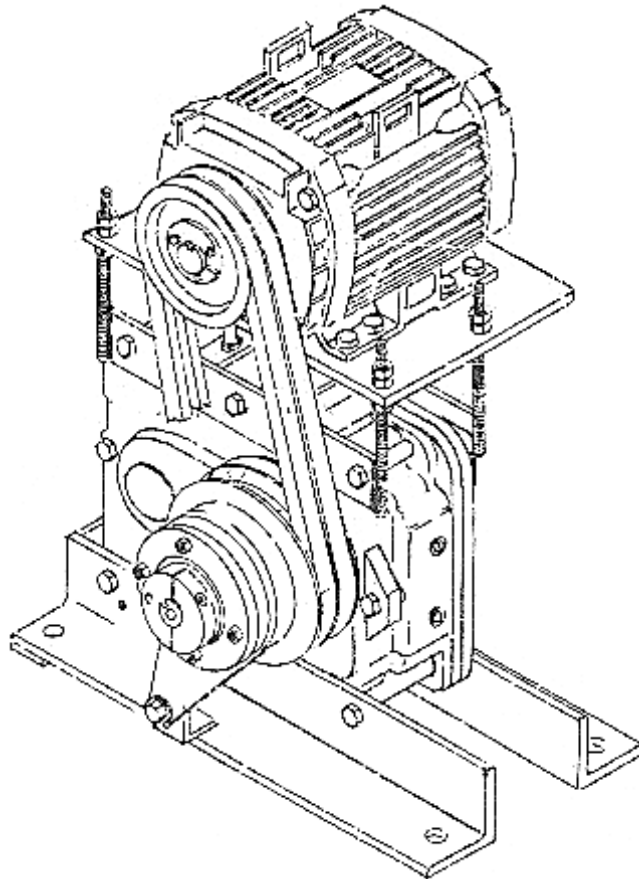

Page 2 - TYPE 215EEC MACHINE

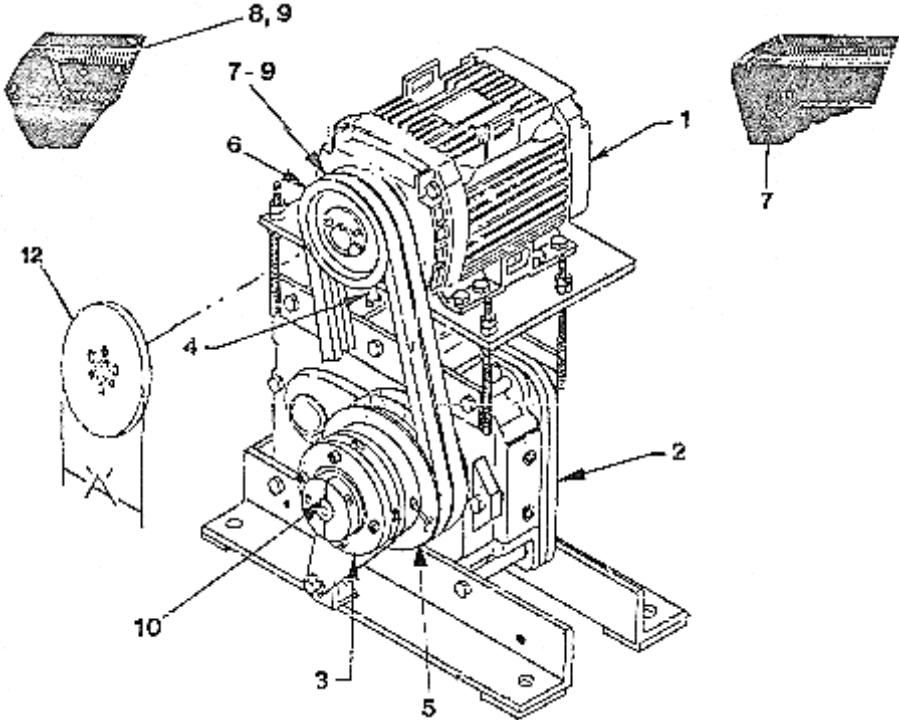

C-3043 - Escalator Machine - Type: 215EEC

REF. NO.	PART NO.	QTY.	DESCRIPTION
1	6333CP--	1	Motor (See Detail Page 5)
2	7575B3	1	Helical Gear Box Assy. (See Detail Page 4)
3	7575F3	1	Electric Brake, 10-55 FT-LBS Torque
	7575F4	1	Electric Brake, 30-85 FT-LBS Torque
4	SENSOR 3030AN50	1	Under-Overspeed Magnetic Sensor
5	SHV8.6PDX1BX1.875X1/2	1	Gear Box Sheave, Single Groove with SDS Bushing
	SHV8.6PDX2BX1.875X1/2	1	Gear Box Sheave, Double Groove with SK Bushing
6	SHV6.6PDX1BX1.125X1/4	1	Motor Sheave, Single Groove, SDS Bushing, 1.125 Bore
	SHV6.6PDX2BX1.375X5/16	1	Motor Sheave, Double Groove, SDS Bushing, 1.375 Bore
	SHV6.6PDX2BX1.625X3/8	1	Motor Sheave, Double Groove, SDS Bushing, 1.675 Bore
	SHV6.6PDX1BX1.375X5/16	1	Motor Sheave, Single Groove, SDS Bushing, 1.375 Bore
RECOMMENDED SPARE PART 7	BELT V-WOODS BX51	1	V-Belt, Torque-Flex
RECOMMENDED SPARE PART 8	BELT V-WOODS 2/B51	2	V-Belt, Sure Grip
RECOMMENDED SPARE PART 9	BELT V-WOODS 2/B55	2	V-Belt, Sure Grip
10	KEY ES5/16X5/16X2.0	1	Key, 2" Long
PART NOT ILLUSTRATED 11	192Y7	1	Key, 1.5" Lg. (TO GEAR BOX SHEAVE)
12	290CC1	1	Flywheel, 'A' = 9.116
	290CC2		10.460
	290CC3		11.476
	290CC4		12.010

C-3043 - Escalator Machine - Type: 215EEC

Page 3

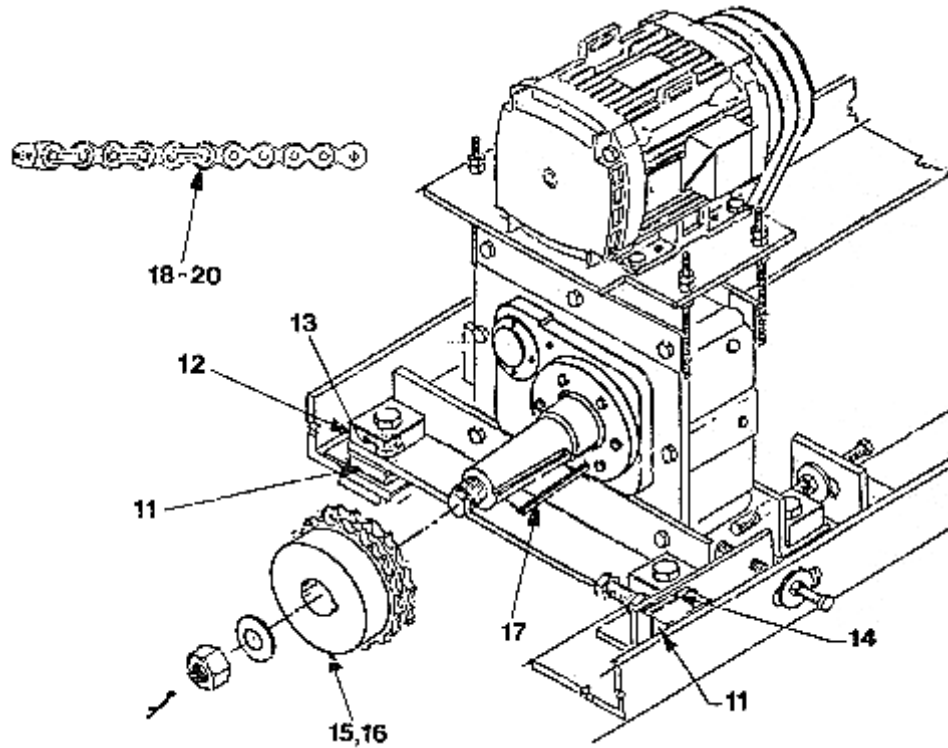

REF. NO.	PART NO.	QTY.	DESCRIPTION
11	310JJ2	5	Block, Sound Isolation, 3" x 3"
12	310JJ4	4	Block, Sound Isolation, 2.5" x 3"
13	137AL6	4	Tubing, Rubber, .88 Long, 1.25 OD
14	255AB51	4	Shim, Steel 2.7" X 3", .0598" Thick
15	195GH4	1	Sprocket, Double Stran.
16	195GL5	1	Sprocket, Triple Strand
17	192D24	1	Key
18	332AW23	1	Chain Main Drive, 138.75" Long, 1 - Strand
19	332AW24	1	Chain Main Drive, 138.75" Long, 2 - Strand
20	332AW27	1	Chain Main Drive, 138.75" Long, 3 - Strand

Page 4 - TYPE 7575B GEAR BOX - SPARE PARTS

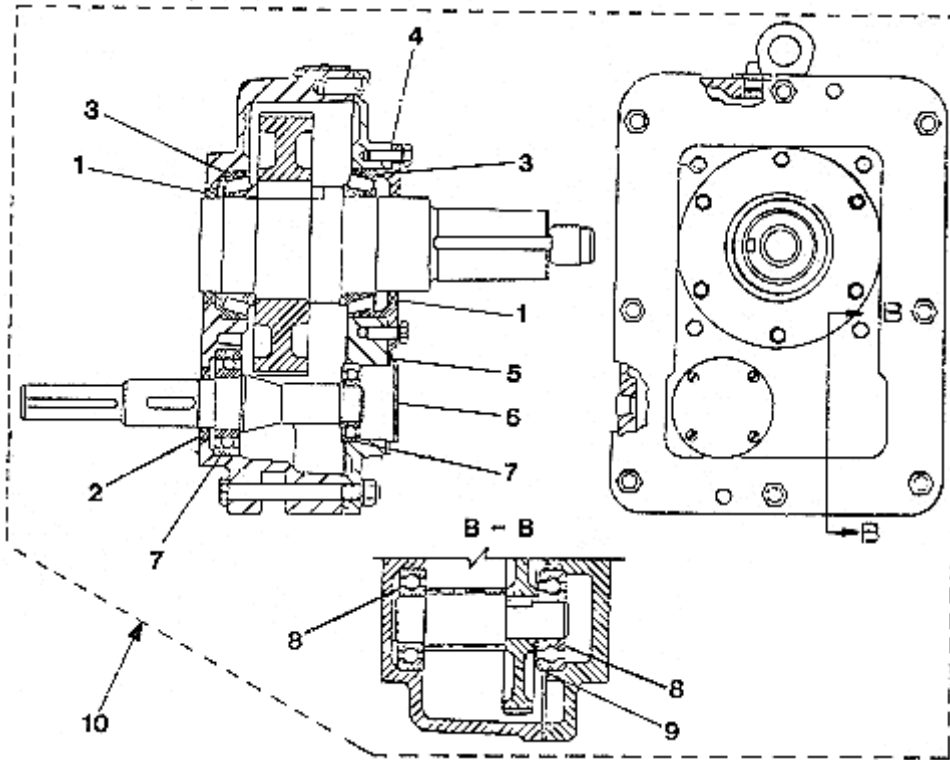

REF' NO	PART NO.	QTY.	DESCRIPTION
1	7575B/36 740 (AWK)	2	Seal, Low Speed Chicago-Rawhide Co.
2	7575B/19301 (AW)	1	Seal, High Speed Chicago-Rawhide Co.
3	7575B/719113-49	2	Roller Bearing Cup and Cone Assembly
4	7575B/76-700 339	1	Shim Set, Low-Speed Bearing Cap
5	7575B3/76-703595	1	Spacer, Backstop
6	7575B3/84-700322	1	Cap, Backstop
7	7575B3/3310-1307	2	Ball Bearing, Set, High Speed
8	7575B3/1308	2	Ball Bearing, Set, Intermediate
9	7575B/5100-16 2	1	Spacer, High-Speed Gear
10	7575B3	1	Helical Gear Box Assy. Complete with Integral Shaft

C-3043 - Escalator Machine - Type: 215EEC

Page 5 - MOTORS - 215EEC MACHINE

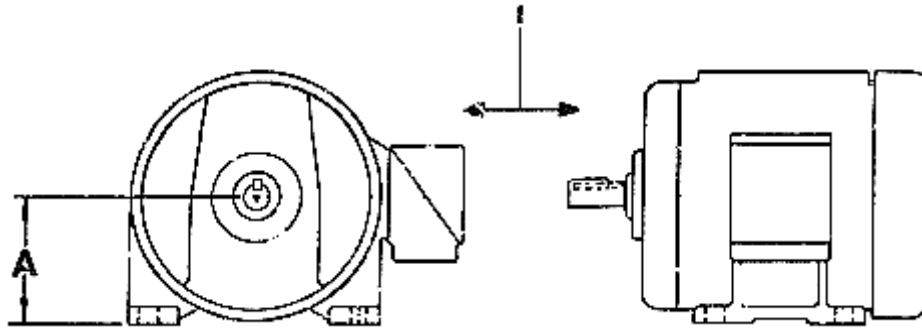

REF. NO.	PART NO.	DESCRIPTION	VOLTAGE	'A' DIM.
1	6333CP1	Motor, 5 HP, 1745 RPM	200	4.50
	6333CP2	Motor, 5 HP, 1745 RPM	230/460	4.50
	6333CP3	Motor, 7.5 HP, 1755 RPM	200	5.25
	6333CP4	Motor, 7.5 HP, 1755 RPM	230/460	5.25
	6333CP5	Motor, 10 HP, 1745 RPM	200	5.25
	6333CP6	Motor, 10 HP, 1745 RPM	230/460	5.25
	6333CP8	Motor, 5 HP, 1745 RPM	575	4.50
	6333CP10	Motor, 7.5 HP, 1755 RPM	575	5.25
	6333CP12	Motor, 10 HP, 1745 RPM	575	5.25
	6333CP13	Motor, 15 HP, 1750 RPM	200	6.25
	6333CP15	Motor, 15 HP, 1750 RPM	230/460	6.25
	6333CP16	Motor, 15 HP, 1750 RPM	575	6.25